



Shady Acres
Perennial Nursery

New Berlin, WI

Perennials

2016

www.ShadyAcresNursery.com

262-679-1610

e-mail: ShadyAcresNursery@juno.com

Planting Guide

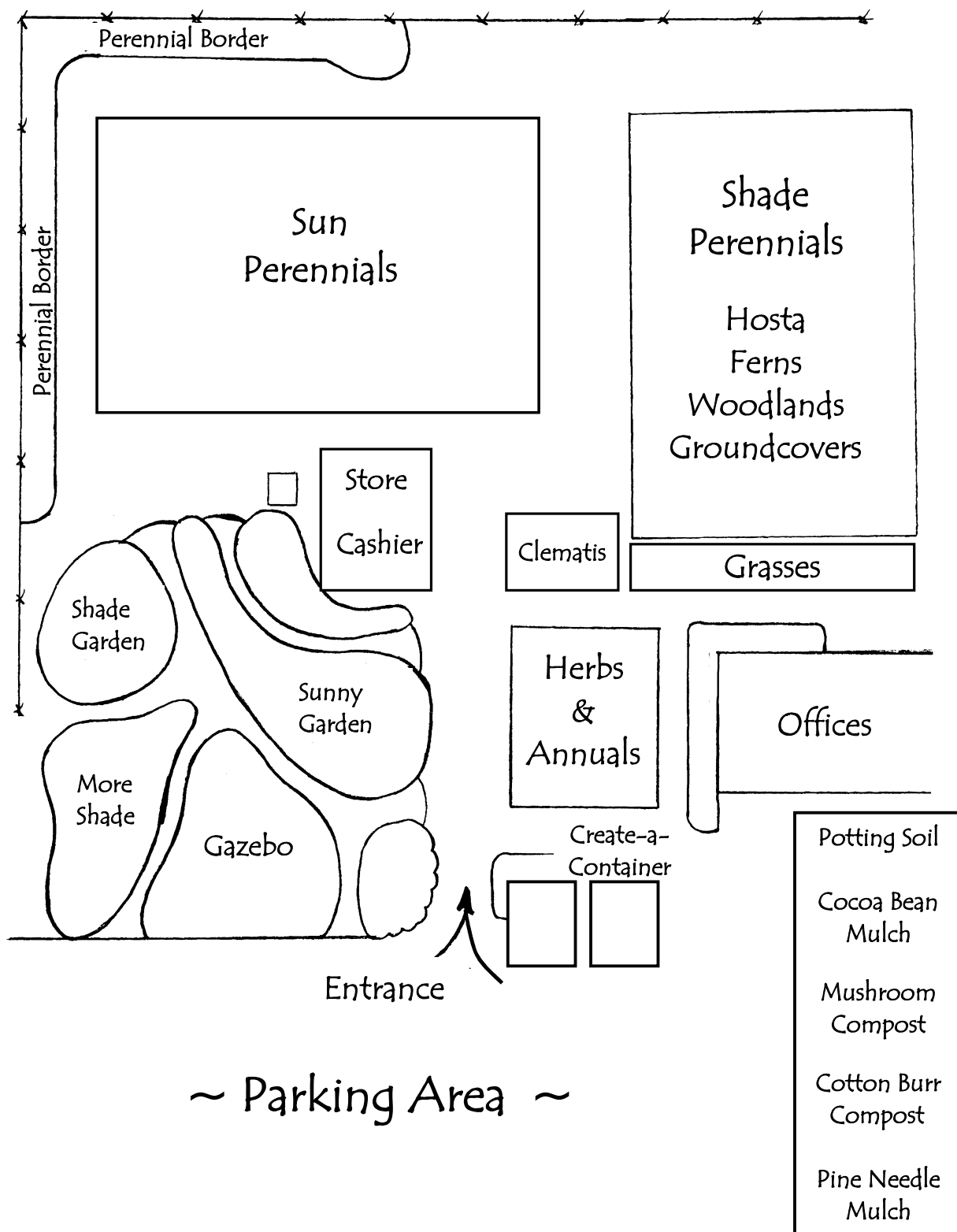

Garbe Enterprises, Inc. dba
Shady Acres Perennial Nursery
5725 South Martin Road
New Berlin, Wisconsin 53146-5112
phone: 262-679-1610
e-mail: ShadyAcresNursery@juno.com
web: www.ShadyAcresNursery.com

Welcome to Shady Acres Perennial Nursery
~ 2016 Gardening Season ~

Shady Acres is your destination for locally grown perennials. Since 1958, our family-owned business has been serving the green industry. Perennials are our specialty, and we are known for our outstanding selection of top-quality plants. We offer over 1200 varieties including perennials for sun or shade, ornamental grasses, native plants, groundcovers and fresh herbs! We invite you to browse our garden center, where all the plants we grow are arranged in an easy-to-find fashion.

Perennials are the perfect choice for enhancing your outdoor areas. A garden that changes through all four seasons will bring years of beauty and enjoyment. Stroll through our many display gardens to see mature perennials growing in a garden environment. Come often to observe how the foliage and flowers change throughout the season. Then, use your creativity to design a garden that reflects your own personal style.

Take a look at our revised calendar of events. We encourage you to join us for special feature days during the season, where we highlight a specific group of plants. These are fun and informative days to help inspire your gardening experience. You will also notice a change in our garden center hours in the late summer months.

Our friendly staff welcomes your comments and questions. Whether you are new to perennial gardening or have years of "trowel and error", let us know how we can assist you. We hope you enjoy each moment spent in your gardens.

Thank you from all of us at Shady Acres!

P.S. Don't forget about our **GIFT CERTIFICATES** for your friends and relatives; ideal for house warmings, Mother's Day, Father's Day, birthdays and even Christmas.

Plant Guarantee

We guarantee our perennials to be healthy at the time of purchase and will thrive under the appropriate growing conditions. If a perennial fails during the first (current) growing season, we will offer a one-time replacement perennial. Replacements are not guaranteed. We do not guarantee the hardiness of any perennial over winter. Our guarantee is excluded from acts of nature, neglect, or other events beyond our control.

*Please contact us for advice if you have any concerns about the health of your perennials.

Returned Checks

A service charge of \$35.00 will be added to any returned checks.

2016 Garden Center Hours

April	Monday-Friday	9:00 - 6:00
	Saturday	8:00 - 4:00
	Sunday	10:00 - 4:00
May, June	Monday-Friday	9:00 - 7:00
	Saturday	8:00 - 5:00
	Sunday	10:00 - 5:00
	<i>open Memorial Day</i>	9:00 - 4:00
July	Monday-Friday	9:00 - 6:00
	Saturday	8:00 - 4:00
	NEW! Sunday	10:00 - 4:00
	<i>closed Independence Day, July 4th</i>	
August, September, October	NEW! <i>by appointment only - call 262-679-1610</i>	
November, December	closed	
January, February, March	closed	

Table of Contents

Calendar of Events.....	4
Perennials.....	6
Clematis	16
Hemerocallis (Daylilies)	25
Hosta	29
Grasses	55
Herbs	59
Vines.....	62
Specialty Annuals.....	63
Top 10 List	64
Planting Instructions	65
Garden Shop.....	66
Mulches & Soil Amendments.....	66
Notes	67
Map.....	69

2016 Calendar of Events

Pre-registration is appreciated for planting projects, so we can prepare supplies. Please call our garden center to register 262-679-1610. No registration is required for Feature Days.

April 16 Garden Center Opens for the season!

April 30 **Feature Day: “New Perennials”** **Saturday**
Join us on this day as we feature what’s new in perennials at Shady Acres.

May 7-8 Mother's Day Weekend
Kids Planting Project: "Create a Gift for Mom" Saturday and Sunday
 Hey kids! Our potting shed will be open for you to create a special project to give to your Mom.
Cost: \$12 All supplies provided. Pre-registration appreciated.

May 21-22 **Planting Project: "Crazy Container Contest"** **Saturday and Sunday**
Get creative! Win a prize! Turn your "junk" into a jewel. Bring in your craziest empty container. Purchase Shady Acres annuals or perennials to plant in your container. We will provide the soil, fertilizer and use of our potting shed. Display your planted container in our voting area for one week. The most creative container garden (based on customer voting) will win a \$50 Shady Acres gift certificate.
Cost: Plants you purchase here. Pre-registration appreciated.

May 30 Memorial Day: Special Hours ~ 9:00 am to 4:00 pm

2016 Calendar of Events

----- June is Perennial Gardening Month -----

- | | | |
|------------|---|----------------------------|
| June 4 | Feature Day: "Incredible Herbs" | Saturday |
| | Join us on this day as we feature our large selection of herbs; along with tips on growing and using fresh herbs. Recipes, tasty herbal treats and fun folklore throughout the day! | |
| June 18-19 | Feature Day: "Hosta Hoopla" | Saturday and Sunday |
| | Join us on this day as we feature our extensive selection of hostas, the perfect plant for shady spots. Hostas of all kinds just in time for Father's Day! | |
| July 16 | Feature Day: "Native Plants" | Saturday |
| | Join us on this day as we feature plants native to Wisconsin, highlighting their benefits and usefulness in the garden. Tips on pollinators and butterflies too! | |
| July 31 | Garden Center Closes for the season. | |

NEW in 2016

Our garden center will not have regular hours in August, September and October. If you are in need of perennials during these late summer/early fall months, please contact us for availability. We will be happy to assemble your plants and arrange a convenient time for pick up.

Call 262-679-1610 or email ShadyAcresNursery@juno.com

Genus	Common Name					Perennials	
Species/Variety		(H)	(S)	Bloom	Loc.	Size	Price

Achillea Yarrow

Useful for the border, wild garden or meadow. Good for cut flowers, suitable for dried arrangements. Due to the scented leaves, yarrow is deer resistant.

millefolium	Naturalized white form.	30"	18"	June-Sept	☼	4.5	4.95
m. 'Saucy Seduction' (PP20782)	Rosy-pink flowers with yellow centers. Sturdy, upright habit.	27"	18"	June-Aug	☼	4.5	4.95
☺ m. 'Strawberry Seduction' (PP18401)	Large clusters of strawberry red flowers with a gold center. Mature flowers turn buff yellow, extending interest into the later season. Compact, sturdy and robust habit.	24"	18"	June-Aug	☼	4.5	4.95
☺ m. 'Sunny Seduction' (PP20808)	Flowers open intense lemon yellow, lightening to pastel yellow. Compact, sturdy and robust habit.	24"	18"	June-Aug	☼	4.5	4.95
'Moonshine'	Sulfur yellow flowers with grayish foliage.	24"	18"	June-Sept	☼	4.5	5.95
'Terracotta'	Silvery foliage. Bright peach flowers slowly turn to rich hues of earthy red-orange.	24"	18"	June-Aug	☼	#1 4.5	8.95 4.95

Actaea see Cimicifuga (Bugbane / Snakeroot)

Aegopodium Bishop's Weed / Snow on the Mountain

podagraria 'Variegatum'	Mats of white edged green foliage makes an attractive groundcover. Aggressive plant that may take over an area.	10"	9"		☼●	2.5	1.95
--------------------------------	---	-----	----	--	----	-----	------

Agastache Licorice Plant

Very aromatic licorice scented leaves. 4-6" flower spikes on strong stems. These plants will attract birds all season. Nice cut flower. Prefers average to dry locations. Great container plant. Deer resistant.

'Blue Fortune'	Deep blue flower spikes.	30"	18"	July-Sept	☼	4.5	4.95
'Bolero'	Vivid rose-purple flower spikes rise above bronzy green foliage. Forms a compact clump. Long blooming. (zone 5)	16"	18"	July-Sept	☼	4.5	4.95

Ajuga Bugleweed

Grows well under trees where a lawn is difficult to establish. Forms a dense evergreen mat.

'Chocolate Chip'	Small, rich chocolate colored narrow leaves, blue flowers in spring. Petite groundcover.	4"	10"	May-June	☼☺	4.5	4.95
r. 'Black Scallop' (PP15815)	Glossy, near black scalloped leaves. Deep blue flowers on short spikes in spring.	4"	10"	May-June	☼☺	4.5	4.95
r. 'Burgundy Glow'	Tri-color foliage, green, cream and bright pink. Blue flowers.	4"	10"	May-June	☼☺	4.5	4.95
r. 'Catlin's Giant'	Extra large leafed Ajuga. Deep bronze to purple foliage. Blue flower spikes.	6"	10"	May-June	☼☺	4.5	4.95

☼ sun ☺ part shade ● shade ☺ new variety (H) height (S) spacing (TP) tender perennial N native

Shady Acres Perennial Nursery

New Berlin, Wisconsin

262-679-1610

Genus	Common Name					Perennials	
Species/Variety		(H)	(S)	Bloom	Loc.	Size	Price
Alcea	Hollyhock						
Very easy to grow plants in full sun and well drained soil. Use in the back of the border or against a wall or fence.							
'Single Mix'	Old fashioned variety. Mixed colors.	60"	18"	July-Aug	☼	4.5	4.95
rosea Halo Series – Cerise	Large, cerise pink flowers with a deep purple halo.	60"	18"	July-Aug	☼	#1	7.95
rosea 'Mars Magic'	(Spotlight Series) Bright red single flowers. True perennial.	60"	18"	July-Aug	☼	#1	7.95
☺ rosea 'Radiant Rose'	(Spotlight Series) Rose-pink single flowers. Said to be truly perennial.	60"	18"	July-Aug	☼	#1	7.95
Alchemilla	Lady's Mantle						
Clusters of small yellow flowers bloom just above the light green fan shaped foliage.							
erythropoda	Bluish green foliage with light yellow flower.	8"	15"	July-Aug	☼☺	4.5	5.95
mollis 'Thriller'	Gray-green hairy leaves with lime-green flowers. Useful in a variety of settings.	18"	18"	July-Aug	☼☺	4.5	4.95
						#1	7.95
Allium	Ornamental Onions						
angulosum 'Summer Beauty'	Long blooming, large pink globular flowers over glossy green foliage.	16"	15"	July-Aug	☼	4.5	5.95
===== WNA 2012 Plant of the Year =====							
N cernuum	(Nodding Pink Onion) A native prairie plant that produces large globes of white flowers that turn to pink as they age.	18"	15"	July-Aug	☼	4.5	5.95
'Millennium'	A profusion of bright rose-purple flower globes upon shiny deep green foliage. Compact, strong grower.	16"	15"	July-Aug	☼	4.5	5.95
senescens 'Glaucum'	Attractive blue-green foliage forms unique twirling patterns. Pink flower.	6"	8"	July	☼	4.5	5.95
Amorpha	Lead Plant						
N canescens	U.S. native for dry or well drained sites. Large plant with hairy, white leaflets. Blue flower spikes.	48"	24"	June-July	☼	4.5	5.95
Amsonia	Blue Star Flower						
Low maintenance perennial native to eastern United States. Lance shaped foliage on tall stems.							
'Blue Ice'	A long blooming, compact selection from A. tabernaemontana. 'Blue Ice' has dark blue buds and flowers. Dark green foliage turns bright yellow in the fall.	15"	18"	June-Sept	☼☺	4.5	5.95
	===== WNA 2008 Plant of the Year =====					#1	8.95
hubrichtii	(Arkansas Amsonia) Graceful 3-4' plant with very fine foliage and clusters of steel blue flowers. Excellent golden fall color.	42"	24"	May-June	☼☺	#1	8.95
===== PPA 2011 Plant of the Year =====							
tabernaemontana	(Willow Amsonia) Pale blue, star-like flowers. Very hardy. Disease and pest resistant. A very nice, low maintenance plant.	36"	24"	June-Sept	☼☺	#1	8.95
Anacyclus	Mt. Atlas Daisy						
☺ pyrethrum var. depressus	Low growing plant with white daisy-like flowers tipped red. Nice rock garden plant.	4"	12"	May	☼	4.5	4.95

☼ sun ☺ part shade ● shade ☺ new variety (H) height (S) spacing (TP) tender perennial N native

Shady Acres Perennial Nursery

New Berlin, Wisconsin

262-679-1610

Genus	Common Name					Perennials	
Species/Variety		(H)	(S)	Bloom	Loc.	Size	Price
Anaphalis	Pearly Everlasting						
margaritacea 'New Snow' ('Neuschnee') This plant is a favorite larval food of the American painted lady butterfly. Small white flowers resembling pearls in 3-4" clusters. Flowers can also be dried for use in arrangements.		24"	15"	July-Aug	☼	4.5	4.95
Anchusa	Bugloss						
Sturdy, upright plants for sun to light shade. Large lance shaped foliage has coarse, hairy texture.							
azurea 'Loddon Royalist' Bushy plant with royal blue buttercup-like flowers.		36"	18"	June-Aug	☼☉	#1	9.95
Andropogon (Big Bluestem) see Grasses List							
Anemone	Windflower						
A mixture of spring and late summer bloomers for low maintenance areas. Forms a substantial mound of foliage low to the ground. Flowers appear on long stems, well above the foliage. Prefers moist soil.							
hybrida 'Pamina' Striking semi-double lavender rose blooms above green foliage. Late season cut flower.		30"	18"	Aug-Sept	☉	#1	9.95
h. 'Whirlwind' Semi-double white flowers, yellow center.		36"	18"	Aug-Sept	☉	#1	9.95
sylvestris (Snowdrop Anemone) Fragrant white flowers over light green foliage.		10"	10"	May-June	☼☉	4.5	4.95
tomentosa 'Robustissima' The hardiest and most vigorous growing of the fall flowering Anemones. 2-3" rose-pink flowers, yellow center.		30"	15"	Aug-Sept	☉●	4.5	6.95
						#1	9.95
Aquilegia	Columbine						
Distinctive flowers high above erect clumps of basal foliage with slender branching stems. You may find columbine seedlings popping up around your garden once your plants are established.							
alpina (Alpine Columbine) Nice short blue form.		18"	15"	May-June	☼☉	4.5	4.95
'Barlow Black' Fully double, very dark purple, spurless, rose-like flowers on long stems.		30"	15"	May-June	☼☉	4.5	4.95
'Biedermeier' Medium size with mostly blue and white.		12"	15"	May-June	☼☉	4.5	4.95
N canadensis (Wild Columbine) Native columbine with red flowers, yellow centers.		30"	15"	May-June	☼☉	4.5	4.95
chrysantha 'Yellow Queen' Yellow flowers.		24"	15"	May-June	☼☉	4.5	4.95
Dragonfly Hybrids Mixed colors.		18"	15"	May-June	☼☉	4.5	4.95
McKana Hybrids Mixed colors.		30"	15"	May-June	☼☉	4.5	4.95
☉ Songbird 'Cardinal' Large red and white flowers are upward-facing with long spurs.		20"	15"	May-June	☼☉	4.5	4.95
☉ Songbird Mix A glorious range of colorful upright flowers.		20"	15"	May-June	☼☉	4.5	4.95
Arisaema	Jack-in-the-Pulpit						
N triphyllum Native woodland wildflower. The flower is a brownish green hood. Brilliant red berries in fall. This plant requires a rich, humus soil.		24"	12"	April-June	☉●	4.5	5.95

☼ sun ☉ part shade ● shade ☉ new variety (H) height (S) spacing (TP) tender perennial N native

Shady Acres Perennial Nursery

New Berlin, Wisconsin

262-679-1610

Genus	Common Name					Perennials	
Species/Variety		(H)	(S)	Bloom	Loc.	Size	Price
Armeria	Sea Thrift						
maritima 'Splendens'	Bright rose flowers over tufts of evergreen foliage.	8"	8"	May-June	☼	4.5	4.95
p. Joystick Series - Mix	Cushion-shaped, grassy foliage. Long-stemmed globular blooms in a mix of colors.	12"	18"	May-Aug	☼	4.5	4.95
Artemesia	Wormwood						
Prefers sunny dry location, dislikes excessive water or fertilizer.							
ludoviciana 'Valerie Finnis'	Wide, showy silvery gray leaves that look like felt.	24"	15"		☼	4.5	4.95
schmidtiana 'Silvermound'	Dense mound of silvery, ferny foliage. Full sun for best performance.	10"	12"		☼	4.5	4.95
stelleriana 'Silver Brocade'	Excellent accent plant. Hardy. Very much resembles the annual 'Dusty Miller'.	12"	12"		☼	4.5	4.95
Aruncus	Goats Beard						
Interesting shrub-like perennials with many branching stems. Creamy white flowers appear above the foliage.							
aethusifolius	Creamy white flowers on red stems, finely cut foliage. Miniature form.	12"	18"	June-July	☼●	4.5	6.95
dioicus (sylvestris)	Astilbe-like ivory white flowers on tall plumes. Large plant for the shade garden or border.	60"	30"	June-July	☼●	#1	9.25
☺ 'Misty Lace' (PP15798)	Perfect size for smaller gardens! Large, creamy white, feathery plumes on dark red stems.	30"	24"	June-July	☼●	#1	11.95
Asarum	Ginger						
N canadense (Wild Ginger)	Heart shaped leaves. Requires humus soils. Good woodland groundcover.	6"	12"	May	●	4.5	5.95
europaeum (European Ginger)	Very glossy green foliage, evergreen. Excellent substance.	6"	12"	May	●	4.5	6.95
						#1	9.95
Asclepias	Butterfly Weed						
Upright perennials with lance shaped leaves.							
N incarnata (Swamp Milkweed)	Clusters of upturned pink flowers attract butterflies. Better for wetter conditions.	48"	18"	June-July	☼	4.5	6.25
i. 'Ice Ballet'	Bright white form of <i>incarnata</i> . Good cut flowers.	48"	18"	June-July	☼	4.5	6.25
N syriaca (Common Milkweed)	Leaves of milkweed are a food source for Monarch butterfly caterpillars. Pinkish-purple flowers are nectar source for many butterflies. Large seed pods split open in fall releasing silky white seeds easily dispersed by the wind.	30"	24"	June-Aug	☼	#1	9.25
N tuberosa (Butterfly Weed)	Native plant with orange flowers for dry sunny areas. Very attractive to butterflies. Slow to emerge in spring.	30"	18"	June-Aug	☼	4.5	6.25
t. 'Hello Yellow'	Showy bright yellow flowers. Best in warm, dry, or well drained sites. Great for butterflies.	30"	18"	June-Aug	☼	4.5	6.25
N verticillata (Whorled Milkweed)	Greenish-white flowers attract many pollinators, including Monarch butterflies.	20"	18"	June-Aug	☼	#1	7.95
☺	Thin "whorled" leaves give this native plant a delicate texture. Narrow pods form in late summer. (available mid-June)						

☼ sun ☼ part shade ● shade ☺ new variety (H) height (S) spacing (TP) tender perennial N native

Shady Acres Perennial Nursery

New Berlin, Wisconsin

262-679-1610

Genus	Common Name					Perennials	
Species/Variety		(H)	(S)	Bloom	Loc.	Size	Price

Aster Hardy Aster

Excellent group of perennials for summer and fall flowers. Easy to grow, dependable plants. All do best in sunny, dry soils. Pinch back through the middle of June to get full, bushy plants in fall.

N	'Alert'	Compact plant with deep crimson-red flowers.	12"	15"	Aug-Oct	☼	4.5	4.95
	azureus (Sky Blue Aster)	Deep green-blue arrow shaped leaves. Brilliant blue flowers make this plant an attractive prairie aster.	30"	18"	Aug-Oct	☼	4.5	5.95
N	novae-angliae	(New England Aster) Native plant. Flower colors can range from pink to blue to purple.	36"	18"	Aug-Oct	☼	4.5	4.95
	n.a. 'Alma Pötschke'	Masses of large, glowing, neon-rose pink flowers make a spectacular display in fall.	36"	18"	Aug-Oct	☼	4.5	4.95
	n.a. 'Purple Dome'	Compact heavy bloomer, purple flower. Disease resistant. Always a hit in the fall garden.	18"	15"	Aug-Oct	☼	4.5	4.95
	oblongifolius 'October Skies'	(Aromatic Aster) A short, bushy selection with mint-scented foliage. Produces daisy-like, sky blue flowers with yellow centers.	18"	18"	Aug-Oct	☼	4.5	4.95
	'Professor Kippenburg'	Lavender blue semi-double flower.	12"	12"	Aug-Oct	☼	4.5	4.95
	tongolensis 'Wartburg Star'	Spring bloomer. Large, violet flowers.	15"	12"	May-June	☼	4.5	4.95
	'Wood's Light Blue'	Clear light blue flowers with gold centers. Great for containers.	12"	12"	Aug-Oct	☼	4.5	4.95
	'Wood's Pink'	Compact plant with dark green foliage. Mildew and rust resistant. Clear pink flowers.	12"	12"	Aug-Oct	☼	4.5	4.95
	'Wood's Purple'	Deep purple flowers with all the virtues of 'Wood's Pink'.	12"	12"	Aug-Oct	☼	4.5	4.95

Astilbe False Spirea

Spikes of graceful plumes, mostly erect but some arching types. Foliage varies from shiny light green to remarkably dark. Taller varieties can be used for cut flowers. Most Astilbes prefers a rich, moist soil in a semi-shade location. If grown in full sun, give them plenty of water, especially at bloom time.

The Astilbe bloom season extends from early to late summer. Therefore, the varieties marked with an "E" will bloom in approximately the first third of that period, those marked with an "M" in the second third, and those marked with an "L" in the last third. Sometimes there is an overlap between bloom times and that is indicated by "M – L" for mid to late season.

	'Bressingham Beauty'	Dusty salmon-rose flowers on gracefully arching plumes.	36"	18"	E – M	☼●	#1	9.25
	chinensis 'Pumila'	Compact, lilac-pink flower, grows in the sun. Good groundcover.	10"	18"	L	☼●	4.5	5.95
	chinensis 'Purpurkerze'	Lilac colored flowers. Shiny dark foliage.	36"	18"	L	☼●	#1	8.95
	chinensis 'Superba'	Purple-rose flowers, heat tolerant.	36"	18"	L	☼●	#1	8.95
	chinensis 'Visions'	Sweetly scented, upright lilac-purple plumes. Excellent plant.	15"	18"	M – L	☼●	4.5	6.25
	===== WNA 2001 Plant of the Year =====						#1	9.25
	chinensis 'Visions in Pink' (PP11860)	Dense upright pink plumes with medium blue-green foliage. Slightly fragrant. Strong variety that can withstand dry conditions.	18"	18"	E – M	☼●	#1	9.25
	chinensis 'Visions in Red' (PP11965)	Deep reddish purple flowers emerge from deep red buds. Red stems and bronze-green foliage enhance the vibrant blossoms.	15"	18"	E – M	☼●	#1	9.25
	chinensis 'Visions in White' (PP18965)	Large creamy white flower plumes stand above a robust clump of glossy green leaves. Handles warm, dry summer conditions well.	24"	18"	E – M	☼●	#1	9.25

☼ sun ☼ part shade ● shade ☼ new variety (H) height (S) spacing (TP) tender perennial N native

Shady Acres Perennial Nursery

New Berlin, Wisconsin

262-679-1610

Genus	Common Name						Perennials	
Species/Variety		(H)	(S)	Bloom	Loc.	Size	Price	
Astilbe		False Spirea		(continued)				
'Delft Lace' (PP19839)	Lacy, deep blue-green foliage with red highlights. Red buds open to soft apricot-pink flowers. Seed panicles are red through summer.	30"	18"	E – M	☉●	#1	9.25	
'Deutschland'	White flowers, green foliage.	24"	18"	E	☉●	4.5	5.95	
						#1	8.95	
'Fanal'	Dark red flowers with dark green, deeply cut foliage.	24"	18"	E - M	☉●	4.5	5.95	
						#1	8.95	
'Fireberry' (PP20658)	Vibrant raspberry pink flowers above a short clump of medium green foliage.	16"	18"	E - M	☉●	#1	9.25	
'Maggie Daley'	Purple flowers and dark foliage.	28"	18"	M	☉●	4.5	5.95	
'Montgomery'	Bright red flowers.	24"	18"	M – L	☉●	4.5	5.95	
						#1	8.95	
'Peach Blossom'	Light pink flowers, light green foliage.	20"	18"	E - M	☉●	4.5	5.95	
						#1	8.95	
'Red Sentinel'	Vibrant scarlet-red flowers, dark green foliage.	28"	18"	M	☉●	4.5	5.95	
						#1	8.95	
'Rheinland'	Pink flowers, green foliage, profuse early bloomer.	24"	18"	E	☉●	4.5	5.95	
						#1	8.95	
'Snowdrift'	White flowers. Light green foliage.	24"	18"	M	☉●	4.5	5.95	
						#1	8.95	
'Sprite'	Shell pink flowers, dark green foliage.	12"	18"	L	☉●	4.5	6.25	
=== 1994 PPA Plant of the Year ===								
'Straussenfeder' ('Ostrich Plume')	Large salmon pink arching flowers, resembling an ostrich feather.	36"	18"	M	☉●	#1	8.95	
'Sugarberry' (PP20674)	Robust, compact growing variety with fern-like foliage. Flowers are soft pink and fragrant.	10"	18"	E - M	☉●	#1	9.25	
Astrantia		Masterwort						
☺	major 'Abbey Road' (PP14961)	28"	24"	June-July	☉	#1	11.95	
		Florets of deep reddish-purple flowers on black stems. Foliage spreads by underground runners to form a dense clump.						
Aubrieta		Purple Rock Cress						
A fine plant for borders or rock gardens.								
	'Purple Gem'	6"	10"	April-June	☼	4.5	4.95	
Aurinia (Alyssum)		Basket of Gold						
	saxatilis 'Gold Dust'	10"	12"	May-June	☼	4.5	4.95	
		Golden-yellow flowers cover the gray-green foliage.						
Baptisia		False Indigo						
N	australis	48"	24"	June	☼	4.5	5.95	
		Beautiful bush-sized perennial with olive green foliage, blue flowers. Interesting black seedpods.						
	'Carolina Moonlight'	36"	24"	June	☼	4.5	5.95	
		Spikes of creamy yellow blooms; nice blue green foliage. Attractive in the perennial border.						
N	leucantha	36"	24"	June	☼	4.5	5.95	
		Similar to <i>Baptisia australis</i> with white flowers.						
	minor	18"	18"	June	☼	4.5	5.95	
		Indigo blue flowers on what looks like a miniature version of <i>Baptisia australis</i> .						
	'Purple Smoke' (Wild Indigo)	36"	24"	June	☼	4.5	5.95	
		Charcoal gray stems with blue-green foliage and purple flowers. Vigorous grower.						
	sphaerocarpa (Yellow Wild Indigo)	36"	24"	June	☼	4.5	5.95	
		Striking yellow pea-like flowers appear on upright stems over blue-green foliage.						

☼ sun ☉ part shade ● shade ☺ new variety (H) height (S) spacing (TP) tender perennial N native

Shady Acres Perennial Nursery

New Berlin, Wisconsin

262-679-1610

Genus	Common Name					Perennials	
Species/Variety		(H)	(S)	Bloom	Loc.	Size	Price

Bergenia Saxifraga / Pig Squeak

Shiny, thick cabbage like foliage forms an attractive groundcover. Foliage turns to bronze color near winter and stays this color throughout the winter. Flowers very early on thick branched stems just above the foliage.

cordifolia	Leathery, shiny big leaves with deep pink flowers.	12"	15"	April-May	☼●	4.5	4.95
'Winterglut'	Bright red flowers. An improved 'Rotblum' with more vivid deep ruby-red winter foliage.	10"	15"	April-May	☼●	4.5	4.95

Boltonia Bolton's Aster

asteroides 'Pink Beauty'	Small soft pink daisy type flowers bloom for six weeks in early fall. Silver blue foliage.	48"	24"	Aug-Oct	☼	#1	7.95
a. 'Snowbank'	Large background plant with clouds of white flowers.	40"	24"	Aug-Oct	☼	#1	7.95

Bouteloua (Sideoats) see Grasses List

Brunnera Siberian Bugloss

Large neat clumps of dark green hairy foliage. Each leaf is heart shaped and grows larger after flowering. Prefers light shade. Will tolerate full sun but require plenty of moisture.

macrophylla	(Siberian Bugloss) Neat clumps of dark green foliage and Forget-Me-Not-like blue flowers.	15"	15"	May-June	☼●	#1	9.95
m. 'Emerald Mist'	(PP20460) Silver bars form a silver collar around the perimeter of the leaf. Very light silver dusting over the entire leaf. Baby blue flowers in spring.	15"	15"	May-June	☼●	#1	14.95
m. 'Jack Frost'	(PP13859) This plant displays a frosty silver overlay with light green veins. The leaves resemble crackled porcelain. Blue flowers in spring.	15"	15"	May-June	☼●	#1	14.95

===== PPA 2012 Plant of the Year =====

Buddleia Butterfly Bush

Deciduous shrub that freezes back to the ground. Comes back from the root and is covered with flowers that are attractive to butterflies and hummingbirds. Needs to be mulched in the winter and cut down to the ground in spring.

☺ Hot Raspberry	Long blooming dark pink flowers. Shorter variety. From the Buzz Series of butterfly bush.	48"	36"	July-Sept	☼	#1	9.95
davidii 'Black Knight'	Dark purple flowers.	60"	36"	July-Sept	☼	#1	9.95
d. 'Pink Delight'	Pink flowers.	60"	36"	July-Sept	☼	#1	9.95
d. 'White Profusion'	White flowers.	60"	36"	July-Sept	☼	#1	9.95
nanhoensis 'Nanho Blue'	Shorter form. Blue flowers with narrow silvery leaves.	48"	36"	July-frost	☼	#1	9.95
weyeriana 'Honeycomb'	Fragrant yellow flowers.	72"	36"	July-Sept	☼	#1	9.95

Calamagrostis (Feather Reed Grass) see Grasses List

Calamintha Calamint

nepeta 'Montrose White'	Clear white flowers all summer. Excellent habit, stays upright without flopping. Self-cleaning, does not hold its seed heads.	15"	18"	June-Sept	☼	4.5	4.95
--------------------------------	---	-----	-----	-----------	---	-----	------

===== WNA 2010 Plant of the Year =====

☼ sun ☺ part shade ● shade ☺ new variety (H) height (S) spacing (TP) tender perennial N native

Shady Acres Perennial Nursery

New Berlin, Wisconsin

262-679-1610

Genus	Common Name					Perennials	
Species/Variety		(H)	(S)	Bloom	Loc.	Size	Price
Callirhoe	Winecups						
involutrata	Low growing, cut leaf foliage with bright purple, cup-shaped flowers all summer.	12"	15"	June-Aug	☉	4.5	5.95
Caltha	Marsh Marigold						
N palustris	Shiny green foliage, yellow-gold flower, native wetland plant.	10"	12"	April-May	☼	4.5	5.95
Campanula	Bellflowers						
Well drained soil required for most Campanula varieties.							
carpatica 'Blue Clips'	Compact, mounding foliage with an abundance of blue flowers.	6"	10"	June-Sept	☼	4.5	4.95
c. 'Pearl Deep Blue'	The deepest blue <i>carpatica</i> on the market. Flowers two weeks earlier than 'Blue Clips'.	6"	10"	June-Sept	☼	4.5	4.95
c. 'White Clips'	Compact, mounding foliage with loads of white flowers.	6"	10"	June-Sept	☼	4.5	4.95
☉ glomerata 'Emerald' (PP18343)	Sky blue flowers, edged purple, sit atop dark stems. Useful in perennial border garden or a container garden.	20"	12"	June-July	☼☉	4.5	5.95
glomerata 'Joan Elliot'	(Clustered Bellflower) Violet blue selection. Nice border plant for cutflowers.	15"	12"	June-July	☼☉	4.5	4.95
persicifolia	(Peachleaf Bellflower) Semi-evergreen foliage with blue flowers, excellent for cutting.	30"	15"	June-Aug	☼☉	4.5	4.95
portenschlagiana 'Birch Hybrids'	Lilac-blue rich flowers on short plant.	6"	12"	June-July	☼	4.5	4.95
poscharskyana 'Blue Waterfall'	(Serbian Bellflower) Vigorous, low-growing, spreading habit. Deep blue star-shaped flower.	8"	12"	June-July	☼	4.5	4.95
rotundifolia	(Bluebells of Scotland) Round basal foliage 6" high with nodding blue flowers.	15"	12"	July-Aug	☼☉	4.5	4.95
'Sarastro'	Dark purple flower buds open to big blue-purple flowers up to 3". One of the best.	16"	18"	June-Aug	☼☉	#1	9.95

Campsis (Trumpet Vine) see Vines List

Carex (Sedge) see Grasses List

Caryopteris Bluebeard

Rounded shrub which grows to 3'. Silvery foliage with excellent spirea like flowers. Mulching for the winter is a good idea. Plant can be cut back to 8-10" in the spring each year.

clandonensis 'Dark Knight'	Deep rich purple flowers with dark green foliage.	36"	24"	July-Sept	☼	#1	9.25
c. 'Longwood Blue'	Upright growing habit. Silvery foliage with sky blue flowers.	40"	24"	July-Sept	☼	#1	9.25

Catananche Cupid's Dart

Drought tolerant perennial that can be used as cut or dried flower.

caerulea	Gray-green clumps of foliage, blue flowers.	15"	10"	June-Sept	☼	4.5	4.95
-----------------	---	-----	-----	-----------	---	-----	------

☼ sun ☉ part shade ● shade ☉ new variety (H) height (S) spacing (TP) tender perennial N native

Shady Acres Perennial Nursery

New Berlin, Wisconsin

262-679-1610

Genus	Common Name					Perennials	
Species/Variety		(H)	(S)	Bloom	Loc.	Size	Price
Ceanothus	New Jersey Tea						
This plant develops a very large taproot, allowing it to tolerate drought conditions once established. Hummingbirds feed on the small insects that pollinate the flowers.							
N americanus	A durable shrub covered with bright white clusters of flowers.	36"	24"	July-Aug	☼☉	4.5	5.95
Centaurea	Perennial Bachelor Button						
Deep cut silvery leaves. Needs well-drained soil. Good cut or dried flower.							
macrocephala	Good tall, landscape plant with yellow flowers.	36"	18"	June-July	☼	4.5	4.95
montana	Large cornflower-blue flowers. Fuzzy silvery green foliage.	24"	15"	June-July	☼	4.5	4.95
m. 'Amethyst in the Snow' (PP18284)	White flowers with royal purple centers over mounds of silver-green foliage.	16"	15"	June-July	☼	4.5	4.95
Centranthus	Jupiter's Beard						
Dense clusters of fragrant flowers above rich green foliage. Not particular about soil conditions.							
ruber	Blue-green foliage, pink-red flowers.	30"	15"	June-July	☼	4.5	4.95
Cerastium	Snow in Summer						
One of the most valuable plants in the rock garden. Nice in containers.							
tomentosum	Silvery foliage, good spreader with white flower.	6"	12"	May-June	☼	4.5	4.95
Chasmanthium (Northern Sea Oats) see Grasses List							
Chelone	Turtlehead						
Dense, upright plants producing stiff stems with dark green leaves. Flowers are tightly clustered directly above the foliage. Plants do best when soil is moist at all times. Good as cut flowers.							
'Hot Lips'	Deep green foliage topped with rose-pink flowers in late summer. Red stems for most of the season.	30"	15"	Aug-Sept	☼☉	4.5	5.95
===== WNLA 2016 Plant of the Year =====						#1	8.95
Chrysanthemum (Dendranthema)							
These hardy, fall blooming chrysanthemums perform best if pinched back through June.							
rubellum 'Clara Curtis'	Rose-pink daisy type flowers. Great for pollinators!	20"	18"	Aug-Oct	☼	4.5	4.95
r. 'Mary Stoker'	Straw yellow flower turning gold with age.	24"	18"	Aug-Sept	☼	4.5	4.95

☼ sun ☉ part shade ● shade ☼ new variety (H) height (S) spacing (TP) tender perennial N native

Shady Acres Perennial Nursery

New Berlin, Wisconsin

262-679-1610

Genus	Common Name	Perennials					
Species/Variety		(H)	(S)	Bloom	Loc.	Size	Price
Chrysanthemum (Leucanthemum)		Shasta Daisy					
In hot areas some shade is recommended. Taller varieties make good cut flowers.							
superbum 'Alaska'	Large single white flowers.	24"	18"	June-Aug	☼	4.5	4.95
s. 'Banana Cream' (PP23181)	Superb selection! 4" flowers open lemon yellow, then brighten to light butter yellow and finally to creamy white as they mature. Vigorous grower with compact foliage.	18"	18"	June-Aug	☼	#1	8.95
s. 'Becky'	A long-lived daisy that holds up well in the heat and humidity. Single white flowers above shiny green foliage. ===== 2003 PPA Plant of the Year =====	30"	18"	June-Aug	☼	4.5	4.95
s. 'Silver Princess'	Showy, compact plant covered with large single white blooms.	12"	12"	June-Aug	☼	#1	7.95
s. 'Snow Lady'	Excellent dwarf habit, beautiful white flowers and long bloom season.	12"	12"	June-Aug	☼	4.5	4.95
s. 'Snowcap'	Medium height. Long lasting white flowers on neat mounded plants.	18"	18"	June-Aug	☼	4.5	4.95
						#1	7.95

Cimicifuga (Actaea) Snakeroot / Bugbane

Beautiful plants for late season bloom. Large plants with bottle brush like flowers. The flowers are fragrant and repel insects. Prefers edge of the woods; part shade, moist humus soil. Excellent background plants with minimum maintenance.

	'Chocoholic'	(PPAF) Deep bronze purple leaves form a dense upright clump. Fragrant, bottlebrush flowers open mauve pink then lighten to white. Foliage becomes greener in full shade.	48"	24"	Aug-Sept	☼●	#1	14.95
N	racemosa	White fragrant flower spikes.	60"	24"	July-Aug	☼●	4.5	6.95
	simplex 'Atropurpurea'	Creamy white flowers over dark purple foliage.	60"	24"	July-Aug	☼●	4.5	9.95
	s. 'Brunette'	Striking deep purple foliage, pinkish white flowers fade to creamy white. Specimen plant.	48"	24"	July-Aug	☼●	4.5	11.95
	s. 'Carbonella'	Very dark foliage. Pink to white bottle brush flowers that point straight up.	54"	24"	Aug-Sept	☼●	#1	14.95
	s. 'Hillside Black Beauty'	(Black Snakeroot) (PP9988) The darkest Cimicifuga with striking purplish-black foliage and white flowers. A collector's plant.	50"	24"	Aug-Sept	☼●	#1	14.95
	s. 'White Pearl'	Large white bottlebrushes over pale green foliage. Great in groups in the garden.	36"	24"	July-Aug	☼●	4.5	6.95

☼ sun ☼ part shade ● shade ☼ new variety (H) height (S) spacing (TP) tender perennial **N** native

Shady Acres Perennial Nursery

New Berlin, Wisconsin

262-679-1610

Genus	Common Name					Perennials	
Species/Variety		(H)	(S)	Bloom	Loc.	Size	Price

Clematis

Shrub type:

	integrifolia (Bush Clematis) Nodding blue bell shaped flowers on non-climbing plants. These plants may need support.	30"	24"	Aug	☼	#1	18.95
☺	recta 'Serious Black' Extraordinarily dark purple new foliage forms an upright, self-supporting clump of intertwining stems. Leaves mature to olive green and are topped with a profusion of ivory blossoms.	40"	24"	June-July	☼☼	#1	18.95

Clematis

Vine type: Trellised

		Bloom Size	(H)	Bloom	Loc	Size	Price
	'Dr. Ruppel' Large, deep carmine flowers with slightly paler margin. Strong grower.	6"	96"+	June-July	☼	#1	18.95
	'Guernsey Cream' Full creamy yellow flowers. Very early and free flowering compact plants.	3-5"	72"+	May-June, Sept	☼☼	#1	18.95
	'Jackmanii' Purple flowers with cream stamens.	5-6"	120"+	June	☼	#1	18.95
	'Mrs. Cholmondeley' Large lavender blue flowers.	5-6"	72"+	June, Sept	☼	#1	18.95
	paniculata (terniflora) (Sweet Autumn Clematis) Small white fragrant flowers in the fall.	½"	180"+	Aug-Sept	☼	#1	18.95
	'Pink Chiffon' (Hagley Hybrid) Shell pink flowers with pointed sepals.	3-5"	72"+	July-Sept	☼	#1	18.95
	'Red Cardinal' Velvety crimson flowers with contrasting yellow stamens.	4"	144"+	July-Sept	☼	#1	18.95
	'The President' Bold purple-blue flowers all summer. Vigorous, easy to grow.	6"	96"+	May-Sept	☼	#1	18.95

Convallaria

Lily of the Valley

majalis (3-4 eye) Fragrant white bell shaped flowers in early spring. Excellent groundcover in poor shady sites.	6"	10"	May-June	☼●	4.5	4.95
---	----	-----	----------	----	-----	------

Coreopsis

Tickseed

Excellent group of landscape plants that are low maintenance and have long bloom periods. Verticillata varieties have finely cut foliage. Grandiflora varieties have more substantial basal foliage. Coreopsis are not particular about soil. However, a sunny location is preferred. Cutting back after bloom promotes reblooming.

	auriculata 'Zamphir' Bright golden flowers with fluted tubular petals. Long blooming.	18"	18"	June-Sept	☼	4.5	5.95
☺	'Berry Chiffon' (PPAF) Eye catching flowers are white with a vibrant raspberry-red eye. Dark green threadleaf foliage forms a sturdy, upright clump.	18"	12"	June-Sept	☼	4.5	5.95
	grandiflora 'Baby Sun' Compact plant with yellow double and semi-double flowers.	12"	12"	June-Sept	☼	4.5	4.95
	g. 'Early Sunrise' Double yellow flowers on compact plant.	18"	18"	June-Sept	☼	4.5	4.95
	g. 'Sunray' Double yellow flowers.	18"	18"	June-Sept	☼	4.5	4.95
	g. 'Tequila Sunrise' (PP9875) Creamy yellow foliage variegation is supplemented with mahogany tones in the fall. Bright yellow flowers with a reddish brown eye.	16"	15"	May-June	☼	4.5	5.95
	'Jethro Tull' (PP18789) Large, deep yellow flowers with fluted petals.	15"	18"	June-Sept	☼	4.5	4.95
	'Mercury Rising' (PPAF) Velvety wine-red flowers cover bright green, wide spreading, mounded foliage. Zone 5	15"	15"	June-Sept	☼	4.5	5.95
	'Sienna Sunset' (PP20460) Threadleaf foliage produces burnt sienna colored flowers that lighten to peach.	18"	18"	June-Sept	☼	4.5	5.95

☼ sun ☺ part shade ● shade ☺ new variety (H) height (S) spacing (TP) tender perennial N native

Shady Acres Perennial Nursery

New Berlin, Wisconsin

262-679-1610

Genus	Common Name						Perennials	
Species/Variety		(H)	(S)	Bloom	Loc.		Size	Price
Coreopsis	Tickseed	<i>(continued)</i>						
verticillata 'Golden Shower'	Bright yellow flowers and thread-like foliage.	20"	15"	June-Sept	☼		4.5	5.95
v. 'Moonbeam'	Thread-like foliage with pale yellow flowers.	20"	15"	June-Sept	☼		4.5	5.95
=== 1992 PPA Perennial Plant of the Year ===								#1 8.95
v. 'Route 66' (PP20609)	Unique yellow blooms with a splash of burgundy-red in the center that bleeds into the yellow petals at varying degrees. Zone 5	24"	15"	June-Sept	☼		4.5	5.95
v. 'Zagreb'	Thread-like foliage with golden yellow flowers.	15"	15"	June-Sept	☼		4.5	5.95
							#1	8.95
Corydalis								
lutea	Yellow dicentra-like flowers on 12" stems with delicate lacy foliage. Reliable, easy plant for partial shade.	12"	12"	May-June	☼		4.5	5.95
Crocasmia	Montbretia	Handsome, broad sword-like foliage provides an outstanding visual effect. Flowers line the strong arching stems. Good for cut flower and attracting hummingbirds. Tender perennial.						
'Emily McKenzie' (TP)	Golden orange flowers with deep red markings.	18"	15"	June-July	☼		4.5	4.95
'Lucifer' (TP)	Brilliant flame red flowers. Great in containers.	36"	15"	June-July	☼		4.5	4.95
Dalea	Purple Prairie Clover							
N purpureum	Fine, delicate foliage complemented by rose-purple flowers that bloom upwards. Drought tolerant due to a thick taproot.	24"	18"	July-Aug	☼		4.5	4.95
Darmera	Umbrella Plant	Interesting huge plant that prefers rich, constantly moist to boggy soil.						
peltata	White flowers changing to pink on hairy, leafless stem. Huge shiny green leaf 15-25" across.	48"	36"	June	☼		#1	9.95
Daylilies see Hemerocallis								

☼ sun ☼ part shade ● shade ☼ new variety (H) height (S) spacing (TP) tender perennial N native

Shady Acres Perennial Nursery

New Berlin, Wisconsin

262-679-1610

Genus	Common Name					Perennials	
Species/Variety		(H)	(S)	Bloom	Loc.	Size	Price
Delphinium							
Great cutflowers, shorter varieties don't require staking. May rebloom if cut back after first flowering.							
grandiflorum 'Blue Butterfly'	Arctic sky-blue flowers.	18"	12"	June-July	☼	4.5	4.95
g. 'Summer Blues'	Loose clusters of soft blue blooms. Try it in container gardens too!	16"	12"	June-July	☼	4.5	4.95
g. 'Summer Morning'	Light pink blooms.	12"	12"	June-July	☼	4.5	4.95
g. 'Summer Night'	Clusters of deep blue flowers.	16"	12"	June-July	☼	4.5	4.95
Magic Fountains Hybrids							
A dwarf version of the Pacific Giants. Beautiful colors make outstanding cut flowers.							
Cherry Blossom w/ White Bee		24"	15"	June-July	☼	4.5	4.95
Dark Blue w/ Dark Bee		24"	15"	June-July	☼	4.5	4.95
Dark Blue w/ White Bee		24"	15"	June-July	☼	4.5	4.95
Pure White		24"	15"	June-July	☼	4.5	4.95
Sky Blue w/ White Bee		24"	15"	June-July	☼	4.5	4.95
Pacific Giant Hybrids							
Tall background plants, excellent for cut flowers. May require staking.							
'Black Knight'	Deep midnight blue flowers.	60"	24"	June-July	☼	4.5	4.95
'Galahad'	White with white bee.	60"	24"	June-July	☼	4.5	4.95
'Summer Skies'	Light Blue.	60"	24"	June-July	☼	4.5	4.95

Deschampsia (Tufted Hair Grass) see Grasses List

Dianthus

Generally mat or mound forming plants with gray-green foliage. All do best in full sun and well-drained soil. Most are excellent ground cover or rock garden plants.

deltoides 'Arctic Fire'	White flowers with a bright fuchsia ring around a medium pink eye.	7"	12"	May-July	☼	4.5	4.95
d. 'Flashing Light'	Ruby-red flowers.	5"	12"	May-June	☼	4.5	4.95
d. 'Zing' ('Zing Rose')	Large rose colored flowers.	6"	12"	May-Aug	☼	4.5	4.95
g. 'Firewitch'	Spreading low growing form with deep blue-green foliage and magenta blooms. Long bloom time.	6"	12"	May-July	☼	4.5	4.95
==== 2006 PPA Plant of the Year =====							
g. 'Fire Star' (PP14895)	Gray-green foliage; vivid fire red flowers with deep crimson eye.	8"	12"	May-June	☼	4.5	4.95
g. 'Neon Star' (PP14549)	Compact mats of silvery foliage; single, fragrant, fringed hot pink flowers.	7"	12"	May-June	☼	4.5	4.95
g. 'Peppermint Star' (PP20369)	Pink flowers with red center. Foliage forms dense cushions.	8"	12"	May-June	☼	4.5	4.95
g. 'Tiny Rubies'	Clumps of gray-green foliage, double pink flower. Very compact plant.	4"	12"	May-June	☼	4.5	4.95
'Velvet n' Lace'	Beautiful 2" carnation type flowers that are deep purple with white fringed edges. Very fragrant flowers that will bloom all summer.	12"	12"	June-Aug	☼	4.5	4.95

☼ sun ☼ part shade ● shade ☼ new variety (H) height (S) spacing (TP) tender perennial N native

Shady Acres Perennial Nursery

New Berlin, Wisconsin

262-679-1610

Genus	Common Name					Perennials	
Species/Variety		(H)	(S)	Bloom	Loc.	Size	Price
Dicentra	Bleeding Hearts						
Popular shade plant with fern-like foliage and heart-shaped flowers. Long blooming perennial for partial shade.							
formosa 'Aurora'	Grayish blue foliage topped by pure white flowers. Good grower.	12"	15"	May-Sept	☉	#1	9.95
formosa 'Luxuriant'	Pink flowers, blooms all summer.	12"	18"	May-Sept	☉	4.5	6.95
						#1	9.95
'King of Hearts'	Grayish blue foliage with rose flowers; flowers all summer.	10"	15"	May-Sept	☉	#1	9.95
spectabilis	(Old Fashioned) Pink flowers. An old time favorite that may go dormant in the summer heat.	36"	30"	May-June	☉	#1	7.95
s. 'Alba'	(Old Fashioned) White flowers, may go dormant in the heat of summer.	30"	30"	May-June	☉	#1	7.95
s. 'Gold Heart'	Radiant yellow foliage creates a perfect backdrop for arching sprays of pink and white heart-shaped blossoms.	24"	30"	May-June	☉	#1	9.95
s. 'Valentine'	(PP22739) Bright red heart-shaped flowers dangle from deep red arching stems. May go dormant in summer.	30"	30"	May-June	☉	#1	9.95
Digitalis	Foxglove						
Thimble shaped flowers on tall erect stems. Good for partial shade location. Not particular about soil.							
ambigua	(grandiflora) Yellow flowers with brown spots.	24"	15"	June-July	☉☉	4.5	4.95
'Mertonensis'	(Strawberry Foxglove) Tetraploid flower, one of the few rose spire flowers available.	24"	15"	June-July	☉☉	4.5	4.95
purpurea Excelsior Hybrids	Mixed pinks, will self-seed.	24"	15"	June-July	☉☉	4.5	4.95
p. Foxy Hybrids	White to pink, will self-seed.	24"	15"	June-July	☉☉	4.5	4.95
p. 'Giant Shirley'	A magnificent array of mixed colors. Needs to re-seed itself in the garden.	48"	15"	June-July	☉☉	#1	7.95
Dodecatheon	Shooting Star						
Native woodland plant that goes dormant in midsummer (ephemeral).							
N meadia	Native plant with dart-shaped white flowers.	15"	4"	May	☉●	4.5	5.95
Doronicum	Leopard's Bane						
Mound forming growing habit. Flowers are similar to small sunflowers. In warmer areas, the plant will go dormant in the hottest part of summer, unless it is planted in a partial shade location.							
orientale 'Magnificum'	One of our earliest blooming yellow perennials, prefers partial shade.	24"	12"	May-July	☉☉	4.5	4.95
Echinacea	Coneflower						
In the perennial world, Echinacea's are all the rage. Hybridizers are working feverishly to release different colors of our native <i>purpurea</i> and other species. Echinaceas are sturdy perennial plants. Plants are pest resistant and flower most of the summer.							
Big Sky™ After Midnight™	('Emily Saul' PP18768) Distinctive dwarf selection. Fragrant dark magenta purple flowers. Blue-green foliage. Compact habit.	12"	18"	June-Aug	☼	4.5	6.95
Big Sky™ Harvest Moon™	('Matthew Saul' PP17652) Fragrant, earthy gold flowers the color of the harvest moon with a golden orange cone. Vigorous grower.	24"	18"	June-Aug	☼	4.5	6.95
Big Sky™ 'Solar Flare'	(PP22133) Enormous, strongly fragrant, deep magenta red blossoms. Sturdy near black stems.	30"	18"	June-Aug	☼	4.5	6.95

☼ sun ☉ part shade ● shade ☉ new variety (H) height (S) spacing (TP) tender perennial N native

Shady Acres Perennial Nursery

New Berlin, Wisconsin

262-679-1610

Genus	Common Name						Perennials	
Species/Variety		(H)	(S)	Bloom	Loc.	Size	Price	
Echinacea	Coneflower	(continued)						
	Big Sky™ Sundown™ ('Evan Saul' PP17659)	Intense russet orange flowers with a brown cone. Fragrant.	32"	18"	June-Aug	☼	4.5 #1	6.95 11.95
	Big Sky™ 'Twilight' (PP17651)	Fragrant, vibrant rose-red flowers with deep red cone. This color really pops.	24"	18"	June-Aug	☼	4.5	6.95
	'Cheyenne Spirit'	This coneflower blooms in a mix of colors: red, orange, magenta, golden yellow and white.	24"	18"	July-Aug	☼	4.5	6.95
	'Cleopatra' (PP24631)	Incredibly vibrant golden yellow fragrant flowers with an orange cone. Compact habit.	18"	18"	July-Aug	☼	#1	11.95
	'Fatal Attraction' (PP18429)	Strong, dark red stems contrast with the bright green foliage. Flowers are vivid.	26"	18"	July-Aug	☼	4.5 #1	6.95 11.95
	'Green Jewel' (PP18678)	Light green ray petals surround a large green cone.	24"	15"	June-Aug	☼	4.5	6.95
☺	'Julia' (PP24629)	Glowing tangerine-orange fragrant flowers with a copper cone. Strong stems. Compact, stocky habit.	18"	18"	July-Aug	☼	#1	11.95
	'Hot Papaya' (PP21022)	Double flowers that have sizzling orange-red petals, and a deep orange cone.	32"	18"	July-Aug	☼	4.5 #1	6.95 11.95
	'Meringue' (PP20537)	White double flowers with yellowish centers. Cone has tubular florets.	18"	18"	July-Sept	☼	4.5	6.95
N	pallida	Very showy large purple flowers with drooping petals atop 3 – 5' stalks in summer. Narrow leaves.	48"	18"	June-Aug	☼	4.5	4.95
	paradoxa	Striking yellow coneflower. A yellow purple coneflower, hence the paradox.	36"	18"	June-Aug	☼	4.5	5.95
	Pixie Meadowbrite™ ('CBG Cone 2' PP18546)	Dwarf habit; loads of pink flowers; very drought tolerant.	18"	18"	July-Sept	☼	4.5 #1	6.95 11.95
	===== 2014 WNA Plant of the Year =====							
N	purpurea	Tough plant that will perform in hot sunny locations with showy purple flowers. One of our best native wildflowers.	30"	18"	July-Aug	☼	4.5 #1	4.95 7.95
	p. 'Kim's Knee High' (PP12242)	The shorter version of the well known purple coneflower. Clear pink, drooping flexed flower petals. Great for small areas.	18"	18"	July-Aug	☼	4.5 #1	6.95 11.95
	p. 'Magnus'	Deep rose flower with dark disc. Non-drooping petals.	40"	18"	July-Aug	☼	4.5 #1	4.95 7.95
☺	p. 'PowWow White'	Yellow cone surrounded by pure white petals. Very floriferous!	18"	18"	July-Aug	☼	#1	11.95
	p. 'PowWow Wild Berry'	Deep purple-pink to near magenta 3-4" flowers are carried on stiff stems atop relatively short, stocky plants.	18"	18"	July-Aug	☼	#1	11.95
	p. Prairie Splendor™	Large rose pink flowers on short, compact plants. Early bloomer.	24"	18"	June-Aug	☼	4.5	4.95
	p. 'Ruby Star' ('Rubinstern')	An excellent selection with horizontally held petals. Deep magenta-red flowers.	36"	18"	July-Aug	☼	4.5	4.95
	p. 'White Swan'	White flowers with coppery cone.	20"	18"	July-Aug	☼	4.5 #1	4.95 7.95
	'Raspberry Truffle' (PP22612)	The fully open flowers have strawberry peach petals and a broad, darker pink pom-pom.	32"	18"	July-Aug	☼	4.5	6.95

☼ sun ☺ part shade ● shade ☺ new variety (H) height (S) spacing (TP) tender perennial N native

Shady Acres Perennial Nursery

New Berlin, Wisconsin

262-679-1610

Genus	Common Name	(H)	(S)	Bloom	Loc.	Perennials Size	Price
Species/Variety							
Echinops	Globe Thistle						
Foliage is thistle-like with spiny tips. The surface is rough and prickly. Flower heads are ball shaped.							
ritro	Globular metallic blue flowers on long stems.	36"	18"	July-Aug	☼	4.5	4.95
Eryngium	Sea Holly						
planum 'Blue Glitter'	Silvery blue stems produce masses of small shimmering blue pin-cushion type flowers.	36"	18"	July-Aug	☼	4.5	4.95
p. 'Blue Hobbit'	Intense blue globe-like flower heads over the silvery blue foliage. Shorter variety.	12"	15"	July-Aug	☼	4.5	4.95
N yuccifolium	(Rattle Snake Master) Native with white flowers. Foliage looks similar to Yucca.	40"	18"	July-Aug	☼	4.5	5.95
Euonymus	Wintercreeper						
Very nice groundcover with a heavier texture than vinca minor. Will climb if structure is provided.							
fortunei 'Coloratus'	(Purple Leaf Wintercreeper) Outstanding red/purple fall color.	18"	8"		☼●	2.5	1.95
Eupatorium	Joe Pye Weed / Boneset						
Late season flowering plant. Taller Joe Pyes are great for the back of the border. All varieties attract butterflies. Great plants for rain gardens!							
'Little Joe'	A very garden worthy Joe Pye Weed. Big mauve flower heads top attractive green foliage. Short, compact; Excellent upright habit.	42"	24"	Aug-Oct	☼☉	#1	7.95
maculatum 'Atropurpureum'	Flat topped clusters of rich purplish flower heads atop strong red stems.	72"	24"	Aug-Oct	☼☉	#1	9.95
m. 'Gateway'	Huge red flowers atop wine red stems.	72"	24"	July-Sept	☼☉	#1	7.95
m. 'Glenda'	(PPAF) Medium height. Much larger lavender-pink flower clusters than 'Little Joe'. Contrasting burgundy stems.	48"	24"	July-Sept	☼☉	#1	9.95
N perfoliatum	(Boneset) White flowers. Native plant.	40"	18"	Aug-Oct	☼☉	#1	7.95
N purpureum	(Sweet Joe Pye Weed) Purple flowers on large plant. Handles wet soil conditions.	60"	24"	July-Aug	☼☉	#1	7.95
rugosum 'Chocolate'	Striking purple/bronze foliage. Creamy white flower panicles. May self seed.	60"	24"	Aug-Sept	☼☉	#1	9.95
Euphorbia	Spurge						
'First Blush'	(PP15292) Light green leaves edged with cream margins flushed with pink. Low mounded foliage.	12"	15"	May	☼☉	#1	7.95
myrsinites	(Donkey Tail) Needs excellent drainage, great for walls or rock garden, yellow flowers.	6"	18"	May	☼	4.5	4.95
polychroma	(epithymoides) (Cushion Spurge) Compact dome-shaped plant covered with chartreuse flowers. Foliage turns red in fall, prefers dry, sunny locations.	12"	15"	May	☼☉	4.5	4.95
p. 'Bonfire'	(PP18585) Phenomenal color! Deep purple red and orange leaves with a touch of chartreuse.	18"	15"	May	☼☉	4.5	5.95
x martinii 'Ascot Rainbow'	(PP21401) Flashy green and yellow variegated foliage takes on pink and orange tones in cool weather.	20"	18"	May	☼☉	#1	7.95

☼ sun ☉ part shade ● shade ☼ new variety (H) height (S) spacing (TP) tender perennial N native

Shady Acres Perennial Nursery

New Berlin, Wisconsin

262-679-1610

Genus	Common Name		(H)	(S)	Bloom	Loc.	Perennials Size	Price
Species/Variety								
Ferns								
The "queen" of shade plants. All do best in shade with medium moist, rich humus soil.								
	Autumn Wood (<i>Dryopteris erythrosora</i>)	In cold climates, this fern is bright red in the fall. New growth is coppery colored.	24-30"		18"	●	#1	8.95
N	Christmas (<i>Polystichum acrostichoides</i>)	Evergreen.	10-18"		18"	●	#1	8.95
N	Cinnamon (<i>Osmunda cinnamomea</i>)	Mature fronds are bluish green and age to cinnamon brown.	24-60"		24"	●	#1	8.95
N	Clayton (Interrupted Fern) (<i>Osmunda claytoniana</i>)	A majestic variety. Similar to Cinnamon Fern, but is distinct in having the frond "interrupted" in the middle.	24-48"		24"	●	#1	8.95
☺	'Ghost'	Frosted apple-green fronds emit a ghostly white light in the shade. Dark purple stems.	18-30"		18"	☉●	#1	9.95
	'Godzilla'	This is a Japanese Painted Fern...giant in size! Forms a massive, arching clump of silvery fronds with green highlights and dark purple stems. Spreads slowly.	36"		36"	☉●	#1	9.95
	Japanese Painted Fern (<i>Athyrium nipponicum 'Pictum'</i>)	Silver colored leaves with red and green fronds.	12-24"		18"	☉●	#1	9.95
==== 2004 PPA Perennial Plant of the Year ====								
N	Lady (<i>Athyrium filix-femina</i>)	Graceful in appearance, extremely hardy, roots easily.	12-36"		18"	●	#1	8.95
N	Maidenhair (<i>Adiantum pedatum</i>)	Once established, these ferns create a beautiful canopy in the shade garden.	18"		18"	●	#1	8.95
N	Ostrich (<i>Matteuccia struthiopteris</i>)	Upright, vase-shaped and a vigorous grower. Needs moist soil.	24-60"		24"	☉●	#1	8.95
N	Royal (<i>Osmunda regalis</i>)	Majestic fern grows in wet soils or near permanent water. A slow spreader.	24-48"		24"	●	#1	8.95
N	Sensitive (<i>Onoclea sensibilis</i>)	Coarse textured; tolerates more sun and wet soils.	18"		18"	☉●	#1	8.95
N	Wood (<i>Dryopteris</i>)	Very fine texture and easy to grow.	12-24"		18"	●	#1	8.95

Filipendula

Meadow Sweet

Superb perennials, extremely hardy and pest resistant. Flowers in mid to late summer with impressive plume like flowers. Moist soil and some shade are preferred for best growth.

☺	purpurea Deep pink, fluffy flowers on purple-red stems. Attracts butterflies!	40"	24"	July-Sept	☼☉	#1	9.95
	rubra 'Venusta' Deep pink flowers.	48"	24"	July-Sept	☼☉	#1	9.95

Fragaria

Strawberry

	'Lipstick' Strawberry-like habit with bright red flower.	6"	12"	June-Aug	☼	4.5	5.95
	'Variegata' Creamy-white margined leaf. White flowers with yellow center.	6"	12"	June-Aug	☼	4.5	5.95

Gaillardia

Blanket Flower

Low maintenance, heat tolerance, and long bloom season make this a popular perennial.

	aristata 'Arizona Apricot' Large 3", apricot flowers with yellow tips and darker orange center. Compact habit.	12"	15"	June-Sept	☼	4.5	4.95
a.	'Arizona Red Shades' Large crimson red flowers with long bloom time. More compact than <i>G. 'Burgundy'</i> .	12"	15"	June-Sept	☼	4.5	4.95
a.	'Arizona Sun' Provides a continuous display of large 3" single mahogany red flowers with bright yellow petal edges. Compact plant.	10"	15"	June-Sept	☼	4.5	4.95
	'Dazzler' Gold with maroon center flowers.	18"	15"	June-Sept	☼	4.5	4.95
	'Goblin' ('Kobold') Deep red with yellow-bordered flowers.	12"	15"	June-Sept	☼	4.5	4.95
	Mesa Yellow™ Well branched plants produce masses of yellow flowers.	18"	15"	June-Sept	☼	4.5	4.95

☼ sun ☉ part shade ● shade ☺ new variety (H) height (S) spacing (TP) tender perennial N native

Shady Acres Perennial Nursery

New Berlin, Wisconsin

262-679-1610

Genus	Common Name	(H)	(S)	Bloom	Loc.	Perennials	Size	Price
Species/Variety								
Galium	Sweet Woodruff							
odoratum	Delicate-looking but fast-spreading groundcover for semi-shade, white flowers.	8"	8"	May-June	☉●		4.5	4.95
Gaura	Indian Feather							
	Long flowering plant for the sunny border.							
lindheimeri 'Siskiyou Pink'	Tall, wiry stems with long blooming, striking flowers of deep, rich pink.	36"	12"	June-Oct	☼		4.5	5.95
I. 'Whirling Butterflies'	Beautiful narrow-leafed plant with pale pink fading to white flowers, excellent texture plant.	36"	12"	June-Oct	☼		4.5	4.95
Gentiana	Gentian							
dahurica	Deep blue flowers in late summer and fall. Hardy to zone 3.	12"	12"	Aug-Sept	☼☉		4.5	5.95
Geranium	Cranesbill							
	A large group of excellent perennials in a wide range of colors. Some are clump forming and others are spreaders. Foliage is important for location choice. Larger foliage varieties need some shade.							
'Brookside'	Clear blue flowers with a tiny white eye.	15"	18"	June-Aug	☼☉	#1		9.95
cantabrigiense 'Biokovo'	White flowers with pink stamens.	10"	12"	May-June	☼☉	4.5		6.25
	===== PPA 2015 Plant of the Year =====							
c. 'Karmina'	Rich, raspberry-pink flowers on a plant prized for its groundcover effect.	8"	12"	May-June	☼☉	#1		9.25
cinereum 'Ballerina'	Pink flowers with dark veins.	6"	12"	June-Sept	☼☉	#1		9.95
'Johnson's Blue'	Bright violet-blue flowers. Good as a groundcover.	16"	12"	June-July	☼☉	4.5		6.25
						#1		9.25
macrorrhizum	(Bigroot Cranesbill) Fragrant apple scented foliage with thick clusters of pink flowers in late spring. Red to bronze fall foliage color.	12"	15"	May-July	☼☉	#1		9.25
macrorrhizum 'Bevan's Variety'	Deep magenta petals with dark red sepals. One of the best flowering selections. Good groundcover.	12"	15"	May-July	☼☉	#1		9.25
N maculatum	Native species with deep pink flowers.	18"	15"	June	☼☉	4.5		4.95
pratense 'Dark Reiter'	Handsome, finely cut plum purple foliage with contrasting lilac blue flowers.	10"	12"	June-Aug	☼☉	4.5		6.25
'Rozanne' (PP12175)	Large, violet blue flowers with a white eye. Deep green, mounded foliage. Vigorous. Exceptionally long bloom season.	18"	18"	June-Sept	☼☉	#1		9.95
	===== PPA 2008 Plant of the Year =====							
sanguineum	Deeply lobed foliage with deep purplish-red flowers, red fall foliage color.	10"	15"	June-Sept	☼☉	4.5		6.25
s. 'Album'	Deeply lobed foliage with white flowers.	10"	15"	June-Sept	☼☉	4.5		6.25
sanguineum 'Max Frei'	Abundant deep magenta flowers. Mounding, compact foliage. Good fall color.	12"	15"	July-Sept	☼☉	#1		9.25
s. 'New Hampshire Purple'	Deep purple blossoms stand out above dark green foliage. Compact habit makes this plant great in containers.	8"	15"	June-Sept	☼☉	#1		9.25
s. var. striatum	(lancastrisense) Shell-pink flowers. Outstanding red foliage in the fall.	10"	18"	June-Sept	☼☉	4.5		6.25

☼ sun ☉ part shade ● shade ☼ new variety (H) height (S) spacing (TP) tender perennial N native

Shady Acres Perennial Nursery

New Berlin, Wisconsin

262-679-1610

Genus Species/Variety	Common Name	(H)	(S)	Bloom	Loc.	Perennials	
						Size	Price
Geum	Avens						
coccineum 'Borisii'	Orange-red flowers on shorter plant.	12"	12"	May-Sept	☼	4.5	5.95
chiloense 'Lady Stratheden'	Double yellow flowers.	24"	12"	May-July	☼	4.5	4.95
c. 'Mrs. Bradshaw'	Scarlet semi-double flowers.	24"	12"	May-July	☼	4.5	4.95
flora plena 'Blazing Sunset'	Fully double, scarlet red flowers. Great for the border or bouquets.	24"	12"	May-July	☼	4.5	5.95
Totally Tangerine	('Tim's Tangerine' - PP22041) Robust growing habit. Very tall, strong stems above the mounded foliage, carry loads of bright apricot to tangerine orange flowers.	30"	15"	May-July	☼	4.5	5.95
N triflorum	(Prairie Smoke) White flowers. It produces outstanding feathery silver and pink seed heads.	8"	12"	May-June	☼	4.5	6.95
Gillenia	Bowman's Root						
trifoliata	A tough plant native to the Midwest. Loose sprays of star-shaped white to pinkish flowers. Tolerates wet or dry conditions once established.	30"	24"	June-July	☼☉	4.5	5.95
Grasses...see list at back of catalog							
Gypsophila	Baby's Breath						
Tall forms make excellent cut flowers.							
MY PINK®	(paniculata 'DANGYP39') (PP17485) Large panicles of true light pink, double flowers appear atop upright, well branched, bushy plants.	30"	24"	June-July	☼	#1	9.25
repens	White flowers, good spreading ground cover.	6"	18"	June-July	☼	4.5	4.95
r. 'Rosea'	Rose-pink flowers, good spreading ground cover.	6"	18"	June-July	☼	4.5	4.95
Hakonechloa (Hakone Grass) see Grasses List							
Hedera	English Ivy						
Climbing, spreading groundcover with dark green leaves. Will climb trees and buildings. Some winter protection required to prevent die back.							
helix 'Thorndale'	Subzero strain, elegant ground cover, needs good soil.	6"	9"		☉●	2.5	1.95
Helenium	Helen's Flower / Sneezeweed						
Large clumps with stems up to 3-4' tall. Leaves are lance shaped. All varieties are heavy flower producers and flower from early to late summer. Great for cut flower growing. Full sun, not particular about soil conditions.							
autumnale Red and Gold Hybrids	2" sunflower shaped yellow to burgundy flowers.	48"	15"	June-July	☼	4.5	4.95
'Moerheim Beauty'	Brownish red flowers, light green foliage.	36"	18"	June-July	☼	#1	8.95
'Red Army'	Contrasting red and yellow flowers make an outstanding show. Shorter form.	24"	18"	June-July	☼	#1	8.95
Helictotrichon (Blue Oat Grass) see Grasses List							

☼ sun ☉ part shade ● shade ☉ new variety (H) height (S) spacing (TP) tender perennial N native

Shady Acres Perennial Nursery

New Berlin, Wisconsin

262-679-1610

Genus	Common Name					Perennials	
Species/Variety		(H)	(S)	Bloom	Loc.	Size	Price
Heliopsis	False Sunflower						
Flowers midsummer to late fall. Flowers are showy, yellow rays with darker disk. Prefers moist soil.							
N helianthoides (Ox-eye Sunflower)	Yellow-orange flowers.	60"	24"	July	☼	4.5	4.95
h. 'Summer Nights'	Deep golden yellow flowers with mahogany centers top dark red stems and red tinged foliage. Simply stunning.	36"	24"	July-Oct	☼	4.5	5.95
h. 'Summer Sun'	Double yellow-orange flowers.	36"	24"	July-Oct	☼	4.5	4.95
						#1	7.95

Helleborus Hellebore (Lenten Rose)

Winter and very early spring blooming plants. Great for the shady border or light woodlands. Helleborus is one of the most enchanting spring bloomers. The plant is not difficult to grow, but does require some attention. Helleborus mainly grow in the spring and fall. Due to the heat, these plants hardly grow in the summer. These plants should be protected against the harsh winter winds. Deer resistant.

Helleborus x hybridus ===== 2005 PPA Perennial Plant of the Year =====

☼ Brandywine	Single, semi-double and double flowers in a mix of reds, spotted pinks and apricot shades. Spectacular selection! (available mid-June)	15"	15"	April-May	☼	#1	14.95
Winter Thrillers™ Mix	Large and heavily spotted single flowers in shades of red, pink, purple, yellow, green, apricot and more! Some double flowers.	20"	15"	April-May	☼●	#1	14.95
x hybridus Royal Heritage™	Wide range of colors (purple, red, near black, white, green, pink and even yellow.) The 2" flowers are truly a harbinger of spring.	20"	15"	April-May	☼●	#1	14.95

Hemerocallis Daylilies

The combination of easy maintenance, hardiness and flower color makes this a "perennial" favorite among gardeners and landscapers alike. Hemerocallis prefer full sun but will grow in half shade.

Bloom Period (June – August)

E=Early, **EM**=Early Mid, **M**=Mid, **ML**=Mid Late, **L**=Late, **Ext**=Extended bloom, **Re**=Rebloomer.

Daylily	Color	(H)	Bloom Period	Size	Price
'Barbara Mitchell'	Very popular award winning daylily. Very large soft pink flowers with round ruffled overlapping petals.	20"	M-Re	#1	9.95
'Blueberry Candy'	Ivory colored flowers have ruffled petals. Stunning violet eyezone. A strong performer in the landscape, many buds and flowers on each stem.	22"	ML-Re	#1	9.95
'Bodacious Returns'	Large (7") ruffled, dusted gold flower that reportedly outblooms <i>Stella d'Oro</i> .	24"	M-Re	#1	9.95
'Bonanza'	Gold-yellow, red-eye.	28"	M	4.5	5.95
'Bright Sunset'	Slightly ruffled, burnt coppery orange flowers with golden midribs. Very fragrant.	36"	M-Ext	#1	8.95
'Catherine Woodbury'	Orchid pink, slightly ruffled.	30"	M	#1	8.95
'Chicago Apache'	Fiery red with silky finish. Ruffled edges.	26"	ML	#1	9.95
'Chicago Fire'	Red with yellow stripes.	34"	ML	#1	9.95
'Chicago Sunrise'	Yellow/orange blend, heavy bloomer.	28"	M	#1	9.95
'Custard Candy'	Creamy yellow 4" flowers with maroon eyezone and green throat.	24"	EM-Re	#1	9.95
'Daring Deception'	Pale lavender with dark purple edges and eyezone.	24"	E-Re	#1	9.25

☼ sun ☼ part shade ● shade ☼ new variety (H) height (S) spacing (TP) tender perennial N native

Shady Acres Perennial Nursery

New Berlin, Wisconsin

262-679-1610

Genus	Common Name					Perennials	
Species/Variety		(H)	(S)	Bloom	Loc.	Size	Price
Hemerocallis	Daylilies	<i>(continued)</i>					
Daylily	Color	(H)	Bloom	Size	Price		
'Frans Hals'	Orange-red and yellow bicolor.	24"	ML	4.5	5.95		
'Gentle Shepherd'	Near white flowers.	28"	EM	#1	9.25		
☺ 'Going Bananas'	(PP17164) Large lemon yellow flowers, fragrant, slightly ruffled. Blooms nearly continuous from summer into fall.	20"	EM-Re	#1	9.95		
'Grape Magic'	Grape-purple flowers with a deep purple eye. Similar to 'Little Grapette' with flowers twice the size.	20"	ML-Re	4.5	5.95		
'Happy Returns'	Canary yellow. Rebloomer. (MIN)	18"	Ext E-Re	#1 4.5	6.95		
'Hyperion'	Canary yellow, heavy bloomer.	40"	M-Re	4.5	6.25		
'Joan Senior'	Creamy white ruffled fragrant flowers.	20"	Ext M-Re	#1 4.5	9.25 9.95		
'Little Grapette'	Light grape-purple self with green throat. (MIN)	12"	EM	4.5	6.95		
'Mary Todd'	Yellow, heavy bloomer.	26"	Ext EM-Re	#1 4.5	9.95		
'Mini Pearl'	3" lightly ruffled blush melon pink flowers. Reblooms like <i>Stella d'Oro</i> .	18"	E-Re	4.5	6.95		
'Missouri Beauty'	Bright lemon yellow flower with green throat.	32"	EM	#1	8.95		
'Pardon Me'	Brick red flowers with lemon yellow throat. (MIN)	26"	M-Re	4.5	6.95		
'Prairie Blue Eyes'	Fragrant. Lavender flowers with blue eyes.	28"	M	#1	9.95		
'Prairie Wildfire'	Classic fragrant red daylily. Velvety red flowers with slightly recurved petals.	23"	M	4.5	5.95		
'Purple d'Oro'	Medium purple, slightly ruffled flowers with a bright yellow throat. (MIN)	20"	Ext EM-Re	#1 4.5	8.95 9.95		
'Rocket City'	Bittersweet orange flower.	36"	M-Ext	#1	9.25		
'Rosy Returns'	(PP9779) A pink everblooming daylily! The 4" flowers are rose pink with a deep rose eyezone.	14"	E-Re	4.5	6.95		
☺ 'Ruby Stella'	Ruby-red with yellow throat. Fragrant.	20"	M-Re	#1	9.95		
'Siloam June Bug'	Golden yellow, burgundy eyezone. (MIN)	23"	E	4.5	6.95		
'Stella de Oro'	Gold-yellow, ever bloomer. (MIN)	16"	Ext E-Re	#1 4.5	7.95 4.95		
'Strawberry Candy'	Strawberry pink with rose-red eyezone and golden green throat. Stout Medal winner.	26"	Ext EM-Re	#1 4.5	9.95		
'Summer Wine'	Lavender-wine, green throat.	24"	M	4.5	6.25		

☼ sun ☺ part shade ● shade ☺ new variety (H) height (S) spacing (TP) tender perennial N native

Shady Acres Perennial Nursery

New Berlin, Wisconsin

262-679-1610

Genus	Common Name				Perennials			
Species/Variety		(H)	(S)	Bloom	Loc.	Size	Price	
Hemerocallis	Daylilies							
Bloom Period (June – August)								
E=Early, EM=Early Mid, M=Mid, ML=Mid Late, L=Late, Ext=Extended bloom, Re=Rebloomer.								
Color	E / EM		M		ML / L			
Red			Pardon Me (Re) Prairie Wildfire Ruby Stella (Re)		Chicago Apache Chicago Fire			
Orange / Peach	Mini Pearl (Re)		Bright Sunset (Ext) Rocket City (Ext)					
Pink	Rosy Returns (Re) Strawberry Candy (Re)		Barbara Mitchell (Re) Catherine Woodbury					
Yellow	Custard Candy (Re) Happy Returns (Re/Ext) Missouri Beauty		Chicago Sunrise Going Bananas (Re) Hyperion (Re/Ext)					
Gold	Mary Todd (Re) Siloam June Bug Stella d'Oro (Re/Ext)		Bodacious Returns (Re) Bonanza					
Purple	Daring Deception (Re) Little Grapette Purple d'Oro (Re)		Prairie Blue Eyes Summer Wine		Grape Magic (Re/Ext)			
White/Cream	Gentle Shepherd		Joan Senior (Re/Ext)		Blueberry Candy (Re)			
Bicolor			Frans Hals					

Herbs...see list in back of catalog

☼ sun ☉ part shade ● shade ☺ new variety (H) height (S) spacing (TP) tender perennial N native

Shady Acres Perennial Nursery

New Berlin, Wisconsin

262-679-1610

Genus	Common Name					Perennials	
Species/Variety		(H)	(S)	Bloom	Loc.	Size	Price
Hepatica	Mayflower / Liverwort						
N acutiloba Native spring-blooming plant with white to blue flower.		6"	12"	April-May	☉●	4.5	5.95
Heuchera	Coral Bells						
Clump forming plants with round leaves. Foliage is attractive and very effective in the border. Bell shaped flowers appear in mid summer on panicles above the foliage. Heuchera prefer well drained organic soil and dark leafed varieties will tolerate full sun if moisture is available.							
americana 'Dale's Strain' Unique, silver blue marbled foliage with white flowers in spring.		12"	12"	May-June	☼☉	#1	7.95
☼ 'Berry Timeless' (PPAF) A myriad of light pink flowers which age to a deeper rose. Leaves are lightly silvered, mint green.		12"	18"	May-July	☼☉	#1	9.95
'Caramel' (PP16560) Fuzzy, bright yellow-orange leaves with purple-red undersides. Compact habit. Cream flowers.		12"	15"	May-July	☼☉	#1	9.95
'Citronelle' (PP17934) In heavy shade, the citron yellow foliage will turn chartreuse. Cream colored flowers.		12"	15"	May-July	☉	#1	9.95
'Crimson Curls' Distinctively curly, crimson foliage. Color intensifies in spring.		15"	12"	May-July	☼☉	#1	9.95
'Georgia Peach' (PP19375) Glowing peach colored leaves with a light silver overlay. Creamy white flowers.		14"	15"	May-July	☼☉	#1	9.95
'Hercules'® Bright green leaves with heavy white marbling. Deep red flowers.		15"	15"	May-July	☼☉	#1	9.95
'Lime Marmalade' (PP21861) Heavily ruffled, lime green to chartreuse leaves. Tan flowers.		10"	15"	May-July	☉	#1	9.95
'Marmalade' (PP15945) Shiny, undulating leaves in eye-catching shades of peach and honey with bright purple undersides. Red buds open to white flowers.		10"	15"	May-July	☼☉	#1	9.95
'Midnight Rose' (PP18551) This unique sport of 'Obsidian' has deep purple-black leaves that are splashed with hot pink in spring. The spots lighten to creamy pink as the season progresses.		10"	15"	May-July	☼☉	#1	9.95
m. 'Palace Purple' Bronze foliage, small white flowers.		15"	12"	May-July	☼☉	4.5	4.95
=== 1991 PPA Plant of the Year ===						#1	7.95
'Obsidian' (PP14836) The blackest Heuchera, with smooth, shiny, rounded leaves. Holds its color all season. Cream flowers.		10"	12"	May-June	☼☉	#1	9.95
'Plum Pudding' Compact plant with silvery plum-purple foliage. Dainty cream colored flowers.		12"	12"	May-June	☼☉	#1	9.95
sanguinea Bressingham Hybrids A mix of pink to red flowers over green foliage.		15"	12"	May-July	☼☉	4.5	4.95
s. 'Firefly' Scarlet flowers above dark green foliage.		15"	12"	May-July	☼☉	4.5	4.95
'Stormy Seas' Very serrated and ruffled bronze purple foliage with light rose flowers.		16"	12"	May-June	☼☉	4.5	6.95

☼ sun ☉ part shade ● shade ☼ new variety (H) height (S) spacing (TP) tender perennial N native

Shady Acres Perennial Nursery

New Berlin, Wisconsin

262-679-1610

Genus	Common Name						Perennials	
Species/Variety		(H)	(S)	Bloom	Loc.	Size	Price	
Heucherella	Foamy Bells							
Heucherella is a cross between Tiarella (Foam Flower) and Heuchera (Coral Bells), hence Foamy Bells. Excellent plant for the border and also well suited for container gardens.								
'Gold Zebra' (PP22104)	Shocking golden yellow leaves display a heavy smattering of bright red. Small white flowers.	10"	15"	May-June	☉●	#1	9.95	
☺ 'Pink Fizz' (PPAF)	Large, deeply lobed, soft green leaves are lightly silvered with prominent purple veins. Pure pink flowers pop open from hot pink buds.	10"	15"	May-June	☉	#1	9.95	
'Sweet Tea' (PP21296)	Foliage is apricot orange with a burgundy center blotch in spring. Darkens to coppery orange and cinnamon tones in summer. White flowers.	20"	15"	May-June	☉	#1	9.95	

Hierochloe (Sweetgrass) see Herbs List

Hollyhock see Alcea

Hosta

Low maintenance and bold foliage help make this the perfect shade and part shade perennial. Variegated types are better for shady areas, while green and yellow types can withstand more sun. Blue varieties usually have thicker substance and keep their color best in full shade.

The American Hosta Growers Association established the AHGA Hosta of the Year in 1996.

see **Hosta** size and foliage type chart on pages 34 & 35...

'Abiqua Drinking Gourd'	L	Interesting round, puckered, intensely cupped shaped leaf. Great specimen plant.	4.5	14.95
=== 2014 AHGA Hosta of the Year ===				
'Adorable' (PPAF)	M	Fragrant white flowers over glossy green leaves that have very defined chartreuse centers. Sport of <i>H. 'Royal Standard'</i> . Can handle some sun.	4.5	14.95
'Afterglow' (PPAF)	L	Large, green heart-shaped leaves with incredibly striking, wide, yellow margins.	4.5	14.95
'Allan P. McConnell'	S	Narrow, dark green leaves edged in white. Forms neat clumps.	4.5	6.95
'Alligator Shoes'	M	Seer-suckered leaves. Frosty blue-green with white margins.	4.5	14.95
'American Hero' (PP23587)	M	Wide dark green margins with a white center speckled in green. Supports GreenCare for Troops.	4.5	14.95
'Antioch'	M	Wide, creamy-white edge on medium-green leaves.	4.5	6.95
☺ 'Atlantis'	L	Long, dark green ruffled leaves with dramatic golden yellow margin.	4.5	14.95
'August Moon'	M	Large, rounded, uniformly crinkled golden leaves that hold their color all year. Near white flowers.	4.5	6.25
'Autumn Frost' (PP23224)	M	Incredibly showy hosta! In spring, leaves are frosty blue with radiant yellow margins. Later, the leaves turn green with creamy white margins.	#1	9.25
			#1	19.95
'Beach Boy'	M	A vigorous grower with slug resistant leaves. Foliage has soft yellow centers with blue-green margins.	4.5	14.95
'Big Daddy'	L	Rich blue-green leaves, heavily corrugated. Near white flowers.	#1	12.95
'Blue Angel'	L	Huge, deep blue leaves. Very heavy texture. Glossy white flowers.	#1	11.95
'Blue Cadet'	S	Heavy blue-green foliage. Makes large rounded clumps. Lavender flowers.	4.5	6.95

☼ sun ☉ part shade ● shade ☺ new variety (H) height (S) spacing (TP) tender perennial N native

Shady Acres Perennial Nursery

New Berlin, Wisconsin

262-679-1610

Genus	Common Name		(H)	(S)	Bloom	Loc.	Perennials	Size	Price
Species/Variety									
Hosta		(continued)							
'Blue Ivory'	M	This 'Halcyon' sport has wide creamy white margins and blue center in spring. Margins brighten to white in summer.						4.5	14.95
(PP19623)									
'Blue Mouse Ears'	VS	Blue rounded, thick leaves with lavender flowers. Compact.						4.5	14.95
=== 2008 AHGA Hosta of the Year ===									
'Bressingham Blue'	M	Cupped, heart-shaped,blue-green leaves of heavy substance. White flowers.						#1	11.95
'Brim Cup'	S	Rich green leaves with wide irregular margins.						4.5	11.95
☺ 'Brother Stefan'	M	Foliage changes from chartreuse with blue margins to gold with green margins. Heavy, puckered leaves.						4.5	14.95
'Cathedral Windows'	L	Grows quickly to form a large clump of rounded bright gold leaves with very wide, dark green margins. Large, fragrant near white flowers.						4.5	14.95
(PP17295)									
☺ 'Christmas Candy'	M	Medium green lance-shaped leaves have wide white centers. A rapid grower.						4.5	14.95
☺ 'Church Mouse'	S	Forms a cute miniature clump of blue-green to green thick, wavy leaves.						4.5	14.95
'Climax'	L	Very showy! The dark green leaves with bright gold margins exhibit nice corrugation and are of good substance.						4.5	14.95
☺ 'Coast to Coast'	XL	Emerges chartreuse yellow, turning lighter gold in summer. Thick, puckered, wavy leaves form an upright vase-shaped clump.						#1	19.95
(PPAF)									
☺ 'Curly Fries'	S	Extremely rippled, narrow leaves. Bright chartreuse foliage is best grown in morning sun.						4.5	14.95
=== 2016 AHGA Hosta of the Year ===									
'Dancing Queen'	M	Exceptionally unique! Leaves emerge bright yellow and remain yellow all season. Large leaves have a prominent pie crust edge.						4.5	14.95
'Deja Blu'	M	Striking hosta... blue-green leaves with creamy bolt between center and yellow margins.						4.5	14.95
'Diamond Tiara'	M	Medium green with a narrow white band on the margins. Wavy edge. Lavender flowers.						4.5	6.95
☺ 'Diamonds are Forever'	S	Green leaves with a wide, crisp white margin. Sharply contrasting variegation really shows up, even from a distance. Purple flowers.						4.5	14.95
☺ 'Dream Queen'	L	Large, nearly round bluish-green leaves with creamy white centers. White flowers.						4.5	14.95
'Earth Angel'	L	Large heart shaped leaves; blue green with yellow edges. Margins turn creamy white as season progresses. Light lavender flowers. == 2009 AHGA Hosta of the Year ==						4.5	14.95
☺ 'El Nino'	M	Very blue leaves are edged in bright white. White flowers.						4.5	14.95
☺ 'Electrocution'	M	Distinctive hosta with an upright mounded habit. Tightly rippled, twisted, long and narrow leaves are green with creamy yellow margins.						4.5	14.95
'Empress Wu'	XL	This very, very large hosta will create conversation in your shade garden! Huge dark green deeply veined leaves can measure more than 18 inches wide and long. Strongly upright habit, forming a very tall and wide clump.						#1	19.95
(PP20774)									
☺ 'Fantabulous'	M	Wavy, dark green leaves with very wide creamy white margins that streak toward the center.						4.5	14.95
'Fire & Ice'	M	This spectacular sport of 'Patriot' has pure white centers surrounded by a very deep green margin.						4.5	14.95
'Fire Island'	M	Brilliant yellow leaves emerge on red petioles! During the summer, the foliage will cool to dark chartreuse. Grows best in full shade.						4.5	14.95

☼ sun ☺ part shade ● shade ☺ new variety (H) height (S) spacing (TP) tender perennial N native

Shady Acres Perennial Nursery

New Berlin, Wisconsin

262-679-1610

30

Genus	Common Name		(H)	(S)	Bloom	Loc.	Perennials	Size	Price
Species/Variety									
Hosta		(continued)							
☺	'Firn Line'	M	Heart shaped leaves have a very wide white margins and blue centers. Striking!					4.5	14.95
☺	'Forbidden Fruit'	M	Thick leaves have glowing yellow centers set off by blue-green edges.					4.5	14.95
f.	'Aureo-marginata'	M	Deep-green foliage with a matte sheen. Creamy yellow edge. Lavender flowers.					4.5	6.25
	'Fragrant Bouquet'	M	Apple green leaves with wide irregular yellow-white margins. Large funnel shaped, fragrant white flowers.					4.5	6.95
== 1998 AHGA Hosta of the Year ==									
	'Francee'	M	Shiny dark green foliage with a narrow white edge. Lavender flowers.					4.5	6.95
	'Frances Williams'	L	Blue-green, corrugated with yellow margin. White flowers.					4.5	6.95
	'Fried Bananas'	L	Glossy chartreuse leaves grace this plant that quickly forms a large mound. Fragrant white flowers.					4.5	14.95
	'Ginko Craig'	S	Dark green foliage with white margin. Purple flowers.					4.5	6.95
	'Gold Edger'	S	Gold foliage with heavy substance. White flowers.					4.5	6.25
	'Gold Standard'	M	Creamy yellow foliage with dark green margin. Pinkish-lavender flowers.					4.5	6.95
	'Golden Tiara'	S	Green with wide chartreuse margin. Lavender flowers.					4.5	6.25
	'Grand Tiara'	S	This sport of H. 'Golden Tiara' has a wider and more pronounced bright gold margin with a narrow dark green center. Rapid grower.					4.5	11.95
	'Great Escape'	M	Oval shaped blue-green leaves set off with white edges.					4.5	14.95
	(PP19003)		White flowers.						
	'Great Expectations'	L	Blue/green margin with creamy yellow center. White flowers.					4.5	14.95
	'Guacamole'	L	Chartreuse leaves are margined by the wide green edge. Large fragrant flowers open in August. Outstanding.					4.5	14.95
☺	'Gypsy Rose'	M	Oval leaves are dark green with dazzling yellow centers and white stripes. A sport of H. 'Striptease'.					4.5	14.95
	'Halcyon'	M	Spear shaped, intense blue, with heavy substance. White flowers.					4.5	6.95
☺	'Hudson Bay'	L	Wide, bright blue margins and apple-green jetting contrast with creamy white centers. Near-white flowers.					4.5	19.95
	(PP23598)								
	'Humpback Whale'	XL	Giant sized plant. Forms a massive, dome-shaped mound of blue-green, corrugated, heart shaped leaves.					4.5	14.95
	'Ice Follies'	M	Showy dark green leaves show off a pure creamy white margin. Long, pointed leaves.					4.5	14.95
	'Inniswood'	L	Rounded gold foliage with a wide deep green edge. Lavender flower on 30" scapes.					4.5	14.95
	'Island Breeze'	M	Wide, green margins contrast with bright yellow centers. Showy red petioles with dark lavender flowers.					4.5	14.95
☺	'Joy Ride'	M	Very wavy, blue-green leaves accented by upright folded edges. Very fun texture for shade gardens!					4.5	14.95
	'June'	M	Creamy centered foliage changing to chartreuse, blue margins.					4.5	14.95
== 2001 AHGA Hosta of the Year ==									
	'Krossa Regal'	L	Heavy textured, powdery blue foliage. Upright habit. Lavender flowers.					4.5	6.95
	'Lakeside Dragonfly'	L	Pointed blue-green leaves with irregular white margins. Fast grower.					4.5	14.95

☼ sun ☺ part shade ● shade ☺ new variety (H) height (S) spacing (TP) tender perennial N native

Shady Acres Perennial Nursery

New Berlin, Wisconsin

262-679-1610

Genus Species/Variety	Common Name				Perennials	
	(H)	(S)	Bloom	Loc.	Size	Price
Hosta (continued)						
'Lakeside Paisley Print'	S		Stunning small hosta! Thick, heart shaped leaves with very wide, wavy green margins. Narrow creamy white markings on the leaves shoot out in a feathery pattern.		4.5	14.95
<i>lancifolia</i>	M		Shiny green, lance shaped foliage. See it planted as an edging in our display gardens!		#1	8.95
'Liberty' (PP12531)	L		Green leaves with wide, jetting, yellow margins which lighten to creamy white. Sport of 'Sagae'. == 2012 AHGA Hosta of the Year ==		4.5	14.95
☺ 'Maui Buttercups'	S		Bright gold, rounded leaves are cupped and corrugated. Near-white flowers.		4.5	14.95
'Mighty Mouse'	S		Mouse ear-shaped leaves emerge blue-green with a creamy yellow edge. Changes to grey-green with creamy white edge in summer. So cute!		4.5	14.95
☺ 'Moon Split'	M		Shiny leaves have a dark green stripe in the center, and creamy yellow margins. White flowers.		4.5	14.95
☺ 'Morning Star'	M		Leaves have a creamy white-flamed centers with green margins.		4.5	14.95
<i>montana</i> 'Aureo-marginata'	L		Dark green, pointed leaves with bright yellow margin. Upright, vase-like habit. Pale lavender flowers.		4.5	11.95
'Night Before Christmas'	ML		Velvety thick green leaves and a striking white center. Larger, better plant than <i>H. 'White Christmas'</i> .		4.5	14.95
'Parky's Prize'	M		Sport of <i>H. 'Birchwood Park's Gold'</i> with a dark blue-green center and gold edge. Excellent vigor.		4.5	14.95
'Patriot'	M		Similar to 'Francee' except very wide white margin. Medium violet flowers. == 2005 WNA Plant of the Year ==		#1	19.95
☺ 'Paul's Glory'	M		Heart-shaped leaves have a distinct blue-green margin with a gold center. === 1999 AHGA Hosta of the Year ===		4.5	6.95
<i>plantaginea</i>	M		(August Lily) Very shiny green foliage. Large fragrant white flowers in late summer.		#1	9.95
'Prairie Sky' (PP17309)	M		One of the bluest hostas available! Powdery blue, lightly cupped leaves of thick substance.		4.5	14.95
'Praying Hands'	M		Upright, narrow folded leaves resemble hands folded in prayer. Dark green leaves, heavily rippled, gold margins. == 2011 AHGA Hosta of the Year ==		4.5	14.95
'Radiant Edger'	S		Dark green leaves with wide gold margins. Lavender flowers. Rapid growth rate.		4.5	14.95
'Rainbow's End' (PP17251)	M		Incredibly variegated, shiny foliage. Bright yellow leaves have dark green margins that jet into the center. In summer, centers brighten to creamy white and red scapes carry dark lavender, tubular flowers.		4.5	14.95
'Regal Splendor'	XL		Blue-green leaves with contrasting creamy margin. Vase-shaped, upright form. A sport of <i>H. 'Krossa Regal'</i> .		4.5	14.95
'Regal Supreme' (PP19818)	L		Sport of 'Krossa Regal'. Frosty blue leaves with wide margins of creamy yellow.		4.5	14.95
'Remember Me'	S		Bright creamy center framed by a blue-green margin. Its smaller size makes it perfect for small areas or the front of the border. The white centers brighten up dark areas.		4.5	14.95
'Rhino Hide' (PPAF)	L		The thickest leaves of any hosta!! Super resistant to slugs. Cupped, puckered leaves have wide, blue margins and a narrow light green center that brightens to yellow.		4.5	14.95
'Royal Standard'	M		Glossy green foliage. Fragrant white flowers.		4.5	5.95
☺ 'Sagae'	L		Very striking blue-green leaves with creamy yellow margin. Upright habit. Near white flowers. Exhibits some sun tolerance. == 2000 AHGA Hosta of the Year ==		4.5	14.95

☼ sun ☺ part shade ● shade ☺ new variety (H) height (S) spacing (TP) tender perennial N native

Shady Acres Perennial Nursery

New Berlin, Wisconsin

262-679-1610

Genus Species/Variety	Common Name		(H)	(S)	Bloom	Loc.	Perennials	
							Size	Price
Hosta	<i>(continued)</i>							
'Sergeant Pepper'	M	Wavy, corrugated foliage is medium green in the center surrounded by wide gold margins.					4.5	14.95
sieboldiana 'Elegans'	L	(Blue Giant) Heavy-textured, blue-green foliage. White flowers.					4.5 #1	6.95 9.95
'So Sweet'	M	Green, lance-shaped leaves with white margins. Fragrant white flowers.					4.5	6.95
☺ 'Spartacus'	L	Large, blue-green leaves with wide yellow margins. Nicely ruffled edges.					4.5	14.95
'Stained Glass'	L	Brilliant gold leaves with dark green margins. Prominent veins in the leaf give it the look of stained glass. Fragrant, pale lavender flowers. = 2006 AHGA Hosta of the Year =					4.5	14.95
'Stiletto'	VS	Long narrow wavy leaves with thin white margins. Growth habit lends itself for use in borders. Purple flowers.					4.5	6.95
☺ 'Stirfry'	M	Clear green shiny leaves with wavy margins and stunning rippled edges.					4.5	14.95
☺ 'Striptease'	M	Wide dark green margin surrounds chartreuse center. It was named striptease because a white strip appears between the green and gold. == 2005 AHGA Hosta of the Year =					4.5	14.95
'Sum and Substance'	XL	Chartreuse-gold, heavy substance leaves with a waxy sheen. === 2004 AHGA Hosta of the Year ===					#1	12.95
☺ 'Summer Breeze'	M	Dark green leaves have a sheen to them, and show off contrasting wide streaky yellow margins.					4.5	14.95
'Sun Power'	L	One of the very best gold hostas. Features unique twisted and pointed golden leaves that rapidly grow into a beautiful clump. Holds color in considerable sun.					4.5	11.95
'Sweet Home Chicago'	M	Sport of <i>H. 'Birchwood Park's Gold'</i> with a dark blue-green edge and bright gold center. Excellent vigor. Nice in combination with <i>H. 'Parky's Prize'</i> which is the same plant with the opposite variegation pattern.					4.5 #1	14.95 19.95
'T. Rex'	XL	Monster-sized leaves can reach a size of 18" x 14"! Leaves are green, slightly wavy and have a matte finish. Large near-white flowers.					4.5	14.95
'Thunderbolt'	L	Yellow-cream leaves with wide blue-green margins. Strong grower with fragrant white flowers					4.5	11.95
☺ 'Touch of Class'	M	(PP14232) Intense blue leaves with gold flame in center have incredibly thick substance and are held upright. Slug resistant.					4.5	14.95
☺ 'Twist of Lime'	S	(PP13080) Bright gold lance-shaped leaves with a green edge. Vigorous grower.					4.5	14.95
undulata 'Albo-marginata'	M	Medium green with white creamy-white margin. Lavender flowers.					4.5 #1	5.95 8.95
undulata 'Variegata'	M	Medium green with white centers. Twisted leaves. Lavender flowers.					4.5 #1	5.95 8.95
'Victory'	L	Shiny green leaves of good substance display yellow margins which lighten to pale yellow. Slower grower...although it is a large size hosta, it does take some years to develop the huge leaves and distinctive variegation that make it so special. == 2015 AHGA Hosta of the Year ==					4.5	14.95
'Wheee!'	M	(PP23565) Extremely ruffled, cream colored margins on green leaves. Thicker leaves are slug resistant.					#1	19.95
☺ 'White Feather'	M	First emerges with pointy ivory-cream leaves, later develops green stripes. Does not tolerate sun.					4.5	14.95
'Wide Brim'	M	Green with wide, white margin. Lavender flowers.					4.5	6.95
☺ 'Wishing Well'	L	Large blue hosta that is quite sun tolerant. Huge, thick leaves are attractively cupped, rippled and corrugated.					4.5	14.95

☼ sun ☺ part shade ● shade ☺ new variety (H) height (S) spacing (TP) tender perennial N native

Shady Acres Perennial Nursery

New Berlin, Wisconsin

262-679-1610

Genus	Common Name					Perennials
Species/Variety		(H)	(S)	Bloom	Loc.	Size Price

Hosta

Low maintenance and bold foliage help make this the perfect shade and part shade perennial. Variegated types are better for shady areas, while green and yellow types can withstand more sun. Blue varieties usually have thicker substance and keep their color best in full shade.

The table shown on these two pages is a quick reference that categorizes the Hostas available at Shady Acres by leaf color and mature foliage clump size.

Mature foliage size: **VS**=Very Small 3-6"; **S**=Small 6-12"; **M**=Medium 12-24"; **L**=Large 24-36"; **XL**=Extra-Large 36"+

	S	M	L
VARIEGATED TYPES	'Lakeside Paisley Print' 'Remember Me' 'Twist of Lime'	'Adorable' 'American Hero' 'Beach Boy' 'Brother Stefan' 'Christmas Candy' 'Fire & Ice' 'Forbidden Fruit' 'Gold Standard' 'Gypsy Rose' 'Island Breeze' 'June' 'Morning Star' 'Paul's Glory' 'Rainbow's End' 'Striptease' 'Sweet Home Chicago' 'Touch of Class' undulata 'Variegated' 'White Feather'	'Cathedral Windows' 'Dream Queen' 'Great Expectations' 'Guacamole' 'Hudson Bay' 'Inniswood' 'Night Before Christmas' 'Rhino Hide' 'Stained Glass' 'Thunderbolt'
BLUE SHADES	'Blue Cadet' 'Blue Mouse Ears' (VS) 'Church Mouse'	'Bressingham Blue' 'Halcyon' 'Joy Ride' 'Prairie Sky'	'Abiqua Drinking Gourd' 'Big Daddy' 'Blue Angel' 'Krossa Regal' sieboldiana 'Elegans' 'Wishing Well'
YELLOW / GOLD SHADES	'Curly Fries' 'Gold Edger' 'Maui Buttercups'	'August Moon' 'Dancing Queen' 'Fire Island'	'Coast to Coast' (XL) 'Fried Bananas' 'Sum and Substance' (XL) 'Sun Power'

☼ sun ☉ part shade ● shade ☼ new variety (H) height (S) spacing (TP) tender perennial N native

Shady Acres Perennial Nursery

New Berlin, Wisconsin

262-679-1610

Genus	Common Name	(H)	(S)	Bloom	Loc.	Perennials	Size	Price
Species/Variety								

Hosta

Mature foliage size: VS=Very Small; 3-6"; S=Small 6-12"; M=Medium 12-24"; L=Large 24-36"; XL=Extra-Large 36"+

	S	M	L
GREEN SHADES		lancifolia plantaginea 'Royal Standard' 'Stirfry'	'Empress Wu' (XL) 'Humpback Whale' (XL) 'T. Rex' (XL)
CREAM / GOLD MARGINS	'Golden Tiara' 'Grand Tiara' 'Mighty Mouse' 'Radiant Edger'	'Autumn Frost' 'Deja Blu' 'Electrocution' fortunei 'Aureo-marginata' 'Fragrant Bouquet' 'Moon Split' 'Parky's Prize' 'Praying Hands' 'Sergeant Pepper' 'Summer Breeze' 'Wheee!'	'Afterglow' 'Atlantis' 'Climax' 'Earth Angel' 'Frances Williams' 'Liberty' montana 'Aureo-marginata' 'Regal Splendor' (XL) 'Regal Supreme' 'Sagae' 'Spartacus' 'Victory'
WHITE MARGINS	'Allan P. McConnell' 'Brim Cup' 'Diamonds are Forever' 'Ginko Craig' 'Stiletto' (VS)	'Alligator Shoes' 'Antioch' 'Blue Ivory' 'Diamond Tiara' 'El Nino' 'Fantabulous' 'Firn Line' 'Francee' 'Great Escape' 'Ice Follies' 'Patriot' 'So Sweet' undulata 'Albo-marginata' 'Wide Brim'	'Lakeside Dragonfly'

Houttuynia

Lizard's Tail

cordata 'Chameleon' Groundcover with red, cream and green foliage. Spreads via underground runners. 10" 12" June-July ☼● 4.5 4.95

Hydrangea see Vines List

Hypericum

St. John's Wort

calycinum Large yellow flowers that seem to glow. Likes partial shade. 12" 18" June-July ☼☉ 4.5 4.95

☼ sun ☉ part shade ● shade ☺ new variety (H) height (S) spacing (TP) tender perennial N native

Shady Acres Perennial Nursery

New Berlin, Wisconsin

262-679-1610

Genus	Common Name					Perennials	
Species/Variety		(H)	(S)	Bloom	Loc.	Size	Price

Iberis

Candytuft

Low growing woody stemmed evergreen plant. The flowers are single, pure white and develop in 2-3" clusters. One of the earliest spring flowering perennials. Drainage is important to survive the winter.

'Alexander's White' Shiny dark green foliage. Very dense grower. Evergreen. 8" 15" April-May ☼☉ 4.5 4.95

Imperata (Japanese Blood Grass) see Grasses List

Iris

pallida 'Albo-Variegata' Blue-green leaves with white streaking, fragrant lavender blue flowers. 24" 15" June-July ☼ #1 9.95

pallida 'Variegata' Blue-green leaves with yellow streaking, fragrant lavender blue flowers. 24" 15" June-July ☼ #1 9.95

N versicolor (Blue Flag Iris) Blue flowers. Performs best in moist areas. 30" 15" May-June ☼ 4.5 5.95

Iris ensata

Japanese Iris

Ensata types are the iris group latest to bloom, about a month after the Tall Bearded and Siberian Iris. They have the largest flowers of all groups with very interesting color combinations. These iris prefer full sun and ample water.

'Sensation' Rich purple with yellow centers, double flowers. 32" 15" June-July ☼ #1 9.95

'Variegata' Variegated leaves, purple flowers. 30" 15" June-July ☼ #1 9.95

Iris germanica

Tall Bearded Iris

This group of iris is not particular about soil but definitely prefers a sunny location. Can withstand dry conditions and soggy soils should be avoided. Blooms early summer.

'Again & Again' Bright yellow flowers, reblooms. 36" 15" June, Sept ☼ #1 9.95

☺ 'Clarence' Pale violet-blue flowers are ruffled with white beards. Reblooms! 35" 15" June, Sept ☼ #1 9.95

'Coal Seams' Flowers are nearly as black as coal! Thick, velvety and ruffled petals glimmer in the sun. 40" 18" June ☼ #1 9.95

☺ 'Lenora Pearl' Salmon-pink self, with tangerine colored beards. Rebloomer. 28" 15" June, Sept ☼ #1 9.95

'Immortality' Pure white self with light lemon yellow beards. Vigorous grower. Reblooms in fall. 29" 15" June, Sept ☼ #1 9.95

☺ 'Jurassic Park' Canary yellow and purple flowers with a slight, sweet fragrance. 36" 15" June ☼ #1 9.95

☺ 'Orange Harvest' Bright orange, fragrant flowers. Reblooms in fall. 32" 15" June, Sept ☼ #1 9.95

☺ 'Speeding Again' Dark blue-violet flowers. Rebloomer. 38" 15" June, Sept ☼ #1 9.95

☺ 'Superstition' One of the darkest iris! Near black flowers. 34" 15" June ☼ #1 9.95

'Swingtown' A fragrant selection with rich mulberry (deep purple-red) self and purple beards. 36" 15" June ☼ #1 9.95

'War Chief' Beautiful red flowers. Very long bloom season. 37" 15" June ☼ #1 9.95

☼ sun ☉ part shade ● shade ☺ new variety (H) height (S) spacing (TP) tender perennial N native

Shady Acres Perennial Nursery

New Berlin, Wisconsin

262-679-1610

Genus Species/Variety	Common Name	(H)	(S)	Bloom	Loc.	Perennials	
						Size	Price
Iris pumila	Dwarf Iris						
Pumila types are miniature Bearded Iris and require the same attention, or lack thereof. Not particular about soil but require a sunny location. Can also withstand dry conditions. Blooms earlier.							
'Baby Blessed'	Light yellow flowers in the spring and again in fall. Rated as the best reblooming miniature iris.	12"	10"	April-May, Sept	☼	4.5	5.95
'Blue Denim'	Light blue flowers.	14"	10"	April-May	☼	4.5	5.95
'Cherry Garden'	Velvety red flowers.	12"	10"	April-May	☼	4.5	5.95
Iris sibirica	Siberian Iris						
Siberian types are excellent for landscaping. They tolerate nearly any soil and are drought tolerant after they are established. Ideal plant for full sun and moist soil. They bloom after the Bearded Iris and before the Japanese Iris.							
'Butter and Sugar'	Butter yellow and white flowers.	28"	15"	June-July	☼	4.5	6.25
'Caesar's Brother'	Rich deep violet-blue flowers.	36"	15"	June-July	☼	4.5	6.25
'Shirley Pope'	Large, rich, velvety dark violet blue flowers.	30"	15"	June-July	☼	4.5	#1 9.25
	Recent recipient of the Morgan-Wood Medal, the highest award bestowed by the Siberian Iris Society.						6.25
'Silver Edge'	Sky-blue with silver edge flowers.	24"	15"	June-July	☼	4.5	6.25
'White Swirl'	Large, pure white flowers.	36"	15"	June-July	☼	4.5	6.25
Kalimeris	Japanese Aster						
☺ i. 'Daisy Mae'	Petite, white flowers cover a compact mound of green foliage. A must for the butterfly garden!	24"	18"	July-Aug	☼	4.5	5.95
yomena 'Shogun'	Yellow edged variegation fades through the growing season. Spreading habit. Lavender Aster-like flowers.	12"	18"	July-Sept	☼☺	4.5	5.95
Kirengeshoma	Yellow Waxbells						
palmata	Shrub-like plant with maple like leaves. Waxy yellow, funnel-shaped flowers, 1-2" long.	30"	24"	Sept	☼●	#1	9.95
Knautia							
macedonica 'Mars Midget'	A profusion of brilliant ruby-red flowers from June into fall on compact, dwarf plants. Attractive to butterflies. Zone 5	16"	12"	June-Sept	☼☺	4.5	4.95
Kniphofia	Red Hot Poker						
hirsuta 'Fire Dance'	Coral red and yellow flower spikes atop a thick clump of narrow, arching, blue-green foliage. Hardy to zone 4. Deer resistant.	20"	15"	June-Aug	☼	4.5	5.95
Lamium	Yellow Archangel						
Excellent groundcover for dry, shady areas.							
galeobdolon 'Herman's Pride'	Silvery spotted foliage. Clump forming.	12"	12"	May-June	☼●	4.5	4.95
g. 'Florentinum' (variegatum)	Spreading groundcover. Yellow flowers with variegated foliage.	8"	12"	May-June	☼●	4.5	4.95

☼ sun ☺ part shade ● shade ☺ new variety (H) height (S) spacing (TP) tender perennial N native

Shady Acres Perennial Nursery

New Berlin, Wisconsin

262-679-1610

Genus	Common Name					Perennials	
Species/Variety		(H)	(S)	Bloom	Loc.	Size	Price
Lamium	Dead Nettle						
Excellent groundcover for adding color to shaded areas. Both foliage and flowers provide the contrast. Plants do best in part shade, but will tolerate deeper shade. Don't let Lamium get too wet or they will rot out.							
maculatum 'Beacon Silver'	Silvery leaves with narrow green margins, rose-pink flowers.	6"	12"	May-July	☉●	4.5	4.95
m. 'Chequers'	Marbled foliage with rose-pink flower.	8"	12"	May-July	☉●	4.5	4.95
m. 'Pink Pewter'	Clear pink form of 'White Nancy'.	6"	12"	May-July	☉●	4.5	4.95
m. 'Shell Pink'	Green and white variegated foliage with soft pink flowers.	8"	12"	May-July	☉●	4.5	4.95
m. 'White Nancy'	Nearly all silver leaves with narrow blue-green margins. Pure white flowers.	8"	12"	May-July	☉●	4.5	4.95
Lathyrus	Perennial Sweet Pea						
A climbing, scrambling vine with gray-green foliage and clusters of pea like blossoms.							
latifolius	Mixed colors.	60"	24"	July-Aug	☼	4.5	4.95
Lavendula	Lavender						
Fragrant herb with gray green lance shaped foliage. A well drained site is needed for Lavender to be hardy here.							
angustifolia 'Hidcote'	Midnight blue flowers.	15"	15"	June-Sept	☼	4.5	4.95
a. 'Jean Davis'	Pale pink flowers.	18"	15"	June-Sept	☼	4.5	4.95
a. 'Munstead'	Lavender flowers, silver foliage.	15"	15"	June-Sept	☼	4.5	4.95
i. 'Provence'	The best variety for bouquets, potpourri and culinary use. Narrow, light blue flower spikes have a sweet fragrance. Forms a 3 ft. hedge-like shrub.	36"	24"	June-Sept	☼	4.5	4.95
x i. PHENOMENAL™ (PP24193)	Forms a very large uniform, dense mound of silvery green foliage topped with tall wands of rich purple flowers.	24"	48"	July-Sept	☼	#1	9.95
Leontopodium	Edelweiss						
alpinum	Narrow wooly white foliage with creamy white flowers. Great rock garden plant.	6"	8"	June-Sept	☼	4.5	4.95
Leptinella	Brass Buttons						
☼ s. 'Platt's Black'	An excellent groundcover. Delicate fern-like foliage is accented with smokey grey tones. Tolerates moderate foot traffic.	3"	12"	June-July	☉	4.5	4.95
Liatris	Blazing Star / Gay Feather						
Tall spikes of flowers emerge from tufts of glossy linear leaves. Excellent cut flowers. Prefers a moderately fertile, sandy soil. Easy to grow. Flowers in mid to late summer.							
N aspera	(Rough Blazing Star) Striking bright magenta spike flowers adorn this prairie wildflower. Seeds are loved by finches. Needs good drainage, tolerates dry soils.	30"	15"	July-Sept	☼	4.5	5.95
N pycnostachya	Native, tallest species, rosy-purple flowers.	48"	15"	July-Sept	☼	4.5	5.95
N spicata	Purple flowers.	30"	15"	July-Sept	☼	4.5	4.95
						#1	7.95
s. 'Alba'	White flowers.	30"	15"	July-Sept	☼	4.5	4.95
						#1	7.95
s. 'Kobold'	Shorter variety, rose-lavender flowers.	18"	15"	July-Sept	☼	4.5	4.95
						#1	7.95

☼ sun ☉ part shade ● shade ☉ new variety (H) height (S) spacing (TP) tender perennial N native

Shady Acres Perennial Nursery

New Berlin, Wisconsin

262-679-1610

Genus	Common Name					Perennials	
Species/Variety		(H)	(S)	Bloom	Loc.	Size	Price
Ligularia Bigleaf Golden Ray / Ragwort							
Impressive plants with large leaves. Flowers on 'Little Lantern', 'Little Rocket', przewalskii and 'The Rocket' are tall spikes above the foliage. The others are loaded with daisy like flowers. Ligularias need constant moisture for best performance.							
'Bottle Rocket' (PPAF)	Excellent garden performer.	30"	24"	July-Sept	☉●	#1	9.95
Perfectly proportional plant forms a dense clump of thick, serrated green leaves with mustard yellow flower spikes held on chocolate stems just above the foliage.							
dentata 'Brit-Marie Crawford' (PP16113)	Glossy chocolate maroon foliage. Golden orange daisy-like flowers.	32"	24"	July-Sept	☉●	#1	12.95
d. 'Desdemona'	Orange-yellow daisy-like flowers.	36"	24"	July-Sept	☉●	#1	9.95
d. 'Othello'	Golden yellow flowers with purple leaves.	36"	24"	July-Sept	☉●	#1	9.95
'Little Rocket' (PP14621)	Dwarf form of L. 'The Rocket'.	40"	24"	July-Sept	☉●	#1	9.95
Yellow flower spikes with heart shaped leaves.							
przewalskii	Tall dark yellow spike flowers.	60"	24"	June-July	☉●	#1	9.95
stenocephala 'The Rocket'	Golden yellow spikes.	60"	24"	July-Sept	☉●	#1	9.95

Lilium Hardy Lily

Hardy Lilies are excellent for containers and garden use. Many of our lilies are the short varieties, which don't require staking in the garden. The oriental lilies have larger flowers and are fragrant. Excellent cut flower.

Asiatic Hybrids:

'Blackout'	Very dark, almost black flowers.	36"	18"	June-July	☼	4.5	5.95
'Crimson Pixie' (PP6557)	Pure red flowers.	14"	18"	June-July	☼	4.5	5.95
'Elgrado'	Cherry red flowers.	18"	18"	June-July	☼	4.5	5.95
'Lemon Pixie' (PP6367)	Lemon yellow flowers.	18"	18"	June-July	☼	4.5	5.95
'Lollypop'	Upward facing flowers with carmine red petal ends set against a large white center.	24"	18"	June-July	☼	4.5	5.95
'New Wave'	Pure white flowers.	20"	18"	June-July	☼	4.5	5.95
'Orange Pixie'	Orange flowers.	18"	18"	June-July	☼	4.5	5.95
'Pink Pixie' (PP6476)	Pink flowers.	18"	18"	June-July	☼	4.5	5.95

Oriental Hybrids:

'Casa Blanca'	Pure white flowers, fragrant.	48"	18"	June-July	☼	4.5	5.95
'Mona Lisa' (PP7379)	Pink flowers with white stripes.	24"	18"	June-July	☼	4.5	5.95
'Muscadet'	Large white flowers with pink spots, fragrant.	32"	18"	June-July	☼	4.5	5.95
'Star Gazer'	Spotted crimson red over creamy white.	32"	18"	June-July	☼	4.5	5.95

Tiger Lily:

tigrinum 'Splendens'	An old fashioned favorite! Orange petals with burgundy spots. Petals are curved back on flowers that face downward.	40"	24"	June-July	☼	#1	8.95
----------------------	---	-----	-----	-----------	---	----	------

Linum Flax

perenne 'Sapphire'	Sapphire blue flowers over finely textured blue-green foliage.	12"	12"	June-July	☼	4.5	4.95
--------------------	--	-----	-----	-----------	---	-----	------

☼ sun ☉ part shade ● shade ☉ new variety (H) height (S) spacing (TP) tender perennial N native

Shady Acres Perennial Nursery

New Berlin, Wisconsin

262-679-1610

Genus Species/Variety	Common Name	(H)	(S)	Bloom	Loc.	Perennials	
						Size	Price
Lobelia	Cardinal Flower						
Tall spikes, topped with tubular flowers.							
N cardinalis	Native plant, dark green foliage with red flowers.	30"	18"	July-Sept	☼☼	4.5	4.95
fulgens	'Queen Victoria' (TP) Deep scarlet, red foliage.	30"	18"	July-Sept	☼☼	4.5	4.95
N siphilitica	Native plant, blue-violet flowers. Self seeds.	30"	18"	July-Sept	☼☼	4.5	4.95
Lupinus	Lupine						
A mound of light green foliage followed by erect tall flower stems. Flowers are very showy on tall spikes. A cool, moist area is preferred. Sensitive to hot summers. Likes lots of compost mixed with the soil upon planting, in a spot with morning sun and afternoon shade.							
'Minarette'	Beautiful mixed colors. Shorter form.	18"	15"	June-July	☼☼	4.5	4.95
'Russell Mix'	Mixed colors.	36"	15"	June-July	☼☼	4.5	4.95
'The Governor'	Marine blue and white flowers.	24"	15"	June-July	☼☼	4.5	4.95
☺ 'The Pages'	Carmine-red flowers.	30"	15"	June-July	☼☼	4.5	4.95
Lychnis	Maltese Cross / Catch Fly						
☺ chalcidonica	Star shaped red-orange flowers. Cut to the ground after flowering to promote new fresh leaves.	24"	15"	June-July	☼	4.5	4.95
coronaria	'Blood Red' Bright magenta flowers, wooly silver foliage.	30"	15"	June-Sept	☼	4.5	4.95
Lysimachia	Moneywort						
nummularia	(Creeping Jenny) Yellow flowers. Excellent groundcover. Works well in containers.	2"	12"	July-Aug	☼☼	4.5	4.95
nummularia	'Aurea' Golden foliage. May burn in full sun. Outstanding in containers.	2"	12"	July-Aug	☼	4.5	4.95
Macleaya	Plume Poppy / Bocconia						
Imposing perennials, which require ample room to grow and are best used as a specimen plant in the back of the border. Leaves are about 8" wide and are grayish white on the underside.							
cordata	Plume-like cream-pink colored flowers.	96"	36"	July-Aug	☼	#1	9.25
Malva							
Attracts butterflies all blooming season. Self-sows very easily.							
sylvestris	'Zebrina' (Althea 'Zebrina') White to pink flowers with dark veins.	36"	18"	July-Oct	☼	4.5	4.95
Mazus							
Mat forming creeping groundcover with tiny leaves. Excellent between stepping stones, pavers, or in rock gardens. Grows more rapidly in moist soil. Tiny tubular flowers in spring resemble butterflies.							
reptans	Blue flowers.	2"	12"	May-June	☼☼	4.5	4.95
Mertensia	Virginia Blue Bells						
N virginica	Native blue bells for shady woodland settings, plant goes dormant in summer.	12"	15"	April-May	☼●	4.5	5.95

☼ sun ☼ part shade ● shade ☺ new variety (H) height (S) spacing (TP) tender perennial N native

Shady Acres Perennial Nursery

New Berlin, Wisconsin

262-679-1610

Genus Species/Variety	Common Name	(H)	(S)	Bloom	Loc.	Perennials	
						Size	Price
Mimulus	Monkey Flower						
N ringens (Lavender Monkey Flower)	Lavender-blue flowers appear profusely all summer; shiny foliage. Likes moist soil or water up to 6" deep.	18"	15"	June-Aug	☼☉	4.5	5.95
Miscanthus (Maidengrass/Eulalia) see Grasses List							
Molinia (Tall Moor Grass) see Grasses List							
Monarda	Bee Balm / Bergamot						
Large clumps of strong, erect, square stems with dark green leaves that are strongly scented. Not particular about soil. However, mildew can be a problem. Monarda attracts butterflies and hummingbirds.							
'Gardenvue Scarlet'	Improved form of 'Cambridge Scarlet', very mildew resistant with larger red flowers.	30"	18"	July-Sept	☼☉	4.5	4.95
'Jacob Cline'	Large red flowers on 5' mildew resistant plant.	60"	18"	July-Sept	☼☉	4.5	4.95
'Marshall's Delight'	Lavender-pink flowers, mildew resistant.	30"	18"	July-Sept	☼☉	4.5	4.95
'Petite Delight' (PP10784)	Lavender rose flowers. Retains dark green glossy foliage all summer. Highly resistant to mildew. Dwarf variety.	15"	18"	July-Sept	☼☉	4.5	4.95
'Purple Rooster'	Large, true royal purple flowers over clean foliage. Strong stems do not require staking.	36"	18"	July-Sept	☼☉	#1	8.95
'Raspberry Wine'	Clear wine red flowers. The buds really do resemble raspberries. Very mildew resistant.	36"	18"	July-Sept	☼☉	4.5	4.95
<i>SugarBuzz Series</i>							
'Bubblemum Blast' (PPAF)	Hot pink flowers on strong stems. Dark green foliage, very aromatic.	24"	18"	July-Sept	☼☉	#1	8.95
'Cherry Pops' (PPAF)	Cherry red flowers on strong stems. Dark green foliage, very aromatic.	20"	18"	July-Sept	☼☉	#1	8.95
'Grape Gumball' (PPAF)	Vibrant magenta flowers on strong stems. Dark green foliage, very aromatic.	24"	18"	July-Sept	☼☉	#1	8.95
'Lilac Lollipop' (PPAF)	Lavender lilac flowers on strong stems. Dark green foliage, very aromatic.	20"	18"	July-Sept	☼☉	#1	8.95
Mukdenia							
rossii 'Karasuba'	Unique perennial for partial shade. Green, fan-shaped leaves are topped by delicate panicles of starry white flowers in spring. Leaves turn red in summer and are fire red in fall.	10"	18"	May	☉	#1	9.25
Nepeta	Cat Mint						
Great border plant with highly aromatic and attractive foliage. Will rebloom if cut back after first bloom.							
faassenii 'Blue Wonder'	Spectacular 12-14" groundcover with 6" blue flower spikes.	14"	18"	May-July	☼☉	4.5	4.95
f. 'Purrsian Blue' (PP24788)	Very floriferous! Two-tone periwinkle blue and purple flowers. Scented foliage. Tidy growth habit.	18"	18"	June-Sept	☼	4.5	4.95
s. 'Sweet Dreams'	Large, soft, two-toned pink flowers on upright, clumping stems of neat serrated leaves.	18"	18"	June-Aug	☼☉	#1	9.25
'Walker's Low'	Grey-green foliage has arching stems and is covered with violet-blue flowers for much of the season. Great for pollinators!	24"	18"	April-Sept	☼☉	4.5	4.95
==== 2007 PPA Perennial Plant of the Year ====							

☼ sun ☉ part shade ● shade ☼ new variety (H) height (S) spacing (TP) tender perennial N native

Shady Acres Perennial Nursery

New Berlin, Wisconsin

262-679-1610

Genus	Common Name					Perennials	
Species/Variety		(H)	(S)	Bloom	Loc.	Size	Price
Oenothera Evening Primrose / Sun Drops							
fruticosa 'Fireworks'	Upright species, yellow flower. Rapid spreader.	18"	15"	July-Sept	☼☉	4.5 #1	4.95 7.95
macrocarpa (missouriensis) (Ozark Sundrop)	Large canary yellow flowers. Dark green foliage. Seed pods can be used in dried floral arrangements.	12"	12"	June-Aug	☼☉	4.5	4.95
Pachysandra Japanese Spurge							
Popular evergreen shade groundcover. Shiny green foliage with creamy white flowers.							
terminalis 'Green Carpet'	Better evergreen color.	8"	10"		☉●	2.5	1.95
Paeonia Peony Hybrids							
Low maintenance perennials for any garden. Clump forming, bush like growing habits. Single varieties don't flower as long as the double varieties. Peonies are not particular about soil, but a sunny location is required for best flower production. Can also be used as cut flower. The Peony varieties grown at Shady Acres are deer resistant.							
'Bowl of Beauty'	Single (M) Light pink with yellow center.	38"	36"	May-June	☼	#1	14.95
'Bunker Hill'	Double (M) Fragrant, vibrant purple flowers.	32"	36"	May-June	☼	#1	14.95
'Coral Charm'	Semi-double (Early) Coral flowers.	30"	36"	May-June	☼	#1	14.95
'Duchess de Nemore'	Double (L) Creamy white.	34"	36"	May-June	☼	#1	14.95
'Early Scout'	Single (Very Early) Dark red with yellow stamens. Finely cut leaves.	22"	36"	May	☼	#1	14.95
'Festiva Maxima'	Double (E) Large white with red spot.	34"	36"	May-June	☼	#1	14.95
'Karl Rosenfield'	Double (M) Dark wine-red.	34"	36"	May-June	☼	#1	14.95
'Krinkled White'	Single (E) White, neatly crinkled petals.	32"	36"	May-June	☼	#1	14.95
☺ 'Lady Anna'	Double (Mid) Large, soft pink flowers with a sweet fragrance.	36"	36"	May-June	☼	#1	14.95
☺ 'Paul M. Wild'	Double (Mid) Large velvety red flowers. Good cut flower.	38"	36"	May-June	☼	#1	14.95
'Primevere'	Single (M) Creamy outer petals with large yellow center.	34"	36"	May-June	☼	#1	14.95
'Sarah Bernhardt'	Double (L) Medium rose-pink.	36"	36"	May-June	☼	#1	14.95
'Scarlet O'Hara'	Single (Early) Scarlet red flowers with yellow stamens.	36"	36"	May-June	☼	#1	14.95
'Shirley Temple'	Double (E) Light rose fading to white.	36"	36"	May-June	☼	#1	14.95
'Sorbet'	Double (M) Light pink flower with yellow ring in the center.	30"	36"	May-June	☼	#1	14.95
Paeonia suffruticosa Japanese Tree Peony							
Large semi-double flowers bloom in late May, one or two years after they are planted. Do not cut back the foliage.							
Pink	'Hanakiso'	48"	36"	May-June	☼	#1	24.95
Red	'Hoki'	48"	36"	May-June	☼	#1	24.95
Red/ White	'Shimanishiki'	48"	36"	May-June	☼	#1	24.95
Purple	'Shimadajain'	48"	36"	May-June	☼	#1	24.95
White	'Renkaku'	48"	36"	May-June	☼	#1	24.95
Yellow	'High Noon'	48"	36"	May-June	☼	#1	24.95

Panicum (Switch Grass) see Grasses List

☼ sun ☉ part shade ● shade ☺ new variety (H) height (S) spacing (TP) tender perennial N native

Shady Acres Perennial Nursery

New Berlin, Wisconsin

262-679-1610

Genus Species/Variety	Common Name	(H)	(S)	Bloom	Loc.	Perennials	
						Size	Price
Papaver	Poppy						
Basal light green foliage with bristly hairy texture. Erect stout stems with nodding flower buds open to large brilliant colored flowers. Most varieties bloom in late spring. Foliage goes dormant after flowering and returns in early fall. Full sun is required.							
burseri (alpinum)	Low tufts of gray foliage. Mixed flowers from white to yellow to orange. Short lived perennial.	10"	15"	May-Aug	☼	4.5	4.95
nudicaule 'Wonderland Mix'	Bright colored flowers in mixed colors on strong upright stems. Short lived perennial, may self seed.	10"	15"	May-June	☼	4.5	4.95
orientale 'Allegro'	Red flowers, shorter variety.	18"	15"	May-June	☼	4.5	4.95
o. 'Beauty of Livermore'	Red flowers.	30"	15"	May-June	☼	4.5	4.95
o. 'Brilliant'	Red flowers.	30"	15"	May-June	☼	4.5	4.95
☉ o. 'Plum Pudding'	Rich plum pink flowers.	30"	15"	May-June	☼	#1	9.95
o. 'Prince of Orange'	Orange flowers.	30"	15"	May-June	☼	4.5	4.95
o. 'Princess Louise'	Salmon flowers.	30"	15"	May-June	☼	4.5	4.95
o. 'Queen Alexander'	Bright, salmon-pink, with smooth rounded petals.	30"	15"	May-June	☼	#1	9.95
o. 'Royal Wedding'	Papery, white, flouncy blooms.	30"	15"	May-June	☼	#1	9.95
o. 'Türkenlouis'	Fiery red with fringe and black center.	30"	15"	May-June	☼	#1	9.95
Pardancanda	Candyliily						
norrisii	Iris-like foliage with 1" blooms in an array of bright colors. Flowers are followed by shiny black seedpods.	36"	15"	July-Sept	☼	4.5	4.95
Dazzler Series	Dwarf strain with extra large flowers in exciting colors.	18"	15"	July-Sept	☼	4.5	4.95
Parthenium	American Feverfew						
N integrifolium	A native prairie plant. Large, bold leaves. Flat topped clusters of small, white flowers rise above the foliage.	36"	24"	June-July	☼	4.5	5.95
Pennisetum (Fountain Grass) see Grasses List							
Penstemon	Beardtongue						
Tubular flowers on wiry stems high above the foliage. Will attract hummingbirds. Rumored to repel deer.							
barbatus 'Coccineus' ('Jingle Bells')	From the four corners area of US. Bright scarlet flowers in late summer. Grow in full sun and well drained soil.	36"	15"	Aug-Sept	☼	4.5	5.95
'Dark Towers' (PP20013)	Dark foliage emerges wine-purple and keeps its color. Masses of pink flowers.	40"	24"	June-July	☼	#1	7.95
=== 2015 WNLA Perennial Plant of the Year ===							
digitalis 'Husker Red'	Bronze foliage with white flowers.	40"	24"	June-July	☼	4.5	4.95
=== 1996 PPA Perennial Plant of the Year ===							
'Prairie Dusk'	Rose-purple flowers on sturdy stems above shiny dark green basal foliage.	20"	15"	June-July	☼	4.5	6.25

☼ sun ☉ part shade ● shade ☉ new variety (H) height (S) spacing (TP) tender perennial N native

Shady Acres Perennial Nursery

New Berlin, Wisconsin

262-679-1610

Genus	Common Name	(H)	(S)	Bloom	Loc.	Perennials Size	Price
Species/Variety							
Perovskia Russian Sage							
Graceful, aromatic shrub-like perennial with attractive, silvery gray foliage. Tips of branches produce small, whirled lavender blue flowers.							
	atriplicifolia (Russian Sage) Silvery gray aromatic foliage, violet-blue flowers. == 1995 PPA Plant of the Year ==	40"	24"	July-Sept	☼	#1	9.25
☺	a. 'Denim and Lace' (PPAF) Stays compact, has stronger stems and a more upright habit than older varieties. Full of lacy-like, sky blue flowers.	30"	24"	June-Sept	☼	#1	11.95
	a. 'Filigran' Finely cut foliage, bushy habit.	40"	24"	July-Sept	☼	#1	9.25
	a. 'Longin' More upright form of atriplicifolia.	40"	24"	July-Sept	☼	#1	9.25
	a. 'Rocketman' (PPAF) Shorter variety, growing to 3 feet tall. Strong silvery stems hold fluffy textured lavender-blue flowers.	36"	24"	June-Sept	☼	#1	9.25
Persicaria							
	filiformis 'Painter's Palette' Green leaves with central red/brown zones, ivory yellow splashes and stripes with an overall pink tinge.	28"	18"	June-Sept	☼☺	4.5	6.95
Phlox carolina Carolina Phlox							
Flowers mid to late summer, longer than most other Phlox types. Very fragrant flowers and good as cut flower. Forms a tidy clump. Resistant to mildew.							
	carolina 'Bill Baker' Vigorous pink flowers with light center.	20"	18"	June-Sept	☼	4.5	5.95
	c. 'Miss Lingard' Pure white flowers, very fragrant.	24"	18"	June-Sept	☼	4.5	5.95
Phlox divaricata Woodland Phlox							
Divaricata types are different than all other Phlox groups. They form a loose creeping mat of many tiny stems with semi evergreen foliage. Fragrant flowers appear in early summer.							
N	divaricata (Wild Sweet William) Semi-evergreen, mat forming ground cover with blue flowers.	12"	12"	May-June	☺●	4.5	5.95
	d. 'May Breeze' Very pale blue, almost white flowers.	10"	12"	May-June	☺●	4.5	5.95
Phlox paniculata Tall Garden Phlox / Border Phlox							
The common garden phlox has a sweet fragrance. Some of the more recent introductions are mildew resistant and will soon replace the older varieties. Stems are strong and tall and can be used as cut flowers. Flowers mid to late summer. Not particular about soil.							
FLAME series phlox are shorter, disease resistant varieties with bushy growing habits.							
	FLAME Coral (PP22234) Large, fragrant coral red flowers.	18"	18"	July-Aug	☼	4.5	5.95
	FLAME Pink (PP11804) Fragrant flowers are fuchsia with a darker pink eye.	18"	18"	July-Aug	☼	4.5	5.95
	FLAME Purple (PP12605) Rich purple flowers with a small darker eye.	18"	18"	July-Aug	☼	4.5	5.95
	paniculata 'Blue Boy' Blue with white eye, light fragrance.	38"	18"	July-Aug	☼	4.5	5.95
	p. 'Bright Eyes' Large clusters of light pink flowers with very deep pink eyes.	30"	18"	July-Aug	☼	4.5	5.95
	p. 'David' White, fragrant, highly mildew resistant.	36"	18"	July-Aug	☼	4.5	5.95
	==== 2002 PPA / WNA Plant of the Year ====						
☺	p. 'Glamour Girl' (PPAF) Glowing coral-pink flowers on dark stems. Very mildew resistant.	32"	18"	July-Aug	☼	#1	8.95
	p. 'Laura' Purple flowers with white center. Mildew resistant.	36"	18"	July-Aug	☼	4.5	5.95
	p. 'Nicky' Stunning deep magenta flowers. Fragrant. Good mildew resistance.	36"	18"	July-Aug	☼	4.5	5.95

☼ sun ☺ part shade ● shade ☺ new variety (H) height (S) spacing (TP) tender perennial N native

Shady Acres Perennial Nursery

New Berlin, Wisconsin

262-679-1610

Genus	Common Name	(H)	(S)	Bloom	Loc.	Perennials	
Species/Variety						Size	Price
Phlox paniculata	Tall Garden Phlox / Border Phlox			(continued)			
p. 'Norah Leigh'	Lavender flowers with creamy yellow variegated foliage.	30"	18"	July-Aug	☼	4.5	5.95
p. 'Orange Perfection'	Orange red flower, compact grower.	30"	18"	July-Aug	☼	4.5	5.95
p. 'Starfire'	Bright red Blooms on compact plants.	32"	18"	July-Aug	☼	4.5	5.95
Phlox stolonifera	Woodland Creeping Phlox						
Very shade tolerant. Grows in rich, humus soil. Attractive evergreen foliage. Low mat forming ground cover, good for woodland areas. ===== 1990 PPA Plant of the Year =====.							
s. 'Blue Ridge'	Very nice blue.	8"	12"	April-May	☼●	4.5	4.95
s. 'Home Fires'	Deep pink, most fragrant of the bunch.	8"	12"	April-May	☼●	4.5	4.95
s. 'Sherwood Purple'	Masses of purple flowers in spring.	8"	12"	April-May	☼	4.5	4.95
Phlox subulata	Creeping Phlox						
Creeping evergreen plant with stiff needle like foliage. Forms a dense mat and works as an excellent groundcover. The small flowers are extremely showy in spring and early summer.							
s. 'Candy Stripes'	White and pink two-toned flowers.	6"	12"	April-May	☼	4.5	4.95
s. 'Emerald Blue'	Lavender-blue flowers.	6"	12"	April-May	☼	4.5	4.95
s. 'Emerald Pink'	Clear pink flowers.	6"	12"	April-May	☼	4.5	4.95
☺ s. 'North Hills'	Bright white flowers with a violet purple eye.	6"	12"	April-May	☼	4.5	4.95
Physostegia	Obedient Plant / False Dragonhead						
Trumpet like flower on sturdy stems. Ideal for borders and cut flowers.							
'Miss Manners' (PP12637)	Pure white snapdragon like flowers over deep green glossy foliage. Short non-spreading habit.	18"	15"	June-Sept	☼☼	4.5	5.95
virginiana 'Variegata'	White variegated leaves, pink flowers.	24"	18"	Aug-Sept	☼☼	4.5	5.95
v. 'Vivid'	Bright pink flower spikes.	20"	18"	Aug-Sept	☼☼	4.5	4.95
Platycodon	Balloon Flower						
Balloon like flower buds open to a 2-3" saucer shaped flower. Well drained soil is important.							
'Astra Pink'	Long lasting light pink flowers. Compact, uniform growing habit.	8"	12"	July-Aug	☼☼	4.5	5.95
☺ grandiflorus 'Fairy Snow'	Delicate white bell-shaped blooms with deep blue veining. Compact habit.	10"	12"	July-Aug	☼☼	4.5	5.95
g. 'Mariesii'	Large, bell shaped blue flowers.	16"	12"	July-Aug	☼	4.5	5.95
g. 'Sentimental Blue'	Large blue flowers on compact plant.	8"	12"	July-Aug	☼	4.5	5.95
Podophyllum	Mayapple						
N peltatum	Native wildflower, single nodding white flower, hanging beneath deeply lobed foliage, followed by "apple" fruit.	18"	10"	April-June	●	4.5	5.95

☼ sun ☼ part shade ● shade ☼ new variety (H) height (S) spacing (TP) tender perennial N native

Shady Acres Perennial Nursery

New Berlin, Wisconsin

262-679-1610

Genus	Common Name					Perennials	
Species/Variety		(H)	(S)	Bloom	Loc.	Size	Price
Polemonium	Jacob's Ladder						
Clusters of bell shaped flowers held above divided ladder like foliage.							
N caeruleum 'Blue Pearl'	Bright blue flowers.	18"	12"	May-June	☼☉	4.5	4.95
N reptans	Blue flowers. Native plant.	12"	12"	May-June	☼☉	4.5	4.95
r. 'Stairway to Heaven'	(Variegated Jacob's Ladder)	18"	12"	May-June	☼☉	#1	9.95
	(PP15187) Large, vigorous selection with green and white leaves tinged with pink in the spring. Pale lavender blue flower.						
yezoense 'Bressingham Purple'	(PP15367) Lilac blue flowers are stunning when set against the glossy deep purple foliage. Great plant for a moist, shady location.	18"	15"	May-June	☉●	4.5	6.95
Polygonatum	Solomon's Seal						
White flowers, tipped with green hang down in 4 to 6 clusters. Best in a naturalized area where they can be left alone. Prefers a moist organic, woodland type soil.							
N biflorum	(Solomon's Seal) White flowers.	24"	15"	May	●	4.5	5.95
N commutatum	(Giant Solomon's Seal) The graceful, arching stems of Solomon's Seal add an exotic touch to the shade garden. This species has tall stems of dangling white bell flowers in late spring, followed by a crop of blue-black berries in the fall.	36"	15"	May-June	●	4.5	5.95
falcatum 'Variegatum'	Unbranched stems with beautiful creamy variegated foliage.	24"	15"	May-June	●	4.5	6.95
=== WNA 2004 / PPA 2013 Plant of the Year ===							
humile	(Miniature Solomon's Seal) Greenish white flowers under green foliage. Nice as a groundcover.	8"	15"	May-June	●	4.5	6.95
Potentilla	Cinquefoil						
Sunny, dry locations for this group will insure best growth. Not particular about soil.							
☉ nepalensis 'Ron McBeath'	Bright carmine-pink flowers contrast nicely with the dark green foliage. Good groundcover. Deer resistant.	12"	12"	May-June	☼☉	4.5	4.95
'Verna Nana'	Low, mound forming, yellow flowers.	4"	8"	May-June	☼	4.5	5.95
Primula	Hardy Primrose						
Early season bloomer. Large, vibrant flowers over bright green foliage.							
polyanthus SuperNova Mix	Large flowers in an array of bright colors.	8"	10"	April-June	☉	#1	7.95
Pulmonaria	Lungwort						
Excellent early blooming perennials. Although flowers are impressive, these plants are more valued for their attractive spotted foliage. A moist soil in a shady location is critical for best color. Deer resistant.							
longifolia 'E.B. Anderson'	Narrow spotted foliage with violet-blue flowers.	14"	15"	May-June	☉●	#1	9.95
I. 'Roy Davidson'	Long, narrow blue-green foliage with silver spots. Flowers start pink and turn powder blue.	12"	15"	May-June	☉●	#1	9.95
'Majeste'	Solid silvery-gray leaves with a very narrow green margin. In spring, light pink buds open to bluish pink flower bells.	12"	15"	May-June	☉●	#1	9.95
'Polar Splash'	Dark green leaves splashed with silver spots. Blue buds open to pink flowers.	16"	15"	May-June	☉●	#1	9.95
saccharata 'Mrs. Moon'	Pink flowers fade to blue, silvery spotted foliage.	12"	15"	May-June	☉●	#1	9.95

☼ sun ☉ part shade ● shade ☉ new variety (H) height (S) spacing (TP) tender perennial N native

Shady Acres Perennial Nursery

New Berlin, Wisconsin

262-679-1610

Genus	Common Name	(H)	(S)	Bloom	Loc.	Perennials	
	Species/Variety					Size	Price
Pulsatilla	Pasque Flower						
	Bell shaped flowers about 2-3" wide appearing in early spring. One of the first perennials to bloom. The flowers are followed by fern like leaves of silvery color.						
	vulgaris (Anemone pulsatilla) Lavender flowers.	8"	10"	April-May	☼☉	4.5	5.95
	v.'Alba' White flowers.	8"	10"	April-May	☼☉	4.5	5.95
	v.'Rubra' Wine-red flowers.	8"	10"	April-May	☼☉	4.5	5.95
Ratibida	Prairie Coneflower						
	columnifera (Mexican Hat Plant) The cylindrical brown center disk of each flower can be 2 inches long! Yellow and red ray petals with deeply cut leaves.	30"	18"	June-Sept	☼	4.5	4.95
N	pinnata (Gray Headed Coneflower) Large yellow flowers on striking plants. Drooping petals surrounding prominent cone-like centers add to its unique appearance. Native.	48"	18"	July-Sept	☼	4.5	4.95
Rudbeckia	Gloriosa Daisy						
	Hirta varieties are biennials and need to re-seed themselves in the garden or landscape.						
	fulgida 'Goldsturm' (Black Eyed Susan) True perennial form, yellow flowers with black center eye.	30"	18"	July-Sept	☼	4.5	4.95
	=== 1999 PPA Plant of the Year ===					#1	7.95
	f. var. 'Deamii' Very similar to 'Goldsturm', but completely resistant to black spots on the leaves. Golden yellow flowers with dark centers.	24"	18"	July-Oct	☼	#1	7.95
	f. var. fulgida Shiny, deep green foliage. Flowers are smaller than 'Goldsturm', but the plant has a much longer flowering season.	24"	18"	July-Oct	☼	4.5	4.95
	f. var. sullivanii 'Little Goldstar' (PP22397) More compact selection compared to 'Goldsturm'. Golden yellow flowers above the short, bushy clump of rich green foliage. Great in containers.	15"	18"	July-Oct	☼	4.5	6.95
☼	f. 'Viette's Little Suzy' (PP8867) Tons of features: Compact, upright, shorter height, excellent disease resistance and long-blooming yellow daisy-like flowers.	15"	18"	Aug-Sept	☼	4.5	6.95
N	hirta (Black Eyed Susan) Bright yellow flowers. Native.	24"	15"	July-Sept	☼	4.5	4.95
	h. 'Cherokee Sunset' A blend of sunset colors on semi-double 4" flowers. Excellent branching. Ideal cut flower.	30"	18"	July-Sept	☼	4.5	4.95
	h. 'Goldilocks' (Dwarf Black Eyed Susan) Compact form of hirta. Single golden yellow flowers with dark eye.	10"	15"	July-Sept	☼	4.5	4.95
	h. 'Indian Summer' Huge, semi-double and single golden-yellow flowers. Outstanding basal branching does not require staking.	36"	18"	July-Sept	☼	4.5	4.95
	h. 'Prairie Sun' Striking 5" light green eyed golden yellow flowers. Excellent in border, container or cutting garden.	36"	18"	July-Sept	☼	4.5	4.95
	h. 'Toto' Cute 2" single golden yellow flowers with dark eye. Dwarf, compact habit ideal for pots or bedding.	10"	15"	July-Sept	☼	4.5	4.95
	laciniata 'Goldquelle' Brassy double yellow flowers.	36"	18"	July-Sept	☼	#1	9.25
	maxima Tall plant. Foliage is powdery blue-green. Bright yellow flowers have a 3" cone.	60"	30"	July-Sept	☼	4.5	5.95
	nitida 'Herbstsonne' (Autumn Sun) Yellow rays with green disks. Tall plant for the back of the border.	72"	30"	Aug-Sept	☼	#1	7.95
	subtomentosa 'Henry Eilers' Strikingly unique fluted, tubular shaped petals surround a brown cone. Sweetly scented foliage.	54"	24"	Aug-Sept	☼	#1	9.25
☼	triloba 'Prairie Glow' Vibrant orange-red flowers with golden yellow tips surround a chocolate brown cone. Dark colored sturdy stems.	40"	24"	Aug-Sept	☼	#1	9.25

☼ sun ☉ part shade ● shade ☼ new variety (H) height (S) spacing (TP) tender perennial N native

Shady Acres Perennial Nursery

New Berlin, Wisconsin

262-679-1610

Genus Species/Variety	Common Name	(H)	(S)	Bloom	Loc.	Perennials Size	Price
Rumex	Garden Sorrel						
sanguineus var. sanguineus	(Bloody Sorrel) Distinct red-purple veins color the foliage of this perennial. Zone 5	15"	12"	Sept	☼☉	4.5	4.95
Sagina	Irish Moss / Pearlwort						
Moss like evergreen foliage. Excellent for shaded areas or between stepping stones.							
subulata	(Irish Moss) Small white flowers.	3"	10"	June-July	☉	4.5	4.95
s. 'Aurea'	(Scotch Moss) Gold to chartreuse foliage.	3"	10"	June-July	☉	4.5	4.95
Salvia	Meadow Sage						
Very reliable and compact perennials. For full sun locations where few others will survive as they can withstand dry conditions. Spikes of long lasting flowers appear in early summer. Cutting off flower stems after the first bloom will encourage another bloom later in summer.							
nemorosa 'Blue Hill'	('Blauhügel') Sky-blue flowers.	18"	15"	June-Aug	☼	4.5	6.25
n. 'Caradonna'	Very upright habit that does not flop open. Dark purple flower stems set off the bright violet-blue flowers. Outstanding as a cut flower.	24"	15"	June-Aug	☼	4.5 #1	6.25 9.25
n. 'Dwarf Blue Queen'	Short variety. Deep blue flowers.	12"	15"	June-July	☼	4.5	4.95
n. 'East Friesland'	('Ostfriesland') Violet-purple flowers.	18"	15"	June-July	☼	4.5	6.25
n. 'Marcus'	(PP13322) Dark violet blue flowers on a dwarf plant. The perfect size plant for containers.	10"	15"	June-Aug	☼	#1	9.25
n. 'May Night'	('Mainacht') Dark violet-blue flowers.	24"	15"	May-June	☼	4.5	6.25
==== 1997 PPA Perennial Plant of the Year ====						#1	9.25
n. 'Snow Hill'	('Schneehügel') White flowers, gray-green foliage.	18"	15"	June-Aug	☼	4.5	6.25
n. 'Viola Klose'	Deep purple flowers.	18"	15"	June-July	☼	#1	9.25
n. 'Wesuwe'	Vibrant purple flowers.	18"	15"	May-July	☼	#1	9.25
'Sensation Deep Rose Improved'	(PPAF) Extremely floriferous; bright pink flowers on dark purple stems. Forms a robust, compact clump of green foliage.	16"	15"	June-July	☼	4.5	6.25
Sanguisorba	Burnet						
☉ obtusa	Oblong shaped leaves, rose-pink bottlebrush-like flowers.	30"	24"	June-Aug	☼	#1	9.95
Saponaria	Soapwort						
ocymoides	Bright pink flowers over prostrate foliage. Good as groundcover or rock garden plant.	8"	15"	May-June	☼☉	4.5	4.95
Saxifraga	Rockfoil						
Low growing, rock garden plants.							
caespitosa 'Purple Robe'	Carmine flowers.	4"	8"	May-July	☼☉	4.5	4.95
Scabiosa	Pincushion Plant						
caucasica 'Isaac House Hybrids'	Large flowers dance in shades of lavender, light to dark blue and silvery white.	24"	15"	June-Aug	☼	4.5	4.95

☼ sun ☉ part shade ● shade ☉ new variety (H) height (S) spacing (TP) tender perennial N native

Shady Acres Perennial Nursery

New Berlin, Wisconsin

262-679-1610

Genus	Common Name					Perennials	
Species/Variety		(H)	(S)	Bloom	Loc.	Size	Price

Schizachyrium (Little Bluestem) see Grasses List

Sedum

Stonecrop / Live Forever

A large group of very tough perennials that can perform in any type of soil. All varieties can handle full sun and are resistant to most pests. Fleshy leaves sometimes have dramatic color changes later in the season.

	acre Small green foliage tinted with red as the season cools. Yellow flowers. Good groundcover.	1"	15"	June	☼	2.5	1.95
	Autumn Charm™ ('Lajos' PP14421) Gray-green leaves have butter yellow, serrated edges and form an upright clump. Cream buds open to light pink flowers.	16"	18"	Aug-Sept	☼	#1	9.25
	'Autumn Fire' Similar to 'Autumn Joy', but selected for its tighter growth habit, thicker foliage, and more brightly colored rosy flower heads.	24"	18"	Aug-Sept	☼	4.5 #1	4.95 7.95
	'Autumn Joy' ('Herbstfreude') Upright sedum with rust-red flowers. Great winter interest.	24"	18"	Aug-Sept	☼	4.5 #1	4.95 7.95
	'Bertram Anderson' More upright hybrid of caudicula.	8"	12"	Aug-Sept	☼	4.5	4.95
	caudicula Deep pink flowers, blue-gray foliage.	5"	12"	Aug-Sept	☼	4.5	4.95
	floriferum 'Weihenstephaner Gold' Rich, dark green scalloped foliage with golden yellow flowers.	7"	15"	June	☼	2.5 4.5	1.95 4.95
	k. var. 'ellacombeanum' Yellow flowers, scalloped leaves.	10"	15"	June	☼	4.5	4.95
	k. var. 'middendorffianum' Yellow flowers, serrated foliage.	5"	15"	June	☼	4.5	4.95
	k. 'Variegatum' Orange-yellow flowers with creamy yellow variegated foliage.	7"	15"	June	☼	4.5	4.95
	'Matrona' Deep gray foliage with shiny red stems topped off with large pink flower heads. Very upright habit.	24"	18"	Aug-Sept	☼	#1	9.25
☺	'Mr. Goodbud' (PP17671) Large vibrant purple-pink flowers on purple-red stems. Strong stems resist flopping.	16"	18"	Aug-Sept	☼	#1	9.25
	reflexum 'Blue Spruce' Blue foliage with bright yellow flowers in summer. Great groundcover for a sunny spot.	6"	15"	July-Aug	☼	4.5	4.95
	rupestre 'Angelina' Amazing, brilliant golden leaves on trailing stems. Excellent for hanging baskets, containers and adding a bright spot to a border or rock garden.	6"	15"	July-Aug	☼☺	4.5	4.95
	sarmentosum Spreading groundcover for sunny locations or rock gardens. Bright yellow flowers.	2"	12"	May-June	☼	2.5	1.95
	sieboldii Unique pale blue-green foliage. Pink flowers. Interesting in the garden or containers.	6"	12"	June	☼	4.5	4.95
	sieboldii 'Mediovariegatum' Blue-green scalloped leaves with pink edges and a creamy white strip in the center.	6"	12"	June	☼	4.5	4.95
	spectabile 'Neon' Brilliant, rosy-magenta pink flowers. Upright habit, gold fall color.	24"	18"	Aug-Sept	☼	#1	7.95
	spurium 'Dragon's Blood' ('Schorbuser Blut') Dark red flowers, green foliage. Outstanding groundcover.	4"	12"	July-Aug	☼	2.5 4.5	1.95 4.95
	s. 'Fuldaglut' ('Fuldaglow') Red flowers, red foliage.	4"	12"	July-Aug	☼	4.5	4.95
	s. 'Tricolor' Red, green and white foliage, pinkish flowers.	4"	12"	July-Aug	☼	4.5	4.95
	'Vera Jameson' More compact form of Ruby Glow. Darker blue-green foliage.	8"	12"	July-Aug	☼	4.5	4.95
	<i>SunSparkler Series</i>						
☺	'Dazzleberry' (PP22457) Smokey blue foliage covered with large clusters of raspberry colored flowers.	6"	15"	Aug-Sept	☼	4.5	4.95
☺	'Fire Cracker' (PPAF) Burgundy red foliage on this robust groundcover. Vibrant pink flowers.	6"	15"	Aug-Sept	☼	4.5	4.95
☺	'Lime Zinger' (PP24632) Succulent apple-green leaves edged in red. Soft pink flowers.	6"	15"	Aug-Sept	☼	4.5	4.95

☼ sun ☺ part shade ● shade ☺ new variety (H) height (S) spacing (TP) tender perennial N native

Shady Acres Perennial Nursery

New Berlin, Wisconsin

262-679-1610

Genus	Common Name					Perennials	
Species/Variety		(H)	(S)	Bloom	Loc.	Size	Price
Sempervivum Hen & Chicks							
Rock garden, crevice plants. A nice plant for trough containers and living wreaths.							
'Braunii'	Medium green foliage.	3"	12"		☼	4.5	4.95
'Cobweb'	Pale green covered with fine silvery web-like hairs.	3"	12"		☼	4.5	4.95
'Pacific Blue Ice'	Icy blue-green leaves become flushed with rose hues in cooler weather. Unique cupped form.	3"	12"		☼	4.5	4.95
'Pilosum'	Green foliage, flushed with red.	3"	12"		☼	4.5	4.95
'Red Beauty'	Large rosettes, red foliage.	3"	12"		☼	4.5	4.95
'Ruby Heart'	Rosettes are sharply pointed, silvery blue, and flushed with rosy red at the base.	3"	12"		☼	4.5	4.95
'Twilight Blues'	Large olive green rosettes, shaded with lavender, purple tips.	3"	12"		☼	4.5	4.95
Sidalcea Miniature Hollyhock							
Long blooming perennials for a sunny location. Moist soil is the key to best results. Deadheading will promote a longer blooming season.							
'Elsie Hough'	Soft shell pink flowers.	24"	18"	June-Aug	☼☉	#1	8.95
oregana 'Brilliant'	Vibrant deep rose flowers.	30"	18"	June-Aug	☼☉	#1	8.95
Silphium							
Native plants, good back of border plants.							
N laciniatum	(Compass Plant) A classic prairie plant. Deeply divided leaves often orient themselves in a north-south direction. Large plant with a healthy taproot.	96"	36"	Sept	☼	#1	8.95
N perfoliatum	(Cup Plant) Robust 6-8' native with square stems. Opposite leaves joined at the stem form cups which hold water for birds. Large yellow daisy-like flowers. Self seeds.	84"	36"	Aug-Sept	☼	#1	8.95
Sisyrinchium Blue Eyed Grass (...not really a grass)							
angustifolium 'Lucerne'	Thin iris-like clump forming foliage. Bright blue star-shaped flowers with yellow centers in summer. Likes average to moist soil. === WNLA 2013 Plant of the Year ===	12"	12"	June-July	☼☉	4.5	5.95
Smilacina False Solomon Seal							
Leaves are broadly lance shaped. Flowers on terminal clusters.							
N racemosa	Woodland native plant. Creamy white flowers on arching stems. Green berries turning red follow the flowers in late summer or fall.	24"	15"	May-June	●	4.5	5.95

☼ sun ☉ part shade ● shade ☼ new variety (H) height (S) spacing (TP) tender perennial N native

Shady Acres Perennial Nursery

New Berlin, Wisconsin

262-679-1610

Genus	Common Name					Perennials	
Species/Variety		(H)	(S)	Bloom	Loc.	Size	Price
Solidago	Goldenrod						
Low maintenance, beautiful flat flowers and they do not cause hay fever! They just happen to bloom at the same time as ragweed, a common hay fever villain.							
'Fireworks'	A striking plant with a radiating golden flower form that really looks like fireworks.	36"	18"	Aug-Sept	☼	4.5	5.95
===== 2003 WNA Plant of the Year =====							
'Golden Baby'	Compact, upright growth. Dense, small golden-yellow flowers.	24"	18"	June-Sept	☼	4.5	4.95
N rigida	(Stiff Goldenrod) Yellow-gold, relatively large, flat-topped flowers.	48"	18"	Aug-Sept	☼	4.5	5.95
N speciosa	(Showy Goldenrod) Showy golden yellow flowers atop stiff, narrow-leaved, reddish stems. Attractive to bees and butterflies.	36"	18"	Aug-Sept	☼	4.5	5.95
Sorghastrum (Indian Grass) see Grasses List							
Sporobolus (Dropseed) see Grasses List							
Stachys	Lamb's Ears						
byzantina	'Helene von Stein' (Big Ears) Broad leaves, twice the size of other Lamb's Ears. Strong, clumping habit.	15"	15"		☼	4.5	5.95
b.	'Silver Carpet' Non-flowering form of <i>byzantina</i> .	10"	12"		☼	4.5	5.95
'Hummelo'	Neat, compact clumps of glossy light green, textured foliage. Sturdy rose-lavender flower spikes. At least 6 weeks of bloom time.	18"	15"	June-July	☼	4.5	5.95
===== WNA 2011 Plant of the Year =====							
minima	Extremely floriferous plant. Pink-purple flowers bloom on 4-6" spikes in summer. Forms a dense mound of dark, glossy green foliage.	6"	12"	June-July	☼	4.5	5.95
Stokesia	Stoke's Aster						
laevis	'Mary Gregory' Distinctive, unusual soft yellow flowers on this 12-18" selection.	18"	15"	July-Sept	☼	4.5	5.95
I.	'Purple Parasols' (PP10660) Deep violet flowers. Highly acclaimed.	15"	15"	July-Sept	☼	4.5	5.95
Strawberry see Fragaria							
Thalictrum	Meadow Rue						
☺ aquilegifolium	Graceful foliage resembles that of Columbine. Airy rose-colored flowers. This fine-textured plant mixes well with Hostas in a part sun area.	30"	18"	July-Aug	☼☺	4.5	4.95
r.	'Lavender Mist' Magnificent sprays of delicate, purplish flowers on tall, dark purple stems rise above the green low-mounding foliage.	60"	24"	July-Aug	☼	#1	8.95
Thermopsis	False Lupine						
lanceolata	Yellow pea-like blossoms on sturdy stems.	24"	24"	May-June	☼	4.5	4.95

☼ sun ☺ part shade ● shade ☺ new variety (H) height (S) spacing (TP) tender perennial N native

Shady Acres Perennial Nursery

New Berlin, Wisconsin

262-679-1610

Genus	Common Name	(H)	(S)	Bloom	Loc.	Perennials	Size	Price
Species/Variety								
Thymus Thyme								
Popular as a groundcover or used between stepping stones. Durable plant that can handle some foot traffic.								
	citriodorus (Lemon Thyme) see Herb List							
	praecox (serpyllum) 'Coccineus' Deep pink flowers.	4"	12"	June-July	☼		4.5	5.95
☺	p. 'Pink Chintz' Deep olive evergreen foliage showcases pretty salmon-pink flowers in summer.	2"	12"	June-July	☼		4.5	5.95
	p. 'Pseudolanuginosus' (Wooly Thyme) Gray foliage.	2"	12"	June-July	☼		4.5	5.95
Tiarella Foam Flower								
Tiarellas are very popular for their shade tolerance and early bloom season. Unusual leaf shapes and marked foliage make these plants a terrific underplanting for hostas in the shade garden or along shaded walkways.								
N	cordifolia Native, white flowers. Works as groundcover.	15"	12"	April-May	☼●		4.5	5.95
	c. 'Brandywine' A strong grower with glossy, rugose leaves and excellent bronze fall and winter color. Light pink flowers. A robust clump former with some short runners.	8"	12"	April-May	☼●		4.5	6.25
	c. 'Oakleaf' A long blooming, clumping plant with light pink flowers. Bronze new spring growth. Burgundy winter color.	10"	12"	April-May	☼●		4.5	6.25
	c. 'Running Tapestry' A vigorous running ground cover with red speckled, deeply dissected foliage. Plenty of white flowers.	12"	12"	April-May	☼●		4.5	6.25
	'Elizabeth Oliver' A spreading runner with deeply lobed leaves with lots of red markings and light pink flowers.	8"	12"	April-May	☼●		4.5	6.25
	wherryi Pale pink flower. Does not spread like <i>cordifolia</i> .	15"	12"	April-May	☼●		4.5	4.95
Tradescantia Spiderwort								
Long narrow leaves in a dense clump. Flowers are star shaped on branched stems. Flowers from late spring through late summer. After flowering, cut back for new growth and reblooming. Tolerant of wet, boggy sights.								
	AMETHYST KISS™ (PP24733) Large clusters of sizeable, periwinkle blue flowers accented with yellow tipped stamens. Very long blooming selection!	18"	15"	June-Sept	☼☼		4.5	5.95
	'Concord Grape' Deep purple flowers. Long flowering season. Bluish green foliage.	18"	15"	June-Aug	☼☼		4.5	5.95
N	ohiensis Native plant. Deep blue flowers. Not particular about soil conditions.	30"	15"	June-Aug	☼☼		4.5	5.95
	'Sweet Kate' (Golden Spiderwort) Rich blue-purple flowers over slender chartreuse leaves.	15"	15"	June-Aug	☼☼		4.5	5.95
	'Zwanenburg' Royal blue flowers.	18"	15"	June-Aug	☼☼		4.5	5.95
Tricyrtis Toad Lily								
Sharply pointed heart shaped leaves on tall stems. Flowers have a unique star shape. Fall blooming plants.								
☺	formosana 'Autumn Glow' Variegated leaves have wide yellow margins. Arching stems of orchid-like, reddish purple speckled flowers arrive late in the season.	24"	18"	Sept-Oct	☼●	#1		9.25
	hirta 'Miyazaki Hybrids' Pale purple flowers with darker purple blotches.	20"	18"	Sept-Oct	☼●		4.5	5.95
	h. 'Moonlight' Chartreuse sport of <i>T. h. 'Variegata'</i> . Outstanding in the shade garden.	20"	18"	Sept-Oct	☼●		4.5	6.25
Trillium								
Native woodland flowers, needing rich, moist soils. Beautiful spring display of flowers, then go dormant.								
N	grandiflorum (Great White Trillium) Large white flowers.	12"	6"	April-June	●		4.5	5.95

☼ sun ☼ part shade ● shade ☺ new variety (H) height (S) spacing (TP) tender perennial N native

Shady Acres Perennial Nursery

New Berlin, Wisconsin

262-679-1610

Genus Species/Variety	Common Name	(H)	(S)	Bloom	Loc.	Perennials	
						Size	Price
Trollius	Globe Flower						
Clump forming dark green deeply toothed foliage. Colors are vibrant, usually golden or yellow. Trollius do best in moist soil, great near ponds or in wetlands. All <i>Trollius</i> should be deadheaded regularly to ensure reblooming.							
europaeus 'Superbus'	Buttercup yellow and gold flowers.	24"	12"	May-June	☼☉	4.5	6.95
'Golden Queen'	Golden-yellow buttercup-like flowers produced prominently above dark green foliage.	30"	12"	May-June	☼☉	4.5	6.95
'Lemon Queen'	Nice lemon yellow color.	30"	12"	May-June	☼☉	4.5	6.95
Uvularia	Merrybells / Bellwort						
Woodland plant with wiry stems, will take full sun if you mulch it.							
N grandiflora	Spring blooming wildflower. Bell-shaped, yellow flowers.	12"	12"	May-June	☉●	4.5	5.95
Verbascum	Mullein						
'Summer Sorbet'	Tall, sturdy stalks of purple flowers with a hint of peach and a darker raspberry eye.	24"	18"	June-Sept	☼	#1	9.95
Vernonia	Ironweed						
Though native to moist meadows, Ironweed is tolerant of hot, dry conditions, once established. Cutting the stems back hard once in late spring will encourage branching and keep plants shorter and more compact.							
N fasciculata	Deep lilac-colored flowers add late season interest to the landscape. Tough stems stand upright. Great for rain gardens or pond side.	60"	18"	Aug-Sept	☼	#1	9.95
☉	lettermannii Threadleaf foliage similar to <i>Amsonia hubrichtii</i> , this ironweed produces true purple flowers that attract plenty of butterflies.	30"	18"	Aug-Sept	☼	4.5	5.95
Veronica	Speedwell						
A large group of perennials with different characteristics. Most varieties are very drought tolerant summer blooming perennials. Taller varieties are great for borders, shorter varieties for edging or groundcover.							
	austriaca 'Crater Lake Blue' Gentian-blue flowers.	15"	12"	June-July	☼☉	4.5	4.95
	'Giles van Hees' Dwarf veronica with clear pink flowers.	6"	10"	June-Aug	☼☉	4.5	4.95
	longifolia 'Eveline' (PP14888) Tall spikes of red-violet flowers on nice upright plants.	20"	15"	June-Aug	☼☉	4.5	4.95
	peduncularis 'Georgia Blue' Round intense blue flowers on low spreading bushy foliage.	6"	12"	June-Aug	☼☉	4.5	4.95
	repens Light blue to white flowers, very low ground cover.	2"	12"	April-May	☼☉	4.5	4.95
	'Royal Candles' (PP18432) Masses of violet-blue spikes dart up above compact, upright, deep green foliage. Holds on to lower foliage better than other upright Veronicas.	18"	15"	June-Aug	☼☉	4.5	4.95
	spicata 'Goodness Grows' Spikes of deep violet-blue flowers from June through August.	12"	15"	June-Aug	☼☉	4.5	4.95
	s. 'Icicle' Pure white flowers, upright form.	20"	15"	June-Aug	☼☉	4.5	4.95
	s. 'Red Fox' ('Rotfuchs') Bright rose-red flower spikes, good landscape plant.	14"	15"	June-Aug	☼☉	4.5	4.95
	'Sunny Border Blue' Dark violet-blue flowers, upright habit. === 1993 PPA Plant of the Year ===	20"	15"	June-Aug	☼☉	4.5	4.95
	'Waterperry Blue' A low growing, long flowering groundcover. During the cooler months, the dark green foliage is blushed with burgundy and copper. Lavender-blue flowers with a white eye.	4"	15"	June-Aug	☼☉	4.5	4.95
☉	'Whitewater' (PP22783) Glossy green leaves with pristine white flowers. Makes a great groundcover.	5"	15"	June-Aug	☼☉	4.5	4.95

☼ sun ☉ part shade ● shade ☉ new variety (H) height (S) spacing (TP) tender perennial N native

Shady Acres Perennial Nursery

New Berlin, Wisconsin

262-679-1610

Genus	Common Name					Perennials	
Species/Variety		(H)	(S)	Bloom	Loc.	Size	Price
Veronicastrum	Culver's Root						
N virginicum	Upright plants with white spire-type flowers. Outstanding plant if given some attention.	36"	15"	June-July	☼☉	4.5	4.95
v. 'Fascination'	Two-tone flowers - purple on the top; lilac pink on the bottom, dark green foliage.	40"	15"	June-July	☼☉	#1	9.25
Vinca	Periwinkle / Myrtle						
	Evergreen groundcover with dark green glossy foliage. Very pretty blue flowers in spring and early summer.						
minor	Blue flowers, glossy, spreading foliage.	8"	9"	April-May	☉●	2.5	1.95
m. 'Bowles Variety'	Slightly larger flower than straight species. Glossy dark green foliage.	8"	9"	April-May	☉●	2.5	1.95
m. 'Sterling Silver'	Variegated foliage with blue flowers.	8"	9"	April-May	☉●	2.5	1.95
Viola							
	Violets prefer partial shade locations. Can be used as woodland groundcover.						
labradorica	Reddish green foliage with porcelain-blue flowers. Self seeds easily.	6"	15"	May	☉	4.5	4.95
Waldsteinia	Barren Strawberry						
	Versatile plant. Can be grown anywhere in any type of soil.						
ternata	Yellow flowers, good tough ground cover.	8"	12"	May-June	☼☉	2.5	1.95
Yucca	Adams Needle						
	Evergreen sword like leaves. Flowers appear on a large stalk from the center of the plant. Drought tolerant.						
filamentosa	Creamy white flower.	60"	24"	July-Aug	☼	#1	9.95
f. 'Bright Edge'	Sword like, green leaves with bright golden yellow edges radiate upward from a central crown. Sturdy stalks bear creamy white flowers.	48"	24"	July-Aug	☼	#1	11.95
f. 'Color Guard'	White and cream on the inside and edged with green. Foliage height to 4', flower height to 6'.	48"	24"	July-Aug	☼	#1	11.95
Zizia	Golden Alexander						
N aptera	Butterflies love this plant! Heart-shaped, bright green leaves with tiny yellow blooms.	20"	18"	May-June	☼☉	4.5	5.95

☼ sun ☉ part shade ● shade ☼ new variety (H) height (S) spacing (TP) tender perennial N native

Shady Acres Perennial Nursery

New Berlin, Wisconsin

262-679-1610

Genus	Common Name							Grasses
Species/Variety		(H)	(S)	Bloom	Loc.	Size	Price	

Grasses

Native grasses provide the perfect complement to dry, prairie-like settings. Hybridized grasses work beautifully in landscaping and gardens. Foliage color ranges from green to variegated to blood red. From stunning vertical accents to low pin cushion-like varieties, these grasses have become the newest landscape rage. Generally, most prefer sun. Good drainage is essential for most varieties.

Andropogon

Big Bluestem

N	gerardii	Prairie grass, tall enough for background, edge of the woods or windbreak. Panicles good for dried arrangements.	Z3	72"	24"	Aug-Oct	☼	#1	9.95
----------	-----------------	--	----	-----	-----	---------	---	----	------

Bouteloua

Sideoats

N	curtipendula (Sideoats grama)	Very attractive flower stalk with small oat-like seeds suspended on one side of a 2-3' stem. Excellent for dry soils.	Z3	24"	18"	Aug-Oct	☼	#1	9.95
----------	--------------------------------------	---	----	-----	-----	---------	---	----	------

Calamagrostis

Feather Reed Grass

Beautiful in breezy locations, good fall and winter color.

	acutiflora 'Avalanche'	Deep green leaves with a wide white stripe down the center. Distinctly upright.	Z4	48"	24"	June-July	☼	#1	9.95
--	-------------------------------	---	----	-----	-----	-----------	---	----	------

a.	'Karl Foerster'	A clumping grass with compact, erect growth habit. Wheat-like seed heads appear in early summer and last all season.	Z4	60"	24"	June-July	☼	#1	9.95
-----------	------------------------	--	----	-----	-----	-----------	---	----	------

=== 2001 PPA Perennial Plant of the Year ===

a.	'Overdam'	(Variegated Feather Reed Grass) Variegated foliage has bright creamy white margins. Clump-forming and very erect grass.	Z4	60"	24"	June-July	☼	#1	9.95
-----------	------------------	---	----	-----	-----	-----------	---	----	------

	brachytricha	(Korean Reed Grass) Shorter, fall blooming reed grass. Fine textured rosy plumes look great all fall.	Z4	36"	24"	Sept-Oct	☼	#1	9.95
--	---------------------	---	----	-----	-----	----------	---	----	------

Carex

Sedge

	elata 'Bowles Golden'	(Gold Sedge) Bright gold foliage with narrow green margins. Spectacular with blue or gold edged Hosta. Moisture loving.	Z5	24"	24"		☉●	#1	9.95
--	------------------------------	---	----	-----	-----	--	----	----	------

	morrowii 'Ice Dance'	Vigorous grower with strong, shiny foliage and bright variegation. Effective groundcover. Drought tolerant once established.	Z5	15"	18"		☉●	4.5	5.95
--	-----------------------------	--	----	-----	-----	--	----	-----	------

	morrowii 'Silver Sceptre'	A fine textured sedge with narrow leaves with white margins. Forms thick silvery clumps to brighten up the shade garden.	Z5	12"	18"		☉●	4.5	5.95
--	----------------------------------	--	----	-----	-----	--	----	-----	------

	pensylvanica	Slender, upright sedge. Spreads slowly by rhizomes, often creating an almost lawn-like cover. Tolerates dry shade.	Z4	8"	15"		☉●	4.5	5.95
--	---------------------	--	----	----	-----	--	----	-----	------

Chasmanthium

Northern Sea Oats

N	latifolium	Attractive oat-like seed heads from late summer through winter. Likes dry shade. Deep gold fall color.	Z3	36"	24"	Sept-Oct	☼☉	#1	9.95
----------	-------------------	--	----	-----	-----	----------	----	----	------

☼ sun ☉ part shade ● shade ☉ new variety (H) height (S) spacing (TP) tender perennial N native

Shady Acres Perennial Nursery

New Berlin, Wisconsin

262-679-1610

Genus	Common Name							Grasses	
Species/Variety		(H)	(S)	Bloom	Loc.	Size	Price		
Deschampsia	Tufted Hair Grass								
☺ cespitosa 'Pixie Fountain'	Dense clumps of slender, silver-green foliage. Golden-brown flower spikes work well for cutting.	Z4	24"	18"	July	☼☼	#1	9.95	
c. 'Schottland'	Pin cushion shape, clump- forming, silver panicles turning tan in July, will take some shade.	Z4	24"	18"	July	☼☼	#1	9.95	
Festuca	Fescue								
g. 'Elijah Blue'	One of the nicest blues. Color holds up all summer. Remove flowers to prevent seeding.	Z4	10"	15"		☼	#1	9.95	
Hakonechloa	Hakone Grass / Japanese Forest Grass								
☺ macra 'All Gold'	Brilliant solid gold foliage glows in the shade. Slightly upright habit.	Z5	18"	24"		☼●	#1	11.95	
macra 'Aureola'	Bright yellow-green variegated foliage. Does best in partial shade.	Z5	18"	24"		☼	#1	11.95	
Helictotrichon	Blue Oat Grass								
sempervirens	Dense tufted grass similar to Blue Fescue but with flat bluish-green foliage.	Z4	24"	18"		☼	#1	9.95	
s. 'Sapphire'	Similar to species, this selection has good blue color. Blades are slightly wider at maturity.	Z4	18"	18"		☼	#1	9.95	
Imperata	Japanese Blood Grass								
cylindrical 'Red Baron'	Beautiful reddish foliage. Not invasive in this part of the country.	Z5	16"	12"		☼☼	4.5 #1	4.95 7.95	
Juncus	Soft Rush								
N effusus	A native grass for pond edges, bog gardens, moist to wet soils. Vase-shaped habit, clump forming. Great vertical accent plant.	Z2	30"	24"		☼☼	#1	9.95	
Miscanthus	Maidengrass / Eulalia								
sinensis 'Adagio'	Fine textured, silver-gray leaves. Flowers have a pink cast that turns white.	Z5	36"	24"	Sept-Oct	☼	#1	9.95	
sinensis 'Ferner Osten'	A very distinct selection. Blooms open deep red, turn to silver. Slightly wider leaves than 'Gracillimus'.	Z5	48"	24"	Aug-Sept	☼	#1	9.95	
s. 'Gracillimus'	Feathery, fan-shaped pale pink panicles. Thin, stiff foliage.	Z4	72"	24"	Sept-Oct	☼	#1	9.95	
s. 'Graziella'	Similar to 'Gracillimus' but blooms in August. Nice bronze-red fall color. Slender foliage.	Z4	72"	24"	Aug	☼	#1	9.95	
s. 'Little Nicky'	(aka 'Hinjo') Dwarf zebra grass. Horizontal yellow bands on foliage with silvery white plumes.	Z5	24"	24"	Sept-Oct	☼	#1	9.95	
s. 'Morning Light'	Variegated 'Gracillimus'.	Z5	48"	24"	Sept-Oct	☼	#1	9.95	
☺ s. 'Oktoberfest'	(PPAF) Forms a narrow, upright tower of wide, deep green leaves that develop deep purple and red highlights later in the season. Shimmery flowers start burgundy and turn to tan.	Z5	72"	24"	Sept-Oct	☼	#1	9.95	
s. var. purpurascens	(Flame Grass) Red to purple fall color. Silvery flower plumes.	Z4	60"	24"	Sept-Oct	☼	#1	9.95	

☼ sun ☼ part shade ● shade ☺ new variety (H) height (S) spacing (TP) tender perennial N native

Shady Acres Perennial Nursery

New Berlin, Wisconsin

262-679-1610

Genus	Common Name							Grasses
Species/Variety		(H)	(S)	Bloom	Loc.	Size	Price	
Miscanthus	Maidengrass / Eulalia	<i>(continued)</i>						
s. 'Silver Feather' ('Silberfeder') Earlier blooming than species. Outstanding silver plumes.		Z4	96"	24"	Aug-Sept	☼	#1	9.95
s. 'Strictus' Horizontal yellow bar variegation.		Z5	84"	24"	Sept-Oct	☼	#1	9.95
s. 'Variegatus' Longitudinal stripes on green leaves.		Z5	72"	24"	Sept-Oct	☼	#1	9.95
Molinia	Tall Moor Grass							
arundinacea 'Skyracer' Stems are long and thin. Forms a transparent screen for structure in the garden. Fall foliage and flowers are yellow, turning gold when mature.		Z5	84"	24"	July	☼	#1	9.95
caerulea 'Moorflamme' Graceful, upright slightly arching, open flowering stems change to soft butter yellow in fall.		Z4	48"	24"	Sept-Oct	☼	#1	9.95
c. 'Moorhexe' Distinguished upright growth habit, allowing the slightest view through the narrow black-brown flower spikes.		Z4	36"	24"	July-Sept	☼	#1	9.95
Panicum	Switch Grass							
☺ virgatum 'Apache Rose' (PPAF) Dense, upright, columnar habit with grey-green foliage. Rose-colored flower panicles.		Z4	48"	24"	Aug	☼	#1	9.95
v. 'Heavy Metal' Bright, metallic blue foliage. Pink flowers above the foliage. Yellow and red fall highlights.		Z4	60"	24"	Aug	☼	#1	9.95
v. 'Northwind' Stiff, upright blue-green foliage. == WNA 2006 / PPA 2014 Plant of the Year ==		Z4	72"	24"	Sept	☼	#1	9.95
v. 'Rotstrahlbusch' Outstanding red fall color.		Z4	48"	24"	Sept	☼	#1	9.95
v. 'Shenandoah' The bright red foliage appears in June. Red flowers emerge later in summer. One of the shorter varieties available.		Z4	36"	24"	Sept	☼	#1	9.95
Pennisetum	Fountain Grass							
alopecuroides Rose-copper, bristly flower heads.		Z5	36"	24"	Aug	☼	#1	9.95
a. 'Burgundy Bunny' (PP21917) Rounded clump of green foliage starts to turn red in summer. All-over blazing red fall color until frost.		Z5	15"	18"	July	☼	#1	9.95
a. 'Hameln' (Dwarf Fountain Grass) Fine textured foliage; earlier flowers.		Z5	24"	24"	July	☼	#1	9.95
a. 'Little Bunny' (Miniature Fountain Grass) Smallest of the dwarf fountain grasses. Excellent for rock gardens.		Z5	12"	18"	July	☼	#1	9.95
a. 'Red Head' Deep purple buds mature to smoky purple plumes that measure 3" wide and 8" long. The green foliage turns gold in the fall.		Z5	48"	24"	July	☼	#1	9.95

☼ sun ☺ part shade ● shade ☺ new variety (H) height (S) spacing (TP) tender perennial N native

Shady Acres Perennial Nursery

New Berlin, Wisconsin

262-679-1610

Genus	Common Name		(H)	(S)	Bloom	Loc.	Grasses	
	Species/Variety						Size	Price
Schizachyrium Little Bluestem								
N	scoparium Good ground cover for naturalized areas, bluish-green to light purplish-colored foliage.	Z3	36"	18"	Aug-Sept	☼	#1	9.95
	s. 'Prairie Blues' Brighter grey-blue foliage and red-orange fall color. Narrow, upright habit.	Z3	36"	18"	Aug-Sept	☼	#1	9.95
	s. 'The Blues' True deep blue foliage and exceptional burgundy red fall color. Tolerates heat and humidity.	Z4	36"	18"	Aug-Sept	☼	#1	9.95
Sesleria Autumn Moor Grass								
	autumnalis (Autumn Moor Grass) Narrow, bright green leaves will form a clump producing silvery seed heads. Very drought tolerant once established, but needs ample water to get going.	Z4	15"	24"	Sept-Oct	☼	#1	9.95
Sorghastrum Indian Grass								
N	nutans Native warm season grass for average to dry meadows. Golden brown seed heads.	Z3	72"	24"	Sept-Oct	☼	#1	9.95
Sporobolus Dropseed								
N	heterolepis (Prairie Dropseed) Ground cover that grows well in hot dry areas, provides bird feed and wildlife protection.	Z3	36"	18"	Aug-Sept	☼	#1	9.95
	'Tara' A marvelous dwarf Prairie Dropseed. Tara's flowers and vase shape habit are much more upright than the species.	Z3	24"	18"	Aug-Sept	☼	#1	9.95

☼ sun ☉ part shade ● shade ☼ new variety (H) height (S) spacing (TP) tender perennial N native

Shady Acres Perennial Nursery

New Berlin, Wisconsin

262-679-1610

Common Name	Description	Herbs		
Genus / Species / Variety		Plant Type	Size	Price

Herbs

The popularity of herbs continues, undoubtedly due to the onslaught of cooking and gardening television programs utilizing them in numerous ways. Herbs are used for culinary, medicinal, and ornamental purposes. The majority of the herbs we grow are for cooking, yet we offer some that are useful in decorating the home and garden. There are other "herbs" listed under our general perennial line.

(A)=Annual (B)=Biennial (P)=Perennial (TP)=Tender Perennial

Basil, Purple Ruffles <i>O. b. 'Purple Ruffles'</i>	Dark purple serrated and crinkled leaves. Excellent in vinegar and as a garnish. Nice ornamental herb, too.	A	3.5	2.95
Basil, Spicy Globe <i>O. b. 'Spicy Globe'</i>	Compact, small leaf, mounded growth to 12". Highly flavorful and fragrant. Use like Sweet Basil.	A	3.5	2.95
Basil, Sweet <i>O. basilicum</i>	Clove-like flavor for Italian foods such as tomato-based dishes, pasta sauces, and pesto.	A	3.5	2.95
Basil, Sweet Dani <i>O. b. 'Dani'</i>	Lemon scented leaves. Attractive growth habit makes 'Sweet Dani' valuable as an ornamental plant also.	A	3.5	2.95
Basil, Sweet Genovese <i>O. b. 'Genovese'</i>	Large, dark green, thick leaves of strong scented, spicy basil flavor. Very popular in gourmet cooking.	A	3.5	2.95
Basil, Thai (Siam Queen) <i>O. b. 'Siam Queen'</i>	Outstanding culinary and ornamental plant. Green leaves on thick purple stems, mounding habit.	A	3.5	2.95
Bay, Sweet <i>Laurus nobilis</i>	The broadleaf evergreen foliage is aromatic. Used to flavor soups and stews. Use within a few days of drying for best flavor.	TP	#1	14.95
Burnet, Salad <i>Sanguisorba officinalis</i>	Its evergreen foliage may be cut for salads all winter long. Has cucumber flavor. Use in salads and drinks.	P	3.5	2.95
Caraway <i>Carum carvi</i>	Use seeds in cakes, rolls, puddings, cookies, boiled potatoes, spaghetti sauce, and applesauce. Young leaves can be used in salads and herb butter.	B	3.5	2.95
Catnip <i>Nepeta cataria</i>	Use young leaves in salads or tea. Add leaves to stews or rub meat with it before roasting. / Cats love it!	P	3.5	2.95
Chamomile, Roman <i>Chamaemilum nobile</i>	Dried flowers used for tea and aid for digestion. Flowers and foliage have an apple-like scent.	P	3.5	2.95
Chervil, Curled <i>Anthriscus cerefolium</i>	Rich in vitamin C, beta carotene, iron, and magnesium. Use leaves in salads, vegetables, sauces, vinegars, and butters.	A	3.5	2.95
Chives <i>Allium schoenoprasum</i>	Chopped leaves used as seasoning in soups, salads and sauces. Leaves stimulate appetite and improve digestion.	P	3.5	2.95
Chives, Garlic <i>Allium tuberosum</i>	Leaves are used to give a mild garlic flavor. Has flat solid leaves with 2 inch heads of white flowers.	P	3.5	2.95
Cilantro (Coriander) <i>Coriandrum sativum</i>	Use fresh leaves in salsa, marinades, and salads. Whole or ground seeds can be added to beans, baked goods, eggs, cheeses, and sausages.	A	3.5	2.95

Shady Acres Perennial Nursery

New Berlin, Wisconsin

262-679-1610

Common Name Genus / Species / Variety	Description	Plant Type	Size	Herbs Price
Dill, Fernleaf	Outstanding dill flavor. Dark green, finely cut foliage. (18") Use fresh leaves or seeds in soups, salads, vinegars, pickles, and herb-seasoning blends.	A	3.5	2.95
Dill, Mammoth	Excellent with fish, vegetables, and pickling. (30") Add fresh leaves to soups and salads.	A	3.5	2.95
Egyptian Onion <i>Allium cepa 'Proliferum'</i>	Use as you would a regular garden onion. Produces small onions on tips of leaves.	P	3.5	2.95
Fennel, Smokey-Bronze <i>Foeniculum vulgare 'Dulce'</i>	Same as sweet fennel, only foliage is a smokey-bronze color.	A	3.5	2.95
Fennel, Sweet <i>Foeniculum vulgare</i>	Use leaves in salads, rice, vegetables, butters and vinegars. Add seeds to sausages, duck, and breads.	A	3.5	2.95
Horehound <i>Marrubium vulgare</i>	Flavoring for candies, cookies, cough medicine and medicinal tea. Use in dried bouquets and crafts.	P	3.5	2.95
Hyssop <i>Hyssopus officinalis</i>	The pungent flavor of the leaves can be used in stews, salads, with tomatoes, or with poultry. Nice as a short hedge edging a border.	P	3.5	2.95
Lavender, English <i>Lavandula vera munstead</i>	Use in sachets, perfumes, potpourri and flower arrangements. Harvest flowers just as they open.	P	3.5	2.95
Leek <i>Allium porrum</i>	Produces a sheaf of leaves rather than a bulb. Mild and tender when blanched.	P	3.5	2.95
Lemon Balm <i>Melissa officinalis</i>	Use for flavoring cold drinks, salads, fruit cups and teas. Use dried in potpourri.	P	3.5	2.95
Lemon Grass <i>Cymbopogon citratus</i>	Dense clumps grown for aromatic lemon oil. Also used in Asian cooking and stir fry.	TP	3.5	2.95
Lemon Verbena <i>Aloysia triphylla</i>	Use leaves in sauces, teas, drinks, and desserts. Chop leaves finely, since they are tough.	TP	3.5	2.95
Lovage <i>Levisticum officinale</i>	Leaves and stalks have a very strong celery flavor. Use in salads, soups, stews, stuffings, or tomato juice.	P	3.5	2.95
Marjoram <i>Origanum majorana</i>	Sweet flowers in purple spikes to flavor meats, eggs and sausages. Try marjoram as a substitute if flavor of oregano is too strong.	TP	3.5	2.95
Mint, Applemint <i>Mentha sauveolens</i>	Used in drinks and jellies. Adds an interesting flavor. Can tolerate drier sites than other mints.	P	3.5	2.95
Mint, Chocolate <i>M. piperita 'Chocolate'</i>	'Peppermint Patty' scent; plants may grow to 2'.	P	3.5	2.95
Mint, Mojito <i>M. x villosa</i>	Bright green leaves used to flavor summer drinks.	P	3.5	2.95
Mint, Orange <i>M. citrata 'Orange'</i>	A good orange scent, used to flavor orange jelly. Dries well and can be used instead of lavender.	P	3.5	2.95
Mint, Peppermint <i>M. piperita</i>	Aggressive grower; characteristic peppermint scent and flavor.	P	3.5	2.95
Mint, Pineapple <i>M. suaveolens variegata</i>	Attractive green and cream variegated mint with a pineapple scent and mild apple mint flavor.	P	3.5	2.95

Shady Acres Perennial Nursery

New Berlin, Wisconsin

262-679-1610

Common Name Genus / Species / Variety	Description	Plant Type	Size	Herbs Price
Mint, Spearmint <i>M. spicata</i>	Used for flavoring sauces, juleps, and meat dishes. Bold spearmint flavor.	P	3.5	2.95
Oregano <i>Origanum vulgare</i>	Use leaves in salads, tomato sauces, stewed beef, soups, vinegars, and butters.	P	3.5	2.95
Oregano, Golden <i>O. vulgare aureum</i>	Lovely mound of golden foliage. Used the same as Oregano.	P	3.5	2.95
Oregano, Greek <i>O. heracleoticum</i>	It has a strong, earthy aroma and is most flavorful.	TP	3.5	2.95
Oregano, Italian <i>O. onites</i>	It has a light, warm flavor and is the preferred Oregano for Italian foods.	TP	3.5	2.95
Parsley, Curled <i>Petroselinum crispum</i>	Dark green, triple curled and handsome. Use leaves with sandwiches, meats, and butters. Freshens breath.	B	3.5	2.95
Parsley, Italian <i>Petroselinum crispum</i>	Dark green plain leaf: the gourmet's favorite. Used in salads and as a garnish in soups and meat dishes. The plain leaf forms have a better flavor.	B	3.5	2.95
Rosemary <i>Rosmarinus officinalis</i>	Excellent with lamb or pork. Used in tea, eggs, soup and vegetables. Dry to use in potpourri.	TP	3.5	2.95
Rosemary, Cascading <i>R. officinalis 'Prostrata'</i>	Cascading, dwarf form of Rosemary.	TP	3.5	2.95
Rue – Herb of Grace <i>Ruta graveolens</i>	Blue-green foliage. Unique leaves make it a nice ornamental herb.	P	3.5	2.95
Sage, Berggarten <i>Salvia o. 'Berggarten'</i>	Gray-green fragrant foliage used in stuffings, soups and meat dishes.	P	3.5	2.95
Sage, Common <i>Salvia officinalis</i>	Use leaves with breads, pork, sausage, stuffings, butters, and vinegars.	P	3.5	2.95
Sage, Compact	Compact form of Common Sage.	P	3.5	2.95
Sage, Golden <i>S. o. ictérina-aurea</i>	Compact grower with gold and green variegated foliage. Nice addition to the flower border.	TP	3.5	2.95
Sage, Pineapple <i>S. elegans</i>	Fresh sprigs serve as a fragrant garnish on a fruit platter. Bright red flowers.	TP	3.5	2.95
Sage, Purple <i>S. o. purpurascens</i>	Compact grower with reddish-purple foliage.	TP	3.5	2.95
Sage, Tricolor <i>S. o. 'Tricolor'</i>	Colorful purple, white and green foliage. Attractive in garden as an ornamental or in containers.	TP	3.5	2.95
Savory, Summer <i>Satureja hortensis</i>	Sweeter flavor than Winter Savory. Use in soups, beans, sausages, teas, butters, and jellies.	A	3.5	2.95
Savory, Winter <i>S. montana</i>	Semi-evergreen leaves used to flavor beans and other vegetables.	P	3.5	2.95
Stevia (Sweetleaf) <i>Stevia rebaudiana</i>	Edible leaves are many times sweeter than sugar without the calories.	TP	3.5	2.95

Shady Acres Perennial Nursery

New Berlin, Wisconsin

262-679-1610

Common Name Genus / Species / Variety	Description	Plant Type	Size	Herbs Price
Sweetgrass <i>Hierochloa odorata</i>	Fast spreading, sweet smelling, native grass used by a number of Indian tribes in ceremonies as perfume or burned as incense. Useful for wetlands, bog gardens, and shoreline plantings.	P	4.5	4.95
Tarragon, French <i>Artemesia dracunculus</i> 'Sativa'	Strong licorice flavor. Use leaves in salads, sauces, soups, butters, vegetables, and pickles. Rich in vitamins A and C.	P	3.5	2.95
Thyme, English <i>Thymus vulgaris</i>	Widely used as seasoning in soups, stews, meats and stuffing. Dried leaves and flowers can be used in potpourri or insect repelling sachets.	P	3.5	2.95
Thyme, Golden Lemon <i>Thymus c. 'Aureus'</i>	Lemon scented green leaves dappled in gold. Nice accent plant for the herb garden.	P	3.5	2.95
Thyme, Lemon <i>Thymus citriodorus</i>	Lemon scented thyme. Dry leaves to use in potpourri or insect repelling sachets.	P	3.5	2.95
Thyme, Silver Edge <i>Thymus vulgaris 'Argenteus'</i>	Variegated foliage. Thyme is known as the "blending" herb in cooking, because it pulls flavors together.	P	3.5	2.95

Vines

Campsis

Trumpet Vine

N	radicans	Vigorous, twining vine. Orange tubular flowers bloom in mid-summer. Attracts hummingbirds.	144"+	24"	July-Aug	☼☼	#1	11.95
----------	-----------------	--	-------	-----	----------	----	----	-------

Clematis see Perennial List

Humulus

Hops

lupulus 'Aureus'	(Golden Hops)	Twining vine with chartreuse leaves. Pale green, papery overlapping bracts cover cone-like fruiting structures. Zone 5.	144"+	24"	July-Aug	☼	#1	11.95
-------------------------	---------------	---	-------	-----	----------	---	----	-------

Hydrangea

Climbing Hydrangea

anomala petiolaris	Climbing Hydrangea offers beautiful and fragrant white flowers in early summer. Rich, green foliage and striking exfoliating bark. Does best in moist soil and some shade. May be somewhat slow to establish, but worth the effort.	144"+	72"	June-July	☼●	#3	24.95
---------------------------	---	-------	-----	-----------	----	----	-------

Parthenocissus

Ivy

quinquefolia 'Engelmannii'	(Engelman Ivy)	Vigorous, trouble-free vine for use as a climber or groundcover.	120"+	24"		☼☼	#1	14.95
tricuspidata	(Boston Ivy)	Will climb almost anything. Does not harm masonry walls. Great red fall color.	120"+	24"		☼☼	#1	14.95

Shady Acres Perennial Nursery

New Berlin, Wisconsin

262-679-1610

Specialty Annuals

Shady Acres also carries a nice selection of specialty annual plants for additional color and interesting foliage in the garden or hanging baskets and containers.

<i>Ageratum</i>	<i>Impatiens, New Guinea</i>
<i>Alternanthera</i>	<i>Impatiens, Trailing</i>
<i>Angelonia</i>	<i>Ipomoea batatas – Sweet Potato Vine</i>
<i>Argyranthemum – Marguerite Daisy</i>	<i>Lantana</i>
<i>Bacopa (Sutera)</i>	<i>Laurentia</i>
<i>Begonia</i>	<i>Lobelia</i>
<i>Bidens</i>	<i>Morning Glory</i>
<i>Bracteantha – Strawflower</i>	<i>Nasturtium</i>
<i>Calibrachoa- Million Bells</i>	<i>Nemesia</i>
<i>Castor Bean</i>	<i>Nicotiana sylvestris</i>
<i>Celosia – Cockscomb</i>	<i>Osteospermum – Cape Daisy</i>
<i>Coleus</i>	<i>Pansy</i>
<i>Datura – Angel's Trumpet</i>	<i>Pentas</i>
<i>Diascia – Twinspur</i>	<i>Petunia</i>
<i>Dichondra</i>	<i>Phormium</i>
<i>Euphorbia</i>	<i>Rudbeckia</i>
<i>Felicia – Blue Marguerite Daisy</i>	<i>Salvia</i>
<i>Fuchsia</i>	<i>Scaevola – Fan Flower</i>
<i>Gazania</i>	<i>Setcreasea</i>
<i>Gerbera</i>	<i>Swiss Chard 'Bright Lights'</i>
<i>Geraniums</i>	<i>Thunbergia – Black-eyed Susan Vine</i>
<i>Gomphrena</i>	<i>Tomato (Various types)</i>
<i>Grass: Carex – 'Toffee Twist'</i>	<i>Torenia</i>
<i>Grass: Juncus – Corkscrew Grass</i>	<i>Tulbagia – Society Garlic</i>
<i>Grass: Millet</i>	<i>Verbena</i>
<i>Grass: Pennisetum rubrum</i>	<i>Vinca vine</i>
<i>Grass: Pennisetum r. 'Fireworks'</i>	<i>Viola</i>
<i>Grass: Scirpus – Fiber Optic</i>	<i>...and more!</i>
<i>Hedera – Ivy</i>	
<i>Heliotrope</i>	

2016
Shady Acres Perennial Nursery
Top 10 List

Are you seeking mindfulness in each moment? How about well-being instead of stress? KEEP CALM and GARDEN ON. Each year, our garden center staff picks ten of our favorite perennials. We are pleased to suggest these plants to help bring harmony to your gardens from spring through fall.

Achillea 'Saucy Seduction' Yarrow is a dependable plant for sunny dry areas, spreading to fill in those tough-to-grow spots. This selection has long blooming fuchsia-pink blossoms that attract butterflies. The flowers are also useful as fresh cut or dried.

Brunnera 'Jack Frost' This perennial adds sparkle to a garden growing in light shade. Tons of little baby-blue flowers appear in spring. Then, the silvery heart-shaped leaves grow larger through the summer, putting on a spectacular display until frost.

Echinops ritro This tall perennial has spherical flowers that are eye catching and truly unique. Their metallic blue color complements other perennials blooming in late summer, like Echinacea and Heliopsis. Beneficial for the bees!

Euphorbia 'First Blush' We love the tri-colored foliage on this plant! A tidy mound of green, cream and pink looks soft and lush all season. The perky yellow flowers in spring are an added bonus.

Geranium 'Biokovo' A great low maintenance perennial. Forms a groundcover of citrus scented leaves that turn reddish in fall. Dainty white flowers touched with pink rebloom sporadically all summer.

Hemerocallis 'Barbara Mitchell' Every garden needs a few easy-to-grow daylilies. This elegant selection has large, soft pink blossoms with ruffled edges. Look for hummingbirds to hover about them!

Heuchera 'Midnight Rose' Coral bells provide fabulous foliage all season long. This one has deep purple-black leaves splashed with pink spots and flecks. Looks fantastic in a container garden too!!

Hosta 'Rhino Hide' The thickest leaves of any hosta! Cupped, puckered blue leaves have a lighter green center and show off the white flowers. Plant in combination with Aruncus, Carex and Tiarella in a partly shady area.

Nepeta 'Walkers Low' The name of this perennial is deceiving...it is not low growing. It is an all-time favorite of ours for its carefree nature, super long bloom time and aromatic foliage. Covered in lavender-blue flowers, bees and hummingbirds adore this plant!

Sisyrinchium 'Lucerne' This grass-like perennial is so cute! Its overall size is petite, making it great for edging. The purple-blue, star-like flowers bloom almost continuously and just make us smile ☺

Shady Acres Perennial Planting Instructions

Due to the differing nature of soil conditions, moisture, and exposure in our area, the following planting instructions are suggestions for successful perennial establishment.

1. **Soil Preparation:** Prepare the soil by mixing 2-3" of compost with the existing soil in the area to be planted. At Shady Acres, mushroom compost and cotton burr compost are available for purchase.
2. **Planting:** Dig the hole twice the size of the pot but no deeper. Carefully remove the plant from the pot. Place the plant into the hole making sure it is at the same depth that it was in the pot. Backfill with the prepared soil. Lightly pack the soil around the root ball leveling off the soil around the plant.
3. **Water:** Following planting, water the plants thoroughly. Be sure the root area of each plant receives ample water. (A root stimulator may be applied. Follow directions on product label.) As the plants become established, water as needed. Weather will determine how often to water. Warm, windy days may require daily watering, while under other conditions water may not be necessary for two days or longer. Check to see if plants need water by sticking a finger into the surrounding soil. If the top 1-2" of soil is dry, watering is recommended.
4. **Mulch:** Apply 1-2" of mulch to the newly planted garden. Keep the mulch away from the crown of the plant to reduce the risk of rot. Cocoa bean shells, pine needles, or a light layer of compost can be used as mulch and are available at Shady Acres.

We hope that this information helps in your gardening experience.

Garden Shop

Make a stop in the Shady Acres garden shop. You will find gardening essentials like comfortable gloves, sturdy tools, plant supports, and zinc plant labels. Fertilizers, ready-to-use plant care products, and informative reference books are also available.

Trendy garden décor is displayed in our garden shop as well as throughout our display gardens. Browse around, and you are sure to find a treasure for yourself or as a gift for a gardening friend.

Mulches and Soil Amendments

Cocoa Bean Shells	2 cu. ft. bag	4.95
Cocoa Bean/Rice Hull Mix	2 cu. ft. bag	7.95
Pine Needle Mulch	2 cu. ft. bale	9.95
Mushroom Compost	1 cu. ft. bag	4.95
Cotton Burr Compost	2 cu. ft. bag	9.95
Jolly Gardener C/B Potting Mix	2.8 cu. ft. bag	24.95

Mulch Coverage... Generally, mulch coverage is dependent upon soil type and the type of mulch. When applying mulch around plants, keep the mulch away from the crown (base) of the plant to decrease the incidence of rot. Cocoa bean mulch can be applied to a depth of 1", while pine needles can be spread up to 4" deep.

Depth of mulch	1 cu. ft. will cover
1"	12 ft ²
1½"	9 ft ²
2"	6 ft ²
3"	4 ft ²
4"	3 ft ²

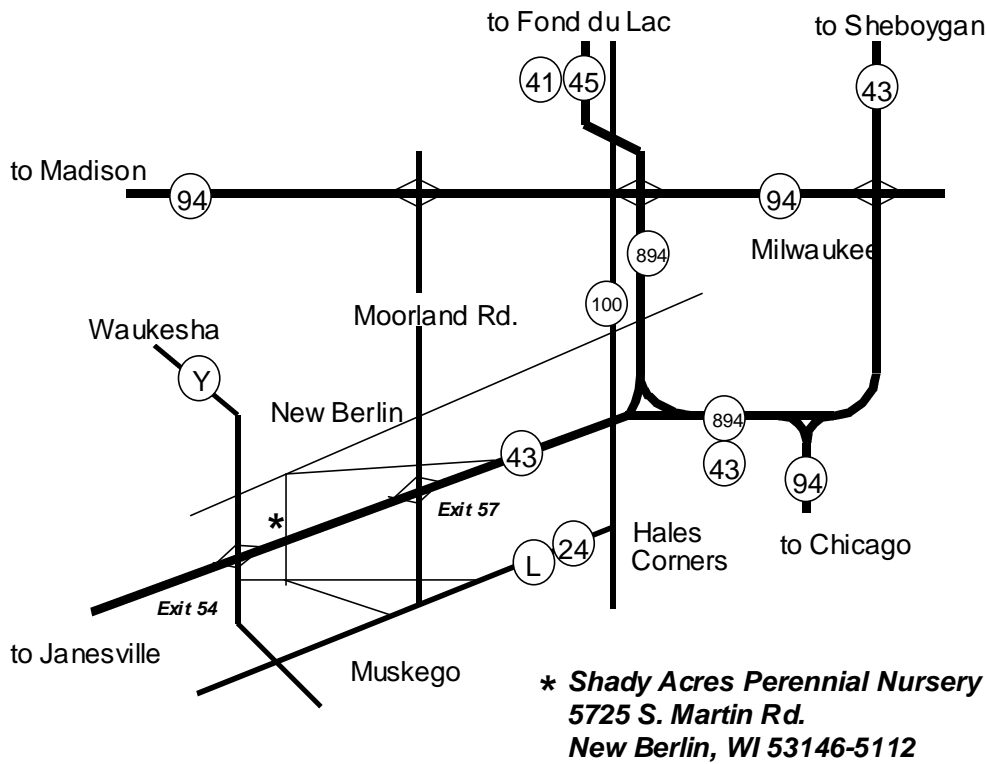

Shady Acres Perennial Nursery is a member of...

- Wisconsin Green Industry Federation
- Wisconsin Nursery and Landscape Association
- Commercial Flower Growers of Wisconsin



Shady Acres

Perennial Nursery

5725 South Martin Road
New Berlin, Wisconsin 53146