



Shady Acres
Perennial Nursery

1958 - 2018

60
years in the
Green Industry

New Berlin, WI

Perennials

2018

www.ShadyAcresNursery.com

262-679-1610

e-mail: ShadyAcresNursery@juno.com

Planting Guide

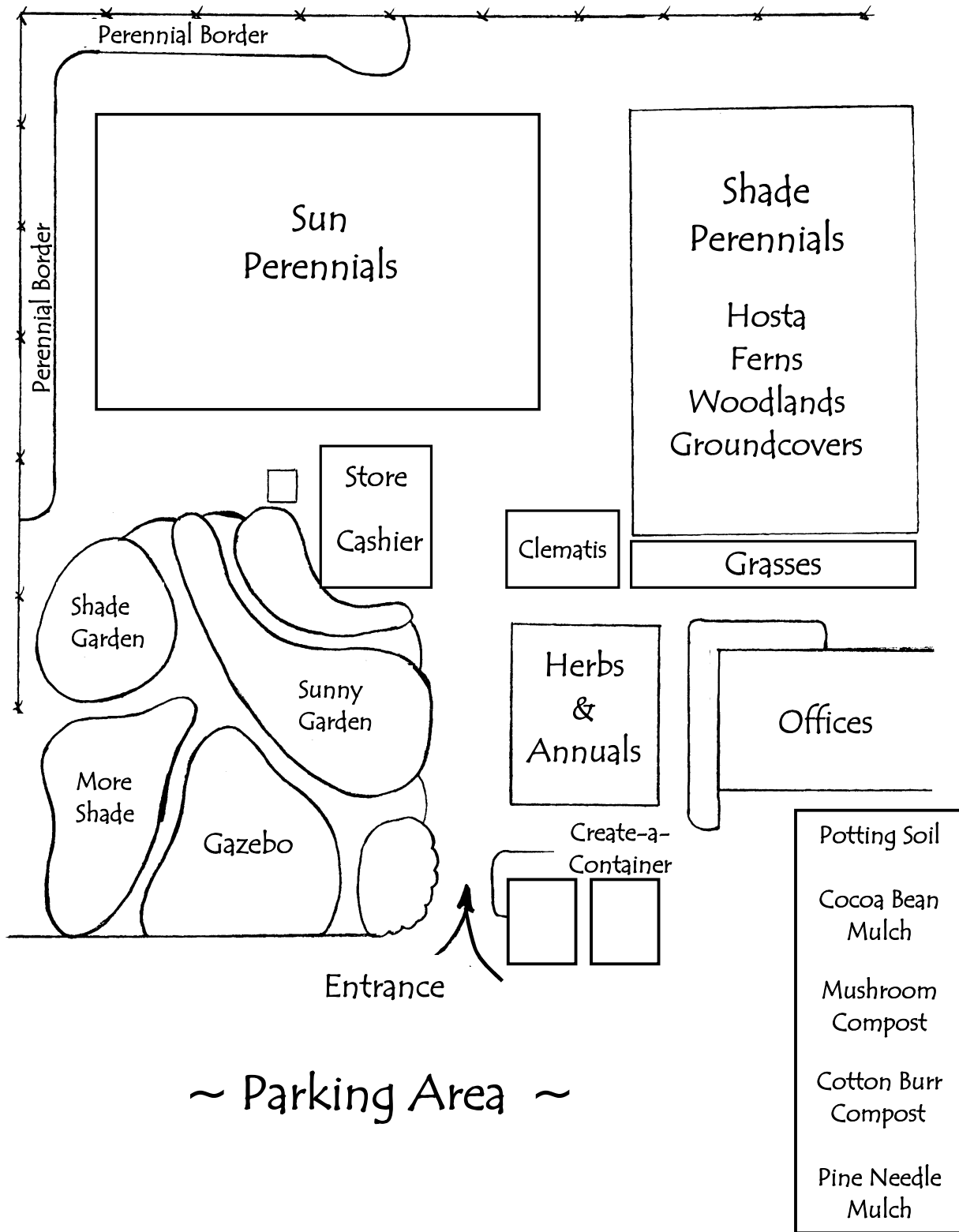

Garbe Enterprises, Inc. dba
Shady Acres Perennial Nursery
5725 South Martin Road
New Berlin, Wisconsin 53146-5112
phone: 262-679-1610
e-mail: ShadyAcresNursery@juno.com
web: www.ShadyAcresNursery.com

Welcome to Shady Acres Perennial Nursery

~ 2018 Gardening Season ~

Shady Acres is your destination for locally grown perennials. Since 1958, our family-owned business has been serving the green industry. Perennials are our specialty, and we are known for our outstanding selection of top-quality plants. We offer over 1200 varieties including perennials for sun or shade, ornamental grasses, native plants, groundcovers and herbs! We invite you to browse our garden center, where all the plants we grow are arranged in an easy-to-find fashion.

Perennials are the perfect choice for enhancing your outdoor areas. A garden that changes through all four seasons will bring years of beauty and enjoyment. Stroll through our many display gardens to see mature perennials growing in a garden environment. Come often to observe how the foliage and flowers change throughout the season. Then, use your creativity to design a garden that reflects your own personal style. This planting guide will assist in your planning and planting.

Take a look at our 2018 calendar of events. We encourage you to join us for special feature days during the season, where we highlight a specific group of plants. These are fun and informative days to help inspire your gardening experience. Also, take note of our garden center hours, as they change from month to month.

Our friendly staff welcomes your comments and questions. Whether you are new to perennial gardening or have years of "trowel and error", let us know how we can assist you. We hope gardening with perennials brings joy to you each day.

Celebrating 60 years of gardening together...

Thank you from all of us at Shady Acres!

P.S. Don't forget about our **GIFT CERTIFICATES** for your friends and relatives; ideal for house warmings, Mother's Day, Father's Day, birthdays and even Christmas.

Plant Guarantee

We guarantee our perennials to be healthy at the time of purchase. They will thrive under the appropriate growing conditions. If a perennial fails during the first (current) growing season, we will offer a one-time replacement perennial. Replacements are not guaranteed. We do not guarantee the hardiness of any perennial over winter. Our guarantee is excluded from acts of nature, neglect, or other events beyond our control.

*Please contact us for advice if you have any concerns about the health of your perennials.

Returned Checks

A service charge of \$40.00 will be added to any returned checks.

2018 Garden Center Hours

April	Monday-Friday	9:00 - 6:00
	Saturday	8:00 - 4:00
	Sunday	10:00 - 4:00
May, June	Monday-Friday	9:00 - 7:00
	Saturday	8:00 - 5:00
	Sunday	10:00 - 5:00
	<i>open Memorial Day</i>	9:00 - 4:00
July	Monday-Friday	9:00 - 6:00
	Saturday	8:00 - 4:00
	Sunday	10:00 - 4:00
	<i>closed Independence Day, July 4th</i>	
August, September, October	<i>by appointment only - call 262-679-1610</i>	
November, December	closed	
January, February, March	closed	

Table of Contents

Calendar of Events.....	4
Perennials.....	6
Clematis.....	15
Hemerocallis (Daylilies).....	23
Hosta.....	26
Grasses, Sedges, Rush.....	52
Herbs.....	56
Vines.....	59
Specialty Annuals.....	60
Top 10 List.....	61
Planting Instructions.....	62
Garden Shop.....	63
Mulches & Soil Amendments.....	63
Notes.....	64
Map.....	65

2018 Calendar of Events

----- June is Perennial Gardening Month -----

- June 16-17 **Feature Day: "Hosta Hoopla"** **Saturday and Sunday**
Join us on this day as we feature our extensive selection of hostas, the perfect plant for shady spots. Hostas of all kinds just in time for Father's Day!
- June 23 **Planting Project: "Create a Living Wreath"** **9:00 am**
You will plant sedums and hen-n-chicks in a moss-covered wreath. Please dress for planting.
Cost: \$39 All supplies provided. Pre-registration required. Space limited.
- July 14 **Feature Day: "Native Plants"** **Saturday**
Join us on this day as we feature plants native to Wisconsin, highlighting their benefits in the garden. Information on honey bees and butterflies too!
- July 14 **Nursery Tour: "Behind the Scenes at Shady Acres"** **9:00 am**
Join Jim Garbe for a tour of our growing areas. Wear shoes for walking.
Pre-registration required.
- July 31 Garden Center Closes for the season.

Note:

Our garden center does not have regular hours in August, September and October. If you are in need of perennials during these late summer/early fall months, please contact us for availability. We will be happy to assemble your plants and arrange a convenient time for pick up.

Call 262-679-1610 or email ShadyAcresNursery@juno.com

Genus	Common Name	(H)	(S)	Bloom	Loc.	Perennials	
						Species/Variety	Size
Achillea	Yarrow						
Useful for the border, wild garden or meadow. Good for cut flowers, suitable for dried arrangements. Due to the scented leaves, yarrow is deer resistant.							
	millefolium	30"	18"	June-Sept	☼	4.5	4.95
	m. 'Saucy Seduction' (PP20782) Rosy-pink flowers with yellow centers. Sturdy, upright habit.	27"	18"	June-Aug	☼	4.5	4.95
	m. 'Strawberry Seduction' (PP18401) Large clusters of strawberry red flowers with a gold center. Mature flowers turn buff yellow, extending interest into the later season. Compact, sturdy and robust habit.	24"	18"	June-Aug	☼	4.5	4.95
	m. 'Sunny Seduction' (PP20808) Flowers open intense lemon yellow, lightening to pastel yellow. Compact, sturdy and robust habit.	24"	18"	June-Aug	☼	4.5	4.95
	'Moonshine' Sulfur yellow flowers with grayish foliage.	24"	18"	June-Sept	☼	4.5	5.95
	'Terracotta' Silvery foliage. Bright peach flowers slowly turn to rich hues of earthy red-orange.	24"	18"	June-Aug	☼	#1 4.5	8.95 4.95
Acorus	Sweet Flag						
N	calamus Sword shaped bright green leaves are sweetly scented. Prefers wet soil or shallow water. Naturalizes via rhizomes.	30"	18"	June	☼☉	4.5	5.95
Agastache	Licorice Plant						
Very aromatic licorice scented leaves. 4-6" flower spikes on strong stems. These plants will attract birds all season. Nice cut flower. Prefers average to dry locations. Great container plant. Deer resistant.							
	'Blue Fortune' Deep blue flower spikes.	30"	18"	July-Sept	☼	4.5	4.95
	'Bolero' Vivid rose-purple flower spikes rise above bronzy green foliage. Forms a compact clump. Long blooming.	16"	18"	July-Sept	☼	4.5	4.95
☉	'Kudos Mandarin' (PP25381) Long lasting bright orange plume-like flowers over gray-green foliage. Neat, compact habit.	18"	18"	July-Sept	☼	4.5	4.95
Ajuga	Bugleweed						
Grows well under trees where a lawn is difficult to establish. Forms a dense evergreen mat.							
	'Chocolate Chip' Small, rich chocolate colored narrow leaves, blue flowers in spring. Petite groundcover.	4"	12"	May-June	☼☉	4.5	4.95
	r. 'Black Scallop' (PP15815) Glossy, near black scalloped leaves. Deep blue flowers on short spikes in spring.	4"	12"	May-June	☼☉	4.5	4.95
	r. 'Burgundy Glow' Tri-color foliage, green, cream and bright pink. Blue flowers.	4"	12"	May-June	☼☉	4.5	4.95
	r. 'Catlin's Giant' Extra large leafed Ajuga. Deep bronze to purple foliage. Blue flower spikes.	6"	12"	May-June	☼☉	4.5	4.95
Alcea	Hollyhock						
Very easy to grow plants in full sun and well drained soil. Use in the back of the border or against a wall or fence.							
	'Single Mix' Old fashioned variety. Mixed colors.	60"	18"	July-Aug	☼	4.5	4.95
	rosea Halo Series – Cerise Large, cerise pink flowers with a deep purple halo.	60"	18"	July-Aug	☼	#1	7.95
	rosea 'Mars Magic' (Spotlight Series) Bright red single flowers. True perennial.	60"	18"	July-Aug	☼	#1	7.95
	rosea 'Radiant Rose' (Spotlight Series) Rose-pink single flowers. Said to be truly perennial.	60"	18"	July-Aug	☼	#1	7.95
☼ sun ☉ part shade ● shade ☺ new variety (H) height (S) spacing (TP) tender perennial N native							

Genus Species/Variety	Common Name	(H)	(S)	Bloom	Loc.	Perennials	
						Size	Price
Alchemilla Lady's Mantle							
Clusters of small flowers bloom just above the fan shaped foliage.							
erythropoda	Bluish green foliage with light yellow flower.	8"	15"	July-Aug	☼☉	4.5	5.95
mollis 'Thriller'	Gray-green hairy leaves with lime-green flowers. Useful in a variety of settings.	18"	18"	July-Aug	☼☉	4.5	4.95
						#1	7.95
Allium Ornamental Onions							
Adored by butterflies and honeybees. Deer and rabbit resistant.							
angulosum 'Summer Beauty'	Long blooming, large pink globular flowers over glossy green foliage.	16"	18"	July-Aug	☼	4.5	5.95
=== 2012 WNA Plant of the Year ===							
N cernuum	(Nodding Pink Onion) A native prairie plant that produces large globes of white flowers that turn to pink as they age.	18"	18"	July-Aug	☼	4.5	5.95
'Millennium'	A profusion of bright rose-purple flower globes upon shiny deep green foliage. Compact, strong grower.	16"	18"	July-Aug	☼	4.5	5.95
=== 2018 PPA Plant of the Year ===							
☉ s. 'Blue Eddy'	Pinwheel-like rosettes of blue-green foliage resemble small swirling eddies of water. Flowers in late summer with lilac pink one inch globes. Does not reseed.	10"	15"	July-Aug	☼	4.5	5.95
s. 'Medusa'	(PPAF) Snaky, twisty narrow leaves form a low mound. Amethyst purple flowers are 2" round.	20"	18"	July-Aug	☼	4.5	5.95
Amorpha Lead Plant							
N canescens	U.S. native for dry or well drained sites. Large plant with hairy, white leaflets. Blue flower spikes.	48"	24"	June-July	☼	#1	8.95
Amsonia Blue Star Flower							
Low maintenance perennial native to eastern United States.							
'Blue Ice'	A long blooming, compact selection from <i>A. tabernaemontana</i> . 'Blue Ice' has dark blue buds and flowers. Dark green foliage turns bright yellow in the fall.	15"	18"	June-Sept	☼☉	4.5	5.95
=== 2008 WNA Plant of the Year ===							
hubrichtii	(Arkansas Amsonia) Graceful 3-4' plant with very fine foliage and clusters of steel blue flowers. Excellent golden fall color.	42"	24"	May-June	☼☉	#1	8.95
=== 2011 PPA Plant of the Year ===							
tabernaemontana	(Willow Amsonia) Pale blue, star-like flowers. Very hardy. Disease and pest resistant.	36"	24"	June-Sept	☼☉	#1	8.95
☉ t. 'Storm Cloud'	New stems emerge near-black. Dark green leaves are covered with light periwinkle blue, star shaped flowers. Wide, mounded habit.	24"	24"	June-Sept	☼☉	#1	11.95
Anacyclus Mt. Atlas Daisy							
pyrethrum var. depressus	Low growing plant with white daisy-like flowers tipped red. Nice rock garden plant.	4"	12"	May	☼	4.5	4.95
Anaphalis Pearly Everlasting							
margaritacea 'New Snow'	(Neuschnee) This plant is a favorite larval food of the American painted lady butterfly. Small white flowers resembling pearls in 3-4" clusters. Flowers can also be dried for use in arrangements.	24"	15"	July-Aug	☼	4.5	4.95

☼ sun ☉ part shade ● shade ☺ new variety (H) height (S) spacing (TP) tender perennial N native

Genus Species/Variety	Common Name	(H)	(S)	Bloom	Loc.	Perennials		
						Size	Price	
Anchusa	Bugloss							
Sturdy, upright plants for sun to light shade. Large lance shaped foliage has coarse, hairy texture.								
azurea 'Loddon Royalist'	Bushy plant with royal blue buttercup-like flowers.	36"	18"	June-Aug	☼☉	#1	9.95	
Andropogon (Big Bluestem) see <i>Grasses, Sedges, and Rush Section</i>								
Anemone	Windflower							
A mixture of spring and late summer bloomers for low maintenance areas. Forms a substantial mound of foliage low to the ground. Flowers appear on long stems, well above the foliage. Prefers moist soil.								
☉	hybrida 'Honorine Jobert'	A classic cottage garden perennial for late season interest. Single, pure white flowers with yellow centers are produced atop tall, wiry stems over attractive dark green foliage.	36"	18"	Aug-Sept	☉	#1	9.95
	hybrida 'Pamina'	Striking semi-double lavender rose blooms above green foliage. Late season cut flower.	30"	18"	Aug-Sept	☉	#1	9.95
	h. 'Whirlwind'	Semi-double white flowers, yellow center.	36"	18"	Aug-Sept	☉	#1	9.95
	sylvestris (Snowdrop Anemone)	Fragrant white flowers over light green foliage.	10"	12"	May-June	☼☉	4.5	4.95
	tomentosa 'Robustissima'	The hardiest and most vigorous growing of the fall flowering Anemones. 2-3" rose-pink flowers, yellow center.	30"	15"	Aug-Sept	☉●	4.5	6.95
Aquilegia	Columbine							
Distinctive flowers high above erect clumps of basal foliage with slender branching stems. You may find columbine seedlings popping up around your garden once your plants are established.								
	alpina (Alpine Columbine)	Short form, blue flowers.	18"	15"	May-June	☼☉	4.5	4.95
	'Biedermeier'	Medium size with mostly blue and white.	12"	15"	May-June	☼☉	4.5	4.95
N	canadensis (Wild Columbine)	Native columbine with red flowers, yellow centers.	30"	15"	May-June	☼☉	4.5	4.95
	chrysantha 'Yellow Queen'	Yellow flowers.	24"	15"	May-June	☼☉	4.5	4.95
☉	Songbird 'Blue Bird'	Upright sky-blue and white flowers. Also, nice flowers for cutting.	20"	15"	May-June	☼☉	4.5	4.95
	Songbird 'Cardinal'	Large red and white flowers are upward-facing with long spurs.	20"	15"	May-June	☼☉	4.5	4.95
	Songbird Mix	A glorious range of colorful upright flowers.	20"	15"	May-June	☼☉	4.5	4.95
Arabis	Rockcress							
	'Lotti Deep Rose'	Foliage is bright green and tightly mounded. Covered in vibrant magenta pink blossoms. Great for rock gardens and crevices.	6"	12"	April-May	☼	4.5	4.95
Aralia	Golden Japanese Spikenard							
	cordata 'Sun King'	This tropical looking beauty brightens up the shade garden with its very large, compound, bright gold leaves. Color is greener in more shade. Tiny white flowers give way to purple-black berries in fall, which birds will eat.	36"	36"	July-Aug	☉	#1	11.95

☼ sun ☉ part shade ● shade ☉ new variety (H) height (S) spacing (TP) tender perennial N native

Genus Species/Variety	Common Name	(H)	(S)	Bloom	Loc.	Perennials	
						Size	Price
Arisaema Jack-in-the-Pulpit							
N <i>triphillum</i>	Native woodland wildflower. The flower is a brownish green hood. Brilliant red berries in fall. This plant requires a rich, humus soil.	24"	12"	April-June	☉●	4.5	5.95
Armeria Sea Thrift							
<i>maritima</i> ' Splendens '	Bright rose flowers over tufts of evergreen foliage.	8"	15"	May-June	☼	4.5	4.95
Artemesia Wormwood							
Prefers sunny dry location, dislikes excessive water or fertilizer.							
<i>ludoviciana</i> ' Valerie Finnis '	Wide, showy silvery gray leaves that look like felt.	24"	15"		☼	4.5	4.95
<i>schmidtiana</i> ' Silvermound '	Dense mound of silvery, ferny foliage. Full sun for best performance.	10"	15"		☼	4.5	4.95
<i>stelleriana</i> ' Silver Brocade '	Excellent accent plant. Hardy. Very much resembles the annual 'Dusty Miller'.	12"	15"		☼	4.5	4.95
Aruncus Goats Beard							
Interesting shrub-like perennials with many branching stems. Creamy white flowers appear above the foliage.							
<i>aethusifolius</i>	Creamy white flowers on red stems, finely cut foliage. Miniature form.	12"	18"	June-July	☼●	4.5	6.95
<i>dioicus</i> (sylvestris)	Astilbe-like ivory white flowers on tall plumes. Large plant for the shade garden or border.	60"	30"	June-July	☉●	#1	9.25
' Misty Lace ' (<i>PP15798</i>)	Perfect size for smaller gardens! Large, creamy white, feathery plumes on dark red stems.	30"	24"	June-July	☉●	#1	11.95
Asarum Ginger							
N <i>canadense</i> (Wild Ginger)	Heart shaped leaves. Requires humus soils. Good woodland groundcover.	6"	15"	May	●	4.5	5.95
<i>europaeum</i> (European Ginger)	Very glossy green foliage, evergreen. Excellent substance.	6"	15"	May	●	#1	9.95
Asclepias Butterfly Weed							
N <i>incarnata</i> (Swamp Milkweed)	Clusters of upturned pink flowers attract butterflies. Better for wetter conditions.	48"	18"	June-July	☼	4.5	6.25
i. ' Ice Ballet '	Bright white form of <i>incarnata</i> . Good cut flowers.	48"	18"	June-July	☼	4.5	6.25
N <i>syriaca</i> (Common Milkweed)	Leaves of milkweed are a food source for Monarch butterfly caterpillars. Pinkish-purple flowers are nectar source for many butterflies. Large seed pods split open in fall releasing silky white seeds easily dispersed by the wind.	30"	24"	June-Aug	☼	#1	9.25
N <i>tuberosa</i> (Butterfly Weed)	Native plant with orange flowers for dry sunny areas. Very attractive to butterflies. Slow to emerge in spring.	30"	18"	June-Aug	☼	4.5	6.25
=== 2017 PPA Plant of the Year ===							
t. ' Hello Yellow '	Showy bright yellow flowers. Best in warm, dry, or well drained sites. Great for butterflies.	30"	18"	June-Aug	☼	4.5	6.25
N <i>verticillata</i> (Whorled Milkweed)	Greenish-white flowers attract many pollinators, including Monarch butterflies. Thin "whorled" leaves give this native plant a delicate texture. Narrow pods form in late summer.	20"	18"	June-Aug	☼	4.5	5.95

☼ sun ☉ part shade ● shade ☉ new variety (H) height (S) spacing (TP) tender perennial N native

Genus Species/Variety	Common Name	(H)	(S)	Bloom	Loc.	Perennials	
						Size	Price

Aster Hardy Aster

Excellent group of perennials for summer and fall flowers. Easy to grow, dependable plants. All do best in sunny, dry soils. Pinch back through the middle of June to get full, bushy plants in fall.

	'Alert' Compact plant with deep crimson-red flowers.	12"	18"	Aug-Oct	☼	4.5	4.95
N	novae-angliae (New England Aster) Native plant. Flower colors can range from pink to blue to purple.	36"	18"	Aug-Oct	☼	4.5	4.95
	n.a. 'Alma Pötschke' Masses of large, glowing, neon-rose pink flowers make a spectacular display in fall.	36"	18"	Aug-Oct	☼	4.5	4.95
	n.a. 'Purple Dome' Compact heavy bloomer, purple flower. Disease resistant. Always a hit in the fall garden.	18"	18"	Aug-Oct	☼	4.5	4.95
	oblongifolius 'October Skies' (Aromatic Aster) A short, bushy selection with mint-scented foliage. Produces daisy-like, sky blue flowers with yellow centers.	18"	18"	Aug-Oct	☼	4.5	4.95
	'Professor Kippenburg' Lavender blue semi-double flower.	12"	18"	Aug-Oct	☼	4.5	4.95
☺	t. 'Wartburg Star' Early blooming Aster. Large, daisy-like violet flower with yellow center.	15"	18"	May-June	☼	4.5	4.95

Astilbe False Spirea

Spikes of graceful plumes, mostly erect but some arching types. Foliage varies from shiny light green to remarkably dark. Taller varieties can be used for cut flowers. Most Astilbes prefers a rich, moist soil in a semi-shade location. If grown in full sun, give them plenty of water, especially at bloom time.

The Astilbe bloom season extends from early to late summer. Therefore, the varieties marked with an "E" will bloom in approximately the first third of that period, those marked with an "M" in the second third, and those marked with an "L" in the last third. Sometimes there is an overlap between bloom times and that is indicated by "M – L" for mid to late season.

	'Bressingham Beauty' Dusty salmon-rose flowers on gracefully arching plumes.	36"	18"	E – M	☼●	#1	9.25
☺	'Cappuccino' (PP24940) Pure white plumes on contrasting red stems. Dark bronze foliage changing to green. Very floriferous!	24"	18"	E – M	☼	#1	8.95
	chinensis 'Pumila' Compact, lilac-pink flower, grows in the sun. Good groundcover.	10"	18"	L	☼●	4.5	5.95
	chinensis 'Purpurkerze' Lilac colored flowers. Shiny dark foliage.	36"	18"	L	☼●	#1	8.95
	chinensis 'Visions' Sweetly scented, upright lilac-purple plumes. Excellent plant.	15"	18"	M – L	☼●	#1	9.25
	=== 2001 WNA Plant of the Year ===						
	chinensis 'Visions in Pink' (PP11860) Dense upright pink plumes with medium blue-green foliage. Slightly fragrant. Strong variety that can withstand dry conditions.	18"	18"	E – M	☼●	#1	9.25
	chinensis 'Visions in Red' (PP11965) Deep reddish purple flowers emerge from deep red buds. Red stems and bronze-green foliage enhance the vibrant blossoms.	15"	18"	E – M	☼●	#1	9.25
	chinensis 'Visions in White' (PP18965) Large creamy white flower plumes stand above a robust clump of glossy green leaves. Handles warm, dry summer conditions well.	24"	18"	E – M	☼●	#1	9.25
	'Delft Lace' (PP19839) Lacy, deep blue-green foliage with red highlights. Red buds open to soft apricot-pink flowers. Seed panicles are red through summer.	30"	18"	E – M	☼●	#1	9.25
	'Deutschland' White flowers, green foliage.	24"	18"	E	☼●	4.5	5.95
	'Fanal' Dark red flowers with dark green, deeply cut foliage.	24"	18"	E - M	☼●	4.5	5.95
	'Maggie Daley' Purple flowers and dark foliage.	28"	18"	M	☼●	#1	8.95

☼ sun ☼ part shade ● shade ☺ new variety (H) height (S) spacing (TP) tender perennial N native

Genus Species/Variety	Common Name	(H)	(S)	Bloom	Loc.	Perennials	
						Size	Price
Astilbe	False Spirea	<i>(continued)</i>					
'Montgomery'	Bright red flowers.	24"	18"	M - L	☉●	4.5	5.95
						#1	8.95
'Peach Blossom'	Light pink flowers, light green foliage.	20"	18"	E - M	☉●	4.5	5.95
						#1	8.95
'Red Sentinel'	Vibrant scarlet-red flowers, dark green foliage.	28"	18"	M	☉●	4.5	5.95
						#1	8.95
'Rheinland'	Pink flowers, green foliage, profuse early bloomer.	24"	18"	E	☉●	4.5	5.95
						#1	8.95
'Snowdrift'	White flowers. Light green foliage.	24"	18"	M	☉●	#1	8.95
'Sprite'	Shell pink flowers, dark green foliage.	12"	18"	L	☉●	4.5	6.25
	=== 1994 PPA Plant of the Year ===						
☺ 'Younique Pink'	(PP19841) Compact plant with large full plumes. Striking pink flowers. Also, great for containers.	18"	18"	E	☉	#1	8.95
☺ 'Younique Ruby Red'	(PP19847) Compact plant with large full plumes. Ruby red flowers.	18"	18"	M	☉	#1	8.95
Aubrieta	Purple Rock Cress	A fine plant for borders or rock gardens.					
'Purple Gem'	Compact plant with glowing purple flowers.	6"	12"	April-June	☼	4.5	4.95
Aurinia (Alyssum)	Basket of Gold						
saxatilis 'Gold Dust'	Golden-yellow flowers cover the gray-green foliage.	10"	12"	May-June	☼	4.5	4.95
Baptisia	False Indigo						
☺ 'American Goldfinch'	(PPAF) Golden yellow flower spikes rise above its wide habit. Very floriferous. This plant will fill a large space in your garden!	36"	24"	June	☼☉	#3	18.95
N australis	Beautiful bush-sized perennial with olive green foliage, blue flowers. Interesting black seedpods.	48"	24"	June	☼☉	4.5	5.95
						#1	8.95
☺ 'Brownie Points'	(PP26624) Carmel brown flowers with yellow keels. Long blooming!	36"	24"	June	☼☉	#3	18.95
☺ 'Grape Taffy'	(PP26587) Reddish-purple flowers look like grapes on a vine. Attractive green foliage. Compact grower.	24"	24"	June	☼☉	#1	8.95
N leucantha	Similar to <i>Baptisia australis</i> with white flowers.	36"	24"	June	☼☉	4.5	5.95
	'Purple Smoke' (Wild Indigo) Charcoal gray stems with blue-green foliage and purple flowers. Vigorous grower.	36"	24"	June	☼☉	#1	8.95
Bergenia	Saxifraga / Pig Squeak	Shiny, thick cabbage like foliage forms an attractive groundcover. Foliage turns to bronze color near winter and stays this color throughout the winter. Flowers very early on thick branched stems just above the foliage.					
'Sakura'	Large, intense pink flowers. The thick green leaves are evergreen. Deer and rabbit resistant.	16"	18"	April-May	☼●	4.5	4.95
'Winterglut'	Bright red flowers. An improved 'Rotblum' with more vivid deep ruby-red winter foliage.	10"	18"	April-May	☼●	4.5	4.95
Boltonia	Bolton's Aster						
asteroides 'Snowbank'	Large background plant with clouds of white flowers.	40"	24"	Aug-Oct	☼	#1	7.95

☼ sun ☉ part shade ● shade ☺ new variety (H) height (S) spacing (TP) tender perennial N native

Genus Species/Variety	Common Name	(H)	(S)	Bloom	Loc.	Perennials	
						Size	Price

Bouteloua (Sideoats) see *Grasses, Sedges, and Rush Section*

Brunnera Siberian Bugloss

Large neat clumps of dark green hairy foliage. Each leaf is heart shaped and grows larger after flowering. Prefers light shade. Will tolerate full sun but require plenty of moisture.

macrophylla (Siberian Bugloss) Neat clumps of dark green foliage and Forget-Me-Not-like blue flowers.	15"	18"	May-June	☉●	#1	9.95
m. 'Emerald Mist' (PP20460) Silver bars form a silver collar around the perimeter of the leaf. Very light silver dusting over the entire leaf. Baby blue flowers in spring.	15"	18"	May-June	☉●	#1	14.95
m. 'Jack Frost' (PP13859) This plant displays a frosty silver overlay with light green veins. The leaves resemble crackled porcelain. Blue flowers in spring. ==== 2012 PPA Plant of the Year ====	15"	18"	May-June	☉●	#1	14.95
m. 'Looking Glass' (PP17829) Leaves are all-over silver. Clusters of tiny blue flowers float above the foliage in spring. Great plant to brighten a shady spot.	15"	18"	May-June	☉●	#1	14.95

Buddleia Butterfly Bush

Deciduous shrub that freezes back to the ground. Comes back from the root and is covered with flowers that are attractive to butterflies and hummingbirds. Needs to be mulched in the winter and cut down to the ground in spring.

Buzz Series Hot Raspberry Long blooming dark pink flowers. Shorter variety.	48"	36"	July-Sept	☼	#1	9.95
Buzz Series Midnight Velvety purple fragrant flowers. Shorter variety.	48"	36"	July-Sept	☼	#1	9.95
☺ Buzz Series Ivory (PPAF) Ivory flowers. Shorter variety.	48"	36"	July-Sept	☼	#1	9.95
☺ Buzz Series Sky Blue (PPAF) Sky-blue flowers. Shorter variety.	48"	36"	July-Sept	☼	#1	9.95
davidii 'Black Knight' Dark purple flowers.	60"	36"	July-Sept	☼	#1	9.95
d. 'Pink Delight' Pink flowers.	60"	36"	July-Sept	☼	#1	9.95
☺ 'Golden Glow' Fragrant yellow-orange flowers.	60"	36"	July-Sept	☼	#1	9.95

Calamagrostis (Feather Reed Grass) see *Grasses, Sedges, and Rush Section*

Calamintha Calamint

nepeta 'Montrose White' Clear white flowers all summer. Excellent habit, stays upright without flopping. Self-cleaning, does not hold its seed heads. ===== 2010 WNA Plant of the Year =====	15"	18"	June-Sept	☼	4.5	4.95
--------------------------------------------------------------------------------------------------------------------------------------------------------------------------------------------------------	-----	-----	-----------	---	-----	------

Callirhoe Winecups

involutrata Low growing, cut leaf foliage with bright purple, cup-shaped flowers all summer.	12"	15"	June-Aug	☉	4.5	5.95
-----------------------------------------------------------------------------------------------------	-----	-----	----------	---	-----	------

Caltha Marsh Marigold

N palustris Shiny green foliage, yellow-gold flower, native wetland plant.	10"	12"	April-May	☼	4.5	5.95
-----------------------------------------------------------------------------------	-----	-----	-----------	---	-----	------

☼ sun ☉ part shade ● shade ☺ new variety (H) height (S) spacing (TP) tender perennial N native

Genus Species/Variety	Common Name	(H)	(S)	Bloom	Loc.	Perennials	
						Size	Price
Campanula	Bellflowers						
Well drained soil required for most Campanula varieties.							
	carpatica 'Blue Clips' Compact, mounding foliage with an abundance of blue flowers.	6"	12"	June-Sept	☼	4.5	4.95
	c. 'Pearl Deep Blue' The deepest blue <i>carpatica</i> on the market. Flowers two weeks earlier than 'Blue Clips'.	6"	12"	June-Sept	☼	4.5	4.95
☺	c. 'Pearl White' Pure, crisp white bell-shaped blooms cover mounds of compact foliage. Heat tolerant.	8"	12"	June-Sept	☼	4.5	4.95
	c. 'White Clips' Compact, mounding foliage with loads of white flowers.	6"	12"	June-Sept	☼	4.5	4.95
	glomerata 'Emerald' (PP18343) Sky blue flowers, edged purple, sit atop dark stems. Useful in perennial border garden or a container garden.	20"	15"	June-July	☼☺	4.5	5.95
☺	glomerata 'Freyia' (PP22738) Dark violet flowers are clustered on strong upright stems.	16"	15"	June-July	☼☺	4.5	6.95
	portenschlagiana 'Birch Hybrids' Lilac-blue flowers on short plant.	6"	12"	June-July	☼	4.5	4.95
	poscharskyana 'Blue Waterfall' (Serbian Bellflower) Vigorous, low-growing, spreading habit. Deep blue star-shaped flower.	8"	15"	June-July	☼	4.5	4.95
	rotundifolia (Bluebells of Scotland) Round basal foliage 6" high with nodding blue flowers.	15"	15"	July-Aug	☼☺	4.5	4.95
	'Sarasstro' Dark purple flower buds open to big blue-purple flowers up to 3". One of the best.	16"	18"	June-Aug	☼☺	#1	9.95

Campsis (Trumpet Vine) see *Vines Section*

Carex (Sedge) see *Grasses, Sedges, and Rush Section*

Caryopteris Bluebeard

Rounded shrub which grows to 3'. Silvery foliage with excellent spirea like flowers. Mulching for the winter is a good idea. Plant can be cut back to 8-10" in the spring each year.

	clandonensis 'Dark Knight' Deep rich purple flowers with dark green foliage.	36"	24"	July-Sept	☼	#1	9.25
	c. 'Longwood Blue' Upright growing habit. Silvery foliage with sky blue flowers.	40"	24"	July-Sept	☼	#1	9.25

Catananche Cupid's Dart

Drought tolerant perennial that can be used as cut or dried flower.

	caerulea Gray-green clumps of foliage, blue flowers.	15"	12"	June-Sept	☼	4.5	4.95
--	-------------------------------------------------------------	-----	-----	-----------	---	-----	------

Ceanothus New Jersey Tea

This plant develops a very large taproot, allowing it to tolerate drought conditions once established. Hummingbirds feed on the small insects that pollinate the flowers.

N	americanus A durable shrub covered with bright white clusters of flowers.	36"	24"	July-Aug	☼☺	#1	8.95
----------	----------------------------------------------------------------------------------	-----	-----	----------	----	----	------

☼ sun ☺ part shade ● shade ☺ new variety (H) height (S) spacing (TP) tender perennial N native

Genus Species/Variety	Common Name	(H)	(S)	Bloom	Loc.	Perennials	
						Size	Price
Centaurea	Perennial Bachelor Button						
Deep cut silvery leaves. Needs well-drained soil. Good cut or dried flower.							
macrocephala	Good tall, landscape plant with yellow flowers.	36"	24"	June-July	☼	#1	7.95
montana	Large cornflower-blue flowers. Fuzzy silvery green foliage.	24"	18"	June-July	☼	4.5	4.95
m. 'Amethyst in the Snow' (PP18284)	White flowers with royal purple centers over mounds of silver-green foliage.	16"	18"	June-July	☼	4.5	4.95
Centranthus	Jupiter's Beard						
Dense clusters of fragrant flowers above rich green foliage. Not particular about soil conditions.							
ruber	Blue-green foliage, pink-red flowers.	30"	15"	June-July	☼	4.5	4.95
Cerastium	Snow in Summer						
One of the most valuable plants in the rock garden. Nice in containers.							
tomentosum	Silvery foliage, good spreader with white flower.	6"	18"	May-June	☼	4.5	4.95
Chasmanthium (Northern Sea Oats) see Grasses, Sedges, and Rush Section							
Chelone	Turtlehead						
Dense, upright plants producing stiff stems with dark green leaves. Flowers are tightly clustered directly above the foliage. Plants do best when soil is moist at all times. Good as cut flowers.							
'Hot Lips'	Deep green foliage topped with rose-pink flowers in late summer. Red stems for most of the season.	30"	15"	Aug-Sept	☼	4.5	5.95
	==== 2016 WNLA Plant of the Year ====					#1	8.95
☼ obliqua 'Alba'	Bright white flowers over dark green foliage.	30"	15"	Aug-Sept	☼	4.5	5.95
Chrysanthemum (Dendranthema)							
These hardy, fall blooming chrysanthemums perform best if pinched back through June.							
rubellum 'Clara Curtis'	Rose-pink daisy type flowers. Great for pollinators!	20"	18"	Aug-Oct	☼	#1	7.95
r. 'Mary Stoker'	Straw yellow flower turning gold with age.	24"	18"	Aug-Sept	☼	#1	7.95
Cimicifuga (Actaea)	Snakeroot / Bugbane						
Beautiful plants for late season bloom. Large plants with bottle brush like flowers. The flowers are fragrant and repel insects. Prefers edge of the woods; part shade, moist humus soil. Excellent background plants with minimum maintenance.							
'Chocoholic' (PP24821)	Deep bronze purple leaves form a dense upright clump. Fragrant, bottlebrush flowers open mauve pink then lighten to white. Foliage becomes greener in full shade.	48"	24"	Aug-Sept	☼●	#1	14.95
N racemosa	White fragrant flower spikes.	60"	24"	July-Aug	☼●	4.5	6.95
ramosa 'Hillside Black Beauty'	(Black Snakeroot) The darkest Cimicifuga with striking purplish-black foliage and white flowers. A collector's plant.	50"	24"	Aug-Sept	☼●	#1	14.95
s. 'Carbonella'	Very dark foliage. Pink to white bottle brush flowers that point straight up.	54"	24"	Aug-Sept	☼●	#1	14.95

☼ sun ☼ part shade ● shade ☼ new variety (H) height (S) spacing (TP) tender perennial N native

Genus Species/Variety	Common Name	(H)	(S)	Bloom	Loc.	Perennials	
						Size	Price

Clematis

Shrub type:

recta 'Serious Black' Extraordinarily dark purple new foliage forms an upright, self-supporting clump of intertwining stems. Leaves mature to olive green and are topped with a profusion of ivory blossoms.	40"	24"	June-July	☉☼	#1	18.95
---------------------------------------------------------------------------------------------------------------------------------------------------------------------------------------------------------------------	-----	-----	-----------	----	----	-------

Clematis

Bloom times for Clematis range from June (Early) through September (Late). Early blooming varieties may bloom again in the fall.

Vine type: Trellised

	Bloom Size	(H)	Bloom	Loc	Size	Price
'Dr. Ruppel' Large, deep carmine flowers with slightly paler margin. Strong grower.	6"	96"+	Early	☼	#1	18.95
'Guernsey Cream' Full creamy yellow flowers. Very early and free flowering compact plants.	3-5"	72"+	Early-Mid	☉☼	#1	18.95
'Jackmanii' Purple flowers with cream stamens.	5-6"	120"+	Mid-Late	☼	#1	18.95
'Mrs. Cholmondeley' Large lavender blue flowers.	5-6"	72"+	Early	☼	#1	18.95
paniculata (terniflora) (Sweet Autumn Clematis) Small white fragrant flowers in the fall.	½"	180"+	Late into October	☼	#1	18.95
'Pink Chiffon' (Hagley Hybrid) Shell pink flowers with pointed sepals.	3-5"	72"+	Mid-Late	☼	#1	18.95
'Red Cardinal' Velvety crimson flowers with contrasting yellow stamens.	4"	144"+	Mid	☼	#1	18.95
☉ 'Snow Queen' White flowers with pinkish margins and red stamens.	6"	84"+	Early	☼	#1	18.95
'The President' Bold purple-blue flowers all summer. Vigorous, easy to grow.	6"	96"+	Early	☼	#1	18.95

Convallaria

Lily of the Valley

majalis (3-4 eye) Fragrant white bell shaped flowers in early spring. Excellent groundcover in poor shady sites.	6"	12"	May-June	☉●	4.5	4.95
-------------------------------------------------------------------------------------------------------------------------	----	-----	----------	----	-----	------

Coreopsis

Tickseed

Excellent group of landscape plants that are low maintenance and have long bloom periods. Verticillata varieties have finely cut foliage. Grandiflora varieties have more substantial basal foliage. Coreopsis are not particular about soil. However, a sunny location is preferred. Cutting back after bloom promotes reblooming.

'Berry Chiffon' (PP27414) Eye catching flowers are white with a vibrant raspberry-red eye. Dark green threadleaf foliage forms a sturdy, upright clump.	18"	18"	June-Sept	☼	4.5	5.95
'Red Chiffon' (PP27528) Yellow blossoms with a vibrant red eye. Dark green threadleaf foliage is very sturdy.	18"	18"	June-Sept	☼	4.5	5.95
grandiflora 'Baby Sun' Compact plant with yellow double and semi-double flowers.	12"	18"	June-Sept	☼	#1	6.95
g. 'Early Sunrise' Double yellow flowers on compact plant.	18"	18"	June-Sept	☼	#1	6.95
g. 'Sunray' Double yellow flowers.	18"	18"	June-Sept	☼	#1	6.95
g. 'Tequila Sunrise' (PP9875) Creamy yellow foliage variegation is supplemented with mahogany tones in the fall. Bright yellow flowers with a reddish brown eye.	16"	18"	May-June	☼	4.5	5.95
'Jethro Tull' (PP18789) Large, deep yellow flowers with fluted petals.	15"	18"	June-Sept	☼	#1	6.95
'Mercury Rising' (PP24689) Velvety wine-red flowers cover bright green, wide spreading, mounded foliage.	15"	18"	June-Sept	☼	4.5	5.95

☼ sun ☉ part shade ● shade ☉ new variety (H) height (S) spacing (TP) tender perennial N native

Genus Species/Variety	Common Name	(H)	(S)	Bloom	Loc.	Perennials	
						Size	Price
Coreopsis	Tickseed	<i>(continued)</i>					
verticillata 'Moonbeam'	Thread-like foliage with pale yellow flowers.	20"	18"	June-Sept	☼	4.5	5.95
						#1	8.95
=== 1992 PPA Perennial Plant of the Year ===							
☺ v. 'Hot Paprika' (PPAF)	Rich deep-red flowers cover the rounded mound of threadleaf foliage.	18"	18"	June-Sept	☼	4.5	5.95
v. 'Zagreb'	Thread-like foliage with golden yellow flowers.	15"	18"	June-Sept	☼	4.5	5.95
						#1	8.95
Corydalis							
lutea	Yellow dicentra-like flowers on 12" stems with delicate lacy foliage. Reliable, easy plant for partial shade.	12"	12"	May-June	☺	4.5	5.95
Crocsmia	Montbretia						
Handsome, broad sword-like foliage provides an outstanding visual effect. Flowers line the strong arching stems. Good for cut flower and attracting hummingbirds. Tender perennial. Winter mulching recommended.							
'Emily McKenzie' (TP)	Golden orange flowers with deep red markings.	18"	15"	June-July	☼	4.5	4.95
'Lucifer' (TP)	Brilliant flame red flowers. Great in containers.	36"	15"	June-July	☼	4.5	4.95
Dalea	Purple Prairie Clover						
N purpureum	Fine, delicate foliage complemented by rose-purple flowers that bloom upwards. Drought tolerant due to a thick taproot.	24"	18"	July-Aug	☼	4.5	4.95
Daylilies see Hemerocallis							
Delphinium							
Great cutflowers, shorter varieties don't require staking. May rebloom if cut back after first flowering.							
grandiflorum 'Blue Butterfly'	Arctic sky-blue flowers.	18"	12"	June-July	☼	#1	6.95
g. 'Summer Blues'	Loose clusters of soft blue blooms. Try it in container gardens too!	16"	12"	June-July	☼	#1	6.95
g. 'Summer Morning'	Light pink blooms.	12"	12"	June-July	☼	#1	6.95
g. 'Summer Night'	Clusters of deep blue flowers.	16"	12"	June-July	☼	#1	6.95
Magic Fountains Hybrids							
A dwarf version of the Pacific Giants. Beautiful colors make outstanding cut flowers.							
Dark Blue w/ Dark Bee		24"	15"	June-July	☼	#1	6.95
Dark Blue w/ White Bee		24"	15"	June-July	☼	#1	6.95
Mid Blue w/ White Bee		24"	15"	June-July	☼	#1	6.95
Pure White		24"	15"	June-July	☼	#1	6.95
Sky Blue w/ White Bee		24"	15"	June-July	☼	#1	6.95
Pacific Giant Hybrids							
Tall background plants, excellent for cut flowers. May require staking.							
'Black Knight'	Deep midnight blue flowers.	60"	24"	June-July	☼	#1	6.95
'Galahad'	White with white bee.	60"	24"	June-July	☼	#1	6.95
'Summer Skies'	Light Blue.	60"	24"	June-July	☼	#1	6.95

Deschampsia (Tufted Hair Grass) see Grasses, Sedges, and Rush Section

☼ sun ☺ part shade ● shade ☺ new variety (H) height (S) spacing (TP) tender perennial N native

Genus	Common Name	(H)	(S)	Bloom	Loc.	Perennials	
						Species/Variety	Size
Dianthus							
	deltoides 'Arctic Fire' White flowers with a bright fuchsia ring around a medium pink eye.	7"	12"	May-July	☼	4.5	4.95
	d. 'Flashing Light' Ruby-red flowers.	5"	12"	May-June	☼	4.5	4.95
	d. 'Zing' ('Zing Rose') Large rose colored flowers.	6"	12"	May-Aug	☼	4.5	4.95
☺	'First Love' Blooms change from pure white to rose as they age. Clump forming for rock garden.	18"	15"	June-Aug	☼	4.5	4.95
	g. 'Firewitch' Spreading low growing form with deep blue-green foliage and magenta blooms. Long bloom time. === 2006 PPA Plant of the Year ===	6"	12"	May-July	☼	4.5	4.95
	g. 'Fire Star' (PP14895) Gray-green foliage; vivid fire red flowers with deep crimson eye.	8"	12"	May-June	☼	4.5	4.95
	g. 'Neon Star' (PP14549) Compact mats of silvery foliage; single, fragrant, fringed hot pink flowers.	7"	12"	May-June	☼	4.5	4.95
	g. 'Peppermint Star' (PP20369) Pink flowers with red center. Foliage forms dense cushions.	8"	12"	May-June	☼	4.5	4.95
	g. 'Tiny Rubies' Clumps of gray-green foliage, double pink flower. Very compact plant.	4"	12"	May-June	☼	4.5	4.95
Dicentra Bleeding Hearts							
Popular shade plant with fern-like foliage and heart-shaped flowers. Long blooming perennial for partial shade.							
	formosa 'Luxuriant' Pink flowers, blooms all summer.	12"	18"	May-Sept	☺	4.5	6.95
	'King of Hearts' Grayish blue foliage with rose flowers; flowers all summer.	10"	18"	May-Sept	☺	#1	9.95
	spectabilis (Old Fashioned) Pink flowers. An old time favorite that may go dormant in the summer heat.	36"	30"	May-June	☺	#1	7.95
	s. 'Alba' (Old Fashioned) White flowers, may go dormant in the heat of summer.	30"	30"	May-June	☺	#1	7.95
	s. 'Gold Heart' Radiant yellow foliage creates a perfect backdrop for arching sprays of pink and white heart-shaped blossoms.	24"	30"	May-June	☺	#1	9.95
	s. 'Valentine' (PP22739) Bright red heart-shaped flowers dangle from deep red arching stems. May go dormant in summer.	30"	30"	May-June	☺	#1	9.95
Digitalis Foxglove							
Thimble shaped flowers on tall erect stems. Good for partial shade location. Not particular about soil.							
	ambigua (grandiflora) Yellow flowers with brown spots.	24"	15"	June-July	☼☺	4.5	4.95
	'Mertonensis' (Strawberry Foxglove) Tetraploid flower, one of the few rose spire flowers available.	24"	15"	June-July	☼☺	4.5	4.95
	purpurea Foxy Hybrids White to pink, will self-seed.	24"	15"	June-July	☼☺	4.5	4.95
☺	p. 'Camelot Lavender' Tall spikes of nodding lavender flowers with speckled throats.	48"	24"	May-June	☼☺	#1	7.95
☺	p. 'Camelot Rose' Tall spikes of nodding rose colored flowers with speckled throats.	48"	24"	May-June	☼☺	#1	7.95
Dodecatheon Shooting Star							
Native woodland plant that goes dormant in midsummer (ephemeral).							
N	meadia Native plant with dart-shaped white flowers.	6"	15"	May	☺●	4.5	5.95
Doronicum Leopard's Bane							
Mound forming growing habit. May go dormant in summer.							
	orientale 'Little Leo' One of our earliest blooming yellow perennials, prefers partial shade.	10"	12"	May-July	☼☺	4.5	4.95
☼ sun ☺ part shade ● shade ☺ new variety (H) height (S) spacing (TP) tender perennial N native							

Genus Species/Variety	Common Name	(H)	(S)	Bloom	Loc.	Perennials	
						Size	Price

Echinacea Coneflower

In the perennial world, Echinacea's are all the rage. Hybridizers are working feverishly to release different colors of our native *purpurea* and other species. Echinaceas are sturdy perennial plants. Plants are pest resistant and flower most of the summer.

	Big Sky™ 'Solar Flare' (PP22133) Enormous, strongly fragrant, deep magenta red blossoms. Sturdy near black stems.	30"	18"	June-Aug	☼	4.5	6.95
	Big Sky™ Sundown™ ('Evan Saul' PP17659) Intense russet orange flowers with a brown cone. Fragrant.	32"	18"	June-Aug	☼	4.5 #1	6.95 11.95
	'Cheyenne Spirit' This coneflower blooms in a mix of colors: red, orange, magenta, golden yellow and white.	24"	18"	July-Aug	☼	4.5	6.95
	'Cleopatra' (PP24631) Incredibly vibrant golden yellow fragrant flowers with an orange cone. Compact habit.	18"	18"	July-Aug	☼	#1	11.95
	'Fatal Attraction' (PP18429) Strong, dark red stems contrast with the bright green foliage. Flowers are vivid.	26"	18"	July-Aug	☼	4.5 #1	6.95 11.95
	'Green Jewel' (PP18678) Light green ray petals surround a large green cone.	24"	18"	June-Aug	☼	4.5	6.95
	'Hot Papaya' (PP21022) Double flowers that have sizzling orange-red petals, and a deep orange cone.	32"	18"	July-Aug	☼	4.5 #1	6.95 11.95
	'Julia' (PP24629) Glowing tangerine-orange fragrant flowers with a copper cone. Strong stems. Compact, stocky habit.	18"	18"	July-Aug	☼	#1	11.95
	'Marmalade' (PP22602) Double pom pom type flowers atop strong stems, range in color from tangerine to golden orange.	30"	18"	July-Sept	☼	4.5	6.95
	'Meringue' (PP20537) White double flowers with yellowish centers. Cone has tubular florets.	18"	18"	July-Sept	☼	4.5	6.95
☉	'Now Cheesier' (PP23059) Large, deep yellow-orange flowers. Long flowering time.	20"	18"	July-Sept	☼	4.5	6.95
N	pallida Very showy large purple flowers with drooping petals atop 3 – 5' stalks in summer. Narrow leaves.	48"	18"	June-Aug	☼	4.5	4.95
	paradoxa Striking yellow coneflower. A yellow purple coneflower, hence the paradox.	36"	18"	June-Aug	☼	4.5	5.95
	Pixie Meadowbrite™ (PP18546) Dwarf habit; loads of pink flowers; very drought tolerant.	18"	18"	July-Sept	☼	4.5 #1	6.95 11.95
	==== 2014 WNA Plant of the Year ====						
N	purpurea Tough plant that will perform in hot sunny locations with showy purple flowers. One of our best native wildflowers.	30"	18"	July-Aug	☼	4.5 #1	4.95 7.95
	p. 'Butterfly Kisses' (PP24458) Double pom-pom bright pink flowers. Compact habit, sturdy stems.	18"	18"	July-Aug	☼	4.5	6.95
	p. 'Magnus' Deep rose flower with dark disc. Non-drooping petals. ===== 1998 PPA Plant of the Year =====	40"	18"	July-Aug	☼	4.5 #1	4.95 7.95
	p. 'PowWow White' Yellow cone surrounded by pure white petals. Very floriferous!	18"	18"	July-Aug	☼	#1	11.95
	p. 'PowWow Wild Berry' Deep purple-pink to near magenta 3-4" flowers are carried on stiff stems atop relatively short, stocky plants.	18"	18"	July-Aug	☼	#1	11.95
	p. 'Prairie Splendor™' Large rose pink flowers on short, compact plants. Early bloomer.	24"	18"	June-Aug	☼	4.5	4.95
	p. 'Ruby Star' ('Rubinstern') An excellent selection with horizontally held petals. Deep magenta-red flowers.	36"	18"	July-Aug	☼	4.5	4.95
	p. 'White Swan' White flowers with coppery cone.	20"	18"	July-Aug	☼	4.5 #1	4.95 7.95

☼ sun ☉ part shade ● shade ☺ new variety (H) height (S) spacing (TP) tender perennial N native

Genus	Common Name	(H)	(S)	Bloom	Loc.	Perennials	
						Species/Variety	Size
Echinops	Globe Thistle						
	Foliage is thistle-like with spiny tips. The surface is rough and prickly. Flower heads are ball shaped.						
	ritro Globular metallic blue flowers on long stems.	36"	18"	July-Aug	☼	4.5	4.95
Eryngium	Sea Holly						
	planum 'Blue Glitter' Silvery blue stems produce masses of small shimmering blue pin-cushion type flowers.	36"	18"	July-Aug	☼	#1	6.95
	p. 'Blue Hobbit' Intense blue globe-like flower heads over the silvery blue foliage. Shorter variety.	12"	15"	July-Aug	☼	#1	6.95
N	yuccifolium (Rattle Snake Master) Native with white fragrant flowers. Foliage looks similar to Yucca.	40"	18"	July-Aug	☼	4.5	5.95
Euonymus	Wintercreeper						
	Very nice groundcover with a heavier texture than vinca minor. Will climb if structure is provided.						
	fortunei 'Coloratus' (Purple Leaf Wintercreeper) Outstanding red/purple fall color.	18"	12"		☼●	2.5	1.95
Eupatorium	Joe Pye Weed / Boneset						
	Late season flowering plant. Taller Joe Pyes are great for the back of the border. All varieties attract butterflies. Great plants for rain gardens!						
	'Little Joe' A very garden worthy Joe Pye Weed. Big mauve flower heads top attractive green foliage. Short, compact; Excellent upright habit.	42"	24"	Aug-Oct	☼☉	#1	7.95
	maculatum 'Atropurpureum' Flat topped clusters of rich purplish flower heads atop strong red stems.	72"	24"	Aug-Oct	☼☉	#1	9.95
	m. 'Gateway' Huge red flowers atop wine red stems.	72"	24"	July-Sept	☼☉	#1	7.95
	m. 'Glenda' (PPAF) Medium height. Much larger lavender-pink flower clusters than 'Little Joe'. Contrasting burgundy stems.	48"	24"	July-Sept	☼☉	#1	9.95
N	perfoliatum (Boneset) White flowers. Native plant.	40"	18"	Aug-Oct	☼☉	#1	7.95
N	purpureum (Sweet Joe Pye Weed) Purple flowers on large plant. Handles wet soil conditions.	60"	24"	July-Aug	☼☉	#1	7.95
	rugosum 'Chocolate' Striking purple/bronze foliage. Creamy white flower panicles. May self seed.	60"	24"	Aug-Sept	☼☉	#1	9.95
Euphorbia	Spurge						
	'First Blush' (PP15292) Light green leaves edged with cream margins flushed with pink. Low mounded foliage.	12"	15"	May	☼☉	#1	7.95
	myrsinites (Donkey Tail) Needs excellent drainage, great for walls or rock garden, yellow flowers.	6"	18"	May	☼	4.5	4.95
	polychroma (epithymoides) (Cushion Spurge) Compact dome-shaped plant covered with chartreuse flowers. Foliage turns red in fall, prefers dry, sunny locations.	12"	15"	May	☼☉	4.5	4.95
	p. 'Bonfire' (PP18585) Phenomenal color! Deep purple red and orange leaves with a touch of chartreuse.	18"	15"	May	☼☉	4.5	5.95
	x martinii 'Ascot Rainbow' (PP21401) Flashy green and yellow variegated foliage takes on pink and orange tones in cool weather.	20"	18"	May	☼☉	#1	7.95

☼ sun ☉ part shade ● shade ☺ new variety (H) height (S) spacing (TP) tender perennial N native

Genus Species/Variety	Common Name	(H)	(S)	Bloom	Loc.	Perennials		
						Size	Price	
Ferns								
The "queen" of shade plants. All do best in shade with medium moist, rich humus soil.								
	Autumn Wood (<i>Dryopteris erythrosora</i>)	In cold climates, this fern is bright red in the fall. New growth is coppery colored.	24-30"	18"		●	#1	8.95
N	Christmas (<i>Polystichum acrostichoides</i>)	Evergreen.	10-18"	18"		●	#1	8.95
N	Cinnamon (<i>Osmunda cinnamomea</i>)	Mature fronds are bluish green and age to cinnamon brown.	24-48"	24"		●	#1	8.95
N	Clayton (Interrupted Fern) (<i>Osmunda claytoniana</i>)	A majestic variety. Similar to Cinnamon Fern, but is distinct in having the frond "interrupted" in the middle.	24-48"	24"		●	#1	8.95
	'Ghost'	Frosted apple-green fronds emit a ghostly white light in the shade. Dark purple stems.	18-30"	18"		☉●	#1	9.95
	'Godzilla'	This is a Japanese Painted Fern...giant in size! Forms a massive, arching clump of silvery fronds with green highlights and dark purple stems. Spreads slowly.	36"	36"		☉●	#1	9.95
	Japanese Painted Fern (<i>Athyrium nipponicum 'Pictum'</i>)	Silver colored leaves with red and green fronds.	18-24"	18"		☉●	#1	9.95
==== 2004 PPA Perennial Plant of the Year ====								
N	Lady (<i>Athyrium filix-femina</i>)	Graceful in appearance, extremely hardy, roots easily.	18-36"	18"		●	#1	8.95
N	Maidenhair (<i>Adiantum pedatum</i>)	Once established, these ferns create a beautiful canopy in the shade garden.	18"	18"		●	#1	8.95
N	Ostrich (<i>Matteuccia struthiopteris</i>)	Upright, vase-shaped and a vigorous grower. Needs moist soil.	24-60"	24"		☉●	#1	8.95
N	Royal (<i>Osmunda regalis</i>)	Majestic fern grows in wet soils or near permanent water. A slow spreader.	24-48"	24"		●	#1	8.95
N	Sensitive (<i>Onoclea sensibilis</i>)	Coarse textured; tolerates more sun and wet soils.	18"	18"		☉●	#1	8.95
N	Wood (<i>Dryopteris</i>)	Very fine texture and easy to grow.	18-24"	18"		●	#1	8.95

Filipendula

Meadow Sweet

Superb perennials, extremely hardy and pest resistant. Moist soil and some shade are preferred for best growth.

	purpurea	Deep pink, fluffy flowers on purple-red stems. Attracts butterflies!	40"	24"	July-Sept	☼☉	#1	9.95
	rubra 'Venusta'	Deep pink flowers.	48"	24"	July-Sept	☼☉	#1	9.95
☺	vulgaris 'Plena'	Basal, fern-like foliage, double white flower.	24"	18"	June-Aug	☼☉	#1	8.95

Fragaria

Strawberry

	'Lipstick'	Strawberry-like habit with bright red flower.	6"	15"	June-Aug	☼	4.5	5.95
	'Variegata'	Creamy-white margined leaf. White flowers with yellow center.	6"	15"	June-Aug	☼	4.5	5.95

Gaillardia

Blanket Flower

Low maintenance, heat tolerance, and long bloom season make this a popular perennial.

	aristata 'Arizona Apricot'	Large 3", apricot flowers with yellow tips and darker orange center. Compact habit.	12"	15"	June-Sept	☼	4.5	4.95
	a. 'Arizona Red Shades'	Large crimson red flowers. More compact than <i>G. 'Burgundy'</i> .	12"	15"	June-Sept	☼	4.5	4.95
	a. 'Arizona Sun'	Provides a continuous display of large 3" single mahogany red flowers with bright yellow petal edges. Compact plant.	10"	15"	June-Sept	☼	4.5	4.95
☺	grandiflora Mesa™ Red	Fiery red flowers are non-fading over the season. Attracts butterflies!	18"	15"	June-Sept	☼	4.5	4.95
	g. Mesa™ Yellow	Well branched plants produce masses of yellow flowers.	18"	15"	June-Sept	☼	4.5	4.95

☼ sun ☉ part shade ● shade ☺ new variety (H) height (S) spacing (TP) tender perennial N native

Genus Species/Variety	Common Name	(H)	(S)	Bloom	Loc.	Perennials	
						Size	Price
Galium	Sweet Woodruff						
odoratum	Delicate-looking but fast-spreading groundcover for semi-shade, white flowers.	8"	12"	May-June	☉●	4.5	4.95
Gaura	Indian Feather						
	Long flowering plant for the sunny border.						
lindheimeri	'Siskiyou Pink' Tall, wiry stems with long blooming, striking flowers of deep, rich pink.	36"	15"	June-Oct	☼	4.5	5.95
I. 'Whirling Butterflies'	Beautiful narrow-leafed plant with pale pink fading to white flowers, excellent texture plant.	36"	15"	June-Oct	☼	4.5	4.95
Gentiana	Gentian						
dahurica	Deep blue flowers in late summer and fall. Hardy to zone 3.	12"	12"	Aug-Sept	☼☉	4.5	5.95
Geranium	Cranesbill						
	A large group of excellent perennials in a wide range of colors. Some are clump forming and others are spreaders. Foliage is important for location choice. Larger foliage varieties need some shade.						
'Brookside'	Clear blue flowers with a tiny white eye.	15"	18"	June-Aug	☼☉	#1	9.95
cantabrigiense	'Biokovo' White flowers with pink stamens. Aromatic, citrus scented foliage.	10"	15"	May-June	☼☉	4.5	6.25
	=== 2015 PPA Plant of the Year ===						
c. 'Karmina'	Rich, raspberry-pink flowers on a plant prized for its groundcover effect.	8"	15"	May-June	☼☉	#1	9.25
cinereum	'Ballerina' Pink flowers with dark veins.	6"	15"	June-Sept	☼☉	#1	9.95
'Johnson's Blue'	Bright violet-blue flowers. Good as a groundcover.	16"	18"	June-July	☼☉	4.5	6.25
macrorrhizum	(Bigroot Cranesbill) Fragrant apple scented foliage with thick clusters of pink flowers in late spring. Red to bronze fall foliage color.	12"	15"	May-July	☼☉	#1	9.25
macrorrhizum	'Bevan's Variety' Deep magenta petals with dark red sepals. One of the best flowering selections. Good groundcover.	12"	15"	May-July	☼☉	#1	9.25
N maculatum	Native species with deep pink flowers.	18"	15"	June	☼☉	4.5	4.95
pratense	'Dark Reiter' Handsome, finely cut plum purple foliage with contrasting lilac blue flowers.	10"	15"	June-Aug	☼☉	4.5	6.25
☉ 'Rosetta'	(PP19109) Large pink flowers with dark veins. Similar performer to the popular <i>G. 'Rozanne'</i> .	18"	18"	June-Sept	☼☉	#1	9.95
'Rozanne'	(PP12175) Large, violet blue flowers with a white eye. Deep green, mounded foliage. Vigorous. Exceptionally long bloom season.	18"	18"	June-Sept	☼☉	#1	9.95
	=== 2008 PPA Plant of the Year ===						
sanguineum	Deeply lobed foliage with deep purplish-red flowers, red fall foliage color.	10"	15"	June-Sept	☼☉	4.5	6.25
s. 'Album'	Deeply lobed foliage with white flowers.	10"	15"	June-Sept	☼☉	4.5	6.25
sanguineum	'Max Frei' Abundant deep magenta flowers. Mounding, compact foliage. Good fall color.	12"	15"	July-Sept	☼☉	4.5	6.25
s. 'New Hampshire Purple'	Deep purple blossoms stand out above dark green foliage. Compact habit.	8"	15"	June-Sept	☼☉	4.5	6.25
s. var. striatum	(lancastrinse) Shell-pink flowers. Outstanding red foliage in the fall.	10"	18"	June-Sept	☼☉	4.5	6.25
s. 'Tiny Monster'	Magenta-pink flowers with darker veining. Long blooming throughout the summer. This plant has a sprawling habit, making it an effective groundcover. Fall foliage has bronze tones.	16"	18"	June-Sept	☼☉	#1	9.25

☼ sun ☉ part shade ● shade ☼ new variety (H) height (S) spacing (TP) tender perennial N native

Genus Species/Variety	Common Name	(H)	(S)	Bloom	Loc.	Perennials	
						Size	Price
Geum Avens							
coccineum 'Borisii'	Orange-red flowers on shorter plant.	12"	15"	May-Sept	☼	4.5	5.95
chiloense 'Lady Stratheden'	Double yellow flowers.	24"	15"	May-July	☼	4.5	4.95
c. 'Mrs. Bradshaw'	Scarlet semi-double flowers.	24"	15"	May-July	☼	4.5	4.95
flora plena 'Blazing Sunset'	Fully double, scarlet red flowers. Great for the border or bouquets.	24"	15"	May-July	☼	4.5	5.95
Totally Tangerine (PP22041)	Robust growing habit. Very tall, strong stems above the mounded foliage, carry loads of bright apricot to tangerine orange flowers.	30"	15"	May-July	☼	4.5	5.95
N triflorum (Prairie Smoke)	White flowers. It produces outstanding feathery silver and pink seed heads.	8"	12"	May-June	☼	4.5	6.95
Gillenia Bowman's Root							
trifoliata	A tough plant native to the Midwest. Loose sprays of star-shaped white to pinkish flowers. Tolerates wet or dry conditions once established.	30"	24"	June-July	☼☉	4.5 #1	5.95 8.95
Grasses... see <i>Grasses, Sedges, and Rush</i> Section							
Gypsophila Baby's Breath							
Tall forms make excellent cut flowers.							
☉ SUMMER SPARKLES® (PP19318)	Taller variety. Dense foliage is covered with bright white, semi-double, slightly fragrant flowers for a long period.	24"	18"	June-July	☼	#1	9.25
repens	White flowers, good spreading ground cover.	6"	18"	June-July	☼	4.5	4.95
r. 'Rosea'	Rose-pink flowers, good spreading ground cover.	6"	18"	June-July	☼	4.5	4.95
Hakonechloa (Hakone Grass) see <i>Grasses, Sedges, and Rush</i> Section							
Hedera English Ivy							
Climbing, spreading groundcover with dark green leaves. Will climb trees and buildings. Some winter protection required to prevent die back.							
helix 'Thorndale'	Subzero strain, elegant ground cover, needs good soil.	6"	12"		☉●	2.5	1.95
Helenium Helen's Flower / Sneezeweed							
Leaves are lance shaped. All varieties are heavy flower producers and flower from early to late summer. Great for cut flower growing. Full sun, not particular about soil conditions.							
autumnale Red and Gold Hybrids	2" sunflower shaped yellow to burgundy flowers.	48"	18"	June-July	☼	4.5	4.95

☼ sun ☉ part shade ● shade ☉ new variety (H) height (S) spacing (TP) tender perennial N native

Genus Species/Variety	Common Name	(H)	(S)	Bloom	Loc.	Perennials	
						Size	Price

Heliopsis False Sunflower

Flowers midsummer to late fall. Flowers are showy, yellow rays with darker disk. Prefers moist soil.

N	helianthoides (Ox-eye Sunflower)	Yellow-orange flowers.	60"	24"	July	☼	#1	7.95
	h. 'Summer Nights'	Deep golden yellow flowers with mahogany centers top dark red stems and red tinged foliage. Simply stunning.	36"	24"	July-Oct	☼	#1	8.95
	h. 'Summer Sun'	Double yellow-orange flowers.	36"	24"	July-Oct	☼	#1	7.95
	h. 'Sunstruck' (PP25524)	Cream and green variegated foliage. Large golden yellow flowers bloom slightly earlier than other Heliopsis.	15"	18"	July-Oct	☼	#1	8.95
	h. 'Tuscan Sun' (PP18763)	Bright golden yellow, daisy-like flowers with an orange button center. Deep green foliage.	30"	24"	July-Oct	☼	#1	11.95

Hemerocallis Daylilies

The combination of easy maintenance, hardiness and flower color makes this a "perennial" favorite among gardeners and landscapers alike. Hemerocallis prefer full sun but will grow in half shade.

Bloom Period (June – August)

E=Early, EM=Early Mid, M=Mid, ML=Mid Late, L=Late, Ext=Extended bloom, Re=Rebloomer.

Daylily	Color	(H)	Bloom Period	Size	Price
'Barbara Mitchell'	Very popular award winning daylily. Very large soft pink flowers with round ruffled overlapping petals.	20"	M-Re	#1	9.95
'Blueberry Candy'	Ivory colored flowers have ruffled petals. Stunning violet eyezone. A strong performer in the landscape, many buds and flowers on each stem.	22"	ML-Re	#1	9.95
'Bonanza'	Gold-yellow, red-eye.	28"	M	4.5	5.95
'Bright Sunset'	Slightly ruffled, burnt coppery orange flowers with golden midribs. Very fragrant.	36"	M-Ext	#1	8.95
'Catherine Woodbury'	Orchid pink, slightly ruffled.	30"	M	#1	8.95
'Chicago Apache'	Fiery red with silky finish. Ruffled edges.	26"	ML	#1	9.95
'Chicago Fire'	Red with yellow stripes.	34"	ML	#1	9.95
'Chicago Sunrise'	Yellow/orange blend, heavy bloomer.	28"	M	#1	9.95
'Custard Candy'	Creamy yellow 4" flowers with maroon eyezone and green throat.	24"	EM-Re	#1	9.95
'Daring Deception'	Pale lavender with dark purple edges and eyezone.	24"	E-Re	#1	9.25
'Frans Hals'	Orange-red and yellow bicolor.	24"	ML	4.5	5.95
'Gentle Shepherd'	Near white flowers.	28"	EM	#1	9.25
'Going Bananas'	(PP17164) Large lemon yellow flowers, fragrant, slightly ruffled. Blooms nearly continuous from summer into fall.	20"	EM-Re	#1	9.95
'Happy Returns'	Canary yellow. Rebloomer.	(MIN) 18"	E-Re Ext	4.5 #1	4.95 7.95
'Joan Senior'	Creamy white ruffled fragrant flowers.	20"	M-Re Ext	#1	9.95
'Little Grapette'	Light grape-purple self with green throat.	(MIN) 12"	EM	4.5 #1	6.95 9.95
'Mary Todd'	Yellow, heavy bloomer.	26"	EM-Re	#1	9.95
'Mini Pearl'	3" lightly ruffled blush melon pink flowers. Reblooms like Stella d'Oro.	18"	E-Re	4.5	6.95
'Missouri Beauty'	Bright lemon yellow flower with green throat.	32"	EM	#1	8.95
☺ 'Orange Smoothie'	(PPAF) Orange-mango ruffled petals with rose pink band and green throat. Fragrant. Rebloomer.	26"	EM-Re	#1	9.95

☼ sun ☉ part shade ● shade ☺ new variety (H) height (S) spacing (TP) tender perennial N native

Genus Species/Variety	Common Name	(H)	(S)	Bloom	Loc.	Perennials	
						Size	Price
Hemerocallis	Daylilies	<i>(continued)</i>					
Daylily	Color	(H)	Bloom	Size	Price		
'Pardon Me'	Brick red flowers with lemon yellow throat. Fragrant.	(MIN) 26"	M-Re	4.5 #1	6.95		9.95
'Prairie Blue Eyes'	Lavender flowers with blue eyes.	28"	M	#1	9.95		
'Prairie Wildfire'	Classic fragrant red daylily. Velvety red flowers with slightly recurved petals.	23"	M	#1	8.95		
'Purple d'Oro'	Medium purple, slightly ruffled flowers with a bright yellow throat.	(MIN) 20"	EM-Re	#1	9.95		
'Rocket City'	Bittersweet orange flower.	36"	M-Ext	#1	9.25		
'Rosy Returns'	(PP9779) A pink everblooming daylily! The 4" flowers are rose pink with a deep rose eyezone.	14"	E-Re	4.5 #1	6.95		9.95
'Ruby Stella'	Ruby-red with yellow throat. Fragrant.	20"	M-Re	#1	9.95		
'Siloam June Bug'	Golden yellow, burgundy eyezone.	(MIN) 23"	E	4.5	6.95		
'Stella de Oro'	Gold-yellow, ever bloomer.	(MIN) 16"	E-Re	4.5	4.95		
				Ext #1	7.95		
'Strawberry Candy'	Strawberry pink with rose-red eyezone and golden green throat. Stout Medal winner.	26"	EM-Re	#1	9.95		
			Ext				
'Summer Wine'	Lavender-wine, green throat.	24"	M	4.5	6.25		

Bloom Period (June – August)

E=Early, EM=Early Mid, M=Mid, ML=Mid Late, L=Late, Ext=Extended bloom, Re=Rebloomer.

Color	E / EM	M	ML / L
Red		Pardon Me (Re) Prairie Wildfire Ruby Stella (Re)	Chicago Apache Chicago Fire
Orange / Peach	Mini Pearl (Re) Orange Smoothie (Re)	Bright Sunset (Ext) Rocket City (Ext)	
Pink	Rosy Returns (Re) Strawberry Candy (Re)	Barbara Mitchell (Re) Catherine Woodbury	
Yellow	Custard Candy (Re) Happy Returns (Re/Ext) Missouri Beauty	Chicago Sunrise Going Bananas (Re)	
Gold	Mary Todd (Re) Siloam June Bug Stella d'Oro (Re/Ext)	Bonanza	
Purple	Daring Deception (Re) Little Grapette Purple d'Oro (Re)	Prairie Blue Eyes Summer Wine	
White/Cream	Gentle Shepherd	Joan Senior (Re/Ext)	Blueberry Candy (Re)
Bicolor		Frans Hals	

☼ sun ⊙ part shade ● shade ☺ new variety (H) height (S) spacing (TP) tender perennial N native

Genus Species/Variety	Common Name	(H)	(S)	Bloom	Loc.	Perennials	
						Size	Price

Herbs...see list in back of catalog

Hepatica **Mayflower / Liverwort**

N	acutiloba Native spring-blooming plant with white to blue flower.	6"	12"	April-May	☉●	4.5	5.95
----------	--------------------------------------------------------------------------	----	-----	-----------	----	-----	------

Heuchera **Coral Bells**

Clump forming plants with round leaves. Foliage is attractive and very effective in the border. Heuchera prefer well drained organic soil and dark leafed varieties will tolerate full sun if moisture is available.

	'Berry Timeless' (PP26357) A myriad of light pink flowers which age to a deeper rose. Leaves are lightly silvered, mint green.	12"	15"	May-July	☼☉	#1	9.95
	'Black Pearl' (PPAF) Shiny, jet black leaves with scalloped, ruffled edges. White flowers.	10"	15"	May-July	☼☉	#1	9.95
	'Caramel' (PP16560) Fuzzy, bright yellow-orange leaves with purple-red undersides. Compact habit. Cream flowers.	12"	15"	May-July	☼☉	#1	9.95
	'Cinnamon Curls' (PP25648) Ruffled leaves are a unique blend of coppery orange, red and purple tones. Flowers are insignificant.	10"	15"	May-July	☼☉	#1	9.95
	'Citronelle' (PP17934) In heavy shade, the citron yellow foliage will turn chartreuse. Cream colored flowers.	12"	15"	May-July	☉●	#1	9.95
	'Crimson Curls' Distinctively curly, crimson foliage. Color intensifies in spring.	15"	15"	May-July	☼☉	#1	9.95
	'Georgia Peach' (PP19375) Glowing peach colored leaves with a light silver overlay. Creamy white flowers.	14"	15"	May-July	☼☉	#1	9.95
	'Hercules' ® Bright green leaves with heavy white marbling. Deep red flowers.	15"	15"	May-July	☼☉	#1	9.95
☉	'Lava Lamp' (PP26761) Large, rounded leaves are bright copper in spring, turning coppery purple later. Cream flowers.	16"	15"	May-July	☼☉	#1	9.95
	'Midnight Rose' (PP18551) This unique sport of 'Obsidian' has deep purple-black leaves that are splashed with hot pink in spring. The spots lighten to creamy pink as the season progresses.	10"	15"	May-July	☼☉	#1	9.95
m.	'Palace Purple' Bronze foliage, small white flowers. === 1991 PPA Plant of the Year ===	15"	15"	May-July	☼☉	4.5 #1	4.95 7.95
	'Obsidian' (PP14836) The blackest Heuchera, with smooth, shiny, rounded leaves. Holds its color all season. Cream flowers.	10"	15"	May-June	☼☉	#1	9.95
	'Plum Pudding' Compact plant with silvery plum-purple foliage. Dainty cream colored flowers.	12"	15"	May-June	☼☉	#1	9.95
	'Pretty Pistachio' (PPAF) Chartreuse leaves mellow to lime green. Clusters of medium pink flowers are long lasting. Performs best in filtered sunlight.	10"	15"	May-July	☉●	#1	9.95
	sanguinea Bressingham Hybrids A mix of pink to red flowers over green foliage.	15"	15"	May-July	☼☉	4.5	4.95
s.	'Firefly' Scarlet flowers above dark green foliage.	15"	15"	May-July	☼☉	4.5	4.95
	'Stormy Seas' Very serrated and ruffled bronze purple foliage with light rose flowers.	16"	15"	May-June	☼☉	#1	9.95

☼ sun ☉ part shade ● shade ☉ new variety (H) height (S) spacing (TP) tender perennial N native

Genus Species/Variety	Common Name	(H)	(S)	Bloom	Loc.	Perennials	
						Size	Price

Heucherella

Foamy Bells

Heucherella is a cross between Tiarella (Foam Flower) and Heuchera (Coral Bells), hence Foamy Bells. Excellent plant for the border and also well suited for container gardens.

'Catching Fire' (PPAF)	Vibrant lime green leaves with red flame-shaped markings in the centers. Cream flowers. Performs best in filtered sunlight.	10"	15"	May-June	☉●	#1	9.95
'Pink Fizz' (PP26947)	Large, deeply lobed, soft green leaves are lightly silvered with prominent purple veins. Pure pink flowers pop open from hot pink buds.	10"	15"	May-June	☉	#1	9.95
'Pumpkin Spice' (PPAF)	Bronze red leaves with mahogany centers. Dark red stems hold cream flowers. Performs best in filtered sun or afternoon shade.	10"	15"	May-June	☉	#1	9.95
☉ 'Solar Eclipse' (PP23647)	Rounded mounds of red-brown scalloped leaves are edged in glowing lime green. White flowers.	10"	15"	May-June	☉●	#1	9.95

Hollyhock see *Alcea*

Hosta

Low maintenance and bold foliage help make this the perfect shade and part shade perennial. Variegated types are better for shady areas, while green and yellow types can withstand more sun. Blue varieties usually have thicker substance and keep their color best in full shade.

The table shown on these two pages is a quick reference that categorizes the Hostas available at Shady Acres by leaf color and mature foliage clump size.

Mature clump size: VS=Very Small 3-6"; S=Small 6-12"; M=Medium 12-24"; L=Large 24-36"; XL=Extra-Large 36"+

	S	M	L
VARIEGATED TYPES	'Cherry Berry' 'Lakeside Paisley Print' 'Remember Me'	'Adorable' 'Angel Falls' 'Beach Boy' 'Brother Stefan' 'Christmas Candy' 'Fire & Ice' 'Forbidden Fruit' 'Gold Standard' 'Gypsy Rose' 'Half and Half' 'Island Breeze' 'June' 'Morning Star' 'Old Glory' 'Prairie's Edge' 'Rainbow's End' 'Raspberry Sundae' 'Sweet Home Chicago' 'Touch of Class' undulata 'Variegated' 'White Feather'	'Dream Queen' 'Guacamole' 'Hudson Bay' 'Paradigm' 'Rhino Hide' 'Stained Glass'

☼ sun ☉ part shade ● shade ☉ new variety (H) height (S) spacing (TP) tender perennial N native

Genus	Common Name	(H)	(S)	Bloom	Loc.	Perennials	Size	Price
Species/Variety								

Hosta

Mature clump size: **VS**=Very Small; 3-6"; **S**=Small 6-12"; **M**=Medium 12-24"; **L**=Large 24-36"; **XL**=Extra-Large 36"+

	S	M	L
BLUE SHADES	'Blue Mouse Ears' (VS) 'Church Mouse'	'Bressingham Blue' 'Halcyon' 'Prairie Sky'	'Abiqua Drinking Gourd' 'Big Daddy' 'Big Mama' 'Blue Angel' 'Krossa Regal' sieboldiana 'Elegans' 'Wishing Well' 'Yankee Blue'
YELLOW / GOLD SHADES	'Curly Fries' 'Gold Edger' 'Maui Buttercups' 'Munchkin Fire' 'Sun Mouse'	'August Moon' 'Dancing Queen' 'Fire Island' 'Prairie Moon'	'Coast to Coast' (XL) 'Fried Bananas' 'Sum and Substance' (XL) 'Sun Power'
GREEN SHADES		lancifolia plantaginea 'Royal Standard' 'Stirfry'	'Empress Wu' (XL) 'Humpback Whale' (XL) 'Komodo Dragon' (XL)
CREAM / GOLD MARGINS	'Golden Tiara' 'Grand Tiara' 'Mighty Mouse' 'School Mouse'	fortunei 'Aureo-marginata' 'Fragrant Bouquet' 'Grand Prize' 'Luna Moth' 'Moon Split' 'Parky's Prize' 'Praying Hands' 'Summer Breeze' 'Velvet Moon' 'Wheee!' 'Yellow Polka Dot Bikini'	'Afterglow' 'Atlantis' 'Frances Williams' 'Liberty' montana 'Aureo-marginata' 'Northern Exposure' (XL) 'Regal Splendor' (XL) 'Seducer' 'Twilight' 'Victory'
WHITE MARGINS	'Allan P. McConnell' 'Brim Cup' 'Diamonds are Forever'	'Antioch' 'Blue Ivory' 'Diamond Tiara' 'El Nino' 'Fantabulous' 'Firn Line' 'Francee' 'Patriot' 'Royal Wedding' 'So Sweet' undulata 'Albo-marginata' 'Wide Brim'	'Bridal Falls'

☀ sun ☉ part shade ● shade ☺ new variety (H) height (S) spacing (TP) tender perennial N native

Genus Species/Variety	Common Name	(H)	(S)	Bloom	Loc.	Perennials	
						Size	Price

Hosta

Low maintenance and bold foliage help make this the perfect shade and part shade perennial. Variegated types are better for shady areas, while green and yellow types can withstand more sun. Blue varieties usually have thicker substance and keep their color best in full shade.

The American Hosta Growers Association established the AHGA Hosta of the Year in 1996.

see **Hosta** size and foliage type chart on pages 26 & 27...

'Abiqua Drinking Gourd'	L	Interesting round, puckered, intensely cupped shaped leaf. Great specimen plant.	4.5	14.95
		=== 2014 AHGA Hosta of the Year ===		
'Adorable' (PPAF)	M	Fragrant white flowers over glossy green leaves that have very defined chartreuse centers. Sport of <i>H. 'Royal Standard'</i> . Can handle some sun.	4.5	14.95
'Afterglow' (PP26755)	L	Large, green heart-shaped leaves with incredibly striking, wide, yellow margins.	4.5	14.95
'Allan P. McConnell'	S	Narrow, dark green leaves edged in white. Forms neat clumps.	4.5	6.95
'Angel Falls' (PPAF)	M	Forms a rounded mound of cascading green leaves with beautiful white centers. Lighter green appears where margins and centers overlap.	4.5	14.95
'Antioch'	M	Wide, creamy-white edge on medium-green leaves.	4.5	6.95
'Atlantis'	L	Long, dark green ruffled leaves with dramatic golden yellow margin.	4.5	14.95
'August Moon'	M	Large, rounded, uniformly crinkled golden leaves that hold their color all year. Near white flowers.	4.5	4.00 #1 9.25
'Beach Boy'	M	A vigorous grower with slug resistant leaves. Foliage has soft yellow centers with blue-green margins.	4.5	14.95
'Big Daddy'	L	Rich blue-green leaves, heavily corrugated. Near white flowers.	#1	12.95
'Big Mama'	XL	Very large intensely blue-green heart-shaped leaves with heavy puckering. White flowers.	#1	12.95
'Blue Angel'	L	Huge, deep blue leaves. Very heavy texture. Glossy white flowers.	#1	11.95
'Blue Ivory' (PP19623)	M	This ' <i>Halcyon</i> ' sport has wide creamy white margins and blue center in spring. Margins brighten to white in summer.	4.5	14.95
'Blue Mouse Ears'	VS	Blue rounded, thick leaves with lavender flowers. Compact.	4.5	14.95
		=== 2008 AHGA Hosta of the Year ===		
'Bressingham Blue'	M	Cupped, heart-shaped, blue-green leaves of heavy substance. White flowers.	#1	11.95
☺ 'Bridal Falls' (PP25594)	L	Forms a cascading mound of wavy-edged, heart shaped green leaves with pale yellow to creamy white margins.	4.5	14.95
'Brim Cup'	S	Rich green leaves with wide irregular margins.	4.5	11.95
'Brother Stefan'	M	Foliage changes from chartreuse with blue margins to gold with green margins. Heavy, puckered leaves.	4.5	14.95
		=== 2017 AHGA Hosta of the Year ===		
☺ 'Cherry Berry'	S	Eye catching lance shaped dark green leaves with a white center. Red stems hold violet flowers. Named for its seed pods which turn bright red and last through fall.	4.5	11.95
'Christmas Candy'	M	Medium green lance-shaped leaves have wide white centers. A rapid grower.	4.5	14.95
'Church Mouse'	S	Forms a cute miniature clump of blue-green to green thick, wavy leaves.	4.5	14.95

☼ sun ☺ part shade ● shade ☺ new variety (H) height (S) spacing (TP) tender perennial N native

Genus Species/Variety	Common Name	(H)	(S)	Bloom	Loc.	Perennials	
						Size	Price
Hosta	(continued)						
'Coast to Coast'	XL Emerges chartreuse yellow, turning lighter gold in summer. Thick, puckered, wavy leaves form an upright vase-shaped clump.					#1	19.95
	(PP26469)						
'Curly Fries'	S Extremely rippled, narrow leaves. Bright chartreuse foliage is best grown in morning sun.					4.5	14.95
	=== 2016 AHGA Hosta of the Year ===						
'Dancing Queen'	M Exceptionally unique! Leaves emerge bright yellow and remain yellow all season. Large leaves have a prominent pie crust edge.					4.5	14.95
'Diamond Tiara'	M Medium green with a narrow white band on the margins. Wavy edge. Lavender flowers.					4.5	6.95
'Diamonds are Forever'	S Green leaves with a wide, crisp white margin. Sharply contrasting variegation really shows up, even from a distance. Purple flowers.					4.5	14.95
'Dream Queen'	L Large, nearly round bluish-green leaves with creamy white centers. White flowers.					4.5	14.95
'El Nino'	(PP14632) M Very blue leaves are edged in bright white. White flowers.					4.5	14.95
'Empress Wu'	XL This very, very large hosta will create conversation in your shade garden! Huge dark green deeply veined leaves can measure more than 18 inches wide and long. Strongly upright habit, forming a very tall and wide clump.					#1	19.95
	(PP20774)						
'Fantabulous'	M Wavy, dark green leaves with very wide creamy white margins that streak toward the center.					4.5	14.95
'Fire & Ice'	M This spectacular sport of 'Patriot' has pure white centers surrounded by a very deep green margin.					4.5	14.95
'Fire Island'	M Brilliant yellow leaves emerge on red petioles! During the summer, the foliage will cool to dark chartreuse. Grows best in considerable shade.					4.5	14.95
'Firn Line'	M Heart shaped leaves have a very wide white margins and blue centers. Striking!					4.5	14.95
'Forbidden Fruit'	M Thick leaves have glowing yellow centers set off by blue-green edges.					4.5	14.95
f. 'Aureo-marginata'	M Deep-green foliage with a matte sheen. Creamy yellow edge. Lavender flowers.					4.5	6.25
'Fragrant Bouquet'	M Apple green leaves with wide irregular yellow-white margins. Large funnel shaped, fragrant white flowers.					4.5	6.95
	== 1998 AHGA Hosta of the Year ==						
'Francee'	M Shiny dark green foliage with a narrow white edge. Lavender flowers.					4.5	4.00
						#1	9.95
'Frances Williams'	L Blue-green, corrugated with yellow margin. White flowers.					4.5	4.00
						#1	9.95
'Fried Bananas'	L Glossy chartreuse leaves grace this plant that quickly forms a large mound. Fragrant white flowers. Sport of H. 'Guacamole'.					4.5	14.95
'Gold Edger'	S Gold foliage with heavy substance. White flowers.					4.5	6.25
'Gold Standard'	M Creamy yellow foliage with dark green margin. Pinkish-lavender flowers.					4.5	4.00
						#1	9.95
'Golden Tiara'	S Green with wide chartreuse margin. Lavender flowers.					4.5	4.00
						#1	9.25
'Grand Prize'	M This hosta is a real winner! Medium green leaves with very wide yellow margin that turns creamy white. Purple flowers. Exhibits some sun tolerance.					4.5	11.95

☼ sun ☉ part shade ● shade ☺ new variety (H) height (S) spacing (TP) tender perennial N native

Genus Species/Variety	Common Name	(H)	(S)	Bloom	Loc.	Perennials	
						Size	Price
Hosta	<i>(continued)</i>						
'Grand Tiara'	S			This sport of H. 'Golden Tiara' has a wider and more pronounced bright gold margin with a narrow dark green center. Rapid grower.		4.5	11.95
'Guacamole'	L			Chartreuse leaves are margined by the wide green edge. Large fragrant flowers open in August. Outstanding.		4.5	14.95
'Gypsy Rose'	M			Oval leaves are dark green with dazzling yellow centers and white stripes. A sport of H. 'Striptease'.		4.5	14.95
'Halcyon'	M			Spear shaped, intense blue, with heavy substance. White flowers.		4.5	4.00
'Half and Half'	M			This hosta offers instant color in spring. The leaves emerge with a pure white center and dark green margins, and the beautiful variegation remains throughout the season.		#1	9.95
'Hudson Bay'	L			Wide, bright blue margins and apple-green jetting contrast with creamy white centers. Near-white flowers.		4.5	14.95
(PP23598) 'Humpback Whale'	XL			Giant sized plant. Forms a massive, dome-shaped mound of blue-green, corrugated, heart shaped leaves.		#1	19.95
'Island Breeze'	M			Wide, green margins contrast with bright yellow centers. Showy red petioles with dark lavender flowers.		4.5	14.95
(PP27151) 'June'	M			Creamy centered foliage changing to chartreuse, blue margins.		4.5	14.95
☉ 'Komodo Dragon'	XL			Forms a large mound (to seven feet!) of heart-shaped gray-green leaves with rippled margins. Great specimen plant.		4.5	14.95
'Krossa Regal'	L			Heavy textured, powdery blue foliage. Upright habit. Lavender flowers.		4.5	6.95
'Lakeside Paisley Print'	S			Stunning small hosta! Thick, heart shaped leaves with very wide, wavy green margins. Narrow creamy white markings on the leaves shoot out in a feathery pattern.		#1	8.95
lancifolia	M			Shiny green, lance shaped foliage. See it planted as an edging in our display gardens!		4.5	14.95
(PP12531) 'Liberty'	L			Green leaves with wide, jetting, yellow margins which lighten to creamy white. Sport of 'Sagae'.		4.5	14.95
'Luna Moth'	M			Dark-green heart shaped leaves emerge with light green margins which brighten to yellow. Quick grower.		4.5	14.95
'Maui Buttercups'	S			Bright gold, rounded leaves are cupped and corrugated. Near-white flowers.		4.5	14.95
'Mighty Mouse'	S			Mouse ear-shaped leaves emerge blue-green with a creamy yellow edge. Changes to grey-green with creamy white edge in summer. So cute!		4.5	14.95
montana 'Aureo-marginata'	L			Dark green, pointed leaves with bright yellow margin. Upright, vase-like habit. Pale lavender flowers.		4.5	11.95
'Moon Split'	M			Shiny leaves have a dark green stripe in the center, and creamy yellow margins. White flowers.		4.5	14.95
'Morning Star'	M			Leaves have a creamy white-flamed centers with green margins.		4.5	14.95
'Munchkin Fire'	S			Short narrow leaves hold their bright yellow color all season. This small hosta is perfect for troughs and fairy gardens		4.5	14.95
'Northern Exposure'	XL			Huge, corrugated, thick blue-green leaves develop wide yellow-green margins that lighten to cream. White flowers		4.5	14.95
☉ 'Old Glory'	M			Heart shaped leaves have golden-yellow centers and irregular, wide dark green margins.		4.5	14.95
(PP12503) ☉ 'Paradigm'	L			Thick glossy, gold leaves edged with a blue-green margin. The variegation pattern intensifies later in spring.		4.5	14.95
				==== 2007 AHGA Hosta of the Year ====			

☼ sun ☉ part shade ● shade ☉ new variety (H) height (S) spacing (TP) tender perennial N native

Genus Species/Variety	Common Name	(H)	(S)	Bloom	Loc.	Perennials	
						Size	Price
Hosta	<i>(continued)</i>						
'Parky's Prize'	M	Sport of H. 'Birchwood Park's Gold' with a dark blue-green center and gold edge. Excellent vigor.	4.5	7.95			
'Patriot'	M	Similar to 'Francee' except very wide white margin. Medium violet flowers. == 2005 WNA Plant of the Year ==	4.5	4.00			
plantaginea	M	(August Lily) Very shiny green foliage. Large fragrant white flowers in late summer.	4.5	6.95			
☺ 'Prairie's Edge'	M	Brilliant yellow centers and very wide dark green margins are connected by light green coloration.	4.5	14.95			
'Prairie Moon'	M	Distinctive yellow foliage keeps its color all season, but turns lighter in summer. Thick wedge shaped leaves.	4.5	14.95			
'Prairie Sky'	M	One of the bluest hostas available! Powdery blue, lightly cupped leaves of thick substance.	4.5	14.95			
☺ 'Praying Hands'	M	A unique hosta with foliage resembling hands folded in prayer. Dark green, rippled leaves with gold margins.	4.5	14.95			
'Rainbow's End'	M	Incredibly variegated, shiny foliage. Bright yellow leaves have dark green margins that jet into the center. In summer, centers brighten to creamy white and red scapes carry dark lavender, tubular flowers.	4.5	14.95			
'Raspberry Sundae'	M	Foliage has creamy-white center and irregular green margin. Stunning dark red stems and leaf bases.	4.5	14.95			
'Regal Splendor'	XL	Blue-green leaves with contrasting creamy margin. Vase-shaped, upright form. A sport of H. 'Krossa Regal'.	4.5	14.95			
'Remember Me'	S	Bright creamy center framed by a blue-green margin. Its smaller size makes it perfect for small areas or the front of the border. The white centers brighten up dark areas.	4.5	14.95			
'Rhino Hide'	L	The thickest leaves of any hosta!! Super resistant to slugs. Cupped, puckered leaves have wide, blue margins and a narrow light green center that brightens to yellow.	4.5	14.95			
'Royal Standard'	M	Glossy green foliage. Fragrant white flowers.	4.5	4.00			
☺ 'Royal Wedding'	M	Thick, shiny green leaves with a very wide creamy white margin. Large, white flowers are sweetly fragrant.	4.5	14.95			
☺ 'School Mouse'	S	Thick, wavy leaves have blue-green centers and creamy yellow margins. A sport of H. 'Church Mouse'.	4.5	14.95			
☺ 'Seducer'	L	Large dark green leaves, slightly ruffled, with gold margin and a trace of white between the two. Near white flowers.	#1	19.95			
sieboldiana 'Elegans'	L	(Blue Giant) Heavy-textured, blue-green foliage. White flowers.	4.5	4.00			
'So Sweet'	M	Green, lance-shaped leaves with white margins. Fragrant white flowers.	4.5	6.95			
'Stained Glass'	L	Brilliant gold leaves with dark green margins. Prominent veins in the leaf give it the look of stained glass. Fragrant, pale lavender flowers. = 2006 AHGA Hosta of the Year =	4.5	14.95			
'Stirfry'	M	Clear green shiny leaves with wavy margins and stunning rippled edges.	4.5	14.95			
'Sum and Substance'	XL	Chartreuse-gold, heavy substance leaves with a waxy sheen. === 2004 AHGA Hosta of the Year ===	#1	12.95			
'Summer Breeze'	M	Dark green leaves have a sheen to them, and show off contrasting wide streaky yellow margins.	4.5	14.95			
'Sun Mouse'	S	Similar to 'Blue Mouse Ears', but with brilliant yellow leaves. Plant in morning sun or filtered shade for best color.	4.5	14.95			
'Sun Power'	L	One of the very best gold hostas. Features unique twisted and pointed golden leaves that rapidly grow into a beautiful clump. Holds color in considerable sun.	4.5	11.95			

☼ sun ☺ part shade ● shade ☺ new variety (H) height (S) spacing (TP) tender perennial N native

Genus Species/Variety	Common Name		(H)	(S)	Bloom	Loc.	Perennials	
							Size	Price
Hosta	<i>(continued)</i>							
'Sweet Home Chicago'	M	Sport of <i>H. 'Birchwood Park's Gold'</i> with a dark blue-green edge and bright gold center. Excellent vigor. Nice in combination with <i>H. 'Parky's Prize'</i> which is the same plant with the opposite variegation pattern.					4.5 #1	7.95 11.95
'Touch of Class'	M	Intense blue leaves with gold flame in center have incredibly thick substance and are held upright. Slug resistant.					4.5	14.95
☺ 'Twilight'	L	Very large leaves are of heavy substance. Green with wide creamy-gold margins. Slug resistant.					4.5	14.95
undulata 'Albo-marginata'	M	Medium green with white creamy-white margin. Lavender flowers.					4.5 #1	5.95 8.95
undulata 'Variegata'	M	Medium green with white centers. Twisted leaves. Lavender flowers.					#1	8.95
'Velvet Moon'	M	Thick, clear green leaves with a very wide yellow edge.					4.5	14.95
'Victory'	L	Shiny green leaves of good substance display yellow margins which lighten to pale yellow. Slower grower...although it is a large size hosta, it does take some years to develop the huge leaves and distinctive variegation that make it so special. == 2015 AHGA Hosta of the Year ==					4.5	14.95
'Wheee!'	M	Extremely ruffled, cream colored margins on green leaves. Thicker leaves are slug resistant.					#1	19.95
'White Feather'	M	First emerges with pointy ivory-cream leaves, later develops green stripes. Does not tolerate sun.					4.5	14.95
'Wide Brim'	M	Green with wide, white margin. Lavender flowers.					4.5	6.95
'Wishing Well'	L	Large blue hosta that is quite sun tolerant. Huge, thick leaves are attractively cupped, rippled and corrugated.					4.5	14.95
☺ 'Yankee Blue'	L	Vigorous grower. Elongated wedge-shaped blue leaves are wavy. Near-white flowers.					#1	12.95
☺ 'Yellow Polka Dot Bikini'	M	Cupped leaves flatten out later. Wide bright yellow margins, green center, white lines divide the two.					4.5	14.95

Houttuynia Lizard's Tail

<i>cordata</i> 'Chameleon'	Groundcover with red, cream and green foliage. Spreads via underground runners.	10"	12"	June-July	☼●	4.5	4.95
----------------------------	---------------------------------------------------------------------------------	-----	-----	-----------	----	-----	------

Humulus (Hops) see Vines Section

Hydrangea see Vines Section

Hypericum St. John's Wort

<i>calycinum</i>	Large yellow flowers that seem to glow. Likes partial shade.	12"	18"	June-July	☼☉	4.5	4.95
------------------	--------------------------------------------------------------	-----	-----	-----------	----	-----	------

Iberis Candytuft

Low growing woody stemmed evergreen plant. The flowers are single, pure white and develop in 2-3" clusters. One of the earliest spring flowering perennials. Drainage is important to survive the winter.

'Alexander's White'	Shiny dark green foliage. Very dense grower. Evergreen.	8"	15"	April-May	☼☉	4.5	4.95
---------------------	---------------------------------------------------------	----	-----	-----------	----	-----	------

Imperata (Japanese Blood Grass) see Grasses, Sedges, and Rush Section

☼ sun ☉ part shade ● shade ☺ new variety (H) height (S) spacing (TP) tender perennial N native

Genus	Common Name	(H)	(S)	Bloom	Loc.	Perennials	
						Species/Variety	Size

Iris

	pallida 'Albo-Variegata'	Blue-green leaves with white streaking, fragrant lavender blue flowers.	24"	18"	June-July	☼	#1	9.95
	pallida 'Variegata'	Blue-green leaves with yellow streaking, fragrant lavender blue flowers.	24"	18"	June-July	☼	#1	9.95
N	versicolor (Blue Flag Iris)	Blue flowers. Performs best in moist areas.	30"	18"	May-June	☼	4.5	5.95

Iris ensata

Japanese Iris

Ensata types are the iris group latest to bloom, about a month after the Tall Bearded and Siberian Iris. They have the largest flowers of all groups. These iris prefer full sun and ample water.

	'Sensation'	Rich purple with yellow centers, double flowers.	32"	18"	June-July	☼	#1	9.95
	'Variegata'	Variegated leaves, purple flowers.	30"	18"	June-July	☼	#1	9.95

Iris germanica

Tall Bearded Iris

This group of iris is not particular about soil but definitely prefers a sunny location. Can withstand dry conditions and soggy soils should be avoided. Blooms early summer.

	'Again & Again'	Bright yellow flowers, reblooms.	36"	18"	June, Sept	☼	#1	9.95
	'Clarence'	Pale violet-blue flowers are ruffled with white beards. Reblooms!	35"	18"	June, Sept	☼	#1	9.95
	'Coal Seams'	Flowers are nearly as black as coal! Thick, velvety and ruffled petals glimmer in the sun.	40"	18"	June	☼	#1	9.95
	'Firebreather'	Orange with bright tangerine beards.	37"	18"	June, Sept	☼	#1	9.95
	'Immortality'	Pure white self with light lemon yellow beards. Vigorous grower. Reblooms in fall.	29"	18"	June, Sept	☼	#1	9.95
	'Jurassic Park'	Canary yellow and purple flowers with a slight, sweet fragrance.	36"	18"	June	☼	#1	9.95
	'Lenora Pearl'	Salmon-pink self, with tangerine colored beards. Rebloomer.	28"	18"	June, Sept	☼	#1	9.95
	'Mary Frances'	Lavender-blue ruffled flowers.	38"	18"	June	☼	#1	9.95
	'Speeding Again'	Dark blue-violet flowers. Rebloomer.	38"	18"	June, Sept	☼	#1	9.95
	'Superstition'	One of the darkest iris! Near black flowers.	34"	18"	June	☼	#1	9.95
	'War Chief'	Beautiful red flowers. Very long bloom season.	37"	18"	June	☼	#1	9.95

Iris pumila

Dwarf Iris

Pumila types are miniature Bearded Iris and require the same attention, or lack thereof. Not particular about soil but require a sunny location. Can also withstand dry conditions. Blooms earlier.

	'Baby Blessed'	Light yellow flowers in the spring and again in fall. Rated as the best reblooming miniature iris.	12"	15"	April-May, Sept	☼	4.5	5.95
	'Blue Denim'	Light blue flowers.	14"	15"	April-May	☼	4.5	5.95

Iris sibirica

Siberian Iris

Siberian types are excellent for landscaping. They tolerate nearly any soil and are drought tolerant after they are established. Ideal plant for full sun and moist soil. They bloom after the Bearded Iris and before the Japanese Iris.

	'Butter and Sugar'	Butter yellow and white flowers.	28"	18"	June-July	☼	4.5	6.25
	'Caesar's Brother'	Rich deep violet-blue flowers.	36"	18"	June-July	☼	4.5	6.25
	'White Swirl'	Large, pure white flowers.	36"	18"	June-July	☼	#1	9.25
						☼	4.5	6.25

☼ sun ☉ part shade ● shade ☺ new variety (H) height (S) spacing (TP) tender perennial N native

Genus Species/Variety	Common Name	(H)	(S)	Bloom	Loc.	Perennials	
						Size	Price
Kalimeris Japanese Aster							
i. 'Daisy Mae'	Petite, white flowers cover a compact mound of green foliage. A must for the butterfly garden!	24"	18"	July-Aug	☼	4.5	5.95
yomena 'Shogun'	Yellow edged variegation fades through the growing season. Spreading habit. Lavender Aster-like flowers.	12"	18"	July-Sept	☼☉	4.5	5.95
Kirengeshoma Yellow Waxbells							
palmata	Shrub-like plant with maple like leaves. Waxy yellow, funnel-shaped flowers, 1-2" long.	30"	24"	Sept	☉●	#1	9.95
Knautia							
macedonica 'Mars Midget'	A profusion of brilliant ruby-red flowers from June into fall on compact, dwarf plants. Attractive to butterflies. Zone 5	16"	12"	June-Sept	☼☉	4.5	4.95
Kniphofia Red Hot Poker							
hirsuta 'Fire Dance'	Coral red and yellow flower spikes atop a thick clump of narrow, arching, blue-green foliage. Hardy to zone 4. Deer resistant.	20"	15"	June-Aug	☼	4.5	5.95
Lamium Yellow Archangel							
Excellent groundcover for dry, shady areas.							
galeobdolon 'Herman's Pride'	Silvery spotted foliage. Clump forming.	12"	12"	May-June	☉●	4.5	4.95
g. 'Florentinum' (variegatum)	Spreading groundcover. Yellow flowers with variegated foliage.	8"	12"	May-June	☉●	4.5	4.95
Lamium Dead Nettle							
Excellent groundcover for adding color to shaded areas. Both foliage and flowers provide the contrast. Plants do best in part shade, but will tolerate deeper shade. Don't let Lamium get too wet or they will rot out.							
maculatum 'Beacon Silver'	Silvery leaves with narrow green margins, rose-pink flowers.	6"	12"	May-July	☉●	4.5	4.95
m. 'Chequers'	Marbled foliage with rose-pink flower.	8"	12"	May-July	☉●	4.5	4.95
m. 'Pink Pewter'	Clear pink form of 'White Nancy'.	6"	12"	May-July	☉●	4.5	4.95
m. 'Purple Dragon' (PP15890)	Silver foliage. Rich purple flowers.	6"	12"	May-July	☉●	4.5	4.95
m. 'Shell Pink'	Green and white variegated foliage with soft pink flowers.	8"	12"	May-July	☉●	4.5	4.95
m. 'White Nancy'	Nearly all silver leaves with narrow blue-green margins. Pure white flowers.	8"	12"	May-July	☉●	4.5	4.95
Lathyrus Perennial Sweet Pea							
A climbing, scrambling vine with gray-green foliage and clusters of pea like blossoms.							
latifolius	Mixed colors.	60"	24"	July-Aug	☼	4.5	4.95

☼ sun ☉ part shade ● shade ☉ new variety (H) height (S) spacing (TP) tender perennial N native
34

Genus Species/Variety	Common Name	(H)	(S)	Bloom	Loc.	Perennials	
						Size	Price
Lavendula Lavender							
Fragrant herb with gray green lance shaped foliage. A well drained site is needed for Lavender to be hardy here.							
angustifolia	'Hidcote' Midnight blue flowers.	15"	15"	June-Sept	☼	4.5	4.95
a. 'Jean Davis'	Pale pink flowers.	18"	15"	June-Sept	☼	4.5	4.95
a. 'Munstead'	Lavender flowers, silver foliage.	15"	15"	June-Sept	☼	4.5	4.95
i. 'Provence'	The best variety for bouquets, potpourri and culinary use. Narrow, light blue flower spikes have a sweet fragrance.	36"	24"	June-Sept	☼	4.5	4.95
x i. PHENOMENAL™ (PP24193)	Forms a very large uniform, dense mound of silvery green foliage topped with tall wands of rich purple flowers.	24"	48"	July-Sept	☼	#1	9.95
Leontopodium Edelweiss							
alpinum	Narrow wooly white foliage with creamy white flowers. Great rock garden plant.	6"	12"	June-Sept	☼	4.5	4.95
Leptinella Brass Buttons							
s. 'Platt's Black'	An excellent groundcover. Delicate fern-like foliage is accented with smokey grey tones. Tolerates moderate foot traffic.	3"	12"	June-July	☼	4.5	4.95
Leucanthemum (Chrysanthemum) Shasta Daisy							
In hot areas some shade is recommended. Taller varieties make good cut flowers.							
superbum	'Alaska' Large single white flowers.	24"	18"	June-Aug	☼	4.5	4.95
s. 'Banana Cream'	(PP23181) Superb selection! 4" flowers open lemon yellow, then brighten to light butter yellow and finally to creamy white as they mature. Vigorous grower with compact foliage.	18"	18"	June-Aug	☼	#1	8.95
s. 'Becky'	A long-lived daisy that holds up well in the heat and humidity. Single white flowers above shiny green foliage. ===== 2003 PPA Plant of the Year =====	30"	18"	June-Aug	☼	4.5	4.95
						#1	7.95
s. 'Silver Princess'	Showy, compact plant covered with large single white blooms.	12"	18"	June-Aug	☼	4.5	4.95
s. 'Snow Lady'	Excellent dwarf habit, beautiful white flowers and long bloom season.	8"	18"	June-Aug	☼	4.5	4.95
s. 'Snowcap'	Medium height. Long lasting white flowers on neat mounded plants.	18"	18"	June-Aug	☼	4.5	4.95
						#1	7.95
Liatris Blazing Star / Gay Feather							
Tall spikes of flowers emerge from tufts of glossy linear leaves. Excellent cut flowers. Prefers a moderately fertile, sandy soil. Easy to grow. Flowers in mid to late summer.							
N aspera	(Rough Blazing Star) Striking bright magenta spike flowers adorn this prairie wildflower. Seeds are loved by finches. Needs good drainage, tolerates dry soils.	30"	15"	July-Sept	☼	4.5	5.95
N pycnostachya	Native, tallest species, rosy-purple flowers.	48"	15"	July-Sept	☼	4.5	5.95
N spicata	Purple flowers.	30"	15"	July-Sept	☼	4.5	4.95
						#1	7.95
s. 'Alba'	White flowers.	30"	15"	July-Sept	☼	4.5	4.95
						#1	7.95
s. 'Kobold'	Shorter variety, rose-lavender flowers.	18"	15"	July-Sept	☼	4.5	4.95
						#1	7.95

☼ sun ☼ part shade ● shade ☼ new variety (H) height (S) spacing (TP) tender perennial N native

Genus Species/Variety	Common Name	(H)	(S)	Bloom	Loc.	Perennials	
						Size	Price

Ligularia **Bigleaf Golden Ray / Ragwort**

Impressive plants with large leaves. Flowers on 'Bottle Rocket', 'Little Rocket', and 'The Rocket' are tall spikes above the foliage. The others are loaded with daisy like flowers.

Ligularias need constant moisture for best performance.

'Bottle Rocket' (PP24486) Excellent garden performer. Perfectly proportional plant forms a dense clump of thick, serrated green leaves with mustard yellow flower spikes held on chocolate stems just above the foliage.	30"	24"	July-Sept	☉●	#1	9.95
dentata 'Brit-Marie Crawford' (PP16113) Glossy chocolate maroon foliage. Golden orange daisy-like flowers.	32"	24"	July-Sept	☉●	#1	12.95
d. 'Desdemona' Orange-yellow daisy-like flowers.	36"	24"	July-Sept	☉●	#1	9.95
d. 'Othello' Golden yellow flowers with purple leaves.	36"	24"	July-Sept	☉●	#1	9.95
'King Kong' (PPAF) Glossy black-purple leaves are 16" across! Golden orange daisy-like flowers. Plant in morning sun for best leaf color, and in consistently moist soil.	36"	36"	July-Sept	☉●	#1	9.95
'Little Rocket' (PP14621) Shorter form of L. 'The Rocket'. Yellow flower spikes with heart shaped leaves.	40"	24"	July-Sept	☉●	#1	9.95
stenocephala 'The Rocket' Golden yellow spikes. Serrated foliage.	60"	24"	July-Sept	☉●	#1	9.95

Lilium **Hardy Lily**

Hardy Lilies are excellent for containers and garden use. Many of our lilies are the short varieties, which don't require staking in the garden. The oriental lilies have larger flowers and are fragrant. Excellent cut flower.

Asiatic Hybrids:

'Elgrado' Cherry red flowers.	18"	18"	June-July	⚙	4.5	5.95
'Landini' Dark velvet flowers.	36"	18"	June-July	⚙	#1	8.95
'Matrix Golden' Golden yellow flowers, speckled center.	16"	18"	June-July	⚙	4.5	5.95
'Matrix Orange' Orange flowers, speckled in the center.	16"	18"	June-July	⚙	4.5	5.95
'Matrix Red' ('Buzzer') Rosy-red flowers.	16"	18"	June-July	⚙	4.5	5.95
'Mount Duckling' Pink flowers.	18"	18"	June-July	⚙	4.5	5.95
'New Wave' Pure white flowers.	20"	18"	June-July	⚙	4.5	5.95

Oriental Hybrids:

'Casa Blanca' Pure white flowers, fragrant.	48"	18"	June-July	⚙	4.5	5.95
'Mona Lisa' (PP7379) Pink flowers with white stripes.	24"	18"	June-July	⚙	4.5	5.95
'Muscadet' Large white flowers with pink spots, fragrant.	32"	18"	June-July	⚙	4.5	5.95
'Star Gazer' Spotted crimson red over creamy white.	32"	18"	June-July	⚙	4.5	5.95

Linum **Flax**

perenne 'Sapphire' Sapphire blue flowers over finely textured blue-green foliage.	12"	12"	June-July	⚙	4.5	4.95
------------------------------------------------------------------------------------------	-----	-----	-----------	---	-----	------

Lobelia **Cardinal Flower**

Tall spikes, topped with tubular flowers. Prefers moist soil. Attracts hummingbirds.

N cardinalis Native plant, dark green foliage with red flowers.	30"	18"	July-Sept	⚙☉	4.5	4.95
fulgens 'Queen Victoria' (TP) Deep scarlet, red foliage.	30"	18"	July-Sept	⚙☉	4.5	4.95
N siphilitica Native plant, blue-violet flowers. Self seeds.	30"	18"	July-Sept	⚙☉	4.5	4.95

⚙ sun ☉ part shade ● shade ☉ new variety (H) height (S) spacing (TP) tender perennial N native

Genus Species/Variety	Common Name	(H)	(S)	Bloom	Loc.	Perennials	
						Size	Price

Lupinus

Lupine

A mound of light green foliage followed by erect tall flower stems. Very showy flower spikes. A cool, moist area is preferred. Sensitive to hot summers. Likes lots of compost mixed with the soil upon planting, in a spot with morning sun and afternoon shade.

'Minarette'	Beautiful mixed colors. Shorter form.	18"	15"	June-July	☼☉	#1	6.95
'Russell Mix'	Mixed colors.	36"	15"	June-July	☼☉	#1	6.95
<i>Popsicle Series - make lovely cut flowers.</i>							
Popsicle Series – Blue	Purple-blue flowers.	20"	15"	June-July	☼☉	#1	6.95
Popsicle Series – Pink	Pink or pink/white bicolor flowers.	20"	15"	June-July	☼☉	#1	6.95
Popsicle Series – Red	Red flowers.	20"	15"	June-July	☼☉	#1	6.95

Lychnis

Maltese Cross / Catch Fly

chalconica	Star shaped red-orange flowers. Cut to the ground after flowering to promote new fresh leaves.	24"	15"	June-July	☼	4.5	4.95
-------------------	------------------------------------------------------------------------------------------------	-----	-----	-----------	---	-----	------

Lysimachia

Moneywort

nummularia 'Aurea'	Golden foliage. May burn in full sun. Outstanding in containers.	2"	12"	July-Aug	☉	4.5	4.95
---------------------------	------------------------------------------------------------------	----	-----	----------	---	-----	------

Macleaya

Plume Poppy / Bocconia

Imposing perennials, which require ample room to grow and are best used as a specimen plant in the back of the border. Leaves are about 8" wide and are grayish white on the underside.

cordata	Plume-like cream-pink colored flowers.	96"	36"	July-Aug	☼	#1	9.25
----------------	----------------------------------------	-----	-----	----------	---	----	------

Mazus

Mat forming creeping groundcover with tiny leaves. Excellent between stepping stones, pavers, or in rock gardens. Grows more rapidly in moist soil. Tiny tubular flowers in spring resemble butterflies.

reptans	Blue flowers.	2"	12"	May-June	☼☉	4.5	4.95
----------------	---------------	----	-----	----------	----	-----	------

Mertensia

Virginia Blue Bells

N virginica	Native blue bells for shady woodland settings, plant goes dormant in summer.	12"	15"	April-May	☉●	4.5	5.95
--------------------	------------------------------------------------------------------------------	-----	-----	-----------	----	-----	------

Mimulus

Monkey Flower

☉ ringens	Shiny foliage. Lavender-blue snapdragon-like flowers appear profusely all summer. Likes moist soil, boggy areas. May spread.	24"	15"	June-July	☼☉	4.5	5.95
------------------	------------------------------------------------------------------------------------------------------------------------------	-----	-----	-----------	----	-----	------

Miscanthus (Maidengrass/Eulalia) see *Grasses, Sedges, and Rush Section*

Molinia (Tall Moor Grass) see *Grasses, Sedges, and Rush Section*

☼ sun ☉ part shade ● shade ☉ new variety (H) height (S) spacing (TP) tender perennial N native

Genus Species/Variety	Common Name	(H)	(S)	Bloom	Loc.	Perennials	
						Size	Price

Monarda Bee Balm / Bergamot

Large clumps of strong, erect, square stems with dark green leaves that are strongly scented. Not particular about soil. However, mildew can be a problem. Monarda attracts bees, butterflies and hummingbirds.

'Gardenview Scarlet' Improved form of 'Cambridge Scarlet', very mildew resistant with larger red flowers.	30"	18"	July-Sept	☼☉	4.5	4.95	
'Jacob Cline' Large red flowers on 5' mildew resistant plant.	60"	18"	July-Sept	☼☉	#1	7.95	
'Marshall's Delight' Lavender-pink flowers, mildew resistant.	30"	18"	July-Sept	☼☉	4.5	4.95	
'Purple Rooster' Large, true royal purple flowers over clean foliage. Strong stems do not require staking.	36"	18"	July-Sept	☼☉	#1	8.95	
'Raspberry Wine' Clear wine red flowers. The buds really do resemble raspberries. Very mildew resistant.	36"	18"	July-Sept	☼☉	4.5	4.95	
<i>SugarBuzz Series</i>							
'Bubblenum Blast' (PP27497) Hot pink flowers on strong stems. Dark green foliage, very aromatic.	24"	18"	July-Sept	☼☉	#1	8.95	
'Cherry Pops' (PP27619) Cherry red flowers on strong stems. Dark green foliage, very aromatic.	20"	18"	July-Sept	☼☉	#1	8.95	
'Cotton Candy' (PPAF) Light pink flowers. Dark green foliage, very aromatic.	15"	18"	July-Sept	☼☉	#1	8.95	
'Grape Gumball' (PP27498) Vibrant magenta flowers on strong stems. Dark green foliage, very aromatic.	24"	18"	July-Sept	☼☉	#1	8.95	
'Lilac Lollipop' (PP27571) Lavender lilac flowers on strong stems. Dark green foliage, very aromatic.	20"	18"	July-Sept	☼☉	#1	8.95	

Nepeta Cat Mint

Great border plant with highly aromatic and attractive foliage. Will rebloom if cut back after first bloom.

faaseni 'Purrsian Blue' (PP24788) Very floriferous! Two-tone periwinkle blue and purple flowers. Scented foliage. Tidy growth habit.	18"	18"	June-Sept	☼	4.5	4.95	
☺ f. 'Kitten Around' (PPAF) The most compact and petite variety. Tight, round mound of aromatic foliage with periwinkle blue flowers.	12"	15"	June-Sept	☼	4.5	4.95	
s. 'Sweet Dreams' Large, soft, two-toned pink flowers on upright, clumping stems of neat serrated leaves.	18"	18"	June-Aug	☼☉	#1	9.25	
'Walker's Low' Grey-green foliage has arching stems and is covered with violet-blue flowers for much of the season. Great for pollinators!	24"	18"	April-Sept	☼☉	4.5	4.95	
					#1	7.95	
==== 2007 PPA Perennial Plant of the Year ====							

Oenothera Evening Primrose / Sun Drops

fruticosa 'Fireworks' Upright species, yellow flower. Rapid spreader.	18"	15"	July-Sept	☼☉	4.5	4.95
macrocarpa (missouriensis) (Ozark Sundrop) Large canary yellow flowers. Dark green foliage. Seed pods can be used in dried floral arrangements.	12"	15"	June-Aug	☼☉	#1	7.95
					4.5	4.95

Pachysandra Japanese Spurge

Popular evergreen shade groundcover. Shiny green foliage with creamy white flowers.

terminalis 'Green Carpet' Better evergreen color.	8"	12"	May-June	☉●	2.5	1.95
---------------------------------------------------	----	-----	----------	----	-----	------

☼ sun ☉ part shade ● shade ☺ new variety (H) height (S) spacing (TP) tender perennial N native

Genus Species/Variety	Common Name	(H)	(S)	Bloom	Loc.	Perennials	
						Size	Price
Paeonia Peony Hybrids							
Low maintenance perennials for any garden. Clump forming, bush like growing habits. Single varieties don't flower as long as the double varieties. Peonies are not particular about soil, but a sunny location is required for best flower production. Can also be used as cut flower. The Peony varieties grown at Shady Acres are deer resistant.							
☺	'Big Ben'	Double (Early)	36"	36"	May-June	☼	#1 14.95
	'Bowl of Beauty'	Single (Mid) Light pink with yellow center.	38"	36"	May-June	☼	#1 14.95
☺	'Buckeye Belle'	Semi-double (Early) Dark maroon.	30"	36"	May-June	☼	#1 14.95
	'Coral Charm'	Semi-double (Early) Coral flowers.	30"	36"	May-June	☼	#1 14.95
	'Duchess de Nemore'	Double (Late) Creamy white.	34"	36"	May-June	☼	#1 14.95
	'Early Scout'	Single (Very Early) Dark red with yellow stamens. Finely cut leaves.	22"	36"	May	☼	#1 14.95
☺	'Festiva Maxima'	Double (Early) Clear white with red flecks.	34"	36"	May-June	☼	#1 14.95
	'Karl Rosenfield'	Double (Mid) Dark wine-red.	34"	36"	May-June	☼	#1 14.95
	'Krinkled White'	Single (Early) White, neatly crinkled petals.	32"	36"	May-June	☼	#1 14.95
☺	'Miss America'	Semi-Double (Mid) Creamy white outer petals, with golden yellow centers.	36"	36"	May-June	☼	#1 14.95
	'Paul M. Wild'	Double (Mid) Large velvety red flowers.	38"	36"	May-June	☼	#1 14.95
	'Primevere'	Single (Mid) Creamy outer petals with large yellow center.	34"	36"	May-June	☼	#1 14.95
	'Sarah Bernhardt'	Double (Late) Medium rose-pink.	36"	36"	May-June	☼	#1 14.95
	'Scarlet O'Hara'	Single (Early) Scarlet red flowers with yellow stamens.	36"	36"	May-June	☼	#1 14.95
	'Shirley Temple'	Double (Early) Light rose fading to white.	36"	36"	May-June	☼	#1 14.95
	'Sorbet'	Double (Mid) Light pink flower with yellow ring in the center.	30"	36"	May-June	☼	#1 14.95
	'Sweet Harmony'	Double (Late) Soft pink flowers, extremely floriferous.	36"	36"	May-June	☼	#1 14.95

Panicum (Switch Grass) see *Grasses, Sedges, and Rush Section*

☼ sun ☺ part shade ● shade ☺ new variety (H) height (S) spacing (TP) tender perennial N native

Genus Species/Variety	Common Name	(H)	(S)	Bloom	Loc.	Perennials	
						Size	Price
Papaver Poppy							
Basal light green foliage with bristly hairy texture. Erect stout stems with nodding flower buds open to large brilliant colored flowers. Most varieties bloom in late spring. Foliage goes dormant after flowering and returns in early fall.							
burseri (alpinum)	Low tufts of gray foliage. Mixed flowers from white to yellow to orange. Short lived perennial.	10"	15"	May-Aug	☼	4.5	4.95
nudicaule 'Wonderland Mix'	Bright colored flowers in mixed colors on strong upright stems. Short lived perennial, may self seed.	10"	15"	May-June	☼	4.5	4.95
orientale 'Allegro'	Red flowers, shorter variety.	18"	15"	May-June	☼	4.5	4.95
o. 'Plum Pudding'	Rich plum pink flowers.	30"	15"	May-June	☼	#1	9.95
o. 'Prince of Orange'	Orange flowers.	30"	15"	May-June	☼	4.5	4.95
o. 'Queen Alexander'	Bright, salmon-pink, with smooth rounded petals.	30"	15"	May-June	☼	#1	9.95
o. 'Royal Wedding'	Papery, white, flouncy blooms.	30"	15"	May-June	☼	#1	9.95
Pardancanda Candyliily							
norrisii	Iris-like foliage with 1" blooms in an array of bright colors. Flowers are followed by shiny black seedpods.	36"	15"	July-Sept	☼	4.5	4.95
Dazzler Series	Shorter strain with extra large flowers in exciting colors.	18"	15"	July-Sept	☼	4.5	4.95
Parthenium American Feverfew							
N integrifolium	A native prairie plant. Large, bold leaves. Flat topped clusters of small, white flowers rise above the foliage.	36"	24"	June-July	☼	4.5	5.95
Pennisetum (Fountain Grass) see Grasses, Sedges, and Rush Section							
Penstemon Beardtongue							
Tubular flowers on wiry stems high above the foliage. Will attract hummingbirds. Rumored to repel deer.							
☺	'Blackbeard' (PPAF) Dark eggplant-purple colored foliage. Flowers are lilac purple with white tips. Upright habit.	32"	24"	June-July	☼	#1	7.95
	'Dark Towers' (PP20013) Dark foliage emerges wine-purple and keeps its color. Masses of pink flowers. === 2015 WNLA Perennial Plant of the Year ===	40"	24"	June-July	☼	#1	7.95
	digitalis 'Husker Red' Bronze foliage with white flowers. === 1996 PPA Perennial Plant of the Year ===	40"	24"	June-July	☼	4.5	4.95
	'Prairie Dusk' Rose-purple flowers on sturdy stems above shiny dark green basal foliage.	20"	15"	June-July	☼	#1	7.95
Perovskia Russian Sage							
Graceful, aromatic shrub-like perennial with attractive, silvery gray foliage. Tips of branches produce small, whirled lavender blue flowers.							
	atriplicifolia (Russian Sage) Silvery gray aromatic foliage, violet-blue flowers. == 1995 PPA Plant of the Year ==	40"	24"	July-Sept	☼	#1	9.25
	a. 'Denim and Lace' (PPAF) Stays compact, has stronger stems and a more upright habit than older varieties. Full of lacy-like, sky blue flowers.	30"	24"	June-Sept	☼	#1	11.95
	a. 'Longin' More upright form of atriplicifolia, same violet-blue flowers.	40"	24"	July-Sept	☼	#1	9.25

☼ sun ☺ part shade ● shade ☺ new variety (H) height (S) spacing (TP) tender perennial N native

Genus Species/Variety	Common Name	(H)	(S)	Bloom	Loc.	Perennials	
						Size	Price

Persicaria

filiformis 'Painter's Palette' Green leaves with central red/brown zones, ivory yellow splashes and stripes with an overall pink tinge. 28" 18" June-Sept ☼☉ 4.5 6.95

Phlox carolina Carolina Phlox

Flowers mid to late summer, longer than most other Phlox types. Very fragrant flowers and good as cut flower. Forms a tidy clump. Resistant to mildew.

carolina 'Bill Baker' Vigorous pink flowers with light center. 20" 18" June-Sept ☼ 4.5 5.95

Phlox divaricata Woodland Phlox

Divaricata types are different than all other Phlox groups. They form a loose creeping mat of many tiny stems with semi evergreen foliage. Fragrant flowers appear in early summer.

N divaricata (Wild Sweet William) Semi-evergreen, mat forming ground cover with blue flowers. 12" 12" May-June ☉● 4.5 5.95
 ☉ **d. 'Blue Moon'** Fragrant, violet-blue flowers. Very showy groundcover in part shade. 12" 12" May-June ☉● 4.5 5.95
d. 'May Breeze' Very pale blue, almost white flowers. 10" 12" May-June ☉● 4.5 5.95

Phlox paniculata Tall Garden Phlox / Border Phlox

The common garden phlox has a sweet fragrance. Recent introductions are more mildew resistant. Stems are strong and can be used as cut flowers. Flowers mid to late summer. Not particular about soil.

The FLAME series phlox are shorter, disease resistant varieties with bushy growing habits.

FLAME Coral (PP22234) Large, fragrant coral red flowers. 18" 18" July-Aug ☼ 4.5 5.95
FLAME Pink (PP11804) Fragrant flowers are fuchsia with a darker pink eye. 18" 18" July-Aug ☼ 4.5 5.95
FLAME Purple (PP12605) Rich purple flowers with a small darker eye. 18" 18" July-Aug ☼ 4.5 5.95
FLAME Red (PPAF) Intense red flowers. 18" 18" July-Aug ☼ 4.5 5.95
paniculata 'Blue Boy' Blue with white eye, light fragrance. 38" 18" July-Aug ☼ 4.5 5.95
p. 'Bright Eyes' Large clusters of light pink flowers with very deep pink eyes. 30" 18" July-Aug ☼ 4.5 5.95
p. 'David' White, fragrant, highly mildew resistant. 36" 18" July-Aug ☼ 4.5 5.95
 ===== 2002 PPA / WNA Plant of the Year =====
p. 'Glamour Girl' (PP25778) Glowing coral-pink flowers on dark stems. Very mildew resistant. 32" 18" July-Aug ☼ #1 8.95
p. 'Laura' Purple flowers with white center. Mildew resistant. 36" 18" July-Aug ☼ 4.5 5.95
p. 'Nicky' Stunning deep magenta flowers. Fragrant. Good mildew resistance. 36" 18" July-Aug ☼ 4.5 5.95
p. 'Norah Leigh' Lavender flowers with creamy yellow variegated foliage. 30" 18" July-Aug ☼ 4.5 5.95
p. 'Orange Perfection' Orange red flower, compact grower. 30" 18" July-Aug ☼ 4.5 5.95
p. 'Starfire' Bright red blooms on compact plants. 32" 18" July-Aug ☼ 4.5 5.95

Phlox stolonifera Woodland Creeping Phlox

Very shade tolerant. Grows in rich, humus soil. Attractive evergreen foliage. Low mat forming ground cover, good for woodland areas. ===== 1990 PPA Plant of the Year =====.

s. 'Blue Ridge' Very nice blue. 8" 12" April-May ☉● 4.5 4.95
s. 'Home Fires' Deep pink, most fragrant of the bunch. 8" 12" April-May ☉● 4.5 4.95
s. 'Sherwood Purple' Masses of purple flowers in spring. 8" 12" April-May ☉ 4.5 4.95

☼ sun ☉ part shade ● shade ☉ new variety (H) height (S) spacing (TP) tender perennial N native

Genus Species/Variety	Common Name	(H)	(S)	Bloom	Loc.	Perennials	
						Size	Price
Phlox subulata Creeping Phlox							
Creeping evergreen plant with stiff needle like foliage. Forms a dense mat and works as an excellent groundcover. The small flowers are extremely showy in spring and early summer.							
s. 'Candy Stripes'	White and pink two-toned flowers.	6"	12"	April-May	☼	4.5	4.95
s. 'Emerald Blue'	Lavender-blue flowers.	6"	12"	April-May	☼	4.5	4.95
s. 'Emerald Pink'	Clear pink flowers.	6"	12"	April-May	☼	4.5	4.95
s. 'North Hills'	Bright white flowers with a violet purple eye.	6"	12"	April-May	☼	4.5	4.95
Physostegia Obedient Plant / False Dragonhead							
Trumpet like flower on sturdy stems. Ideal for borders and cut flowers.							
'Miss Manners'	(PP12637) Pure white snapdragon like flowers over deep green glossy foliage. Short non-spreading habit.	18"	15"	June-Sept	☼☉	4.5	5.95
virginiana 'Variegata'	White variegated leaves, pink flowers.	24"	18"	Aug-Sept	☼☉	4.5	5.95
v. 'Vivid'	Bright pink flower spikes.	20"	18"	Aug-Sept	☼☉	4.5	4.95
Platycodon Balloon Flower							
Balloon like flower buds open to a 2-3" saucer shaped flower. Well drained soil is important.							
grandiflorum 'Astra Pink'	Long lasting light pink flowers. Compact, uniform growing habit.	8"	12"	July-Aug	☼☉	4.5	5.95
☉ g. 'Astra White'	Puffy balloon-shaped buds open to white star shaped blooms. Shorter plant.	10"	12"	July-Aug	☼☉	4.5	5.95
g. 'Mariesii'	Large, bell shaped blue flowers.	16"	12"	July-Aug	☼	4.5	5.95
g. 'Sentimental Blue'	Large blue flowers on compact plant.	8"	12"	July-Aug	☼	4.5	5.95
Podophyllum Mayapple							
N peltatum	Native wildflower, single nodding white flower, hanging beneath deeply lobed foliage, followed by "apple" fruit.	18"	12"	April-June	●	4.5	5.95
Polemonium Jacob's Ladder							
Clusters of bell shaped flowers held above divided ladder like foliage.							
caeruleum 'Blue Pearl'	Bright blue flowers.	18"	15"	May-June	☼☉	4.5	4.95
N reptans	Blue flowers. Native plant.	12"	15"	May-June	☼☉	4.5	4.95
r. 'Stairway to Heaven'	(Variegated Jacob's Ladder) (PP15187) Large, vigorous selection with green and white leaves tinged with pink in the spring. Pale lavender blue flower.	18"	15"	May-June	☼☉	#1	9.95
yezoense 'Bressingham Purple'	(PP15367) Lilac blue flowers are stunning when set against the glossy deep purple foliage. Great plant for a moist, shady location.	18"	15"	May-June	☉●	4.5	6.95

☼ sun ☉ part shade ● shade ☉ new variety (H) height (S) spacing (TP) tender perennial N native

Genus Species/Variety	Common Name	(H)	(S)	Bloom	Loc.	Perennials	
						Size	Price
Polygonatum Solomon's Seal							
White flowers, tipped with green hang down in 4 to 6 clusters. Best in a naturalized area where they can be left alone. Prefers a moist organic, woodland type soil.							
N	biflorum (Solomon's Seal) White flowers.	24"	15"	May	●	4.5	5.95
N	commutatum (Giant Solomon's Seal) The graceful, arching stems of Solomon's Seal add an exotic touch to the shade garden. This species has tall stems of dangling white bell flowers in late spring, followed by a crop of blue-black berries in the fall.	36"	15"	May-June	●	#1	7.95
	falcatum 'Variegatum' Unbranched arching stems with beautiful creamy variegated foliage.	24"	15"	May-June	●	#1	9.95
	=== 2004 WNA / 2013 PPA Plant of the Year ===						
	humile (Miniature Solomon's Seal) Greenish white flowers under green foliage. Nice as a groundcover.	8"	15"	May-June	●	4.5	6.95
Potentilla Cinquefoil							
Prefers a sunny, dry location for best performance. Adapts to most soil types.							
	nepalensis 'Ron McBeath' Bright carmine-pink flowers contrast nicely with the dark green foliage. Good groundcover. Deer resistant.	12"	12"	May-June	☼☉	4.5	4.95
Primula Hardy Primrose							
Early season bloomer. Large, vibrant flowers over bright green foliage.							
	polyanthus SuperNova Mix Large flowers in an array of bright colors.	8"	15"	April-June	☉	#1	7.95
Pulmonaria Lungwort							
Excellent early blooming perennials. Although flowers are impressive, these plants are more valued for their attractive spotted foliage. A moist soil in a shady location is critical for best color. Deer resistant.							
	longifolia 'E.B. Anderson' Narrow spotted foliage with violet-blue flowers.	14"	15"	May-June	☉●	#1	9.95
	I. 'Roy Davidson' Long, narrow blue-green foliage with silver spots. Flowers start pink and turn powder blue.	12"	15"	May-June	☉●	#1	9.95
	'Majeste' Solid silvery-gray leaves with a very narrow green margin. In spring, light pink buds open to bluish pink flower bells.	12"	15"	May-June	☉●	#1	9.95
	'Raspberry Splash' (PP12138) Dazzling raspberry-pink flower clusters turn to purple as they age. Silver spotted leaves.	12"	15"	May-June	☉●	#1	9.95
	saccharata 'Mrs. Moon' Pink flowers fade to blue, silvery spotted foliage.	12"	15"	May-June	☉●	#1	9.95
Pulsatilla Pasque Flower							
Bell shaped flowers about 2-3" wide appearing in early spring. One of the first perennials to bloom. The flowers are followed by fern like leaves of silvery color.							
	vulgaris (Anemone pulsatilla) Lavender flowers.	8"	12"	April-May	☼☉	4.5	5.95
	v.'Alba' White flowers.	8"	12"	April-May	☼☉	4.5	5.95
	v.'Rubra' Wine-red flowers.	8"	12"	April-May	☼☉	4.5	5.95

☼ sun ☉ part shade ● shade ☉ new variety (H) height (S) spacing (TP) tender perennial N native

Genus Species/Variety	Common Name	(H)	(S)	Bloom	Loc.	Perennials	
						Size	Price
Ratibida Prairie Coneflower							
	columnifera (Mexican Hat Plant) The cylindrical brown center disk of each flower can be 2 inches long! Yellow and red ray petals with deeply cut leaves.	30"	18"	June-Sept	☼	4.5	4.95
N	pinnata (Gray Headed Coneflower) Large yellow flowers on striking plants. Drooping petals surrounding prominent cone-like centers add to its unique appearance. Native.	48"	18"	July-Sept	☼	4.5	4.95
Rudbeckia Gloriosa Daisy							
	fulgida 'Goldsturm' (Black Eyed Susan) True perennial form, yellow flowers with black center eye. === 1999 PPA Plant of the Year ===	30"	18"	July-Sept	☼	4.5 #1	4.95 7.95
	f. var. 'Deamii' Very similar to 'Goldsturm', but completely resistant to black spots on the leaves. Golden yellow flowers with dark centers.	24"	18"	July-Oct	☼	#1	7.95
	f. var. fulgida Shiny, deep green foliage. Flowers are smaller than 'Goldsturm', but the plant has a much longer flowering season.	24"	18"	July-Oct	☼	4.5 #1	4.95 7.95
	f. var. sullivantii 'Little Goldstar' (PP22397) More compact selection compared to 'Goldsturm'. Golden yellow flowers above the short, bushy clump of rich green foliage.	15"	18"	July-Oct	☼	4.5	6.95
	f. 'Viette's Little Suzy' (PP8867) Tons of features: Compact, upright, shorter height, excellent disease resistance and long-blooming yellow daisy-like flowers.	15"	18"	Aug-Sept	☼	#1	9.25
	<i>Rudbeckia hirta</i> varieties are biennials and need to re-seed themselves in the garden or landscape.						
N	hirta (Black Eyed Susan) Bright yellow flowers. Native.	24"	15"	July-Sept	☼	4.5	4.95
	h. 'Cherokee Sunset' A blend of sunset colors on semi-double 4" flowers. Excellent branching. Ideal cut flower.	30"	18"	July-Sept	☼	4.5	4.95
	h. 'Goldilocks' Compact form of hirta. Single golden yellow flowers with dark eye.	10"	15"	July-Sept	☼	4.5	4.95
	h. 'Indian Summer' Huge, semi-double and single golden-yellow flowers. Outstanding basal branching does not require staking.	36"	18"	July-Sept	☼	4.5	4.95
	h. 'Prairie Sun' Striking 5" light green eyed golden yellow flowers. Excellent in border, container or cutting garden.	36"	18"	July-Sept	☼	4.5	4.95
	h. 'Toto' Cute 2" single golden yellow flowers with dark eye. Shorter, compact habit ideal for pots or bedding.	10"	15"	July-Sept	☼	4.5	4.95
	maxima Tall plant. Foliage is powdery blue-green. Bright yellow flowers have a 3" cone.	60"	30"	July-Sept	☼	4.5	5.95
	nitida 'Herbstsonne' (Autumn Sun) Yellow rays with green disks. Tall plant for the back of the border.	72"	30"	Aug-Sept	☼	#1	7.95
	subtomentosa 'Henry Eilers' Strikingly unique fluted, tubular shaped petals surround a brown cone. Sweetly scented foliage.	54"	24"	Aug-Sept	☼	#1	9.25
	triloba 'Prairie Glow' Vibrant orange-red flowers with golden yellow tips surround a chocolate brown cone. Dark colored sturdy stems.	40"	24"	Aug-Sept	☼	#1	9.25
Rumex Garden Sorrel							
	sanguineus var. sanguineus (Bloody Sorrel) Distinct red-purple veins color the foliage. May self-seed.	15"	12"	Sept	☼☉	4.5	4.95

☼ sun ☉ part shade ● shade ☺ new variety (H) height (S) spacing (TP) tender perennial N native

Genus Species/Variety	Common Name	(H)	(S)	Bloom	Loc.	Perennials	
						Size	Price
Sagina	Irish Moss / Pearlwort						
Moss like evergreen foliage. Excellent for shaded areas or between stepping stones.							
subulata (Irish Moss)	Small white flowers.	3"	12"	June-July	☉	4.5	4.95
s. 'Aurea' (Scotch Moss)	Gold to chartreuse foliage.	3"	12"	June-July	☉	4.5	4.95
Salvia	Meadow Sage						
Very reliable and compact perennials. For full sun locations where few others will survive as they can withstand dry conditions. Spikes of long lasting flowers appear in early summer. Cutting off flower stems after the first bloom will encourage another bloom later in summer.							
nemorosa COLOR SPIRES 'Crystal Blue' (PP26344)	Unique light sky-blue flowers.	18"	15"	June-Aug	☼	#1	9.25
COLOR SPIRES 'Pink Dawn' (PP26343)	Cotton-candy pink blossoms on purplish stems. Long blooming.	18"	15"	June-Aug	☼	#1	9.25
nemorosa 'Caradonna'	Very upright habit that does not flop open. Dark purple flower stems set off the bright violet-blue flowers. Outstanding as a cut flower.	24"	15"	June-Aug	☼	4.5	6.25
n. 'Dwarf Blue Queen'	Short variety. Deep blue flowers.	12"	15"	June-July	☼	4.5	4.95
n. 'East Friesland' ('Ostfriesland')	Violet-purple flowers.	18"	15"	June-July	☼	4.5	6.25
n. 'Marcus' (PP13322)	Dark violet blue flowers on a short plant. The perfect size plant for containers.	10"	15"	June-Aug	☼	#1	9.25
n. 'May Night' ('Mainacht')	Dark violet-blue flowers.	24"	15"	May-June	☼	4.5	6.25
	==== 1997 PPA Perennial Plant of the Year ====					#1	9.25
n. 'Snow Hill' ('Schneehügel')	White flowers, gray-green foliage.	18"	15"	June-Aug	☼	4.5	6.25
n. 'Viola Klose'	Deep purple flowers.	18"	15"	June-July	☼	#1	9.25
n. 'Wesuwe'	Vibrant purple flowers.	18"	15"	May-July	☼	#1	9.25
'Sensation Deep Rose Improved' (PPAF)	Extremely floriferous; bright pink flowers on dark purple stems.	16"	15"	June-July	☼	#1	9.25
Sanguisorba	Burnet						
obtusa	Oblong shaped leaves, rose-pink bottlebrush-like flowers. Quite unique.	30"	24"	June-Aug	☼	#1	9.95
Saponaria	Soapwort						
ocymoides	Bright pink flowers over low growing foliage. Good as groundcover or rock garden plant.	8"	15"	May-June	☼☉	4.5	4.95
Saxifraga	Rockfoil						
Low growing, rock garden plants.							
caespitosa 'Purple Robe'	Carmine flowers.	4"	12"	May-July	☼☉	4.5	4.95
Scabiosa	Pincushion Plant						
columbaria 'Butterfly Blue'	Continuous lavender-blue flowers. Thrives in a wide range of soil conditions. Cut spent flowers to keep them blooming all season.	15"	15"	June-Aug	☼	4.5	4.95
	==== 2000 PPA Perennial Plant of the Year ====						

Schizachyrium (Little Bluestem) see *Grasses, Sedges, and Rush Section*

☼ sun ☉ part shade ● shade ☺ new variety (H) height (S) spacing (TP) tender perennial N native

Genus Species/Variety	Common Name	(H)	(S)	Bloom	Loc.	Perennials	
						Size	Price
Sedum	Stonecrop / Live Forever						
A large group of very tough perennials that can perform in any type of soil. All varieties can handle full sun and are resistant to most pests. Fleshy leaves sometimes have dramatic color changes later in the season.							
acre	Small green foliage tinted with red as the season cools. Yellow flowers. Good groundcover.	1"	15"	June	☼	2.5	1.95
'Autumn Fire'	Similar to <i>'Autumn Joy'</i> , but selected for its tighter growth habit, thicker foliage, and more brightly colored rosy flower heads.	24"	18"	Aug-Sept	☼	4.5 #1	4.95 7.95
'Autumn Joy'	(<i>'Herbstfreude'</i>) Upright sedum with rust-red flowers. Great winter interest.	24"	18"	Aug-Sept	☼	4.5 #1	4.95 7.95
'Bertram Anderson'	More upright hybrid of <i>cauticola</i> .	8"	15"	Aug-Sept	☼	4.5	4.95
cauticola	Deep pink flowers, blue-gray foliage.	5"	15"	Aug-Sept	☼	4.5	4.95
floriferum 'Weihenstephaner Gold'	Rich, dark green scalloped foliage with golden yellow flowers.	7"	15"	June	☼	2.5 4.5	1.95 4.95
☺ 'Frosted Fire'	Light green leaves with creamy yellow serrated edges. Bright rosy flowerheads.	15"	18"	Aug-Sept	☼	#1	9.25
k. var. 'ellacombeanum'	Yellow flowers, scalloped leaves.	10"	15"	June	☼	4.5	4.95
k. var. 'middendorffianum'	Yellow flowers, serrated foliage.	5"	15"	June	☼	4.5	4.95
k. 'Variegatum'	Orange-yellow flowers with creamy yellow variegated foliage.	7"	15"	June	☼	4.5	4.95
☺ 'Little Miss Sunshine'	(<i>PPAF</i>) Incredibly dark green, glossy foliage. Very tidy habit. Yellow flowers.	8"	15"	July-Aug	☼	#1	7.95
'Matrona'	Deep gray foliage with shiny red stems topped off with large pink flower heads. Very upright habit.	24"	18"	Aug-Sept	☼	#1	9.25
'Mr. Goodbud'	(<i>PP17671</i>) Large vibrant purple-pink flowers on purple-red stems. Strong stems resist flopping.	16"	18"	Aug-Sept	☼	#1	9.25
☺ 'Mystery Blues'	Blue-green seed-like leaves bundled tightly together. Use as groundcover, in rock garden or in containers.	4"	15"	July-Aug	☼	4.5	4.95
reflexum 'Blue Spruce'	Blue foliage with bright yellow flowers in summer. Great groundcover for a sunny spot.	6"	15"	July-Aug	☼	4.5	4.95
rupestre 'Angelina'	Amazing, brilliant golden leaves on trailing stems. Excellent for hanging baskets, containers and adding a bright spot to a border or rock garden.	6"	15"	July-Aug	☼☺	4.5	4.95
sarmentosum	Spreading groundcover for sunny locations or rock gardens. Bright yellow flowers.	2"	15"	May-June	☼	2.5	1.95
sieboldii	Unique pale blue-green foliage. Pink flowers. Interesting in the garden or containers.	6"	15"	June	☼	4.5	4.95
sieboldii 'Mediovariegatum'	Blue-green scalloped leaves with pink edges and a creamy white strip in the center.	6"	15"	June	☼	4.5	4.95
spectabile 'Neon'	Brilliant, rosy-magenta pink flowers. Upright habit, gold fall color.	24"	18"	Aug-Sept	☼	#1	7.95
spurium 'Dragon's Blood'	(<i>'Schorbuser Blut'</i>) Dark red flowers, green foliage. Outstanding groundcover.	4"	15"	July-Aug	☼	2.5 4.5	1.95 4.95
s. 'Fuldaglut'	(<i>'Fuldaglow'</i>) Red flowers, red foliage.	4"	15"	July-Aug	☼	4.5	4.95
s. 'Tricolor'	Red, green and white foliage, pinkish flowers.	4"	15"	July-Aug	☼	4.5	4.95
'Vera Jameson'	More compact form of Ruby Glow. Darker blue-green foliage.	8"	15"	July-Aug	☼	4.5	4.95
<i>SunSparkler Series</i>							
'Dazzleberry'	(<i>PP22457</i>) Smokey blue foliage covered with large clusters of raspberry colored flowers.	6"	15"	Aug-Sept	☼	4.5	4.95
'Fire Cracker'	(<i>PP26595</i>) Burgundy red foliage on this robust groundcover. Vibrant pink flowers.	6"	15"	Aug-Sept	☼	4.5	4.95
'Lime Zinger'	(<i>PP24632</i>) Succulent apple-green leaves edged in red. Soft pink flowers.	6"	15"	Aug-Sept	☼	4.5	4.95

☼ sun ☺ part shade ● shade ☺ new variety (H) height (S) spacing (TP) tender perennial N native

Genus Species/Variety	Common Name	(H)	(S)	Bloom	Loc.	Perennials	
						Size	Price
Sempervivum Hen & Chicks							
Rock garden, crevice plants. A nice plant for trough containers and living wreaths.							
'Braunii'	Medium green foliage.	3"	12"		☼	4.5	4.95
'Cobweb'	Pale green covered with fine silvery web-like hairs.	3"	12"		☼	4.5	4.95
'Pacific Blue Ice'	Icy blue-green leaves become flushed with rose hues in cooler weather. Unique cupped form.	3"	12"		☼	4.5	4.95
'Pilloseum'	Green foliage, flushed with red.	3"	12"		☼	4.5	4.95
'Red Beauty'	Large rosettes, red foliage.	3"	12"		☼	4.5	4.95
'Rocknoll Rosette'	Colorful! Medium sized rosettes of deep orange to wine red flushed with apple green at the base.	3"	12"		☼	4.5	4.95
'Ruby Heart'	Rosettes are sharply pointed, silvery blue, and flushed with rosy red at the base.	3"	12"		☼	4.5	4.95
'Twilight Blues'	Large olive green rosettes, shaded with lavender, purple tips.	3"	12"		☼	4.5	4.95
Sidalcea Miniature Hollyhock							
Long blooming perennials for a sunny location. Moist soil is the key to best results. Deadheading will promote a longer blooming season.							
'Elsie Heugh'	Soft shell pink flowers.	24"	18"	June-Aug	☼☉	#1	8.95
oregana 'Brilliant'	Vibrant deep rose flowers.	30"	18"	June-Aug	☼☉	#1	8.95
Silphium							
Native plants, good back of border plants.							
N	laciniatum (Compass Plant) A classic prairie plant. Deeply divided leaves often orient themselves in a north-south direction. Large plant with a healthy taproot.	96"	36"	Sept	☼	#1	8.95
N	perfoliatum (Cup Plant) Robust 6-8' native with square stems. Opposite leaves joined at the stem form cups which hold water for birds. Large yellow daisy-like flowers. Self seeds.	84"	36"	Aug-Sept	☼	#1	8.95
Sisyrinchium Blue Eyed Grass (...not really a grass)							
	angustifolium 'Lucerne' Thin iris-like clump forming foliage. Bright blue star-shaped flowers with yellow centers in summer. Likes average to moist soil. === 2013 WNA Plant of the Year ===	12"	12"	June-July	☼☉	4.5	5.95
Smilacina False Solomon Seal							
Leaves are broadly lance shaped. Flowers on terminal clusters.							
N	racemosa Woodland native plant. Creamy white flowers on arching stems. Green berries turning red follow the flowers in late summer or fall.	24"	15"	May-June	●	4.5	5.95

☼ sun ☉ part shade ● shade ☺ new variety (H) height (S) spacing (TP) tender perennial N native

Genus	Common Name	(H)	(S)	Bloom	Loc.	Perennials	
						Species/Variety	Size
Solidago	Goldenrod						
	Low maintenance, beautiful flat flowers and they do not cause hay fever! They just happen to bloom at the same time as ragweed, a common hay fever villain.						
	'Fireworks' A striking plant with a radiating golden flower form that really looks like fireworks.	36"	18"	Aug-Sept	☼	4.5	5.95
	==== 2003 WNA Plant of the Year ====						
	'Golden Baby' Compact, upright growth. Dense, small golden-yellow flowers.	24"	18"	June-Sept	☼	4.5	4.95
N	rigida (Stiff Goldenrod) Yellow-gold, relatively large, flat-topped flowers.	48"	18"	Aug-Sept	☼	4.5	5.95
N	speciosa (Showy Goldenrod) Showy golden yellow flowers atop stiff, narrow-leaved, reddish stems. Attractive to bees and butterflies.	36"	18"	Aug-Sept	☼	4.5	5.95
Sorghastrum (Indian Grass) see Grasses, Sedges, and Rush Section							
Sporobolus (Dropseed) see Grasses, Sedges, and Rush Section							
Stachys	Lamb's Ears						
	byzantina 'Helene von Stein' (Big Ears) Broad leaves, twice the size of other Lamb's Ears. Strong, clumping habit.	15"	15"		☼	4.5	5.95
	b. 'Silver Carpet' Non-flowering form of <i>byzantina</i> .	10"	15"		☼	4.5	5.95
	'Hummelo' Neat, compact clumps of glossy light green, textured foliage. Sturdy rose-lavender flower spikes. At least 6 weeks of bloom time.	18"	15"	June-July	☼	4.5	5.95
	===== 2011 WNA Plant of the Year =====						
	minima Extremely floriferous plant. Pink-purple flowers bloom on 4-6" spikes in summer. Forms a dense mound of dark, glossy green foliage.	6"	12"	June-July	☼	4.5	5.95
Stokesia	Stoke's Aster						
☺	laevis 'Elf' Late season periwinkle blue flowers on shorter plant. Attracts butterflies! Prefers well-drained soil.	8"	15"	July-Sept	☼	4.5	5.95
	I. 'Mary Gregory' Distinctive, unusual soft yellow flowers on this selection.	18"	15"	July-Sept	☼	4.5	5.95
Tanacetum	Painted Daisy						
☺	'Robinson Red' Crimson flowers. Fern-like foliage, flowers are excellent for cutting. Classic cottage garden flower.	24"	15"	June-July	☼☺	4.5	4.95
Thalictrum	Meadow Rue						
	aquilegifolium Graceful foliage resembles that of Columbine. Airy rose-colored flowers. This fine-textured plant mixes well with Hostas in a part sun area.	30"	18"	July-Aug	☼☺	4.5	4.95
Thermopsis	False Lupine						
	lanceolata Yellow pea-like blossoms on sturdy stems.	24"	24"	May-June	☼	4.5	4.95

☼ sun ☺ part shade ● shade ☺ new variety (H) height (S) spacing (TP) tender perennial N native

Genus Species/Variety	Common Name	(H)	(S)	Bloom	Loc.	Perennials	
						Size	Price

Thymus

Thyme

Popular as a groundcover or used between stepping stones. Durable plant that can handle some foot traffic.

citriflorus (Lemon Thyme) see Herb List

praecox (serpyllum) '**Coccineus**' (Red Creeping Thyme) 4" 15" June-July ☼ 4.5 5.95
Deep pink flowers.

p. 'Pink Chintz' Deep olive evergreen foliage showcases pretty salmon-pink flowers. 2" 15" June-July ☼ 4.5 5.95

p. 'Pseudolanuginosus' (Wooly Thyme) Gray foliage. 2" 15" June-July ☼ 4.5 5.95

Tiarella

Foam Flower

Tiarellas are very popular for their shade tolerance and early bloom season. Unusual leaf shapes and marked foliage make these plants a terrific underplanting for hostas in the shade garden or along shaded walkways.

'Brandywine' Glossy wrinkled leaves and excellent bronze fall and winter color. Light pink flowers on a robust clump forming plant. 8" 15" April-May ☉● #1 8.95

N cordifolia Native, white flowers. Works as groundcover. 15" 15" April-May ☉● 4.5 5.95

c. 'Oakleaf' A long blooming, clumping plant with light pink flowers. Bronze new spring growth. Burgundy winter color. 10" 15" April-May ☉● #1 8.95

c. 'Running Tapestry' A vigorous running ground cover with red speckled, deeply dissected foliage. Plenty of white flowers. 12" 15" April-May ☉● #1 8.95

'Elizabeth Oliver' A spreading runner with deeply lobed leaves with lots of red markings and light pink flowers. 8" 15" April-May ☉● #1 8.95

wherryi Pale pink flower. Does not spread like *cordifolia*. 15" 15" April-May ☉● 4.5 4.95

Tradescantia

Spiderwort

Long narrow leaves in a dense clump. Flowers are star shaped on branched stems. Flowers from late spring through late summer. After flowering, cut back for new growth and reblooming. Tolerant of wet, boggy sights.

AMETHYST KISS™ (PP24733) Large clusters of sizeable, periwinkle blue flowers accented with yellow tipped stamens. Very long blooming selection! 18" 15" June-Sept ☼☉ 4.5 5.95

'Concord Grape' Deep purple flowers. Long flowering season. Bluish green foliage. 18" 15" June-Aug ☼☉ 4.5 5.95

N ohioensis Native plant. Deep blue flowers. Not particular about soil conditions. 30" 15" June-Aug ☼☉ 4.5 5.95

'Sweet Kate' (Golden Spiderwort) Rich blue-purple flowers over slender chartreuse leaves. 15" 15" June-Aug ☼☉ 4.5 5.95

'Zwanenburg' Royal blue flowers. 18" 15" June-Aug ☼☉ 4.5 5.95

Tricyrtis

Toad Lily

Sharply pointed heart shaped leaves on tall stems. Flowers have a unique star shape. Fall blooming plants.

formosana 'Autumn Glow' Variegated leaves have wide yellow margins. Arching stems of orchid-like, reddish purple speckled flowers arrive late in the season. 24" 18" Sept-Oct ☉● #1 9.25

hirta 'Miyazaki Hybrids' Pale purple flowers with darker purple blotches. 20" 18" Sept-Oct ☉● 4.5 5.95

h. 'Moonlight' Chartreuse sport of *T. h. 'Variegata'*. Outstanding in the shade garden. 20" 18" Sept-Oct ☉● 4.5 6.25

☼ sun ☉ part shade ● shade ☉ new variety (H) height (S) spacing (TP) tender perennial N native

Genus	Common Name	(H)	(S)	Bloom	Loc.	Perennials		
						Species/Variety	Size	Price
Trillium								
Native woodland flowers, needing rich, moist soils. Beautiful spring display of flowers, then go dormant.								
N	grandiflorum (Great White Trillium)	Large white flowers.	12"	12"	April-June	●	4.5	5.95
Trollius Globe Flower								
Clump forming dark green deeply toothed foliage. Colors are vibrant, usually golden or yellow. Trollius do best in moist soil, great near ponds or in wetlands. All <i>Trollius</i> should be deadheaded regularly to ensure reblooming.								
	'Golden Queen'	Golden-yellow buttercup-like flowers produced prominently above dark green foliage.	30"	15"	May-June	☼☉	#1	9.95
Uvularia Merrybells / Bellwort								
Woodland plant with wiry stems, will take full sun if you mulch it.								
N	grandiflora	Spring blooming wildflower. Bell-shaped, yellow flowers.	12"	12"	May-June	☉●	4.5	5.95
Vernonia Ironweed								
Though native to moist meadows, Ironweed is tolerant of hot, dry conditions, once established. Cutting the stems back hard once in late spring will encourage branching and keep plants shorter and more compact.								
N	fasciculata	Deep lilac-colored flowers add late season interest to the landscape. Tough stems stand upright. Great for rain gardens or pond side.	60"	18"	Aug-Sept	☼	#1	9.95
	lettermannii 'Iron Butterfly'	Threadleaf foliage similar to <i>Amsonia hubrichtii</i> , this ironweed produces true purple flowers that attract plenty of butterflies.	30"	18"	Aug-Sept	☼	4.5	5.95
Veronica Speedwell								
A large group of perennials with different characteristics. Most varieties are very drought tolerant summer blooming perennials. Taller varieties are great for borders, shorter varieties for edging or groundcover.								
	'Blue Skywalker' (PPAF)	Upright dark green leaves. Lavender-blue flower spikes.	30"	15"	June-Aug	☼☉	#1	8.95
	'Giles van Hees'	Small veronica with clear pink flowers.	6"	15"	June-Aug	☼☉	4.5	4.95
	longifolia 'Eveline' (PP14888)	Tall spikes of red-violet flowers on nice upright plants.	20"	15"	June-Aug	☼☉	4.5	4.95
	peduncularis 'Georgia Blue'	Round intense blue flowers on low spreading bushy foliage.	6"	15"	June-Aug	☼☉	4.5	4.95
	'Perfectly Picasso' (PPAF)	White buds open to medium pink flowers, creating a bicolor effect.	24"	15"	June-Aug	☼☉	#1	8.95
	repens	Light blue to white flowers, very low ground cover.	2"	15"	April-May	☼☉	4.5	4.95
	'Royal Candles' (PP18432)	Masses of violet-blue spikes dart up above compact, upright, deep green foliage. Holds on to lower foliage better than other upright Veronicas.	18"	15"	June-Aug	☼☉	4.5	4.95
	spicata 'Red Fox' ('Rotfuchs')	Bright rose-red flower spikes, good landscape plant.	14"	15"	June-Aug	☼☉	#1	7.95
	'Waterperry Blue'	A low growing, long flowering groundcover. During the cooler months, the dark green foliage is blushed with burgundy and copper. Lavender-blue flowers with a white eye.	4"	15"	June-Aug	☼☉	4.5	4.95
	'Whitewater' (PP22783)	Glossy green leaves with pristine white flowers. Makes a great groundcover.	5"	15"	June-Aug	☼☉	4.5	4.95
	MAGIC SHOW 'White Wands' (PP27632)	Long blooming white flower spikes. Loved by pollinators and butterflies!	15"	15"	June-Aug	☼☉	#1	8.95

☼ sun ☉ part shade ● shade ☼☉ new variety (H) height (S) spacing (TP) tender perennial N native

Genus Species/Variety	Common Name	(H)	(S)	Bloom	Loc.	Perennials	
						Size	Price
Veronicastrum Culver's Root							
N virginicum	Upright plants with white spire-type flowers. Outstanding plant for rain gardens.	36"	15"	June-July	☼☉	4.5	4.95
v. 'Fascination'	Two-tone flowers - purple on the top; lilac pink on the bottom, dark green foliage.	40"	15"	June-July	☼☉	#1	9.25
Vinca Periwinkle / Myrtle							
Evergreen groundcover with dark green glossy foliage. Very pretty blue flowers in spring and early summer.							
minor 'Dart's Blue'	Slightly larger flower than straight species. Glossy dark green foliage.	8"	12"	April-May	☉●	2.5	1.95
m. 'Sterling Silver'	Variegated foliage with blue flowers.	8"	12"	April-May	☉●	2.5	1.95
Viola							
Violets prefer partial shade locations. Can be used as woodland groundcover.							
labradorica	Reddish green foliage with porcelain-blue flowers. Self seeds easily.	6"	15"	May	☉	4.5	4.95
Waldsteinia Barren Strawberry							
Versatile plant. Can be grown anywhere in any type of soil.							
ternata	Yellow flowers, good tough ground cover.	8"	15"	May-June	☼☉	2.5	1.95
Zizia Golden Alexander							
N aptera	Butterflies love this plant! Heart-shaped, bright green leaves with tiny yellow blooms.	20"	18"	May-June	☼☉	4.5	5.95

☼ sun ☉ part shade ● shade ☺ new variety (H) height (S) spacing (TP) tender perennial N native
51

Genus
Species/Variety

Common Name

Grasses, Sedges, and Rush

(H) (S) Bloom Loc. Size Price

Grasses, Sedges, and Rush

Native grasses provide the perfect complement to dry, prairie-like settings. Hybridized grasses work beautifully in landscaping and gardens. Foliage color ranges from green to variegated to blood red. From stunning vertical accents to low pin cushion-like varieties, these grasses have become the newest landscape rage. Generally, most prefer sun. Good drainage is essential for most varieties.

Andropogon

Big Bluestem

N **gerardii** Prairie grass, tall enough for background, edge of the woods or windbreak. Panicles good for dried arrangements. Z3 72" 24" Aug-Oct ☼ #1 9.95

Bouteloua

Sideoats

N **curtipendula (Sideoats grama)** Very attractive flower stalk with small oat-like seeds suspended on one side of a 2-3' stem. Excellent for dry soils. Z3 24" 18" Aug-Oct ☼ #1 9.95

Calamagrostis

Feather Reed Grass

Beautiful in breezy locations, good fall and winter color.

acutiflora 'Avalanche' Deep green leaves with a wide white stripe down the center. Distinctly upright. Z4 48" 24" June-July ☼ #1 9.95

a. 'Karl Foerster' A clumping grass with compact, erect growth habit. Wheat-like seed heads appear in early summer and last all season. Z4 60" 24" June-July ☼ #1 9.95

=== 2001 PPA Perennial Plant of the Year ===

a. 'Overdam' (Variegated Feather Reed Grass) Variegated foliage has bright creamy white margins. Clump-forming and very erect grass. Z4 60" 24" June-July ☼ #1 9.95

brachytricha (Korean Reed Grass) Shorter, fall blooming reed grass. Fine textured rosy plumes look great all fall. Z4 36" 24" Sept-Oct ☼ #1 9.95

Carex

Sedge

elata 'Bowles Golden' (Gold Sedge) Bright gold foliage with narrow green margins. Spectacular with blue or gold edged Hosta. Moisture loving. Z5 24" 24" ☼● #1 9.95

morrowii 'Ice Dance' Vigorous grower with strong, shiny foliage and bright variegation. Effective groundcover. Drought tolerant once established. Z5 15" 18" ☼● #1 9.95

morrowii 'Silver Sceptre' A fine textured sedge with narrow leaves with white margins. Forms thick silvery clumps to brighten up the shade garden. Z5 12" 18" ☼● #1 9.95

pensylvanica Slender, upright sedge. Spreads slowly by rhizomes, often creating an almost lawn-like cover. Tolerates dry shade. Z4 8" 15" ☼● 4.5 5.95

☼ sun ☼ part shade ● shade ☼ new variety (H) height (S) spacing (TP) tender perennial N native

Genus Species/Variety	Common Name	Grasses, Sedges, and Rush						
		(H)	(S)	Bloom	Loc.	Size	Price	
Chasmanthium Northern Sea Oats								
N latifolium	Attractive oat-like seed heads from late summer through winter. Deep gold fall color.	Z3	36"	24"	Sept-Oct	☼☉	#1	9.95
Deschampsia Tufted Hair Grass								
cespitosa	'Pixie Fountain' Dense clumps of slender, silver-green foliage. Golden-brown flower spikes work well for cutting.	Z4	24"	18"	July	☼☉	#1	9.95
c.	'Schottland' Pin cushion shape, clump-forming, silver panicles turning tan in July, will take some shade.	Z4	24"	18"	July	☼☉	#1	9.95
Festuca Fescue								
g.	'Elijah Blue' One of the nicest blues. Color holds up all summer. Remove flowers to prevent seeding.	Z4	10"	15"		☼	#1	9.95
Hakonechloa Hakone Grass / Japanese Forest Grass								
macra	'All Gold' Brilliant solid gold foliage glows in the shade. Slightly upright habit.	Z5	18"	24"		☉●	#1	11.95
macra	'Aureola' Bright yellow-green variegated foliage. Does best in partial shade.	Z5	18"	24"		☉	#1	11.95
Imperata Japanese Blood Grass								
cylindrical	'Red Baron' Beautiful reddish foliage. Not invasive in this part of the country.	Z5	16"	12"		☼☉	#1	7.95
Juncus Soft Rush								
N effusus	A native grass for pond edges, bog gardens, moist to wet soils. Vase-shaped habit, clump forming. Great vertical accent plant.	Z2	30"	24"		☼☉	#1	9.95

☼ sun ☉ part shade ● shade ☉ new variety (H) height (S) spacing (TP) tender perennial N native

Genus Species/Variety	Common Name	Grasses, Sedges, and Rush						
		(H)	(S)	Bloom	Loc.	Size	Price	
Miscanthus Maidengrass / Eulalia								
sinensis 'Ferner Osten'	A very distinct selection. Blooms open deep red, turn to silver. Slightly wider leaves than 'Gracillimus'.	Z5	48"	24"	Aug-Sept	☼	#1	9.95
s. 'Gracillimus'	Feathery, fan-shaped pale pink panicles. Thin, stiff foliage.	Z4	72"	24"	Sept-Oct	☼	#1	9.95
s. 'Graziella'	Similar to 'Gracillimus' but blooms in August. Nice bronze-red fall color. Slender foliage.	Z4	72"	24"	Aug	☼	#1	9.95
s. 'Little Nicky'	(aka 'Hinjo') Shorter zebra grass. Horizontal yellow bands on foliage with silvery white plumes.	Z5	24"	24"	Sept-Oct	☼	#1	9.95
s. 'Morning Light'	Variegated 'Gracillimus'.	Z5	48"	24"	Sept-Oct	☼	#1	9.95
s. 'Oktoberfest'	(PP27074) Forms a narrow, upright tower of wide, deep green leaves that develop deep purple and red highlights later in the season. Shimmery flowers start burgundy and turn to tan.	Z5	72"	24"	Sept-Oct	☼	#1	9.95
s. var. 'purpurascens'	(Flame Grass) Red to purple fall color. Silvery flower plumes.	Z4	60"	24"	Sept-Oct	☼	#1	9.95
s. 'Silver Feather'	('Silberfeder') Earlier blooming than species. Outstanding silver plumes.	Z4	96"	24"	Aug-Sept	☼	#1	9.95
s. 'Strictus'	Horizontal yellow bar variegation.	Z5	84"	24"	Sept-Oct	☼	#1	9.95
s. 'Variegatus'	Longitudinal stripes on green leaves.	Z5	72"	24"	Sept-Oct	☼	#1	9.95
Molinia Tall Moor Grass								
arundinacea 'Skyracer'	Stems are long and thin. Forms a transparent screen for structure in the garden. Fall foliage and flowers are yellow, turning gold when mature.	Z5	84"	24"	July	☼	#1	9.95
caerulea 'Moorflamme'	Graceful, upright slightly arching, open flowering stems change to soft butter yellow in fall.	Z4	48"	24"	Sept-Oct	☼	#1	9.95
c. 'Moorhexe'	Distinguished upright growth habit, allowing the slightest view through the narrow black-brown flower spikes.	Z4	36"	24"	July-Sept	☼	#1	9.95
Panicum Switch Grass								
virgatum 'Apache Rose'	(PPAF) Dense, upright, columnar habit with grey-green foliage. Rose-colored flower panicles.	Z4	48"	24"	Aug	☼	#1	9.95
v. 'Heavy Metal'	Bright, metallic blue foliage. Pink flowers above the foliage. Yellow and red fall highlights.	Z4	60"	24"	Aug	☼	#1	9.95
v. 'Northwind'	Stiff, upright blue-green foliage. == 2006 WNA / 2014 PPA Plant of the Year ==	Z4	72"	24"	Sept	☼	#1	9.95
v. 'Rotstrahlbusch'	Outstanding red fall color.	Z4	48"	24"	Sept	☼	#1	9.95
v. 'Shenandoah'	The bright red foliage appears in June. Red flowers emerge later in summer. One of the shorter varieties available.	Z4	36"	24"	Sept	☼	#1	9.95

☼ sun ☉ part shade ● shade ☺ new variety (H) height (S) spacing (TP) tender perennial N native

Genus Species/Variety	Common Name	Grasses, Sedges, and Rush						
		(H)	(S)	Bloom	Loc.	Size	Price	
Pennisetum Fountain Grass								
alopecuroides	Rose-copper, bristly flower heads.	Z5	36"	24"	Aug	☼	#1	9.95
a. 'Burgundy Bunny' (PP21917)	Rounded clump of green foliage starts to turn red in summer. All-over blazing red fall color until frost.	Z5	15"	18"	July	☼	#1	9.95
a. 'Hameln' (Dwarf Fountain Grass)	Fine textured foliage; earlier flowers.	Z5	24"	24"	July	☼	#1	9.95
a. 'Little Bunny' (Miniature Fountain Grass)	Smallest of the dwarf fountain grasses. Excellent for rock gardens.	Z5	12"	18"	July	☼	#1	9.95
a. 'Red Head'	Deep purple buds mature to smoky purple plumes that measure 3" wide and 8" long. The green foliage turns gold in the fall.	Z5	48"	24"	July	☼	#1	9.95
Schizachyrium Little Bluestem								
N scoparium	Good ground cover for naturalized areas, bluish-green to light purplish-colored foliage.	Z3	36"	18"	Aug-Sept	☼	#1	9.95
s. 'Prairie Blues'	Brighter grey-blue foliage and red-orange fall color. Narrow, upright habit.	Z3	36"	18"	Aug-Sept	☼	#1	9.95
☺ s. 'Smoke Signal' (PP27433)	This refined version takes on scarlet red tones in late summer, turning deeper red-purple in fall. Very upright habit.	Z3	36"	18"	Aug-Sept	☼	#1	9.95
s. 'The Blues'	True deep blue foliage and exceptional burgundy red fall color. Tolerates heat and humidity.	Z4	36"	18"	Aug-Sept	☼	#1	9.95
Sesleria Autumn Moor Grass								
autumnalis (Autumn Moor Grass)	Narrow, bright green leaves will form a clump producing silvery seed heads. Very drought tolerant once established, but needs ample water to get going.	Z4	15"	24"	Sept-Oct	☼	#1	9.95
Sorghastrum Indian Grass								
N nutans	Native warm season grass for average to dry meadows. Golden brown seed heads.	Z3	72"	24"	Sept-Oct	☼	#1	9.95
Sporobolus Dropseed								
N heterolepis (Prairie Dropseed)	Ground cover that grows well in hot dry areas, provides bird feed and wildlife protection. === 2018 WNLA Plant of the Year ===	Z3	36"	18"	Aug-Sept	☼	#1	9.95
h. 'Tara'	Fine textured, vase shaped habit is much more upright than the species.	Z3	24"	18"	Aug-Sept	☼	#1	9.95

☼ sun ☺ part shade ● shade ☺ new variety (H) height (S) spacing (TP) tender perennial N native

Common Name Genus / Species / Variety	Description	Plant Type	Size	Herbs Price
------------------------------------------	-------------	------------	------	----------------

Herbs

The popularity of herbs continues, undoubtedly due to the onslaught of cooking and gardening television programs utilizing them in numerous ways. Herbs are used for culinary, medicinal, and ornamental purposes. The majority of the herbs we grow are for cooking, yet we offer some that are useful in decorating the home and garden. There are other "herbs" listed under our general perennial line.

(A)=Annual (B)=Biennial (P)=Perennial (TP)=Tender Perennial

Basil, Purple Ruffles <i>O. b. 'Purple Ruffles'</i>	Dark purple serrated and crinkled leaves. Excellent in vinegar and as a garnish. Nice ornamental herb, too.	A	3.5	2.95
Basil, Sweet <i>O. basilicum</i>	Clove-like flavor for Italian foods such as tomato-based dishes, pasta sauces, and pesto.	A	3.5	2.95
Basil, Sweet Genovese <i>O. b. 'Genovese'</i>	Large, dark green, thick leaves of strong scented, spicy basil flavor. Very popular in gourmet cooking.	A	3.5	2.95
Basil, Thai (Siam Queen) <i>O. b. 'Siam Queen'</i>	Outstanding culinary and ornamental plant. Green leaves on thick purple stems, mounding habit.	A	3.5	2.95
Bay, Sweet <i>Laurus nobilis</i>	The broadleaf evergreen foliage is aromatic. Used to flavor soups and stews. Use within a few days of drying for best flavor.	TP	#1	14.95
Burnet, Salad <i>Sanguisorba officinalis</i>	Its evergreen foliage may be cut for salads all winter long. Has cucumber flavor. Use in salads and drinks.	P	3.5	2.95
Caraway <i>Carum carvi</i>	Use seeds in cakes, rolls, puddings, cookies, boiled potatoes, spaghetti sauce, and applesauce. Young leaves can be used in salads and herb butter.	B	3.5	2.95
Catnip <i>Nepeta cataria</i>	Use young leaves in salads or tea. Add leaves to stews or rub meat with it before roasting. / Cats love it!	P	3.5	2.95
Chamomile, Roman <i>Chamaemilum nobile</i>	Dried flowers used for tea and aid for digestion. Flowers and foliage have an apple-like scent.	P	3.5	2.95
Chervil, Curled <i>Anthriscus cerefolium</i>	Rich in vitamin C, beta carotene, iron, and magnesium. Use leaves in salads, vegetables, sauces, vinegars, and butters.	A	3.5	2.95
Chives <i>Allium schoenoprasum</i>	Chopped leaves used as seasoning in soups, salads and sauces. Leaves stimulate appetite and improve digestion.	P	3.5	2.95
Chives, Garlic <i>Allium tuberosum</i>	Leaves are used to give a mild garlic flavor. Has flat solid leaves with 2 inch heads of white flowers.	P	3.5	2.95
Cilantro (Coriander) <i>Coriandrum sativum</i>	Use fresh leaves in salsa, marinades, and salads. Whole or ground seeds can be added to beans, baked goods, eggs, cheeses, and sausages.	A	3.5	2.95
Dill, Fernleaf	Outstanding dill flavor. Dark green, finely cut foliage. (18") Use fresh leaves or seeds in soups, salads, vinegars, pickles, and herb-seasoning blends.	A	3.5	2.95
Dill, Mammoth	Excellent with fish, vegetables, and pickling. (30") Add fresh leaves to soups and salads.	A	3.5	2.95
Egyptian Onion <i>Allium cepa 'Proliferum'</i>	Use as you would a regular garden onion. Produces small onions on tips of leaves.	P	3.5	2.95

Common Name Genus / Species / Variety	Description	Plant Type	Size	Herbs Price
Fennel, Smokey-Bronze <i>Foeniculum vulgare 'Dulce'</i>	Same as sweet fennel, only foliage is a smokey-bronze color.	A	3.5	2.95
Fennel, Sweet <i>Foeniculum vulgare</i>	Use leaves in salads, rice, vegetables, butters and vinegars. Add seeds to sausages, duck, and breads.	A	3.5	2.95
Hyssop <i>Hyssopus officinalis</i>	The pungent flavor of the leaves can be used in stews, salads, with tomatoes, or with poultry. Nice as a short hedge edging a border.	P	3.5	2.95
Lavender, English <i>Lavandula vera munstead</i>	Use in sachets, perfumes, potpourri and flower arrangements. Harvest flowers just as they open.	P	3.5	2.95
Leek <i>Allium porrum</i>	Produces a sheaf of leaves rather than a bulb. Mild and tender when blanched.	P	3.5	2.95
Lemon Balm <i>Melissa officinalis</i>	Use for flavoring cold drinks, salads, fruit cups and teas. Use dried in potpourri.	P	3.5	2.95
Lemon Grass <i>Cymbopogon citratus</i>	Dense clumps grown for aromatic lemon oil. Also used in Asian cooking and stir fry.	TP	3.5	2.95
Lemon Verbena <i>Aloysia triphylla</i>	Use leaves in sauces, teas, drinks, and desserts. Chop leaves finely, since they are tough.	TP	3.5	2.95
Lovage <i>Levisticum officinale</i>	Leaves and stalks have a very strong celery flavor. Use in salads, soups, stews, stuffings, or tomato juice.	P	3.5	2.95
Marjoram <i>Origanum majorana</i>	Sweet flowers in purple spikes to flavor meats, eggs and sausages. Try marjoram as a substitute if flavor of oregano is too strong.	TP	3.5	2.95
Mint, Applemint <i>Mentha sauveolens</i>	Used in drinks and jellies. Adds an interesting flavor. Can tolerate drier sites than other mints.	P	3.5	2.95
Mint, Chocolate <i>M. piperita 'Chocolate'</i>	'Peppermint Patty' scent; plants may grow to 2'.	P	3.5	2.95
Mint, Mojito <i>M. x villosa</i>	Bright green leaves used to flavor summer drinks.	P	3.5	2.95
Mint, Orange <i>M. citrata 'Orange'</i>	A good orange scent, used to flavor orange jelly. Dries well and can be used instead of lavender.	P	3.5	2.95
Mint, Peppermint <i>M. piperita</i>	Aggressive grower; characteristic peppermint scent and flavor.	P	3.5	2.95
Mint, Pineapple <i>M. suaveolens variegata</i>	Attractive green and cream variegated mint with a pineapple scent and mild apple mint flavor.	P	3.5	2.95
Mint, Spearmint <i>M. spicata</i>	Used for flavoring sauces, juleps, and meat dishes. Bold spearmint flavor.	P	3.5	2.95
Oregano <i>Origanum vulgare</i>	Use leaves in salads, tomato sauces, stewed beef, soups, vinegars, and butters.	P	3.5	2.95
Oregano, Golden <i>O. vulgare aureum</i>	Lovely mound of golden foliage. Used the same as Oregano.	P	3.5	2.95
Oregano, Greek <i>O. heracleoticum</i>	It has a strong, earthy aroma and is most flavorful.	TP	3.5	2.95

Common Name Genus / Species / Variety	Description	Plant Type	Size	Herbs Price
Oregano, Italian <i>O. onites</i>	It has a light, warm flavor and is the preferred Oregano for Italian foods.	TP	3.5	2.95
Parsley, Curled <i>Petroselinum crispum</i>	Dark green, triple curled and handsome. Use leaves with sandwiches, meats, and butters. Freshens breath.	B	3.5	2.95
Parsley, Italian <i>Petroselinum crispum</i>	Dark green plain leaf: the gourmet's favorite. Used in salads and as a garnish in soups and meat dishes. The plain leaf forms have a better flavor.	B	3.5	2.95
Rosemary <i>Rosmarinus officinalis</i>	Excellent with lamb or pork. Used in tea, eggs, soup and vegetables. Dry to use in potpourri.	TP	3.5	2.95
Rosemary, Cascading <i>R. officinalis 'Prostrata'</i>	Cascading, dwarf form of Rosemary.	TP	3.5	2.95
Rue – Herb of Grace <i>Ruta graveolens</i>	Blue-green foliage. Unique leaves make it a nice ornamental herb.	P	3.5	2.95
Sage, Berggarten <i>Salvia o. 'Berggarten'</i>	Gray-green fragrant foliage used in stuffings, soups and meat dishes.	P	3.5	2.95
Sage, Common <i>Salvia officinalis</i>	Use leaves with breads, pork, sausage, stuffings, butters, and vinegars.	P	3.5	2.95
Sage, Golden <i>S. o. icterina-aurea</i>	Compact grower with gold and green variegated foliage. Nice addition to the flower border.	TP	3.5	2.95
Sage, Pineapple <i>S. elegans</i>	Fresh sprigs serve as a fragrant garnish on a fruit platter. Bright red flowers.	TP	3.5	2.95
Sage, Purple <i>S. o. purpurascens</i>	Compact grower with reddish-purple foliage.	TP	3.5	2.95
Sage, Tricolor <i>S. o. 'Tricolor'</i>	Colorful purple, white and green foliage. Attractive in garden as an ornamental or in containers.	TP	3.5	2.95
Savory, Summer <i>Satureja hortensis</i>	Sweeter flavor than Winter Savory. Use in soups, beans, sausages, teas, butters, and jellies.	A	3.5	2.95
Sweetgrass <i>Hierochloe ordorata</i>	Fast spreading, sweet smelling, native grass used by a number of Indian tribes in ceremonies as perfume or burned as incense. Useful for wetlands, bog gardens, and shoreline plantings.	P	4.5	4.95
Tarragon, French <i>Artemesia dracuncululus</i> 'Sativa'	Strong licorice flavor. Use leaves in salads, sauces, soups, butters, vegetables, and pickles. Rich in vitamins A and C.	P	3.5	2.95
Thyme, English <i>Thymus vulgaris</i>	Widely used as seasoning in soups, stews, meats and stuffing. Dried leaves and flowers can be used in potpourri or insect repelling sachets.	P	3.5	2.95
Thyme, Golden Lemon <i>Thymus c. 'Aureus'</i>	Lemon scented green leaves dappled in gold. Nice accent plant for the herb garden.	P	3.5	2.95
Thyme, Lemon <i>Thymus citriodorus</i>	Lemon scented thyme. Dry leaves to use in potpourri or insect repelling sachets.	P	3.5	2.95
Thyme, Silver Edge <i>Thymus vulgaris 'Argenteus'</i>	Variegated foliage. Thyme is known as the "blending" herb in cooking, because it pulls flavors together.	P	3.5	2.95

Common Name Genus / Species / Variety	Description	Plant Type	Size	Vines Price
------------------------------------------	-------------	------------	------	----------------

Vines

Campsis

Trumpet Vine

N radicans	Vigorous, twining vine. Orange tubular flowers bloom in mid-summer. Attracts hummingbirds.	144"+	24"	July-Aug	☼☉	#1	11.95
--------------------------	--------------------------------------------------------------------------------------------	-------	-----	----------	----	----	-------

Clematis see Perennial List

Humulus

Hops

lupulus 'Aureus' (Golden Hops)	Twining vine with chartreuse leaves. Pale green, papery overlapping bracts cover cone-like fruiting structures. Zone 5.	144"+	24"	July-Aug	☼	#1	11.95
---------------------------------------	-------------------------------------------------------------------------------------------------------------------------	-------	-----	----------	---	----	-------

Hydrangea

Climbing Hydrangea

anomala petiolaris	Climbing Hydrangea offers beautiful and fragrant white flowers in early summer. Rich, green foliage and striking exfoliating bark. Does best in moist soil and some shade. May be somewhat slow to establish, but worth the effort.	144"+	72"	June-July	☉●	#1 #3	14.95 24.95
---------------------------	-------------------------------------------------------------------------------------------------------------------------------------------------------------------------------------------------------------------------------------	-------	-----	-----------	----	----------	----------------

Parthenocissus

Ivy

quinquefolia 'Engelmannii' (Engelman Ivy)	Vigorous, trouble-free vine for use as a climber or groundcover.	120"+	24"		☼☉	#1	14.95
tricuspidata (Boston Ivy)	Will climb almost anything. Does not harm masonry walls. Great red fall color.	120"+	24"		☼☉	#1	14.95

Specialty Annuals

While perennials is our thing, Shady Acres also carries a selection of specialty annual plants. Annuals can add color and interesting foliage to garden spots, hanging baskets or containers.

<i>Ageratum</i>	<i>Impatiens, New Guinea</i>
<i>Alternanthera</i>	<i>Ipomoea batatas – Sweet Potato Vine</i>
<i>Angelonia</i>	<i>Lantana</i>
<i>Argyranthemum – Marguerite Daisy</i>	<i>Laurentia</i>
<i>Bacopa</i>	<i>Lobelia</i>
<i>Begonia</i>	<i>Morning Glory</i>
<i>Bidens</i>	<i>Nasturtium</i>
<i>Bracteantha – Strawflower</i>	<i>Nemesia</i>
<i>Calibrachoa- Million Bells</i>	<i>Nicotiana sylvestris</i>
<i>Castor Bean</i>	<i>Osteospermum – Cape Daisy</i>
<i>Celosia – Cockscomb</i>	<i>Pansy</i>
<i>Coleus</i>	<i>Pentas</i>
<i>Datura – Angel's Trumpet</i>	<i>Petunia</i>
<i>Diascia – Twinspur</i>	<i>Rudbeckia</i>
<i>Dichondra</i>	<i>Salvia</i>
<i>Euphorbia</i>	<i>Scaevola – Fan Flower</i>
<i>Fuchsia</i>	<i>Swiss Chard 'Bright Lights'</i>
<i>Gazania</i>	<i>Thunbergia – Black-eyed Susan Vine</i>
<i>Gerbera</i>	<i>Tomato (Various types)</i>
<i>Geraniums</i>	<i>Torenia</i>
<i>Gomphrena</i>	<i>Tulbagia – Society Garlic</i>
<i>Grass: Carex – 'Toffee Twist'</i>	<i>Verbena</i>
<i>Grass: Juncus – Corkscrew Grass</i>	<i>Vinca vine</i>
<i>Grass: Millet</i>	<i>Viola</i>
<i>Grass: Pennisetum rubrum</i>	<i>...and more!</i>
<i>Grass: Pennisetum r. 'Fireworks'</i>	
<i>Heliotrope</i>	

2018
Shady Acres Perennial Nursery
Top 10 List

Shady Acres has been in business for 60 years! Each year since 2002, our garden center staff has created a "favorites" list. This year our selections include tranquil classics and vibrant newer varieties. We hope these perennials will uplift your spirit and bring you joy. Happy gardening!

~ Shelly, Robin, Bev, Susan, Jeanette, Lori, Jeanne and Gail

Amsonia 'Blue Ice' Blue star flowers in spring and summer. Foliage starts green, turning to gold in fall, providing multi season interest. Plant near front of the garden with a dark-leaved Heuchera for contrast.

Artemesia 'Silvermound' This is a foliage plant – silvery, soft and aromatic. Create a monochromatic look by planting with white perennials. A true classic...we've been growing this plant since the 1980's.

Aster novae-angliae (New England Aster) Native plant, great for prairie areas mixed with coneflowers and grasses. Blooms will attract pollinators from late summer well into fall.

Brunnera m. 'Looking Glass' A sea of tiny blue flowers float above silvery leaves in spring. Looks very cheery with blooming daffodil bulbs. Over summer, the heart-shaped leaves on this perennial grow larger. Definitely brightens a shady area.

Buddleia d. 'Black Knight' (Butterfly Bush) Plant in full sun, and in soil that has excellent drainage. Butterflies and hummingbirds adore the fragrant, rich purple flowers! These plants get large. If your space is smaller, try Buddleia 'Midnight' – from the BUZZ series.

Centaurea m. 'Amethyst in Snow' Silvery-green leaves hold fringed white flowers with purple centers. Perfect for an informal, cottage garden style. Mix with Shasta daisies, garden phlox, lavender and peonies...you will have plenty of flowers for cutting.

Hosta 'Fire & Ice' Shady areas will glow with this striking hosta! Leaves have pure white centers surrounded by very deep green margins. Coordinates well planted with spotted-leaved Pulmonaria and bright blooming Monarda.

Japanese Painted Fern Provides lovely textural interest for shade to part shade gardens. Let the artistry of the tri-colored silver, green and red foliage shine when planted near simple blue hostas.

Monarda 'Purple Rooster' (Bee Balm) A taller variety with clean, sweetly scented leaves. Royal purple flowers benefit pollinators all summer. Creates a colorful display planted with Helenium and Salvia.

Platycodon g. 'Mariesii' (Balloon Flower) Slow to emerge in spring, but worth the wait. Balloon buds open to large blue-violet saucer shaped flowers. Deadheading will provide a near continuous bloom!

Shady Acres Perennial Planting Instructions

Due to the differing nature of soil conditions, moisture, and exposure in our area, the following planting instructions are suggestions for successful perennial establishment.

1. **Soil Preparation:** Prepare the soil by mixing 2-3" of compost with the existing soil in the area to be planted. At Shady Acres, mushroom compost and cotton burr compost are available for purchase.
2. **Planting:** Dig the hole twice the size of the pot but no deeper. Carefully remove the plant from the pot. Place the plant into the hole making sure it is at the same depth that it was in the pot. Backfill with the prepared soil. Firmly press the soil around the root ball leveling off the soil around the plant.
3. **Water:** Following planting, water the plants thoroughly. Be sure the root area of each plant receives ample water. (A root stimulator may be applied. Follow directions on product label.) As the plants become established, water as needed. Weather will determine how often to water. Warm, windy days may require daily watering, while under other conditions water may not be necessary for two days or longer. Check to see if plants need water by sticking a finger into the surrounding soil. If the top 1-2" of soil is dry, watering is recommended.
4. **Mulch:** Apply 1-2" of mulch to the newly planted garden. Keep the mulch away from the crown of the plant to reduce the risk of rot. Cocoa bean shells, pine needles, or a light layer of compost can be used as mulch and are available at Shady Acres.

We hope that this information helps in your gardening experience.

Garden Shop

Make a stop in the Shady Acres garden shop. You will find gardening essentials like comfortable gloves, sturdy tools, plant supports, and zinc plant labels. Fertilizers, ready-to-use plant care products, and informative reference books are also available.

Trendy garden décor is displayed in our garden shop as well as throughout our display gardens. Browse around, and you are sure to find a treasure for yourself or as a gift for a gardening friend.

Mulches and Soil Amendments

Cocoa Bean Shells	2 cu. ft. bag	4.95
Cocoa Bean/Rice Hull Mix	2 cu. ft. bag	7.95
Pine Needle Mulch	2 cu. ft. bale	11.95
Mushroom Compost	1 cu. ft. bag	5.95
Cotton Burr Compost	2 cu. ft. bag	11.95
Jolly Gardener C/B Potting Mix	2.8 cu. ft. bag	21.95

Mulch Coverage... Generally, mulch coverage is dependent upon soil type and the type of mulch. When applying mulch around plants, keep the mulch away from the crown (base) of the plant to decrease the incidence of rot. Cocoa bean mulch can be applied to a depth of 1", while pine needles can be spread up to 4" deep.

Depth of mulch	1 cu. ft. will cover
1"	12 ft ²
1½"	9 ft ²
2"	6 ft ²
3"	4 ft ²
4"	3 ft ²

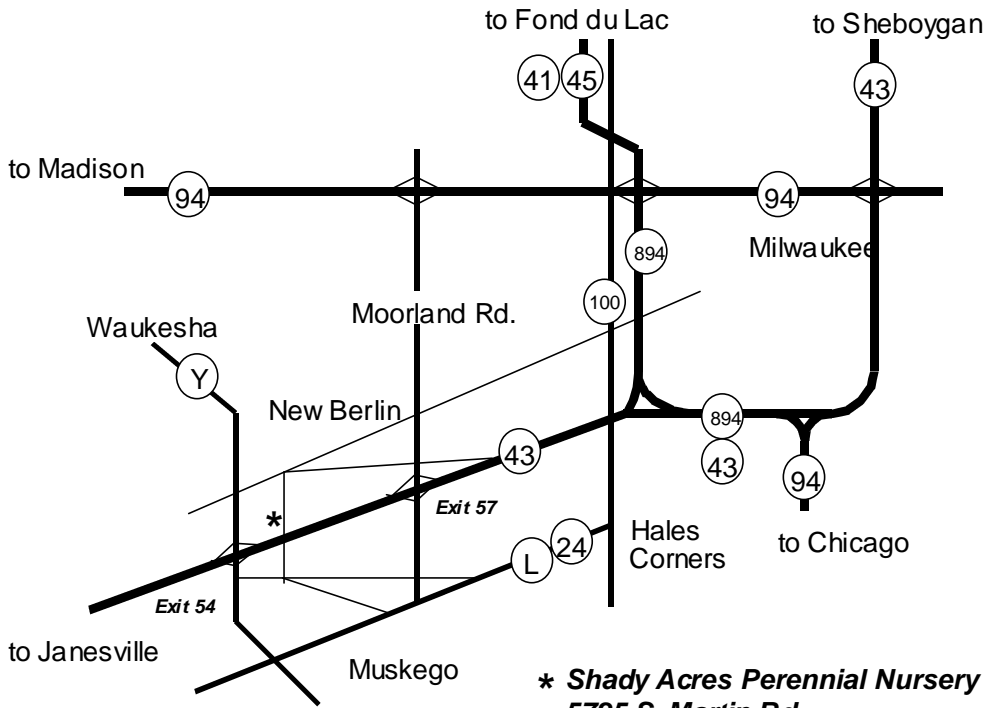

*** Shady Acres Perennial Nursery**
5725 S. Martin Rd.
New Berlin, WI 53146-5112



Shady Acres Perennial Nursery is a member of...
 Wisconsin Green Industry Federation
 Wisconsin Nursery and Landscape Association



Shady Acres

Perennial Nursery

5725 South Martin Road
New Berlin, Wisconsin 53146